

15-179-00104-00-00

STATE OF KANSAS
STATE CORPORATION COMMISSION

Give All Information Completely
Make Required Affidavit
Mail or Deliver Report to:
Conservation Division
State Corporation Commission
212 No. Market
Wichita, Kansas 67202

WELL PLUGGING RECORD

Sheridan County, Sec. 26 Twp. 8 Rge. 26 (E) (W) X
SE/SE/NE

Location as "NE/CNW/SW" or footage from lines _____
Lease Owner John O. Farmer, Inc.
Lease Name Pratt "A" Well No. 1
Office Address 370 W. Wichita Russell, Kansas
Character of Well (completed as Oil, Gas or Dry Hole) _____
Date well completed _____ 19____
Application for plugging filed _____ 19____
Application for plugging approved _____ 19____
Plugging commenced 3-18-72 19____
Plugging completed 3-22-72 19____
Reason for abandonment of well or producing formation Depleted

If a producing well is abandoned, date of last production _____ 19____
Was permission obtained from the Conservation Division or its agents before plugging was commenced? Yes

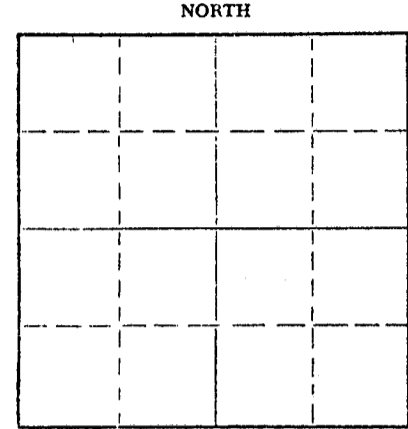

Locate well correctly on above Section Plat

Name of Conservation Agent who supervised plugging of this well W. L. Nichols
Producing formation _____ Depth to top _____ Bottom _____ Total Depth of Well 3940 Feet
Show depth and thickness of all water, oil and gas formations.

OIL, GAS OR WATER RECORDS

CASING RECORD

| FORMATION | CONTENT | FROM | TO | SIZE | PUT IN | PULLED OUT |
|-----------|---------|------|----|-------|--------|------------|
| | | | | 8 5/8 | 160 | None |
| | | | | 5 1/2 | 3913 | 1233.54' |
| | | | | | | |
| | | | | | | |
| | | | | | | |
| | | | | | | |
| | | | | | | |

Describe in detail the manner in which the well was plugged, indicating where the mud fluid was placed and the method or methods used in introducing it into the hole. If cement or other plugs were used, state the character of same and depth placed, from _____ feet to _____ feet for each plug set.

Pushed a plug to 3700 ft., dumped 225ft. sand and 5 sacks cement. Shot casing at 3250, 3150, 1510, 1320, and 1230 ft. Pulled a total of 39 jts. of 5 1/2" casing. Squeezed well with 5 sacks hulls, 30 sacks gel and 150 cub. ft. pozmix cement.

RECEIVED
STATE CORPORATION COMMISSION
MAR 28 1972
COMM. 03-28-1972
WICHITA, KANSAS

(If additional description is necessary, use BACK of this sheet)
Name of Plugging Contractor Rockhold Engineering, Inc.
Address Box 698 Great Bend, Kansas 67530

STATE OF Kansas, COUNTY OF Barton, ss.
James W. Rockhold (employee of owner) or (owner or operator) of the above-described

well, being first duly sworn on oath, says: That I have knowledge of the facts, statements, and matters herein contained and the log of the above described well on file and that the same are true and correct. So help me God.

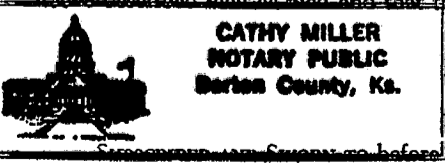

(Signature) James W. Rockhold James W. Rockhold
Box 698 Great Bend, Kansas 67530
(Address)

27th day of March, 1972

Cathy Miller
Cathy Miller Notary Public.

My commission expires September 30, 1975

STATE CORPORATION COMMISSION
CONSERVATION DIVISION
500 INSURANCE BLDG.
212 NORTH MARKET
WICHITA 2, KANSAS

15-179-00104-00-00

Township 8S Range 26W County SHERIDAN Pool S. STUDLEY

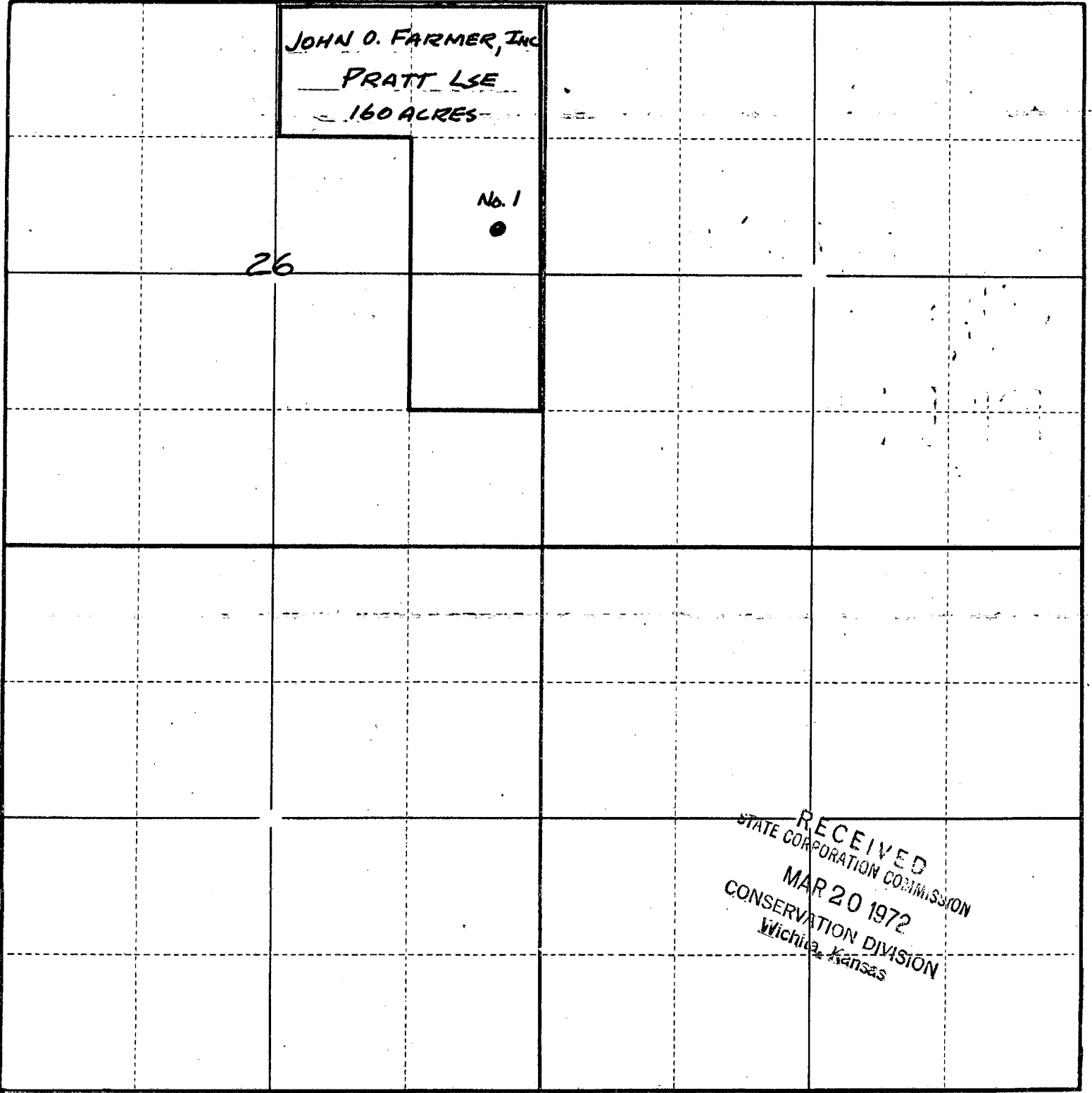

STATE OF KANSAS,
COUNTY OF SEDGWICK

I, JOHN O. FARMER
President of John O. Farmer, Inc., do hereby certify
that the above locations, feet measurements and areas are true and correct to the best of my knowledge.

John O. Farmer

Subscribed and sworn to before me this 17th day of March, 1972

My commission expires 15/75

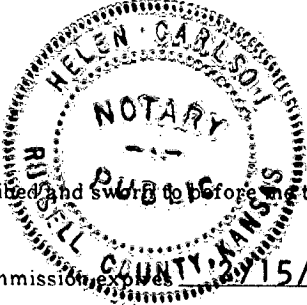

Helen Carlson
NOTARY PUBLIC
Helen Carlson

