

15-179-20298-00-00

STATE OF KANSAS  
STATE CORPORATION COMMISSION

Give All Information Completely  
Make Required Affidavit  
Mail or Deliver Report to:  
Conservation Division  
State Corporation Commission  
212 North Market, Insurance Bldg.  
Wichita, Kansas

WELL PLUGGING RECORD

NORTH

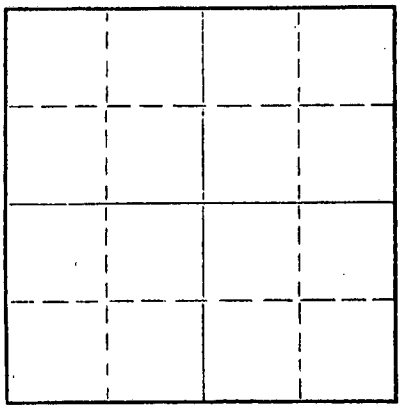

Locate well correctly on above  
Section Plat

Sheridan County. Sec. 26 Twp. 8S Rge. 26W (E) (W)  
Location as "NE/CNW%SW%" or footage from lines SW NE NE  
Lease Owner John o. Farmer, Inc.  
Lease Name Pratt "A" #2 Well No. \_\_\_\_\_  
Office Address Russell, Kansas  
Character of Well (completed as Oil, Gas or Dry Hole) Dryhole  
Date well completed 1-16-72 19\_\_\_\_  
Application for plugging filed 1-16-72 19\_\_\_\_  
Application for plugging approved Yes = 19\_\_\_\_  
Plugging commenced 1-16-72 19\_\_\_\_  
Plugging completed 1-16-72 2am. 19\_\_\_\_  
Reason for abandonment of well or producing formation \_\_\_\_\_

If a producing well is abandoned, date of last production \_\_\_\_\_ 19\_\_\_\_  
Was permission obtained from the Conservation Division or its agents before plugging was commenced? yes

Name of Conservation Agent who supervised plugging of this well W. L. Nichols  
Producing formation \_\_\_\_\_ Depth to top \_\_\_\_\_ Bottom \_\_\_\_\_ Total Depth of Well 3900 Feet  
Show depth and thickness of all water, oil and gas formations.

OIL, GAS OR WATER RECORDS

CASING RECORD

FORMATION	CONTENT	FROM	TO	SIZE	PUT IN	PULLED OUT

Describe in detail the manner in which the well was plugged, indicating where the mud fluid was placed and the method or methods used in introducing it into the hole. If cement or other plugs were used, state the character of same and depth placed, from \_\_\_\_\_ feet to \_\_\_\_\_ feet for each plug set.

Plug #1 @ 1225' 110 Cubic ft.  
#2 @ 215' 30 " "  
#3 @ 40' 10 " "

W. L. Nichols State Plugger  
Morland, Kansas

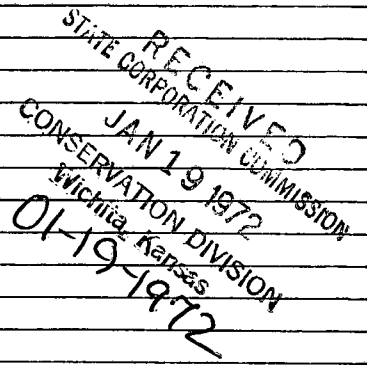

(If additional description is necessary, use BACK of this sheet)

Name of Plugging Contractor John O. Farmer, Inc.  
Address P.O. Box 352, Russell, Kansas 67665

STATE OF Kansas, COUNTY OF Russell, ss. \_\_\_\_\_  
(employee of owner) or (owner or operator) of the above-described well, being first duly sworn on oath, says: That I have knowledge of the facts, statements, and matters herein contained and the log of the above-described well as filed and that the same are true and correct. So help me God.

(Signature) John O. Farmer  
P.O. Box 352, Russell, Kansas 67665  
(Address)



SUBSCRIBED AND SWORN TO before me this 17th day of January, 1972  
Helen Carlson  
Helen Carlson Notary Public.

OPERATOR John O. Farmer, Inc.

15-179-20298-00-00

FORMATION RECORD

ADDRESS Russell, Kansas

Give detailed description and thickness of all formation drilled through, contents of sand, whether dry, water, oil or gas.

FARM NAME Pratt "A" #2 WELL NO. 26 COUNTY Sheridan TWP. 8S RGE. 26W

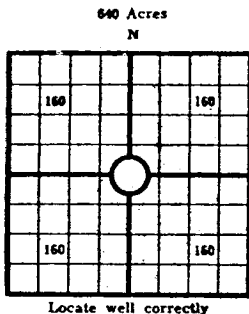

COUNTY Sheridan SEC. 26 TWP. 8S RGE. 26W  
 COMPANY OPERATING John O. Farmer, Inc.  
 OFFICE ADDRESS Box 352, Russell, Ks.  
 DRILLING STARTED 1-8, 1972, DRILLING FINISHED 1-16, 1972  
 DATE OF FIRST PRODUCTION COMPLETED  
 WELL LOCATED 1/4 1/4 1/4, North of South Line and SW NE NE ft. East of West Line of Quarter Section  
 Elevation (Relative to sea level) DERRICK FLOOR 2507 ROUND 2502  
 CHARACTER OF WELL (Oil, gas or dryhole) dryhole

OIL OR GAS SANDS OR ZONES

Name	From	To	Name	From	To
1			4		
2			5		
3			6		

Perforating Record If Any

Shot Record

Formation	From	To	No. of Shots	Formation	From	To	Size of Shot

CASING RECORD

Amount Set						Amount Pulled		Packer Record	
Size	Wt.	Thds.	Make	Ft.	In.	Size	Length	Depth Set	Make

Liner Record: Amount \_\_\_\_\_ Kind \_\_\_\_\_ Top \_\_\_\_\_ Bottom \_\_\_\_\_

CEMENTING AND MUDDING

Size	Amount Set		Sacks Cement	Chemical		Method of Cementing	Amount	Mudding Method	Results (See Note)
	Ft.	In.		Gal.	Make				
8-5/8	207		140						

Note: What method was used to protect sands if outer strings were pulled? \_\_\_\_\_

NOTE: Were bottom hole plugs used? \_\_\_\_\_ If so, state kind, depth set and results obtained \_\_\_\_\_

TOOLS USED

Rotary Tools were used from 0 feet to 3900 Cable tools were used from \_\_\_\_\_ feet to \_\_\_\_\_ feet, and from \_\_\_\_\_ feet to \_\_\_\_\_ feet, and from \_\_\_\_\_ feet to \_\_\_\_\_ feet

Type Rig Rotary

INITIAL PRODUCTION TEST

Describe initial test: whether by flow through tubing or casing or by pumping \_\_\_\_\_

Amount of Oil Production \_\_\_\_\_ bbls. Size of choke, if any \_\_\_\_\_ Length of test \_\_\_\_\_ Water

Production \_\_\_\_\_ bbls. Gravity of oil \_\_\_\_\_ Type of Pump if pump is used, describe \_\_\_\_\_

Formation	Top	Bottom	Formation	Top	Bottom
Anhydrite	2134				
Heebner	3647				
Toronto	3668				
Lansing	3680				
T.D.	3900				
			Sample Formation		
			Shale	0	1150
			Shale & Sand	1150	1490
			Shale	1490	1750
			Sand	1750	1920
			Red Bed	1920	2134
			Anhydrite	2134	2173
			Shale	2173	2325
			Shale & shells	2325	2750
			Shale & Lime	2750	3310
			Lime & Shale	3310	3520
			Shale & Lime	3520	3640
			Lime & Shale	3640	3710
			Lime	3710	3734
			Lime & Shale	3734	3880
			Lime	3880	3900
			R.T.D.	3900	

RECEIVED  
 STATE DEPARTMENT OF REVENUE  
 CONSERVATION DIVISION  
 JAN 19 1972  
 Wichita, Kansas

I, the undersigned, being first duly sworn, upon oath, state that this well record is true, correct and complete according to the records of this office and to the best of my knowledge and belief.

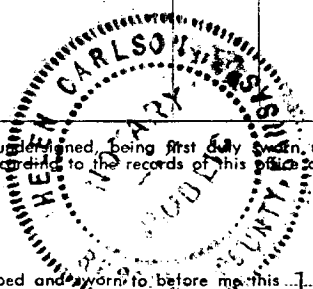

John O. Farmer  
 Name and title of representative of company  
 President

Subscribed and sworn to before me this 17th day of January, 1972

My Commission expires 2-15-75  
Helen Carlson  
 Notary Public.

Helen Carlson