

STATE OF KANSAS
STATE CORPORATION COMMISSION

Give All Information Completely.
Make Required Affidavit
Mail or Deliver Report to:
Conservation Division
State Corporation Commission
212 North Market, Insurance Bldg.
Wichita, Kansas

15-179-20299-00-00

WELL PLUGGING RECORD

NORTH

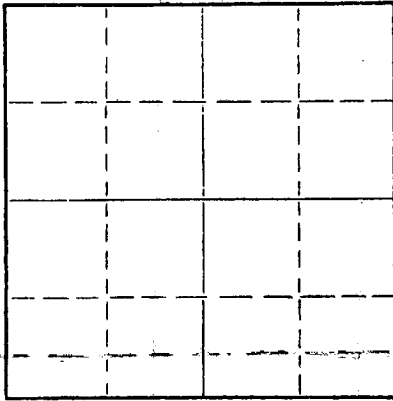

Locate well correctly on above
Section Plat

Sheridan County, Sec. 13 Twp. 8S Rge. 26W (E) (W)
Location as "NE/CNW%SW%" or footage from lines C NE SW
Lease Owner I. O. Miller & John O. Farmer, Inc.
Lease Name Pratt #1 Well No.
Office Address P.O. Box 352, Russell, Kansas 67665
Character of Well (completed as Oil, Gas or Dry Hole) Dry Hole
Date well completed 1-25-72 19
Application for plugging filed 1-25-72 19
Application for plugging approved 1-25-72 19
Plugging commenced 1-25-72 19
Plugging completed 1-25-72 9:30pm. 19
Reason for abandonment of well or producing formation

If a producing well is abandoned, date of last production 19
Was permission obtained from the Conservation Division or its agents before plugging was commenced? yes

Name of Conservation Agent who supervised plugging of this well W. L. Nichols
Producing formation _____ Depth to top _____ Bottom _____ Total Depth of Well _____ Feet
Show depth and thickness of all water, oil and gas formations.

OIL, GAS OR WATER RECORDS

CASING RECORD

FORMATION	CONTENT	FROM	TO	SIZE	PUT IN	PULLED OUT

Describe in detail the manner in which the well was plugged, indicating where the mud fluid was placed and the method or methods used in introducing it into the hole. If cement or other plugs were used, state the character of same and depth placed, from _____ feet to _____ feet for each plug set.

Plug #1 - 1150' - 100 Cubic Ft.
#2 215' 30 " "
#3 40 10 " "

Completed at 9:30 p.m. 1/25/72

W. L. Nichols State Plugger
Morland, Kansas

RECEIVED
STATE CORPORATION COMMISSION
JAN 28 1972
CONSERVATION DIVISION
Wichita, Kansas

1-28-72

(If additional description is necessary, use BACK of this sheet)

Name of Plugging Contractor John O. Farmer, Inc.
Address Russell, Kansas

STATE OF Kansas, COUNTY OF Russell, ss.

(employee of owner) or (owner or operator) of the above-described well, being first duly sworn on oath, says: That I have knowledge of the facts, statements, and matters herein contained and the log of the above-described well and that the same are true and correct. So help me God.

(Signature)

John O. Farmer
P.O. Box 352, Russell, Kansas 67665
(Address)

SUBSCRIBED AND SWORN TO before me this 27th day of January, 1972

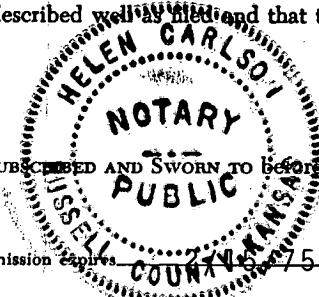

Helen Carlson
Notary Public.

My commission expires 6-75

OPERATOR I. O. MILLER & JOHN O. FARMER, INC.

FORMATION RECORD

ADDRESS P.O. Box 382 Russell, Ks. 67665 Give detailed description and thickness of all formation drilled through, contents of sand, whether dr
water, oil or gas.

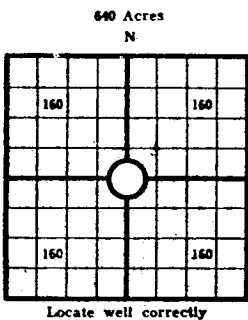

COUNTY Sheridan Sec 13 TWP 8S RGE 26W
 COMPANY OPERATING John O. Farmer, Inc.
 OFFICE ADDRESS Box 352, Russell, Ks.
 DRILLING STARTED 1/19 1972, DRILLING FINISHED 1/25 1972
 DATE OF FIRST PRODUCTION _____ COMPLETED _____
 WELL LOCATED C 1/4 NE 1/4 SW 1/4, North of South
 Line and _____ ft. East of West Line of Quarter Section
 Elevation (Relative to sea level) DERRICK FLOOR 2390 GROUND, 2394
 CHARACTER OF WELL (Oil, gas or dryhole) Dry Hole

Formation	Top	Bottom	Formation	Top	Bottom
Anhydrite	2067'				
Base Anhydrite	2104'				
Heebner	3616'				
Toronto	3632'				
Lansing	3648'				
R.T.D.	3870'				

OIL OR GAS SANDS OR ZONES

Name	From	To	Name	From	To
1			4		
2			5		
3			6		

Perforating Record If Any

Shot Record

Formation	From	To	No. of Shots	Formation	From	To	Size of Shot

CASING RECORD

Amount Set						Amount Pulled		Packer Record	
Size	Wt.	Thds.	Make	Ft.	In.	Size	Length	Depth Set	Make

Liner Record: Amount _____ Kind _____ Top _____ Bottom _____

CEMENTING AND MUDDING

Size	Amount Set		Sacks Cement	Chemical		Method of Cementing	Amount	Mudding Method	Results (See Note)
	Ft.	In.		Gal.	Make				
8-5/8	202		150						

Note: What method was used to protect sands if outer strings were pulled? _____

NOTE: Were bottom hole plugs used? _____ If so, state kind, depth set and results obtained _____

TOOLS USED

Rotary Tools were used from 0 feet to 3870 Cable tools were used from _____ feet to _____ feet, and from _____ feet to _____ feet, and from _____ feet to _____ feet

Type Rig Rotary

INITIAL PRODUCTION TEST

Describe initial test: whether by flow through tubing or casing or by pumping _____

Amount of Oil Production _____ bbls. Size of choke, if any _____ Length of test _____ Water

Production _____ bbls. Gravity of oil _____ Type of Pump if pump is used, describe _____

SAMPLE FORMATIONS

Shale	0	1680
Sand	1680	1840
Red Bed	1840	
Anhydrite	2067	2104
Shale	2104	2162
Shale & Shells	2162	2870
Shale & Lime	2890	3005
Lime & Shale	3005	3130
Shale & Lime	3130	3400
Lime & Shale	3400	3635
Lime	3635	3875
R.T.D.	3870	

RECEIVED
 STATE COMMISSION
 CONSERVATION DIVISION
 Wichita, Kansas
 JAN 28 1972
 1-28-72

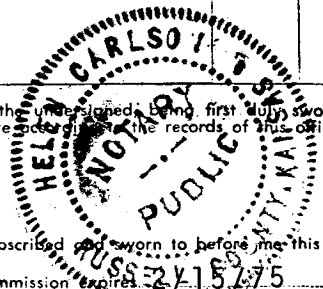

I, the undersigned, being first duly sworn upon oath, state that this well record is true, correct and complete and is being filed in the records of this office and to the best of my knowledge and belief.

John O. Farmer
 Name and title of representative of company

Subscribed and sworn to before me this 27th day of January, 1972
 My Commission Expires 2-15-75
Helen Carlson
 Notary Public.

Helen Carlson

15-179-20299-00-08

26W RGE, 8S TWP, SEC. 13, COUNTY SHERIDAN, WELL NO. L COUNTY SHERIDAN, PRATT FARM NAME