

15-163-03970-00-00

STATE OF KANSAS
STATE CORPORATION COMMISSION

Give All Information Completely
Make Required Affidavit
Mail or Deliver Report to:
Conservation Division
State Corporation Commission
211 No. Broadway
Wichita, Kansas

WELL PLUGGING RECORD

NORTH

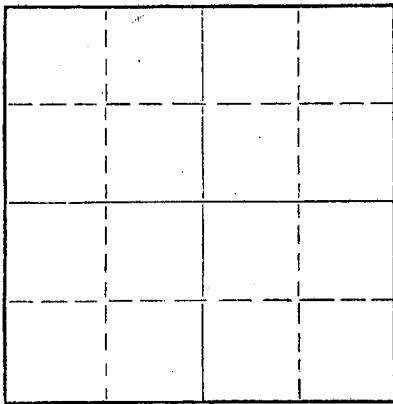

Locate well correctly on above
Section Plat

Rooks County. Sec. 22 Twp. 8S Rge. (E) 18 (W)
Location as "NE/CNW%SW%" or footage from lines NW SW NW
Lease Owner JOHN O. FARMER, INC.
Lease Name KRILEY Well No. 1
Office Address Russell, Kansas
Character of Well (completed as Oil, Gas or Dry Hole) Dry
Date well completed 4/16 1959
Application for plugging filed 4/16 1959
Application for plugging approved 4/16 1959
Plugging commenced 4/16 1959
Plugging completed 4/16 1959
Reason for abandonment of well or producing formation Dry

If a producing well is abandoned, date of last production _____ 19____
Was permission obtained from the Conservation Division or its agents before plugging was commenced? yes

Name of Conservation Agent who supervised plugging of this well Eldon Petty
Producing formation _____ Depth to top _____ Bottom _____ Total Depth of Well 3380 Feet
Show depth and thickness of all water, oil and gas formations.

OIL, GAS OR WATER RECORDS

CASING RECORD

FORMATION	CONTENT	FROM	TO	SIZE	PUT IN	PULLED OUT
				8-5/8"	167'	None

Describe in detail the manner in which the well was plugged, indicating where the mud fluid was placed and the method or methods used in introducing it into the hole. If cement or other plugs were used, state the character of same and depth placed, from _____ feet to _____ feet for each plug set.

First plug set at 450 feet with 20 sacks cement

Second plug set at 150 feet with 20 sacks cement

Third plug set at 40 feet with 10 sacks cement

RECEIVED
STATE CORPORATION COMMISSION
APR 28 1959
CONSERVATION DIVISION
Wichita, Kansas

(If additional description is necessary, use BACK of this sheet)
Name of Plugging Contractor JOHN O. FARMER, INC. 4-28-59
Address Russell, Kansas

STATE OF Kansas, COUNTY OF Russell, ss.
I, John O. Farmer (owner or operator) of the above-described well, being first duly sworn on oath, says: That I have knowledge of the facts, statements, and matters herein contained and the log of the above-described well as filed and that the same are true and correct. So help me God.

(Signature) John O. Farmer
Russell, Kansas (Address)

SUBSCRIBED AND SWORN to before me this 24th day of April, 1959

My commission expires October 11, 1962

Lucille Kennedy
Lucille Kennedy Notary Public.

PLUGGING
FILE SEC. 22 T. 8S R. 18W
BOOK PAGE 34 LINE 6

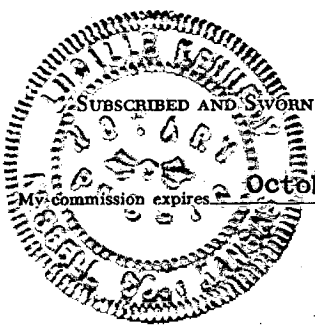

OPERATOR JOHN O. FARMER, INC.

ADDRESS Russell, Kansas

Give detailed description and thickness of all formation drilled through, contents of sand, whether dry, water, oil or gas.

WELL NO. 1 COUNTY ROOKS TWP. 8S RGE. 18W

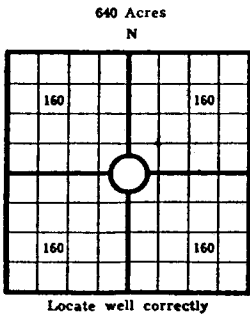

COUNTY Rooks, SEC. 22, TWP. 8S, RGE. 18W
 COMPANY OPERATING JOHN O. FARMER, INC.
 OFFICE ADDRESS Russell, Kansas
 DRILLING STARTED 4/7, 19 59 DRILLING FINISHED 4/16 19 59
 DATE OF FIRST PRODUCTION _____ COMPLETED _____
 WELL LOCATED NW 1/4 SW 1/4 NW 1/4, North of South
 Line and _____ ft. East of West Line of Quarter Section
 Elevation (Relative to sea level) DERRICK FLOOR 1914 GROUND 1911
 CHARACTER OF WELL (Oil, gas or dryhole) Dry

Formation	Top	Bottom	Formation	Top	Bottom
FARM NAME			KRILEY #1		
Surface	0	165			
Shale	165	500			
Shale & sand	500	1000			
Redbed	1000	1278			
Anhydrite	1278	1313			
Shale & shells	1313	2140			
Shale & lime	2140	2860			
Lime & shale	2860	3355			
Arbuckle	3355	3380			
T.D.		3380			
			ELEVATION:	RB	1916
			ELECTRIC LOG TOPS:		
			Topeka		2838
			Heebner		3042
			Toronto		3064
			Lansing		3084
			B/KC		3304
			Arbuckle		3344
			T.D.		3380
			D & A		
			PLUGGING FILE SEC 22 T. 8 R. 18W BOOK PAGE 34 LINE 6		

APR 28 1959

4-28-59

15-163-03970-00-00

OIL OR GAS SANDS OR ZONES

Name	From	To	Name	From	To
1			4		
2			5		
3			6		

Perforating Record If Any

Shot Record

Formation	From	To	No. of Shots	Formation	From	To	Size of Shot

CASING RECORD

Amount Set							Amount Pulled		Packer Record		
Size	Wt.	Thds.	Make	Ft.	In.	Ft.	In.	Size	Length	Depth Set	Make
8-5/8				167							

Liner Record: Amount _____ Kind _____ Top _____ Bottom _____

CEMENTING AND MUDDING

Size	Amount Set		Sacks Cement	Chemical		Method of Cementing	Amount	Mudding Method	Results (See Note)
	Ft.	In.		Gal.	Make				
8-5/8	167		120						

Note: What method was used to protect sands if outer strings were pulled? _____

NOTE: Were bottom hole plugs used? _____ If so, state kind, depth set and results obtained _____

TOOLS USED

Rotary Tools were used from _____ feet to _____ feet Cable tools were used from _____ feet to _____ feet, and from _____ feet to _____ feet, and from _____ feet to _____ feet to _____ feet to _____ feet

Type Rig _____

INITIAL PRODUCTION TEST

Describe initial test: whether by flow through tubing or casing or by pumping _____

Amount of Oil Production _____ bbls. Size of choke, if any _____ Length of test _____ Water

Production _____ bbls. Gravity of oil _____ Type of Pump if pump is used, describe _____

I, the undersigned, being first duly sworn upon oath, state that this well record is true, correct and complete according to the records of this office and to the best of my knowledge and belief.

John O. Farmer President
 Name and title of representative of company

Subscribed and sworn to before me this 24th day of April, 19 59

My Commission expires 10/11/62 *Willie K...* Notary Public.