

EFFECTIVE DATE: 6-17-97  
DISTRICT # 4  
SGA? ... Yes  No

State of Kansas  
NOTICE OF INTENTION TO DRILL (Corrected)

FORM C-1 7,  
FORM MUST BE SIG  
ALL BLANKS MUST BE FILL

Must be approved by the K.C.C. five (5) days prior to commencing well.

Expected Spud Date June 16th 1997  
month day year

\* Spot 85' W of RECEIVED  
NE - NE NE SW Sec 30 Twp .9S. S, Rg .21W Er  
NE - NE NE SW Sec 30 Twp .9S. S, Rg .21W X W

OPERATOR: License # 6622  
Name: JASON OIL COMPANY  
Address: P.O. Box 701  
City/State/Zip: Russell, Kansas 67665-0701  
Contact Person: J.L. Schoenberger  
Phone: (913) 483-4204

\* 2310 feet from South / XXXX line of Secti  
3055 feet from East / XXXX line of Secti  
IS SECTION X REGULAR IRREGULAR?

CONTRACTOR: License #: 31548  
Name: Discovery Drilling, Inc.

(NOTE: Locate well on the Section Plat on Reverse Side  
County: Graham  
Lense Name: Smith "D" Well #: 3  
Field Name: Harrold West

Well Drilled For: Well Class: Type Equipment:  
 Oil ... Enk Rec  Infield X Mud Rotary  
... Gas ... Storage ... Pool Ext. ... Air Rotary  
... OWO ... Disposal ... Wildcat ... Cable  
... Seismic; ... # of Holes ... Other

Is this a Prorated/Spaced Field? ... yes  no  
Target Formation(s): Lansing, KC  
Nearest lense or unit boundary: 330'  
Ground Surface Elevation: 2350. EST feet M  
Water well within one-quarter mile: ... yes   
Public water supply well within one mile: ... yes   
Depth to bottom of fresh water: 160' 4.150  
Depth to bottom of usable water: 1000' 1050

If OWO: old well information as follows:  
Operator: \_\_\_\_\_  
Well Name: \_\_\_\_\_  
Comp. Date: \_\_\_\_\_ Old Total Depth \_\_\_\_\_

Surface Pipe by Alternate: 1  2  
Length of Surface Pipe Planned to be set: 200'  
Length of Conductor pipe required: None  
Projected Total Depth: 3900'  
Formation at Total Depth: Arbuckle  
Water Source for Drilling Operations:  
... well  farm pond ... oth

Directional, Deviated or Horizontal wellbore? ... yes  no  
If yes, true vertical depth: \_\_\_\_\_  
Bottom Hole Location: \_\_\_\_\_

Will Cores Be Taken?: ... yes  no  
If yes, proposed zone: \_\_\_\_\_

AFFIDAVIT

The undersigned hereby affirms that the drilling, completion and eventual plugging of this well will comply with K.S.A. 55-10 et. seq.  
It is agreed that the following minimum requirements will be met:

\* SPOT WAS: NE NE SW  
SPOT IS: 85' W of NE NE SW  
\* WAS: 2970' FEL IS: 3055' FEL

1. Notify the appropriate district office prior to spudding of well;
2. A copy of the approved notice of intent to drill shall be posted on each drilling rig;
3. The minimum amount of surface pipe as specified below shall be set by circulating cement to the top; in all cases surface pipe shall be set through all unconsolidated materials plus a minimum of 20 feet into the underlying formation;
4. If the well is dry hole, an agreement between the operator and the district office on plug length and placement necessary prior to plugging;
5. The appropriate district office will be notified before well is either plugged or production casing is cemented in;
6. IF AN ALTERNATE IS COMPLETION, PRODUCTION PIPE SHALL BE CEMENTED FROM BELOW ANY USABLE WATER TO SURFACE WITHIN 120 DA OF SPUD DATE. IN ALL CASES, NOTIFY DISTRICT OFFICE PRIOR TO ANY CEMENTING.

I hereby certify that the statements made herein are true and to the best of my knowledge and belief.  
Date: June 10, 1997 signature of Operator or Agent: Thomas J. ... Title: Agent

FOR KCC USE:
API # 15- <u>065-227860000</u>
Conductor pipe required <u>NONE</u> feet
Minimum surface pipe required <u>200</u> feet per Alt. <u>X(2)</u>
Approved by: <u>MR 6-16-97 JK / ORIL 6-17-97 JK</u>
This authorization expires: <u>12-16-98</u> (This authorization void if drilling not started within 6 months of effective date.)
Spud date: _____ Agent: _____

REMEMBER TO:

- File Drill Pit Application (form CDP-1) with Intent to Drill;
- File Completion Form ACO-1 within 120 days of spud date;
- File acreage attribution plat according to field proration orders;
- Notify appropriate district office 48 hours prior to workover or re-entry;
- Submit plugging report (CP-4) after plugging is completed;
- Obtain written approval before disposing or injecting salt water.

Mail to: KCC - Conservation Division, 130 S. Market - Room 207B, Wichita, Kansas 67202.

30  
9  
210

**IN ALL CASES PLOT THE INTENDED WELL ON THE PLAT BELOW**

**PLAT OF ACREAGE ATTRIBUTABLE TO A WELL IN A PRORATED OR SPACED FIELD**

If the intended well is in a prorated or spaced field, please fully complete this side of the form. If the intended well is in a prorated or spaced field complete the plat below showing that the well will be properly located in relationship to other wells producing from the common source of supply. Please show all the wells within 1 mile of the boundaries of the proposed acreage attribution unit for gas wells and within 1/2 mile of the boundaries of the proposed acreage attribution unit for oil wells.

API NO. 15- \_\_\_\_\_

OPERATOR JASON OIL COMPANY LOCATION OF WELL: COUNTY Graham

LEASE Smith "D" # 3 \_\_\_\_\_ 2310 feet from south/~~north~~ line of section

WELL NUMBER 3 \_\_\_\_\_ 3055 feet from east/~~west~~ line of section

FIELD Harrold West SECTION 30 TWP 9s RG 21w

NUMBER OF ACRES ATTRIBUTABLE TO WELL \_\_\_\_\_ IS SECTION X REGULAR or \_\_\_\_\_ IRREGULAR

QTR/QTR/QTR OF ACREAGE \_\_\_\_\_ IF SECTION IS IRREGULAR, LOCATE WELL FROM NEAREST CORNER BOUNDARY.

Section corner used: \_\_\_\_\_ NE \_\_\_\_\_ NW \_\_\_\_\_ SE \_\_\_\_\_ SW

**PLAT**

(Show location of the well and shade attributable acreage for prorated or spaced wells.)  
 (Show footage to the nearest lease or unit boundary line.)

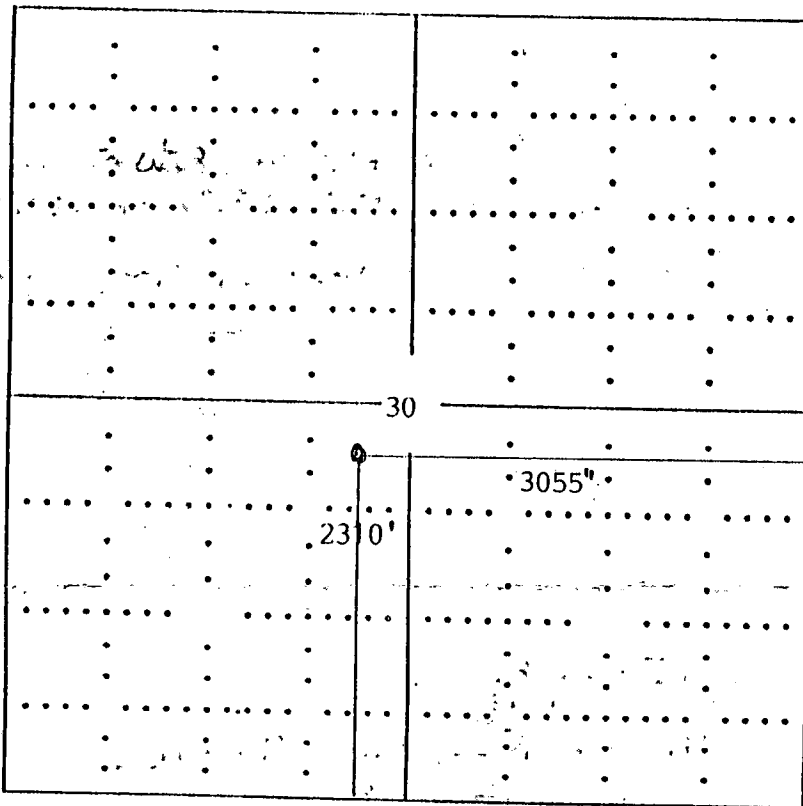

Graham Co.

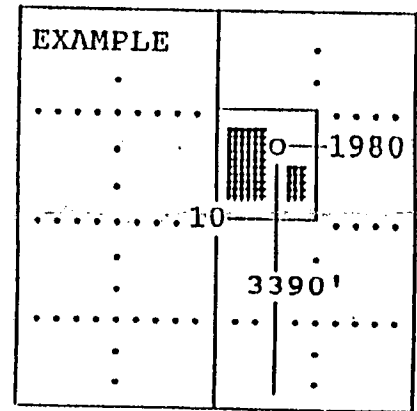

SEWARD CO.

**In plotting the proposed location of the well, you must show:**

- 1) The manner in which you are using the depicted plat by identifying section lines, i.e. 1 section, 1 section with 8 surrounding sections, 4 sections, etc.;
- 2) the distance of the proposed drilling location from the section's south/north and east/west; and
- 3) the distance to the nearest lease or unit boundary line.