

FOR KCC USE:

SKM FORM C-1 7/91
FORM MUST BE TYPED
FORM MUST BE SIGNED
ALL BLANKS MUST BE FILLED

EFFECTIVE DATE: 11-17-91

State of Kansas

DISTRICT # 4

NOTICE OF INTENTION TO DRILL

SGA? Yes No

Must be approved by the K.C.C. five (5) days prior to commencing well

Expected Spud Date 11 month 26 day 91 year

Spot 50' West
NE SE SW Sec 34 Twp 9S S. Rg 21 X East

OPERATOR: License # 5616
Name: Calvin Noah
Address: 329 N. Birch
City/State/Zip: Valley Center, KS 67147
Contact Person: Calvin Noah
Phone: 316-755-1032

990' FSL feet from South/West line of Section
3020' FEL feet from East/West line of Section
IS SECTION X REGULAR IRREGULAR?

CONTRACTOR: License #: 30684
Name: Abercrombie RTD, Inc.

(NOTE: Locate well on the Section Plat on Reverse Side)
County: Graham

Well Drilled For: Well Class: Type Equipment:

X Oil Enh Rec Infield X Mud Rotary
Gas Storage Pool Ext. Air Rotary
OWWO Disposal Wildcat Cable
Seismic: # of Holes Other
Other

Lease Name: Kuehnl Well #: #1
Field Name: unknown

If OWWO: old well information as follows:
Operator: N/A
Well Name:
Comp. Date: Old Total Depth

Is this a Prorated/Spaced Field? yes X no
Target Formation(s): Arbuckle

Directional, Deviated or Horizontal wellbore? yes X no

Nearest lease or unit boundary: 380'
Ground Surface Elevation: 1180' unknown feet MSL

If yes, true vertical depth: N/A

Water well within one-quarter mile: yes X no
Public water supply well within one mile: yes X no

Bottom Hole Location: N/A

Depth to bottom of fresh water: 75'
Depth to bottom of usable water: 1150' 980'

AFFIDAVIT

The undersigned hereby affirms that the drilling, completion and eventual plugging of this well will comply with K.S.A. 55-101, et. seq.

It is agreed that the following minimum requirements will be met:

- 1. Notify the appropriate district office prior to spudding of well;
- 2. A copy of the approved notice of intent to drill shall be posted on each drilling rig;
- 3. The minimum amount of surface pipe as specified below shall be set by circulating cement to the top; in all cases surface pipe shall be set through all unconsolidated materials plus a minimum of 20 feet into the underlying formation;
- 4. If the well is dry hole, an agreement between the operator and the district office on plug length and placement is necessary prior to plugging;
- 5. The appropriate district office will be notified before well is either plugged or production casing is cemented in;
- 6. IF AN ALTERNATE II COMPLETION, PRODUCTION PIPE SHALL BE CEMENTED FROM BELOW ANY USABLE WATER TO SURFACE WITHIN 120 DAYS OF SPUD DATE. IN ALL CASES, NOTIFY DISTRICT OFFICE PRIOR TO ANY CEMENTING.

I hereby certify that the statements made herein are true and to the best of my knowledge and belief.

Date: 11-8-91 Signature of Operator or Agent: [Signature] Title: Executive Vice President

FOR KCC USE:
API # 15- 065-22 656-00-00
Conductor pipe required N.D.R. feet
Minimum surface pipe required 300 feet per Alt. 2
Approved by: [Signature] 11-12-91
This authorization expires: 5-12-92
(This authorization void if drilling not started within 6 months of effective date.)
Spud date: Agent:

REMEMBER TO:

- File Drill Pit Application (form CDP-1) with Intent to Drill;
- File Completion Form ACO-1 within 120 days of spud date;
- File acreage attribution plat according to field prorations orders;
- Notify appropriate district office 48 hours prior to workover or re-entry;
- Submit plugging report (CP-4) after plugging is completed;
- Obtain written approval before disposing or injecting salt water.

Mail to: Conservation Division, 200 Colorado Derby Building, 202 W. First St., Wichita, Kansas 67202-1286.

CONSERVATION DIVISION
WICHITA, KS

NOV 8 1991

RECEIVED
KANSAS CORPORATION COMMISSION

34 9
[Signature]

IN ALL CASES PLOT THE INTENDED WELL ON THE PLAT BELOW

PLAT OF ACREAGE ATTRIBUTABLE TO A WELL IN A PRORATED OR SPACED FIELD

If the intended well is in a prorated or spaced field, please fully complete this side of the form. If the intended well is in a prorated or spaced field complete the plat below showing that the well will be properly located in relationship to other wells producing from the common source of supply. Please show all the wells within 1 mile of the boundaries of the proposed acreage attribution unit for gas wells and within 1/2 mile of the boundaries of the proposed acreage attribution unit for oil wells.

API NO. 15- _____
 OPERATOR Calvin Noah
 LEASE Kuehnl #1
 WELL NUMBER #1
 FIELD unknown

LOCATION OF WELL: COUNTY Graham
990' FSL feet from south/north line of section
3020' FEL feet from east/west line of section
 SECTION 34 TWP 9S RG 21W

NUMBER OF ACRES ATTRIBUTABLE TO WELL 40
 QTR/QTR/QTR OF ACREAGE NE SE SW

IS SECTION X REGULAR or IRREGULAR
IF SECTION IS IRREGULAR, LOCATE WELL FROM NEAREST CORNER BOUNDARY.

Section corner used: NE NW SE SW

PLAT

(Show location of the well and shade attributable acreage for prorated or spaced wells.)
 (Show footage to the nearest lease or unit boundary line.)

R 21W

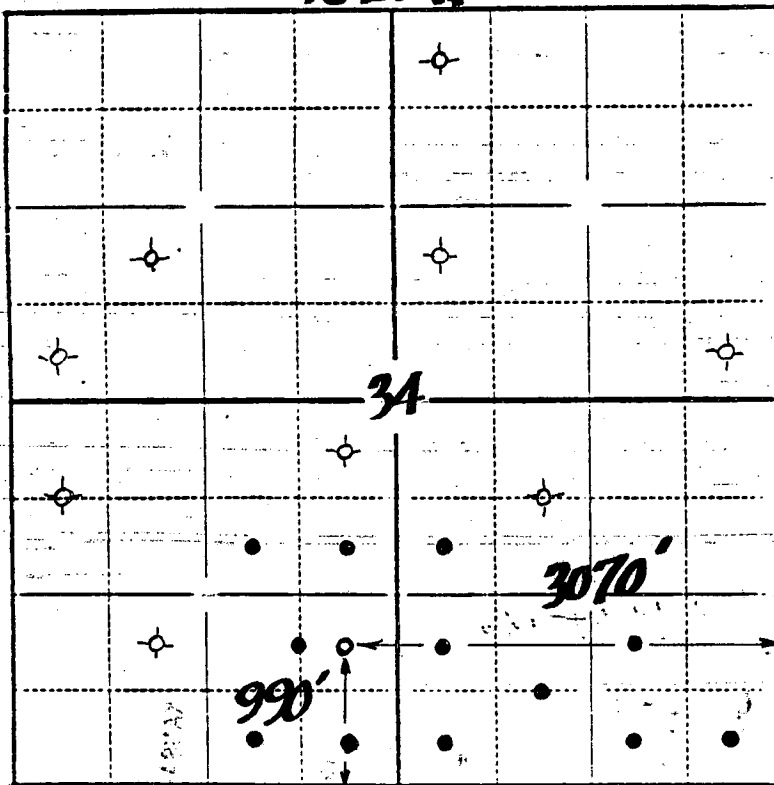

T 9 S

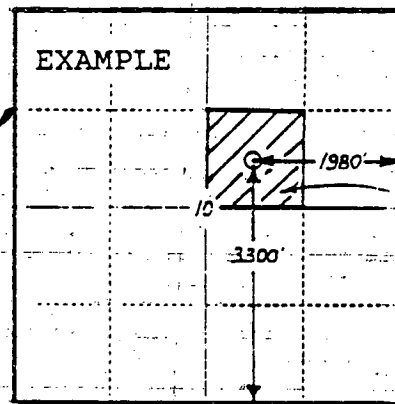

SEWARD CO.

In plotting the proposed location of the well, you must show:

- 1) The manner in which you are using the depicted plat by identifying section lines, i.e. 1 section, 1 section with 8 surrounding sections, 4 sections, etc.;
- 2) the distance of the proposed drilling location from the section's south/north and east/west lines; and
- 3) the distance to the nearest lease or unit boundary line.