

OWWO

For KCC Use:
Effective Date: 8-12-08
District #: 2
SGA? Yes No

KANSAS CORPORATION COMMISSION
OIL & GAS CONSERVATION DIVISION

Form C-1
October 2007
Form must be Typed
Form must be Signed
All blanks must be Filled

NOTICE OF INTENT TO DRILL

Must be approved by KCC five (5) days prior to commencing well

Expected Spud Date: August 7, 2008
month day year

OPERATOR: License# 5123
Name: Pickrell Drilling Company, Inc.
Address 1: 100 S. Main, Suite 505
City: Wichita, State: Kansas Zip: 67212 + 3 7 3 8
Contact Person: Larry J. Richardson
Phone: 316-262-8427

CONTRACTOR: License# 5123
Name: Company Tools

Spot Description:
C SW SE Sec. 6 Twp. 30 S. R. 6 E W
660 feet from N S Line of Section
1,980 feet from E W Line of Section

Is SECTION: Regular Irregular?

(Note: Locate well on the Section Plat on reverse side)

County: Kingman

Lease Name: Huson "A" Gas Unit Well #: 2 OWWO

Field Name: Spivey-Grabs

Is this a Prorated / Spaced Field? Yes No

Target Formation(s): Mississippian

Nearest Lease or unit boundary line (in footage): 660'

Ground Surface Elevation: 1420' feet MSL

Water well within one-quarter mile: Yes No

Public water supply well within one mile: Yes No

Depth to bottom of fresh water: 60'

Depth to bottom of usable water: 180'

Surface Pipe by Alternate: I II

Length of Surface Pipe Planned to be set: 250' already set

Length of Conductor Pipe (if any): N/A

Projected Total Depth: 4200'

Formation at Total Depth: Mississippian

Water Source for Drilling Operations:

Well Farm Pond Other: TBD

DWR Permit #: (Note: Apply for Permit with DWR)

Will Cores be taken? Yes No

If Yes, proposed zone:

Well Drilled For: Oil Gas Seismic Other
Well Class: Enh Rec Storage Disposal Infield Pool Ext Wildcat Other
Type Equipment: Mud Rotary Air Rotary Cable

If OWWO: old well information as follows:

Operator: D R Lauck & Lario Oil & Gas Company
Well Name: #1 Cessna
Original Completion Date: 9/24/66 Original Total Depth: 4550

Directional, Deviated or Horizontal wellbore? Yes No

If Yes, true vertical depth:

Bottom Hole Location:

KCC DKT #:

AFFIDAVIT

The undersigned hereby affirms that the drilling, completion and eventual plugging of this well will comply with K.S.A. 55 et. seq.

It is agreed that the following minimum requirements will be met:

- 1. Notify the appropriate district office prior to spudding of well;
2. A copy of the approved notice of intent to drill shall be posted on each drilling rig;
3. The minimum amount of surface pipe as specified below shall be set by circulating cement to the top;
4. If the well is dry hole, an agreement between the operator and the district office on plug length and placement is necessary prior to plugging;
5. The appropriate district office will be notified before well is either plugged or production casing is cemented in;
6. If an ALTERNATE II COMPLETION, production pipe shall be cemented from below any usable water to surface within 120 DAYS of spud date.

I hereby certify that the statements made herein are true and correct to the best of my knowledge and belief.

Date: July 24, 2008 Signature of Operator or Agent: [Signature] Title: Geologist

RECEIVED
KANSAS CORPORATION COMMISSION
JUL 24 2008
CONSERVATION DIVISION
WICHITA, KS

For KCC Use ONLY
API # 15 - 095-30091-00-01
Conductor pipe required None feet
Minimum surface pipe required 250 feet per ALT.
Approved by: [Signature]
This authorization expires: 8-7-09
Spud date: Agent:

Remember to:
- File Drill Pit Application (form CDP-1) with intent to Drill;
- File Completion Form ACO-1 within 120 days of spud date;
- File acreage attribution plat according to field proration orders;
- Notify appropriate district office 48 hours prior to workover or re-entry;
- Submit plugging report (CP-4) after plugging is completed (within 60 days);
- Obtain written approval before disposing or injecting salt water.
- If this permit has expired (See: authorized expiration date) please check the box below and return to the address below.
Well Not Drilled - Permit Expired Date:
Signature of Operator or Agent:

IN ALL CASES PLOT THE INTENDED WELL ON THE PLAT BELOW

Plat of acreage attributable to a well in a prorated or spaced field

If the intended well is in a prorated or spaced field, please fully complete this side of the form. If the intended well is in a prorated or spaced field complete the plat below showing that the well will be properly located in relationship to other wells producing from the common source of supply. Please show all the wells and within 1 mile of the boundaries of the proposed acreage attribution unit for gas wells and within 1/2 mile of the boundaries of the proposed acreage attribution unit for oil wells.

API No. 15 - 095-30091-00-01
 Operator: Pickrell Drilling Company, Inc.
 Lease: Huson "A" Gas Unit
 Well Number: 2 OWWO
 Field: Spivey-Grabs

Location of Well: County: Kingman
 660 feet from N / S Line of Section
 1,980 feet from E / W Line of Section
 Sec. 6 Twp. 30 S. R. 6 E W

Number of Acres attributable to well: _____
 QTR/QTR/QTR/QTR of acreage: _____ - C - SW - SE

Is Section: Regular or Irregular

If Section is Irregular, locate well from nearest corner boundary.

Section corner used: NE NW SE SW

PLAT

*(Show location of the well and shade attributable acreage for prorated or spaced wells.)
 (Show footage to the nearest lease or unit boundary line.)*

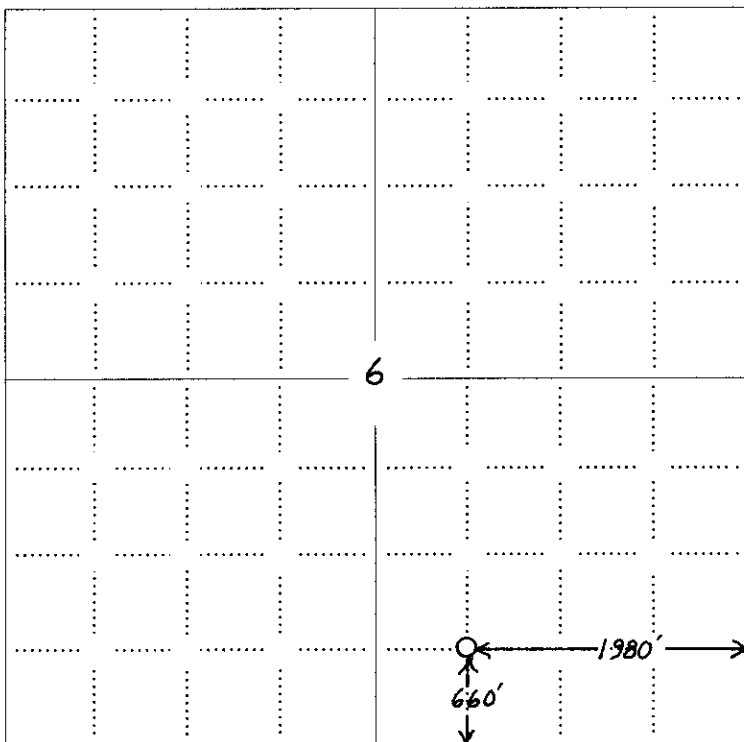

NOTE: In all cases locate the spot of the proposed drilling locaton.

RECEIVED
 KANSAS CORPORATION COMMISSION

JUL 24 2008

CONSERVATION DIVISION
 WICHITA, KS

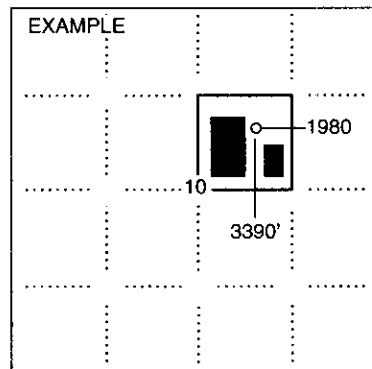

SEWARD CO.

In plotting the proposed location of the well, you must show:

1. The manner in which you are using the depicted plat by identifying section lines, i.e. 1 section, 1 section with 8 surrounding sections, 4 sections, etc.
2. The distance of the proposed drilling location from the south / north and east / west outside section lines.
3. The distance to the nearest lease or unit boundary line (in footage).
4. If proposed location is located within a prorated or spaced field a certificate of acreage attribution plat must be attached: (CO-7 for oil wells; CG-8 for gas wells).

**KANSAS CORPORATION COMMISSION
OIL & GAS CONSERVATION DIVISION
APPLICATION FOR SURFACE PIT**

Form CDP-1
April 2004
Form must be Typed

Submit in Duplicate

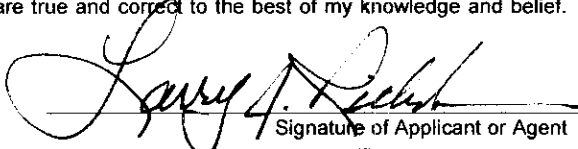
Operator Name: Pickrell Drilling Company, Inc.		License Number: 5123
Operator Address: 100 S. Main, Suite 505		Wichita, Kansas 67212
Contact Person: Larry J. Richardson		Phone Number: 316-262-8427
Lease Name & Well No.: Huson "A" Gas Unit 2 OWWO		Pit Location (QQQQ): <div style="text-align: center;">C SW SE</div> Sec. <u>6</u> Twp. <u>30</u> R. <u>6</u> <input type="checkbox"/> East <input checked="" type="checkbox"/> West 660 Feet from <input type="checkbox"/> North / <input checked="" type="checkbox"/> South Line of Section 1,980 Feet from <input checked="" type="checkbox"/> East / <input type="checkbox"/> West Line of Section Kingman County
Type of Pit: <input type="checkbox"/> Emergency Pit <input type="checkbox"/> Burn Pit <input type="checkbox"/> Settling Pit <input checked="" type="checkbox"/> Drilling Pit <input type="checkbox"/> Workover Pit <input type="checkbox"/> Haul-Off Pit <i>(If WP Supply API No. or Year Drilled)</i>	Pit is: <input checked="" type="checkbox"/> Proposed <input type="checkbox"/> Existing If Existing, date constructed: _____ Pit capacity: 1,780 (bbls)	
Is the pit located in a Sensitive Ground Water Area? <input type="checkbox"/> Yes <input checked="" type="checkbox"/> No		Chloride concentration: _____ mg/l <i>(For Emergency Pits and Settling Pits only)</i>
Is the bottom below ground level? <input checked="" type="checkbox"/> Yes <input type="checkbox"/> No	Artificial Liner? <input type="checkbox"/> Yes <input checked="" type="checkbox"/> No	How is the pit lined if a plastic liner is not used? Bentonite Sealer
Pit dimensions (all but working pits): <u>50</u> Length (feet) <u>50</u> Width (feet) <input type="checkbox"/> N/A: Steel Pits Depth from ground level to deepest point: <u>4</u> (feet) <input type="checkbox"/> No Pit		
If the pit is lined give a brief description of the liner material, thickness and installation procedure.		Describe procedures for periodic maintenance and determining liner integrity, including any special monitoring.
		RECEIVED KANSAS CORPORATION COMMISSION JUL 24 2008 CONSERVATION DIVISION WICHITA, KS
Distance to nearest water well within one-mile of pit <u>2765</u> feet Depth of water well <u>30</u> feet	Depth to shallowest fresh water <u>10</u> feet. Source of information: <input type="checkbox"/> measured <input type="checkbox"/> well owner <input type="checkbox"/> electric log <input checked="" type="checkbox"/> KDWR	
Emergency, Settling and Burn Pits ONLY: Producing Formation: _____ Number of producing wells on lease: _____ Barrels of fluid produced daily: _____ Does the slope from the tank battery allow all spilled fluids to flow into the pit? <input type="checkbox"/> Yes <input type="checkbox"/> No	Drilling, Workover and Haul-Off Pits ONLY: Type of material utilized in drilling/workover: <u>Fresh</u> Number of working pits to be utilized: <u>2</u> Abandonment procedure: <u>Allow to evaporate and backfill when sufficiently dry.</u> Drill pits must be closed within 365 days of spud date.	
I hereby certify that the above statements are true and correct to the best of my knowledge and belief.		
July 24, 2008 Date	 Signature of Applicant or Agent	

15095-30091-00-01

KCC OFFICE USE ONLY		Steel Pit <input type="checkbox"/>	RFAC <input checked="" type="checkbox"/> RFAS <input type="checkbox"/>
Date Received: <u>7/24/08</u>	Permit Number: _____	Permit Date: <u>8/4/08</u>	Lease Inspection: <input checked="" type="checkbox"/> Yes <input type="checkbox"/> No

Mail to: KCC - Conservation Division, 130 S. Market - Room 2078, Wichita, Kansas 67202



Kathleen Sebelius, Governor
Thomas E. Wright, Chairman
Michael C. Moffet, Commissioner
Joseph F. Harkins, Commissioner

August 6, 2008

Mr. Larry J. Richardson
Pickrell Drilling Company, Inc.
100 S. Main Ste 505
Wichita, KS 67212-3738

Re: Drilling Pit Application
Huson A Gas Unit Lease Well No. 2 OWWO
SE/4 Sec. 06-30S-06W
Kingman County, Kansas

Dear Mr. Richardson:

District staff has inspected the above referenced location and has determined that the reserve pit shall be constructed **without slots**, the bottom shall be flat and reasonably level, and **all pits must be lined with bentonite**. The free fluids must be removed. The fluids are to be removed from the reserve pit as soon as the Hutchinson Salt section has been drilled through and displacement of the fluids into the reserve pit has occurred. The fluids should be removed again within 96 hours after drilling operations have ceased.

If production casing is set all completion fluids shall be removed from the working pits daily. NO completion fluids or non-exempt wastes shall be placed in the reserve pit.

The fluids should be taken to an authorized disposal well. Please call the District Office at (316) 630-4000 when the fluids have been removed. Please file form CDP-5 (August 2004), Exploration and Production Waste Transfer, within 30 days of fluid removal. Conservation division forms are available through our office and on the KCC web site:
www.kcc.state.ks.us/conservation/forms.

A copy of this letter should be posted in the doghouse along with the approved Intent to Drill. If you have any questions or concerns please feel free to contact the undersigned at the above address.

Sincerely,

Kathy Haynes
Environmental Protection and Remediation Department

cc: File

15095-30091-0000

Form CP-4

STATE OF KANSAS
STATE CORPORATION COMMISSION

Give All Information Completely
Make Required Affidavit
Mail or Deliver Report to:
Conservation Division
State Corporation Commission
212 No. Market
Wichita, Kansas

WELL PLUGGING RECORD

NORTH

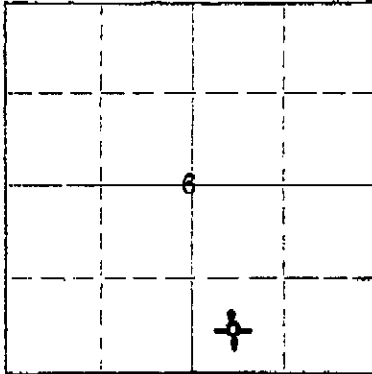

Locate well correctly on above
Section Plat

Kingman County, Sec. 6 Twp. 30S Rge. 6W XX (W)
Location as "NE/CNW/SE" or footage from lines. C SW SE
Lease Owner D. R. Lauck Oil Company, Inc.
Lease Name Cessna Well No. 1
Office Address 301 S. Broadway, Wichita, Kansas
Character of Well (completed as Oil, Gas or Dry Hole) Dry Hole
Date well completed September 24, 1966
Application for plugging filed September 24, 1966
Application for plugging approved September 24, 1966
Plugging commenced September 24, 1966
Plugging completed September 24, 1966
Reason for abandonment of well or producing formation Dry Hole

If a producing well is abandoned, date of last production _____ 19____
Was permission obtained from the Conservation Division or its agents before plugging was commenced? Yes

Name of Conservation Agent who supervised plugging of this well Herman Justus
Producing formation _____ Depth to top _____ Bottom _____ Total Depth of Well 4550 Feet
Show depth and thickness of all water, oil and gas formations.

OIL, GAS OR WATER RECORDS

CASING RECORD

FORMATION	CONTENT	FROM	TO	SIZE	PUT IN	PULLED OUT
		0'	249'	8-5/8"	249'	None

Describe in detail the manner in which the well was plugged, indicating where the mud fluid was placed and the method or methods used in introducing it into the hole. If cement or other plugs were used, state the character of same and depth placed, from _____ feet to _____ feet for each plug set.

4550'-240' Mud
240'-236' Plug
236'-196' Cement, 23 sacks
196'-40' Mud
40'-36' Plug
36'-6' Cement, 10 sacks (Bottom of cellar)

(If additional description is necessary, use BACK of this sheet)

Name of Plugging Contractor Lauck Drilling Company, Incorporated
Address 301 S. Broadway, Wichita, Kansas