

For KCC Use:  
 Effective Date: 8-17-08  
 District #: 3  
 SGA?  Yes  No

KANSAS CORPORATION COMMISSION  
 OIL & GAS CONSERVATION DIVISION

Form C-1  
 October 2007  
 Form must be Typed  
 Form must be Signed  
 All blanks must be Filled

NOTICE OF INTENT TO DRILL

Must be approved by KCC five (5) days prior to commencing well

Expected Spud Date: OCTOBER 2 2008  
month day year

OPERATOR: License# 31002  
 Name: KELLY CO LC  
 Address 1: 9746 PFLUMM RD  
 Address 2: \_\_\_\_\_  
 City: LENEXA State: KS Zip: 66215 + \_\_\_\_\_  
 Contact Person: JIM O GUINOTTE  
 Phone: 620-432-4545  
 CONTRACTOR: License# 8509  
 Name: EVANS ENERGY DEVELOPMENT

Spot Description:  
~~SE~~ - SE - SE - NE Sec. 15 Twp. 14 S. R. 22  E  W  
(10/100)  
2,970 feet from  N /  S Line of Section  
330 feet from  E /  W Line of Section  
 Is SECTION:  Regular  Irregular?

(Note: Locate well on the Section Plat on reverse side)

County: JOHNSON  
 Lease Name: KNABE M Well #: 14  
 Field Name: GARDNER

Is this a Prorated / Spaced Field?  Yes  No  
 Target Formation(s): BARTLESVILLE

Nearest Lease or unit boundary line (in footage): 330  
 Ground Surface Elevation: APPROX 1000 FT feet MSL

Water well within one-quarter mile:  Yes  No  
 Public water supply well within one mile:  Yes  No

Depth to bottom of fresh water: 200+  
 Depth to bottom of usable water: 250-300

Surface Pipe by Alternate:  I  II  
 Length of Surface Pipe Planned to be set: 20FT

Length of Conductor Pipe (if any): NONE  
 Projected Total Depth: 900 FT

Formation at Total Depth: BARTLESVILLE

Water Source for Drilling Operations:  
 Well  Farm Pond  Other: \_\_\_\_\_

DWR Permit #: \_\_\_\_\_  
 (Note: Apply for Permit with DWR )  
 Will Cores be taken?  Yes  No

If Yes, proposed zone: BARTLESVILLE

Well Drilled For:  Oil  Enh Rec  Gas  Storage  Disposal  Seismic; # of Holes \_\_\_\_\_  Other: \_\_\_\_\_  
 Well Class:  Infield  Pool Ext.  Wildcat  Other \_\_\_\_\_  
 Type Equipment:  Mud Rotary  Air Rotary  Cable

If OWWO: old well information as follows:  
 Operator: \_\_\_\_\_  
 Well Name: \_\_\_\_\_  
 Original Completion Date: \_\_\_\_\_ Original Total Depth: \_\_\_\_\_

Directional, Deviated or Horizontal wellbore?  Yes  No  
 If Yes, true vertical depth: \_\_\_\_\_  
 Bottom Hole Location: \_\_\_\_\_  
 KCC DKT #: \_\_\_\_\_

AFFIDAVIT

The undersigned hereby affirms that the drilling, completion and eventual plugging of this well will comply with K.S.A. 55 et. seq.  
 It is agreed that the following minimum requirements will be met:

1. Notify the appropriate district office **prior** to spudding of well;
2. A copy of the approved notice of intent to drill **shall be** posted on each drilling rig;
3. The minimum amount of surface pipe as specified below **shall be set** by circulating cement to the top; in all cases surface pipe shall be set through all unconsolidated materials plus a minimum of 20 feet into the underlying formation.
4. If the well is dry hole, an agreement between the operator and the district office on plug length and placement is necessary **prior to plugging**;
5. The appropriate district office will be notified before well is either plugged or production casing is cemented in;
6. If an ALTERNATE II COMPLETION, production pipe shall be cemented from below any usable water to surface within **120 DAYS** of spud date. Or pursuant to Appendix "B" - Eastern Kansas surface casing order #133,891-C, which applies to the KCC District 3 area, alternate II cementing must be completed within 30 days of the spud date or the well shall be plugged. **In all cases, NOTIFY district office** prior to any cementing.

I hereby certify that the statements made herein are true and correct to the best of my knowledge and belief.

Date: 8/08/08 Signature of Operator or Agent: Jim O. Guinotte Title: mgr.

RECEIVED  
 KANSAS CORPORATION COMMISSION  
 AUG 11 2008

Conservation Division  
 WICHITA, KS

**For KCC Use ONLY**  
 API # 15 - 091-23291-0000  
 Conductor pipe required None feet  
 Minimum surface pipe required 20 feet per ALT.  I  II  
 Approved by: LMH 8-12-08  
 This authorization expires: 8-12-09  
(This authorization void if drilling not started within 12 months of approval date.)  
 Spud date: \_\_\_\_\_ Agent: \_\_\_\_\_

**Remember to:**

- File Drill Pit Application (form CDP-1) with Intent to Drill;
- File Completion Form ACO-1 within 120 days of spud date;
- File acreage attribution plat according to field proration orders;
- Notify appropriate district office 48 hours prior to workover or re-entry;
- Submit plugging report (CP-4) after plugging is completed (within 60 days);
- Obtain written approval before disposing or injecting salt water.
- If this permit has expired (See: authorized expiration date) please check the box below and return to the address below.

Well Not Drilled - Permit Expired Date: \_\_\_\_\_  
 Signature of Operator or Agent: \_\_\_\_\_

15  
14  
22  
 E  
 W

**IN ALL CASES PLOT THE INTENDED WELL ON THE PLAT BELOW**

*Plat of acreage attributable to a well in a prorated or spaced field*

**If the intended well is in a prorated or spaced field, please fully complete this side of the form.** If the intended well is in a prorated or spaced field complete the plat below showing that the well will be properly located in relationship to other wells producing from the common source of supply. Please show all the wells and within 1 mile of the boundaries of the proposed acreage attribution unit for gas wells and within 1/2 mile of the boundaries of the proposed acreage attribution unit for oil wells.

API No. 15 - 023-232910000  
Operator: KELLY CO LC  
Lease: KNABE M  
Well Number: 14  
Field: GARDNER

Number of Acres attributable to well: 10  
QTR/QTR/QTR/QTR of acreage: SE - SE - SE - NE

Location of Well: County: JOHNSON  
2,970 feet from  N /  S Line of Section  
330 feet from  E /  W Line of Section  
Sec. 15 Twp. 14 S. R. 22  E  W

Is Section:  Regular or  Irregular

**If Section is Irregular, locate well from nearest corner boundary.**  
Section corner used:  NE  NW  SE  SW

**PLAT**

*(Show location of the well and shade attributable acreage for prorated or spaced wells.)  
(Show footage to the nearest lease or unit boundary line.)*

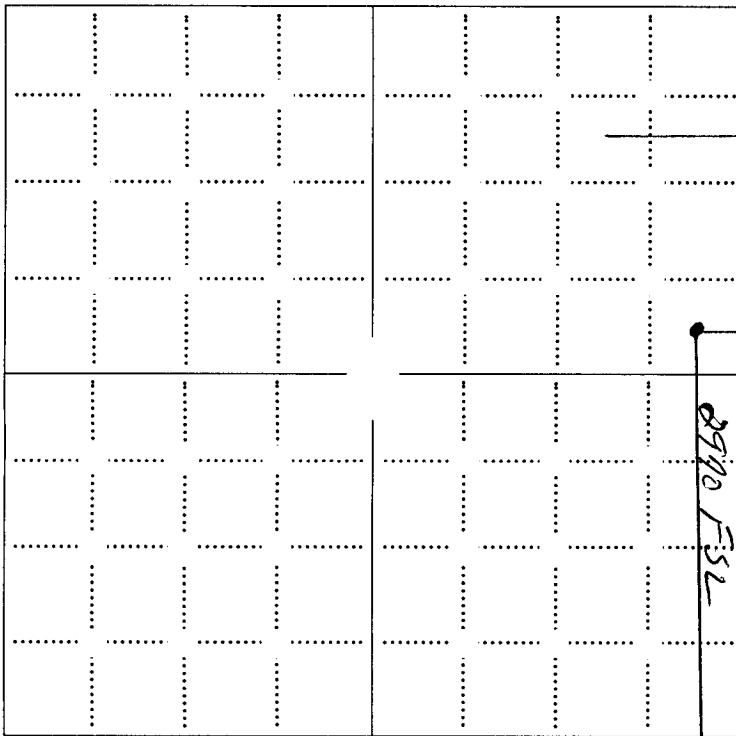

*1/4 SECTION*

*330 FEET*

*2970 FEET*

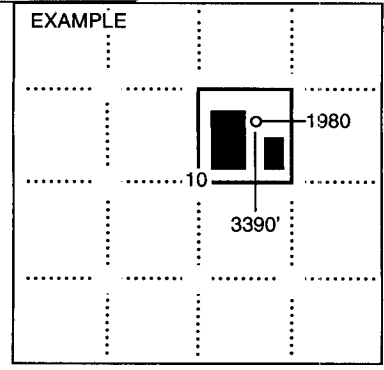

**NOTE: In all cases locate the spot of the proposed drilling location.**

RECEIVED  
KANSAS CORPORATION COMMISSION

**AUG 11 2008**

**In plotting the proposed location of the well, you must show:**

1. The manner in which you are using the depicted plat by identifying section lines, i.e. 1 section, 1 section with 8 surrounding sections, etc.
2. The distance of the proposed drilling location from the south / north and east / west outside section lines.
3. The distance to the nearest lease or unit boundary line (in footage).
4. If proposed location is located within a prorated or spaced field a certificate of acreage attribution plat must be attached: (CO-7 for oil wells; CG-8 for gas wells).

REGISTRATION DIVISION  
WICHITA, KS

**KANSAS CORPORATION COMMISSION  
OIL & GAS CONSERVATION DIVISION  
APPLICATION FOR SURFACE PIT**

Form CDP-1  
April 2004  
Form must be Typed

*Submit in Duplicate*

Operator Name: <b>KELLY CO LC</b>		License Number: <b>31002</b>	
Operator Address: <b>9746 PFLUMM RD</b>		<b>LENEXA KS 66215</b>	
Contact Person: <b>JIM O GUINOTTE</b>		Phone Number: <b>620-432-4545</b>	
Lease Name & Well No.: <b>KNABE M 14</b>		Pit Location (QQQQ): <b>SE SE SE NE</b>	
Type of Pit: <input type="checkbox"/> Emergency Pit <input type="checkbox"/> Burn Pit <input type="checkbox"/> Settling Pit <input checked="" type="checkbox"/> Drilling Pit <input type="checkbox"/> Workover Pit <input type="checkbox"/> Haul-Off Pit <i>(If WP Supply API No. or Year Drilled)</i>		Pit is: <input checked="" type="checkbox"/> Proposed <input type="checkbox"/> Existing If Existing, date constructed: _____ Pit capacity: <b>120</b> (bbls)	
Is the pit located in a Sensitive Ground Water Area? <input type="checkbox"/> Yes <input checked="" type="checkbox"/> No		Sec. <b>15</b> Twp. <b>14</b> R. <b>22</b> <input checked="" type="checkbox"/> East <input type="checkbox"/> West <b>2,970</b> Feet from <input type="checkbox"/> North / <input checked="" type="checkbox"/> South Line of Section <b>330</b> Feet from <input checked="" type="checkbox"/> East / <input type="checkbox"/> West Line of Section <b>JOHNSON</b> County	
Is the bottom below ground level? <input checked="" type="checkbox"/> Yes <input type="checkbox"/> No		Chloride concentration: _____ mg/l <i>(For Emergency Pits and Settling Pits only)</i>	
Artificial Liner? <input type="checkbox"/> Yes <input checked="" type="checkbox"/> No		How is the pit lined if a plastic liner is not used? <i>native clay</i>	
Pit dimensions (all but working pits): <b>15</b> Length (feet) <b>15</b> Width (feet) <input type="checkbox"/> N/A: Steel Pits Depth from ground level to deepest point: <b>5</b> (feet) <input type="checkbox"/> No Pit			
If the pit is lined give a brief description of the liner material, thickness and installation procedure.		Describe procedures for periodic maintenance and determining liner integrity, including any special monitoring.	
Distance to nearest water well within one-mile of pit <i>N/A</i> feet    Depth of water well _____ feet		Depth to shallowest fresh water _____ feet. Source of information: <input type="checkbox"/> measured <input type="checkbox"/> well owner <input type="checkbox"/> electric log <input type="checkbox"/> KDWR	
<b>Emergency, Settling and Burn Pits ONLY:</b> Producing Formation: _____ Number of producing wells on lease: _____ Barrels of fluid produced daily: _____ Does the slope from the tank battery allow all spilled fluids to flow into the pit? <input type="checkbox"/> Yes <input type="checkbox"/> No		<b>Drilling, Workover and Haul-Off Pits ONLY:</b> Type of material utilized in drilling/workover: <b>WATER</b> Number of working pits to be utilized: <b>1</b> Abandonment procedure: <b>PUMP PIT OUT--FILL WITH DIRT--LEVEL</b> Drill pits must be closed within 365 days of spud date.	
I hereby certify that the above statements are true and correct to the best of my knowledge and belief.		RECEIVED KANSAS CORPORATION COMMISSION	
Date: <b>8/08/08</b>		Signature of Applicant or Agent: <i>Jim O. Guinotte</i>	
		AUG 11 2008 CONSERVATION DIVISION WICHITA, KS	
<b>KCC OFFICE USE ONLY</b>			
Date Received: <b>8/11/08</b>		Permit Number: _____ Permit Date: <b>8/11/08</b> Lease Inspection: <input type="checkbox"/> Yes <input checked="" type="checkbox"/> No	

15023-232910000



*Kathleen Sebelius, Governor  
Thomas E. Wright, Chairman  
Michael C. Moffet, Commissioner  
Joseph F. Harkins, Commissioner*

---

**NOTICE TO OPERATORS FILING INTENT TO DRILL  
FOR DISPOSAL OR ENHANCED RECOVERY  
INJECTION WELLS, (CLASS II INJECTION WELL)**

The attached approved Notice of Intent to Drill indicates the proposed well is to be used for injection. An approved "Intent to Drill" does not approve injection authority as a Class II Injection Well in Kansas.

Before any well is used for injection purposes, the operator must file an application for injection authority in accordance with K.A.R. 82-3-401 and provide notice in accordance with K.A.R. 82-3-402. The Conservation Division must issue a written permit granting the application before commencement of injection.

The Conservation Division requirements and restrictions associated with Class II Injection are identified in **K.A.R. 82-3-400 et seq** of our regulations. Associated regulations governing drilling, completion and injection applications may be found in K.A.R. 82-3-135, Table I, Table II, in the Cedar Hills Sandstone Moratorium, (Docket #156,397-C), and the Eastern Kansas Surface Casing Order, (Docket #133,891-C).

If you have questions regarding the approval of injection authority, an injection application may be filed as a "Design Approval" before actual drilling and completion of the well occurs. If you have any questions or concerns regarding Class II injection wells or regulations, call the Underground Injection Control Department at 316-337-6200.

Failure to obtain commission approval before beginning injection is punishable by a penalty, shut-in of the well or both.