

For KCC Use: 8-18-08  
Effective Date: 3  
District # 3  
SGA?  Yes  No

KANSAS CORPORATION COMMISSION  
OIL & GAS CONSERVATION DIVISION  
**NOTICE OF INTENT TO DRILL**

Form C-1  
December 2002  
Form must be Typed  
Form must be Signed  
All blanks must be Filled

Must be approved by KCC five (5) days prior to commencing well

Expected Spud Date August 15 2008  
month day year

OPERATOR: License# 09267 ✓  
Name: JRC Oil Company, Inc.  
Address: P. O. Box 426  
City/State/Zip: Garnett, Kansas 66032-0426  
Contact Person: Mike Colvin  
Phone: 785-448-5833

CONTRACTOR: License# 33977 ✓  
Name: E. K. Energy LLC

Well Drilled For:	Well Class:	Type Equipment:
<input checked="" type="checkbox"/> Oil	<input type="checkbox"/> Enh Rec	<input checked="" type="checkbox"/> Infield
<input type="checkbox"/> Gas	<input type="checkbox"/> Storage	<input type="checkbox"/> Pool Ext.
<input type="checkbox"/> OWO	<input type="checkbox"/> Disposal	<input type="checkbox"/> Wildcat
<input type="checkbox"/> Seismic; # of Holes	<input type="checkbox"/> Other	<input type="checkbox"/> Cable
<input type="checkbox"/> Other		

If OWWO: old well information as follows:

Operator: \_\_\_\_\_  
Well Name: \_\_\_\_\_  
Original Completion Date: \_\_\_\_\_ Original Total Depth: \_\_\_\_\_

Directional, Deviated or Horizontal wellbore?  Yes  No

If Yes, true vertical depth: \_\_\_\_\_

Bottom Hole Location: \_\_\_\_\_

KCC DKT #: \_\_\_\_\_

Spot \_\_\_\_\_ East  
NW NE SW NW Sec. 4 Twp. 21 S. R. 21 West  
1485 feet from  N /  S Line of Section  
825 feet from  E /  W Line of Section  
Is SECTION \_\_\_\_\_ Regular  Irregular?

(Note: Locate well on the Section Plat on reverse side)

County: Anderson  
Lease Name: Daniel Well #: DF-8

Field Name: Bush City Shoestring

Is this a Prorated / Spaced Field?  Yes  No

Target Information(s): Cherokee

Nearest Lease or unit boundary: 825'

Ground Surface Elevation: 1000 feet MSL

Water well within one-quarter mile:  Yes  No

Public water supply well within one mile:  Yes  No

Depth to bottom of fresh water: 50'

Depth to bottom of usable water: 125'/100'

Surface Pipe by Alternate:  1  2

Length of Surface Pipe Planned to be set: 20'

Length of Conductor Pipe required: 0'

Projected Total Depth: 800'

Formation at Total Depth: Cherokee

Water Source for Drilling Operations:

Well  Farm Pond Other

DWR Permit #: \_\_\_\_\_

(Note: Apply for Permit with DWR )

Will Cores be taken?  Yes  No

If Yes, proposed zone: \_\_\_\_\_

**AFFIDAVIT**

The undersigned hereby affirms that the drilling, completion and eventual plugging of this well will comply with K.S.A. 55 et. seq.

It is agreed that the following minimum requirements will be met:

1. Notify the appropriate district office **prior** to spudding of well;
2. A copy of the approved notice of intent to drill **shall be** posted on each drilling rig;
3. The minimum amount of surface pipe as specified below **shall be set** by circulating cement to the top; in all cases surface pipe **shall be set** through all unconsolidated materials plus a minimum of 20 feet into the underlying formation.
4. If the well is dry hole, an agreement between the operator and the district office on plug length and placement is necessary **prior to plugging**;
5. The appropriate district office will be notified before well is either plugged or production casing is cemented in;
6. If an ALTERNATE II COMPLETION, production pipe shall be cemented from below any usable water to surface within **120 days** of spud date.  
Or pursuant to Appendix "B" - Eastern Kansas surface casing order #133,891-C, which applies to the KCC District 3 area, alternate II cementing must be completed within 30 days of the spud date or the well shall be plugged. **In all cases, NOTIFY district office** prior to any cementing.

I hereby certify that the statements made herein are true and to the best of my knowledge and belief.

Date: 8/8/2008 Signature of Operator or Agent: Michael S. Colvin Title: Vice President

For KCC Use ONLY  
API # 15 - 003-24587-0000  
Conductor pipe required None feet  
Minimum surface pipe required 20 feet per Alt. 2  
Approved by: KWC 8-13-08  
This authorization expires: 8-13-09  
(This authorization void if drilling not started within 6 months of effective date.)  
Spud date: \_\_\_\_\_ Agent: \_\_\_\_\_

**Remember to:**

- File Drill Pit Application (form CDP-1) with Intent to Drill;
- File Completion Form ACO-1 within 120 days of spud date;
- File acreage attribution plat according to field proration orders;
- Notify appropriate district office 48 hours prior to workover or re-entry;
- Submit plugging report (CP-4) after plugging is completed;
- Obtain written approval before disposing or injecting salt water.
- If this permit has expired (See: authorized expiration date) please check the box below and return to the address below.

Well Not Drilled - Permit Expired  
Signature of Operator or Agent: \_\_\_\_\_  
Date: \_\_\_\_\_

RECEIVED  
KANSAS CORPORATION COMMISSION  
AUG 13 2008

CONSERVATION DIVISION  
WICHITA, KS

4  
21  
21E

**IN ALL CASES PLOT THE INTENDED WELL ON THE PLAT BELOW**

*Plat of acreage attributable to a well in a prorated or spaced field*

If the intended well is in a prorated or spaced field, please fully complete this side of the form. If the intended well is in a prorated or spaced field complete the plat below showing that the well will be properly located in relationship to other wells producing from the common source of supply. Please show all the wells and within 1 mile of the boundaries of the proposed acreage attribution unit for gas wells and within 1/2 mile of the boundaries of the proposed acreage attribution unit for oil wells.

API No. 15 - 003-24587-0000  
 Operator: JRC Oil Company, Inc.  
 Lease: Daniel  
 Well Number: DF-8  
 Field: Bush City Shoestring  
 Number of Acres attributable to well: 2.5  
 QTR / QTR / QTR of acreage: NW - NE - SW - NW

Location of Well: County: Anderson  
1485 feet from  N /  S Line of Section  
825 feet from  E /  W Line of Section  
 Sec. 4 Twp. 21 S. R. 21  East  West

Is Section:  Regular or  Irregular

If Section is Irregular, locate well from nearest corner boundary.  
 Section corner used:  NE  NW  SE  SW

**PLAT**

(Show location of the well and shade attributable acreage for prorated or spaced wells.)  
 (Show footage to the nearest lease or unit boundary line.)

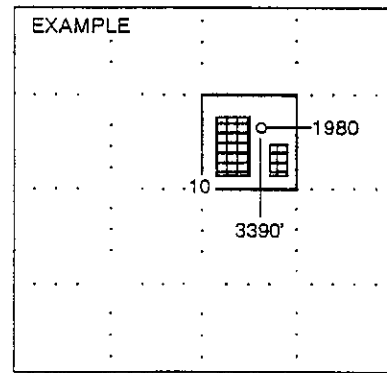
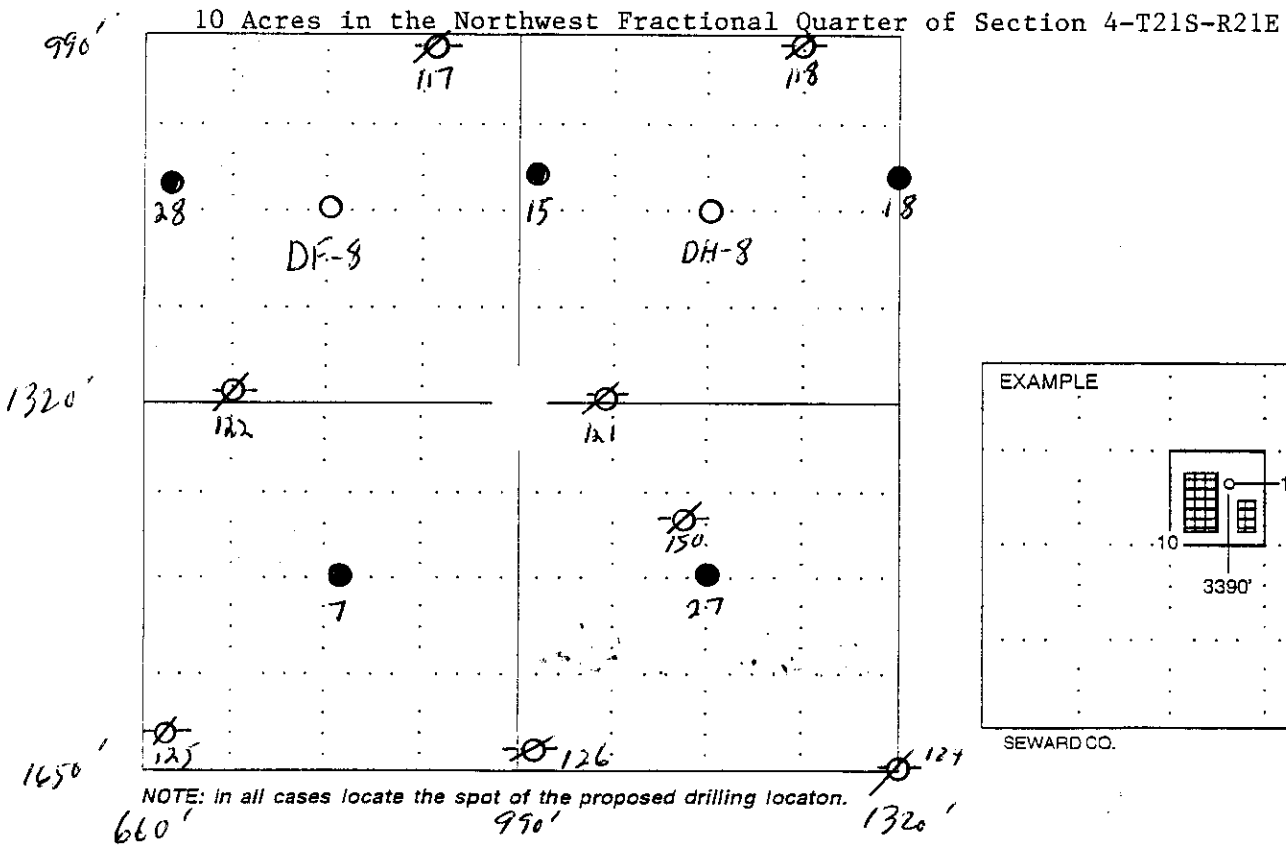

SEWARD CO.

In plotting the proposed location of the well, you must show:

1. The manner in which you are using the depicted plat by identifying section lines, i.e. 1 section, 1 section with 8 surrounding sections, 4 sections, etc.
2. The distance of the proposed drilling location from the section's south / north and east / west.
3. The distance to the nearest lease or unit boundary line.
4. If proposed location is located within a prorated or spaced field a certificate of acreage attribution plat must be attached: (CO-7 for oil wells; CG-8 for gas wells).

KANSAS CORPORATION COMMISSION  
OIL & GAS CONSERVATION DIVISION  
APPLICATION FOR SURFACE PIT

Form CDP-1  
April 2004  
Form must be Typed

Submit in Duplicate

Operator Name: JRC Oil Company, Inc.		License Number: 09267
Operator Address: P. O. Box 426 Garnett, Kansas 66032-0426		
Contact Person: Mike Colvin		Phone Number: ( 785 ) 448-5833
Lease Name & Well No.: Daniel DF-8		Pit Location (QQQQ): NW - NE - SW - NW Sec. 4 Twp. 21 R. 21 <input checked="" type="checkbox"/> East <input type="checkbox"/> West 1485 Feet from <input checked="" type="checkbox"/> North / <input type="checkbox"/> South Line of Section 825 Feet from <input type="checkbox"/> East / <input checked="" type="checkbox"/> West Line of Section Anderson County
Type of Pit: <input type="checkbox"/> Emergency Pit <input type="checkbox"/> Burn Pit <input type="checkbox"/> Settling Pit <input checked="" type="checkbox"/> Drilling Pit <input type="checkbox"/> Workover Pit <input type="checkbox"/> Haul-Off Pit <small>(if WP Supply API No. or Year Drilled)</small>	Pit is: <input checked="" type="checkbox"/> Proposed <input type="checkbox"/> Existing If Existing, date constructed: Pit capacity: 143 (bbls)	
Is the pit located in a Sensitive Ground Water Area? <input type="checkbox"/> Yes <input checked="" type="checkbox"/> No		Chloride concentration: _____ mg/l <small>(For Emergency Pits and Settling Pits only)</small>
Is the bottom below ground level? <input checked="" type="checkbox"/> Yes <input type="checkbox"/> No	Artificial Liner? <input type="checkbox"/> Yes <input checked="" type="checkbox"/> No	How is the pit lined if a plastic liner is not used? Surface Clay
Pit dimensions (all but working pits): 20 Length (feet) 10 Width (feet) _____ N/A: Steel Pits Depth from ground level to deepest point: 4 (feet)		
If the pit is lined give a brief description of the liner material, thickness and installation procedure.		Describe procedures for periodic maintenance and determining liner integrity, including any special monitoring.  None
Distance to nearest water well within one-mile of pit None feet Depth of water well _____ feet		Depth to shallowest fresh water 50 feet. Source of information: <input checked="" type="checkbox"/> measured _____ well owner _____ electric log _____ KDWR
<b>Emergency, Settling and Burn Pits ONLY:</b> Producing Formation: _____ Number of producing wells on lease: _____ Barrels of fluid produced daily: _____ Does the slope from the tank battery allow all spilled fluids to flow into the pit? <input type="checkbox"/> Yes <input type="checkbox"/> No		<b>Drilling, Workover and Haul-Off Pits ONLY:</b> Type of material utilized in drilling/workover: Fresh H2O Number of working pits to be utilized: 2 Abandonment procedure: Backfill with bulldozer. Drill pits must be closed within 365 days of spud date.
I hereby certify that the above statements are true and correct to the best of my knowledge and belief.		
August 8, 2008 Date		Michael S. Colvin, Vice President Signature of Applicant or Agent

RECEIVED  
KANSAS CORPORATION COMMISSION

AUG 13 2008

CONSERVATION DIVISION  
WICHITA, KS

15-003-24587-0000

KCC OFFICE USE ONLY

Date Received: 8/13/08 Permit Number: \_\_\_\_\_ Permit Date: 8/13/08 Lease Inspection:  Yes  No

Mail to: KCC - Conservation Division, 130 S. Market - Room 2078, Wichita, Kansas 67202