

For KCC Use: Effective Date: 8-13-08 District #: 4 SGA? Yes No

KANSAS CORPORATION COMMISSION OIL & GAS CONSERVATION DIVISION

CORRECTED

Form C-1 October 2007 Form must be Typed Form must be Signed All blanks must be Filled

NOTICE OF INTENT TO DRILL

Must be approved by KCC five (5) days prior to commencing well

Expected Spud Date: 08 month 13 day 08 year

OPERATOR: License# 33325 Name: Petroleum Development Corporation Address 1: 1775 Sherman St, Suite 3000 City: Denver State: CO Zip: 80203 Contact Person: James Annable Phone: 303-905-4340 CONTRACTOR: License# 33532 Name: Advanced Drilling Technologies

Spot Description: NW NW NW Sec. 34 Twp. 3 S. R. 42 E W feet from N / S Line of Section feet from E / W Line of Section Is SECTION: Regular Irregular?

County: Cheyenne Lease Name: Rice Well #: 11R-34 Field Name: Cherry Creek Niobrara Gas Area Is this a Prorated / Spaced Field? Yes No Target Formation(s): Niobrara

Well Drilled For: Oil Gas Enh Rec Storage Disposal Seismic Other Well Class: Infield Pool Ext. Wildcat Other Type Equipment: Mud Rotary Air Rotary Cable

Nearest Lease or unit boundary line (in footage): 330' Pooled NWNW per RF 11-34 Ground Surface Elevation: 3653 feet MSL Water well within one-quarter mile: Yes No Public water supply well within one mile: Yes No Depth to bottom of fresh water: 220' Depth to bottom of usable water: 220' Surface Pipe by Alternate: I II Length of Surface Pipe Planned to be set: 270' Length of Conductor Pipe (if any): Not Required Projected Total Depth: 1600' Formation at Total Depth: Niobrara

Operator: Well Name: Original Completion Date: Original Total Depth:

Directional, Deviated or Horizontal wellbore? Yes No If Yes, true vertical depth: Bottom Hole Location:

Water Source for Drilling Operations: Well Farm Pond Other: X DWR Permit #: Drilling Contractor will apply

*WAS: 650' FWL; Length of surface pipe planned: 330' IS: 600' FWL; " " " " " " : 270'

AFFIDAVIT

RECEIVED KANSAS CORPORATION COMMISSION

AUG 13 2008

The undersigned hereby affirms that the drilling, completion and eventual plugging of this well will comply with K.S.A. 55 et. seq. It is agreed that the following minimum requirements will be met:

CONSERVATION DIVISION WICHITA, KS

- 1. Notify the appropriate district office prior to spudding of well; 2. A copy of the approved notice of intent to drill shall be posted on each drilling rig; 3. The minimum amount of surface pipe as specified below shall be set by circulating cement to the top; in all cases surface pipe shall be set through all unconsolidated materials plus a minimum of 20 feet into the underlying formation. 4. If the well is dry hole, an agreement between the operator and the district office on plug length and placement is necessary prior to plugging; 5. The appropriate district office will be notified before well is either plugged or production casing is cemented in; 6. If an ALTERNATE II COMPLETION, production pipe shall be cemented from below any usable water to surface within 120 DAYS of spud date. Or pursuant to Appendix "B" - Eastern Kansas surface casing order #133,891-C, which applies to the KCC District 3 area, alternate II cementing must be completed within 30 days of the spud date or the well shall be plugged. In all cases, NOTIFY district office prior to any cementing.

I hereby certify that the statements made herein are true and correct to the best of my knowledge and belief.

Date: 8/12/2008 Signature of Operator or Agent: Title: Sr. Regulatory Consultant

For KCC Use ONLY API # 15 - 023-21094-0000 Conductor pipe required None feet Minimum surface pipe required 270 feet per ALT. I II Approved by: This authorization expires: 8-8-09 Spud date: Agent:

Remember to: File Drill Pit Application (form CDP-1) with Intent to Drill; File Completion Form ACO-1 within 120 days of spud date; File acreage attribution plat according to field proration orders; Notify appropriate district office 48 hours prior to workover or re-entry; Submit plugging report (CP-4) after plugging is completed (within 60 days); Obtain written approval before disposing or injecting salt water; If this permit has expired (See: authorized expiration date) please check the box below and return to the address below. Well Not Drilled - Permit Expired Date: Signature of Operator or Agent:

CORRECTED

IN ALL CASES PLOT THE INTENDED WELL ON THE PLAT BELOW

Plat of acreage attributable to a well in a prorated or spaced field

If the intended well is in a prorated or spaced field, please fully complete this side of the form. If the intended well is in a prorated or spaced field complete the plat below showing that the well will be properly located in relationship to other wells producing from the common source of supply. Please show all the wells and within 1 mile of the boundaries of the proposed acreage attribution unit for gas wells and within 1/2 mile of the boundaries of the proposed acreage attribution unit for oil wells.

API No. 15 - 15-023-21094-000

Operator: Petroleum Development Corporation

Lease: Rice

Well Number: 11R-34

Field: Cherry Creek Niobrara Gas Area

Number of Acres attributable to well: _____

QTR/QTR/QTR/QTR of acreage: _____ - NW - NW - NW

Location of Well: County: Cheyenne

330 feet from N / S Line of Section

600 feet from E / W Line of Section

Sec. 34 Twp. 3 S. R. 42 E W

Is Section: Regular or Irregular

If Section is Irregular, locate well from nearest corner boundary.

Section corner used: NE NW SE SW

PLAT

(Show location of the well and shade attributable acreage for prorated or spaced wells.)

(Show footage to the nearest lease or unit boundary line.)

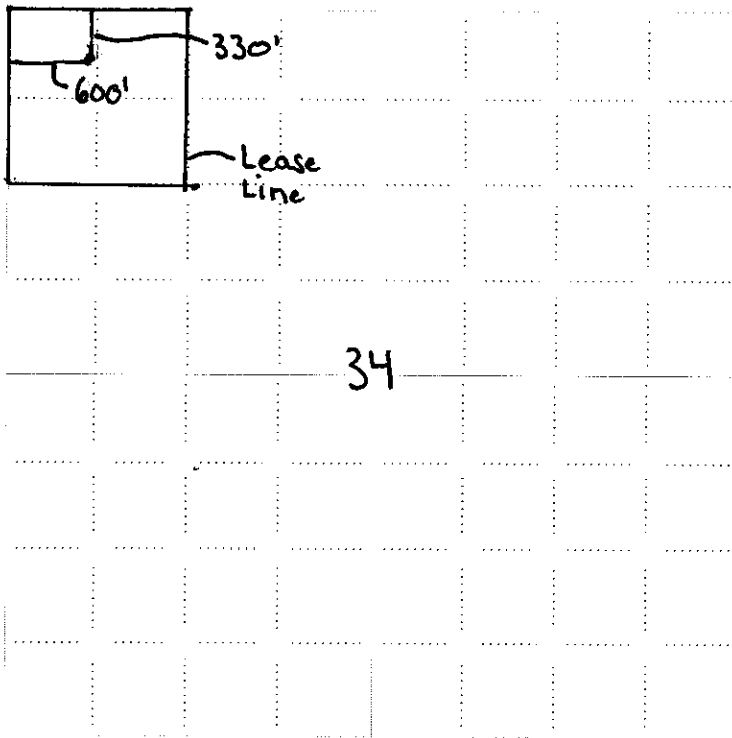

RECEIVED
KANSAS CORPORATION COMMISSION

AUG 13 2008

CONSERVATION DIVISION
WICHITA, KS

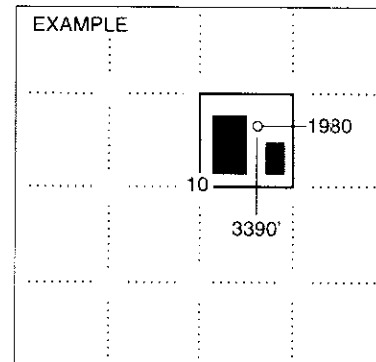

NOTE: In all cases locate the spot of the proposed drilling location.

In plotting the proposed location of the well, you must show:

1. The manner in which you are using the depicted plat by identifying section lines. i.e. 1 section, 1 section with 8 surrounding sections, 4 sections, etc.
2. The distance of the proposed drilling location from the south / north and east / west outside section lines.
3. The distance to the nearest lease or unit boundary line (in footage).
4. If proposed location is located within a prorated or spaced field a certificate of acreage attribution plat must be attached: (CO-7 for oil wells; CG-8 for gas wells).

15-023-21094-0000

WELL LOCATION CERTIFICATE: RICE 11R-34

SECTION 34, TOWNSHIP 3 SOUTH, RANGE 42 WEST, 6TH P.M.

NW SEC 34
CALCULATED
FROM NOTES

S 87°31'19" E 5244.76'

NE SEC 34
CALCULATED
FROM NOTES

RICE 11R-34

SURFACE LOCATION
GROUND ELEVATION= 3653'
NAD27
LATITUDE= 39.75543
LONGITUDE= 102.02838

34

(BASIS OF BEARINGS) SEE NOTE 3
N 03°16'30" E 5320.96'

NOTES:
THIS IS A VERTICAL WELL
LAND SURFACE USE-PASTURE FIELD
GPS OPERATOR: CHRIS PEARSON
NO VISIBLE IMPROVEMENTS WITHIN 200'

M 27°15'20" S

SW SEC 34
3/4" BRASS CAP
BLM

S 7/8 SEC 34
3/4" BRASS CAP
BLM

N 87°29'34" W 2642.24'

N 87°33'25" W 2641.37'

SE SEC 34
FOUND 2 1/2"
PIPE

WELL RICE 11R-34 TO BE LOCATED 330' FNL AND 600' FWL, SECTION 34, T3S, R42W OF THE 6th P.M.

NOTES:

- THIS SURVEY WAS DONE BY GPS METHODS. PDOP VALUE IS LESS THAN 6.0. LATITUDE AND LONGITUDE ARE ACCURATE TO 5 DECIMAL PLACES, AND GPS OBSERVATIONS ARE DIFFERENTIAL AND DONE BY QUALIFIED PERSONNEL.
- ELEVATIONS SHOWN AT THE WELL HEAD, AS WELL AS HORIZONTAL CONTROL, ARE BASED ON GPS-RTK VALUES DERIVED FROM DOING 2-HOUR STATIC GPS SESSIONS AND REDUCTIONS USING OPUS SOLUTIONS
VERTICAL = NAVD88. HORIZONTAL = NAD83/92
- THE BEARINGS SHOWN HEREON ARE BASED ON GPS OBSERVATIONS BETWEEN THE MONUMENTS SHOWN HEREON AS FOUND ON THE FIELD DATE BELOW (KANSAS NORTH ZONE).
- DISTANCES SHOWN ARE AT GROUND LEVEL, AS MEASURED IN THE FIELD, WITH TIES TO WELLS MEASURED AT A PERPENDICULAR TO SECTION LINES
- SURVEY WAS DONE FOR PETROLEUM DEVELOPMENT CORPORATION

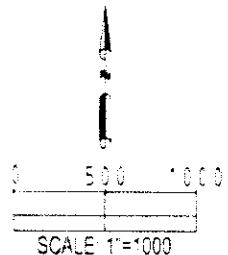

LEGEND

- = EXISTING MONUMENT
- ◆ = BOTTOM HOLE
- BH = BOTTOM HOLE
- = PROPOSED WELL
- ◆ = EXISTING WELL

NOTE: (LATITUDE AND LONGITUDE SHOWN WERE CONVERTED FROM NAD83 USING CORPSSOON 6.0 PROGRAM) PFS DOES NOT WARRANT OR GUARANTEE THEIR ACCURACY

RECEIVED
KANSAS CORPORATION COMMISSION

AUG 13 2008

CONSERVATION DIVISION
WICHITA, KS

<p>PFS Petroleum Field Services, LLC 1501 N. 73rd Ave Derby, KS 67034</p>	DATE OF SURVEY	08-07-08	WELL NAME	RICE 11R-34
	DATE OF FIELD	08-08-08	COUNTY	CHEYENNE COUNTY, KANSAS
	SECTION	CP	SECTION	NW 1/4 NW 1/4, SEC. 34, T3S, R42W

KANSAS CORPORATION COMMISSION
OIL & GAS CONSERVATION DIVISION
APPLICATION FOR SURFACE PIT

CORRECTED

Form CDP-1
April 2004
Form must be Typed

Submit in Duplicate

Operator Name: Petroleum Development Corporation		License Number: 33325	
Operator Address: 1775 Sherman St, Suite 3000		Denver CO 80203	
Contact Person: James Annable		Phone Number: 303-905-4340	
Lease Name & Well No.: Rice 11R-34		Pit Location (QQQQ): _____ NW _____ NW _____ NW Sec. 34 Twp. 3 R. 42 <input type="checkbox"/> East <input checked="" type="checkbox"/> West 330 Feet from <input checked="" type="checkbox"/> North / <input type="checkbox"/> South Line of Section 600 Feet from <input type="checkbox"/> East / <input checked="" type="checkbox"/> West Line of Section Cheyenne County	
Type of Pit: <input type="checkbox"/> Emergency Pit <input type="checkbox"/> Burn Pit <input type="checkbox"/> Settling Pit <input checked="" type="checkbox"/> Drilling Pit <input type="checkbox"/> Workover Pit <input type="checkbox"/> Haul-Off Pit <i>(If WP Supply API No. or Year Drilled)</i>	Pit is: <input checked="" type="checkbox"/> Proposed <input type="checkbox"/> Existing If Existing, date constructed: _____ Pit capacity: 1,200 (bbls)		
Is the pit located in a Sensitive Ground Water Area? <input type="checkbox"/> Yes <input checked="" type="checkbox"/> No		Chloride concentration: _____ mg/l <i>(For Emergency Pits and Settling Pits only)</i>	
Is the bottom below ground level? <input checked="" type="checkbox"/> Yes <input type="checkbox"/> No	Artificial Liner? <input type="checkbox"/> Yes <input checked="" type="checkbox"/> No	How is the pit lined if a plastic liner is not used? Natural Clay/Bentonite	
Pit dimensions (all but working pits): _____ 50 _____ Length (feet) _____ 30 _____ Width (feet) <input type="checkbox"/> N/A: Steel Pits Depth from ground level to deepest point: _____ 6 _____ (feet) <input type="checkbox"/> No Pit			
If the pit is lined give a brief description of the liner material, thickness and installation procedure.		Describe procedures for periodic maintenance and determining liner integrity, including any special monitoring.	
Distance to nearest water well within one-mile of pit _____ 1400 _____ feet Depth of water well _____ 216 _____ feet		Depth to shallowest fresh water _____ 177 _____ feet. Source of information: <input type="checkbox"/> measured <input type="checkbox"/> well owner <input type="checkbox"/> electric log <input checked="" type="checkbox"/> KDWR	
Emergency, Settling and Burn Pits ONLY: Producing Formation: _____ Number of producing wells on lease: _____ Barrels of fluid produced daily: _____ Does the slope from the tank battery allow all spilled fluids to flow into the pit? <input type="checkbox"/> Yes <input type="checkbox"/> No		Drilling, Workover and Haul-Off Pits ONLY: Type of material utilized in drilling/workover: Bentonite mud Number of working pits to be utilized: _____ 1 _____ Abandonment procedure: Evaporation/backfill Drill pits must be closed within 365 days of spud date.	
I hereby certify that the above statements are true and correct to the best of my knowledge and belief.		RECEIVED KANSAS CORPORATION COMMISSION AUG 13 2008 CONSERVATION DIVISION WICHITA, KS	
_____ 8/12/2008 _____ Date		_____ Signature of Applicant or Agent	
KCC OFFICE USE ONLY Steel Pit <input type="checkbox"/> RFAC <input type="checkbox"/> RFAS <input type="checkbox"/>			
Date Received: 8/13/08 Permit Number: _____ Permit Date: 8/13/08 Lease Inspection: <input type="checkbox"/> Yes <input checked="" type="checkbox"/> No			

15-023-21084-0000