

Owwo

For KCC Use: Effective Date: 8-19-08 District # 1 SGA? Yes No

KANSAS CORPORATION COMMISSION OIL & GAS CONSERVATION DIVISION

Form C-1 October 2007 Form must be Typed Form must be Signed All blanks must be Filled

NOTICE OF INTENT TO DRILL

Must be approved by KCC five (5) days prior to commencing well

Expected Spud Date August 24 2008 month day year

OPERATOR: License # 5003 Name: McCoy Petroleum Corporation Address 1: 8080 E. Central, Suite #300 Address 2: City: Wichita State: KS Zip: 67206-2366 Contact Person: Scott Hampel Phone: 316-636-2737 x 104

CONTRACTOR; License # 5142 Name: Sterling Drilling Company

Well Drilled For: Oil Gas Enh Rec Storage Disposal Seismic: # of Holes Other: Well Class: Infield Pool Ext. Wildcat Other: Type Equipment: Mud Rotary Air Rotary Cable

If OWWO: old well information as follows: Operator: McCoy Petroleum Corporation Well Name: STOKES "A" #1-11 (API#:15-135-24366) Original Completion Date: 7/10/05 Original Total Depth: 4478'

Directional, Deviated or Horizontal wellbore? Yes No If Yes, true vertical depth: Bottom Hole Location: KCC DKT #:

Spot Description: NE SW NE Sec 11 Twp. 20 S Rng. 25 E W

1650 feet from N / S Line of Section 1650 feet from E / W Line of Section

Is SECTION: Regular Irregular (Note: Locate well on the Section Plat on reverse side)

County: Ness Lease Name: STOKES "A" OWWO Well #: 1-11 Field Name: Guzzler's Gulch North

Is this a Prorated / Spaced Field? Yes No

Target Information(s): Mississippian Nearest Lease or unit boundary (in footage): 990' Ground Surface Elevation: 2391' feet MSL

Water well within one-quarter mile: Yes No Public water supply well within one mile: Yes No

Depth to bottom of fresh water: 180' Depth to bottom of usable water: 750'

Surface Pipe by Alternate: I II Length of Surface Pipe Planned to be set: 210' Existing

Length of Conductor Pipe (if any): None Projected Total Depth: 4478'

Formation at Total Depth: Mississippian

Water Source for Drilling Operations: Well Farm Pond Other:

DWR Permit #: (Note: Apply for Permit with DWR) Will Cores be taken? Yes No

If Yes, proposed zone: RECEIVED KANSAS CORPORATION COMMISSION

AFFIDAVIT

The undersigned hereby affirms that the drilling, completion and eventual plugging of this well will comply with K.S.A. 55 et. seq. It is agreed that the following minimum requirements will be met:

- 1. Notify the appropriate district office prior to spudding of well;
2. A copy of the approved notice of intent to drill shall be posted on each drilling rig;
3. The minimum amount of surface pipe as specified below shall be set by circulating cement to the top, in all cases surface pipe shall be set through all unconsolidated materials plus a minimum of 20 feet into the underlying formation.
4. If the well is dry hole, an agreement between the operator and the district office on plug length and placement is necessary prior to plugging;
5. The appropriate district office will be notified before well is either plugged or production casing is cemented in;
6. If an ALTERNATE II COMPLETION, production pipe shall be cemented from below any unable water to surface within 120 days of plug date. Or pursuant to Appendix "B" - Eastern Kansas surface casing order #133,891-C, which applies to the KCC District 3 area, alternate II cementing must be completed within 30 days of the spud date or the well shall be plugged. In all cases, NOTIFY district office prior to any cementing.

I hereby certify that the statements made herein are true and to the best of my knowledge and belief. Date: 8/12/08 Signature of Operator or Agent: Scott Hampel Title: Vice President - Production

For KCC Use ONLY API # 15 - 135-24366-00-01 Conductor pipe required None feet Minimum surface pipe required 210 feet per ALT. I II Approved by: [Signature] 8-14-08 This authorization expires: 8-14-09 (This authorization void if drilling not started within 12 months of effective date.) Spud date: Agent:

Remember to: - File Drill Pit Application (form CDP-1) with Intent to Drill; - File Completion Form ACO-1 within 120 days of spud date; - File acreage attribution plat according to field proration orders; - Notify appropriate district office 48 hours prior to workover or re-entry; - Submit plugging report (CP-4) after plugging is completed (within 60 days); - Obtain written approval before disposing or injecting salt water. - If this permit has expired (See: authorized expiration date) please check the box below and return to the address below. Well Not Drilled - Permit Expired Date: Signature of Operator or Agent:

11-20-25

IN ALL CASES PLOT THE INTENDED WELL ON THE PLAT BELOW

Plat of acreage attributable to a well in a prorated or spaced field

If the intended well is in a prorated or spaced field, please fully complete this side of the form. If the intended well is in a prorated or spaced field complete the plat below showing that the well will be properly located in relationship to other wells producing from the common source of supply. Please show all the wells and within 1 mile of the boundaries of the proposed acreage attribution unit for gas wells and within 1/2 mile of the boundaries of the proposed acreage attribution unit for oil wells.

API No. 15 - 135-24366-00-01
 Operator: McCoy Petroleum Corporation
 Lease: STOKES "A" OWWO
 Well Number: #1-11
 Field: Guzzler's Gulch North
 Number of Acres attributable to well: 160
 QTR / QTR / QTR of acreage: NE SW NE

Location of Well: County: Sumner Co., KS
1650 feet from N S (check one) Line of Section
1650 feet from E W (check one) Line of Section
 Sec 11 Twp 20 S. R. 25 East West
 Is Section: Regular Irregular?
 If Section is Irregular, locate well from nearest corner boundary.
 Section corner used: NE NW SE SW

PLAT

*(Show location of the well and shade attributable acreage for prorated or spaced wells)
 (Show footage to the nearest lease or unit boundary fine.)*

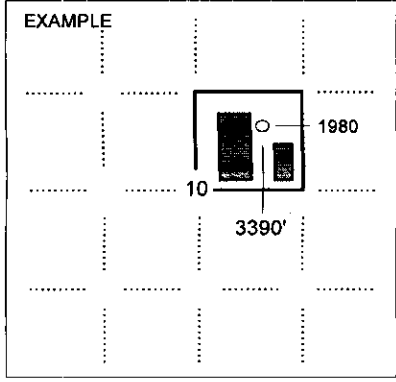
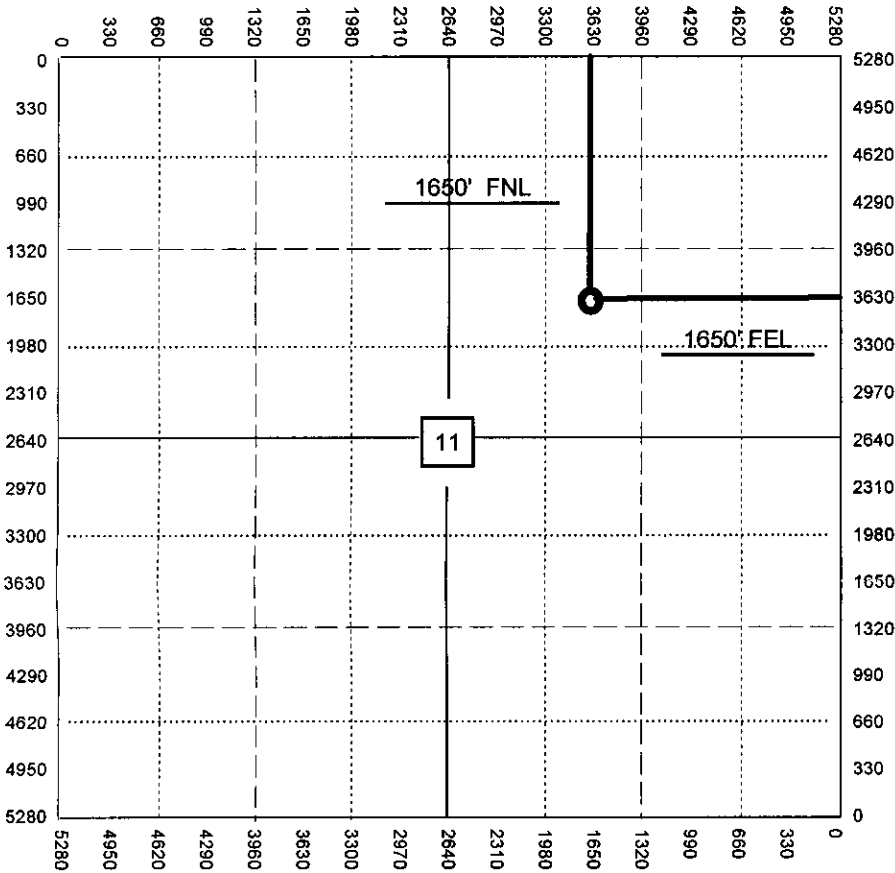

NOTE: In all cases locate the spot of the proposed drilling location.

In plotting the proposed location of the well, you must show.

1. The manner in which you are using the depicted plat by identifying section lines, i.e. 1 section, 1 section with 8 surrounding sections, 4 sections, etc.
2. The distance of the proposed drilling location from the south / north and east / west outside section lines.
3. The distance to the nearest lease or unit boundary line (in footage).
4. If proposed location is located within a prorated or spaced field a certificate of acreage attribution plat must be attached: (CO-7 for oil wells; CG-8 for gas wells).

**KANSAS CORPORATION COMMISSION
OIL & GAS CONSERVATION DIVISION
APPLICATION FOR SURFACE PIT**

Form CDP-1
April 2004
Form must be Typed

Submit in Duplicate

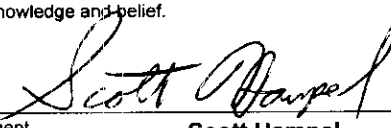
Operator Name: McCoy Petroleum Corporation		License Number: 5003	
Operator Address: 8080 E. Central, Suite #300, Wichita, KS 67206-2366			
Contact Person: Scott Hampel		Phone Number: 316-636-2737x104	
Lease Name & Well No.: STOKES "A" #1-11 OWWO		Pit Location (QQQQ): NE SW NE	
Type of Pit: <input type="checkbox"/> Emergency Pit <input type="checkbox"/> Burn Pit <input type="checkbox"/> Settling Pit <input checked="" type="checkbox"/> Drilling Pit <input type="checkbox"/> Workover Pit <input type="checkbox"/> Haul-Off Pit (If WP Supply API No. or Year Drilled)		Pit is: <input checked="" type="checkbox"/> Proposed <input type="checkbox"/> Existing If Existing, date constructed: _____ Pit capacity: 3600 (bbls)	
Is the pit located in a Sensitive Ground Water Area? <input type="checkbox"/> Yes <input checked="" type="checkbox"/> No		Chloride concentration: _____ mg/l (For Emergency Pits and Settling Pits only)	
Is the bottom below ground level? <input checked="" type="checkbox"/> Yes <input type="checkbox"/> No		Artificial Liner? <input type="checkbox"/> Yes <input checked="" type="checkbox"/> No	
How is the pit lined if a plastic liner is not used? Bentonite / Drilling Mud			
Pit dimensions (all but working pits): 80 Length (feet) 80 Width (feet) N/A : Steel Pits Depth from ground level to deepest point: 4 (feet)			
If the pit is lined give a brief description of the liner material, thickness and installation procedure.		Describe procedures for periodic maintenance and determining liner integrity, including any special monitoring.	
		RECEIVED KANSAS CORPORATION COMMISSION AUG 14 2008 CONSERVATION DIVISION WICHITA, KS	
Distance to nearest water well within one-mile of pit NA 3908 feet Depth of water well NA 30 feet		Depth to shallowest fresh water NA 20 feet. Source of information: <input type="checkbox"/> measured <input checked="" type="checkbox"/> well owner <input type="checkbox"/> electric log <input checked="" type="checkbox"/> KDWR	
Emergency, Settling and Burn Pits ONLY: Producing Formation: _____ Number of producing wells on lease: _____ Barrels of fluid produced daily: _____ Does the slope from the tank battery allow all spilled fluids to flow into the pit? <input type="checkbox"/> Yes <input type="checkbox"/> No		Drilling, Workover and Haul-Off Pits ONLY: Type of material utilized in drilling/workover: Bentonite Number of working pits to be utilized: 3 Abandonment procedure: Evaporate and let dry, backfill and return location to original condition. Drill pits must be closed within 365 days of spud date.	
I hereby certify that the above statements are true and correct to the best of my knowledge and belief.			
Date: 8/12/08		Signature of Applicant or Agent:  Scott Hampel	
KCC OFFICE USE ONLY			
Date Received: 8/14/08 Permit Number: _____ Permit Date: 8/14/08 Lease Inspection: <input type="checkbox"/> Yes <input checked="" type="checkbox"/> No			

15-135-2436600-01

Mail to: KCC - Conservation Division, 130 S. Market - Room 2078, Wichita, Kansas 67202

STATE OF KANSAS
STATE CORPORATION COMMISSION
130 S. Market, Room 2078
Wichita, Kansas 67202

Well Plugging Record

K.A.R. -82-3-117

RECEIVED

JUL 14 2005

KCC WICHITA

API NUMBER 15-135-24366-00-00
LEASE NAME Stokes 'A'
WELL NUMBER No. 1-11

TYPE OR PRINT

NOTICE: Fill out completely and return
to Cons. Div. office within 30 days.

1650 Ft. from North Line of Section
1650 Ft. from East Line of Section

LEASE OPERATOR McCoy Petroleum Corporation SPOT LOCATION NE SW NE
ADDRESS 8080 E. Central, Ste 300 Section 11 Township 20s Range 25w
CITY, STATE, ZIP Wichita, Kansas 67206 County Ness
PHONE # 316-636-2737 Date Well Completed 07/10/05
Character of Well Dry and Abandoned Date Plugging Commenced 07/10/05
(Oil, Gas, D&A, SWD, Input, Water Supply Well) Date Plugging Completed 07/10/05

The plugging proposal was approved on July 8, 2005 (date)
by Jerry Stapleton (KCC District Agent's Name)
Is ACO-1 Filed? ? If not, is well log attached? Yes
Producing Formation(s) D&A Depth to Top Bottom T.D. 4478
Show depth and thickness of all water, oil and gas formations.

OIL, GAS OR WATER RECORDS

CASING RECORD

FORMATION	CONTENT	FROM	TO	SIZE	PUT IN	PULL OUT
Surface Soil, Sands and Clay		0	170	8-5/8"	210'	0

Describe in detail the manner in which the well was plugged, indicating where the mud fluid was placed and the method or methods used in introducing it into the hole. If cement or other plugs were used, state the character of same and depth placed, from _____ feet to _____ feet each set.

Plugging orders received from Jerry Stapleton on 07/08/05. Plugged using 205 sx of; 60/40 Poz, 6% Gel and 1/4#/sx Flow Seal as follows: Heavy mud in hole, Bottom plug 50 sx @ 1680', 2nd plug 80 sx @ 810', 3rd plug 40 sx @ 240', top plug 10 sx @ 40' cemented to surface. Plugged rathole with 15 sx, mousehole with 10 sx. Plugging completed at 6:00 am on 07/10/05 by Allied Cementing. Ticket # 17988.

Name of Plugging Contractor Sterling Drilling Company
Licence No. 5142
Address P.O. Box 1006 City: Pratt State: Kansas Zip 67124
NAME OF PARTY RESPONSIBLE FOR PLUGGING FEES: McCoy Petroleum Corporation (Operator)

STATE OF KANSAS COUNTY OF PRATT, ss.

Gary M. Talbott, Agent (Employee of Operator or (Operator) of above described well, being first duly sworn on oath, says: That I have knowledge of the facts, statements, and matters herein contained and the log of the above described well as filed that the same are true and correct, so help me God.

(Signature) Gary M. Talbott
(Gary M. Talbott, Vice- President of Sterling Drilling Company)

(Address) P.O. Box 1006 City: Pratt State: Kansas Zip 67124

SUBSCRIBED AND SWORN TO me this 13th day of July, 2005

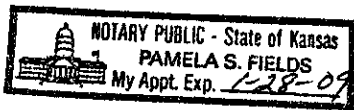

Pamela S. Fields
(Notary Public)

My Commission Expires:

Form CP-4
Revised 12-92

Bo

**NOTICE TO OPERATORS FILING INTENT TO DRILL
FOR DISPOSAL OR ENHANCED RECOVERY
INJECTION WELLS, (CLASS II INJECTION WELL)**

The attached approved Notice of Intent to Drill indicates the proposed well is to be used for injection. An approved "Intent to Drill" does not approve injection authority as a Class II Injection Well in Kansas.

Before any well is used for injection purposes, the operator must file an application for injection authority in accordance with K.A.R. 82-3-401 and provide notice in accordance with K.A.R. 82-3-402. The Conservation Division must issue a written permit granting the application before commencement of injection.

The Conservation Division requirements and restrictions associated with Class II Injection are identified in **K.A.R. 82-3-400 et seq** of our regulations. Associated regulations governing drilling, completion and injection applications may be found in K.A.R. 82-3-135, Table I, Table II, in the Cedar Hills Sandstone Moratorium, (Docket #156,397-C), and the Eastern Kansas Surface Casing Order, (Docket #133,891-C).

If you have questions regarding the approval of injection authority, an injection application may be filed as a "Design Approval" before actual drilling and completion of the well occurs. If you have any questions or concerns regarding Class II injection wells or regulations, call the Underground Injection Control Department at 316-337-6200.

Failure to obtain commission approval before beginning injection is punishable by a penalty, shut-in of the well or both.