

For KCC Use: 8-23-08
 Effective Date: _____
 District # 2
 SGA? Yes No

KANSAS CORPORATION COMMISSION
 OIL & GAS CONSERVATION DIVISION

Form C-1
 October 2007
Form must be Typed
Form must be Signed
All blanks must be Filled

NOTICE OF INTENT TO DRILL

Must be approved by KCC five (5) days prior to commencing well

Expected Spud Date: 7 20 2008
 month day year

OPERATOR: License# 5091 ✓
 Name: Howell Oil Co., Inc.
 Address 1: 2400 Riverbirch Rd.
 Address 2: _____
 City: Hutchinson State: KS. Zip: 67502
 Contact Person: Larry Ressler
 Phone: 620-664-0597
 CONTRACTOR: License# 33724
 Name: Warren Energy

Spot Description: _____
 SW - NE - SE - Sec. 13 Twp. 23 S. R. 4 E W
 (or) 1,430 feet from N / S Line of Section
825 feet from E / W Line of Section
 Is SECTION: Regular Irregular?

(Note: Locate well on the Section Plat on reverse side)
 County: Reno
 Lease Name: Dole Well #: 6
 Field Name: Burton
 Is this a Prorated / Spaced Field? Yes No
 Target Formation(s): Mississippi - Arbuckle
 Nearest Lease or unit boundary line (in footage): 1210
 Ground Surface Elevation: 1466 feet MSL
 Water well within one-quarter mile: Yes No
 Public water supply well within one mile: Yes No
 Depth to bottom of fresh water: 220 ft. 230
 Depth to bottom of usable water: 220 ft. 230
 Surface Pipe by Alternate: I II
 Length of Surface Pipe Planned to be set: _____
 Length of Conductor Pipe (if any): 250 ft. 10 3/4 minimum
 Projected Total Depth: 4450 250 off
 Formation at Total Depth: Arbuckle
 Water Source for Drilling Operations:
 Well Farm Pond Other: _____
 DWR Permit #: _____ (Note: Apply for Permit with DWR)
 Will Cores be taken? Yes No
 If Yes, proposed zone: _____

Well Drilled For: Oil Gas Seismic Other: _____
 Enh Rec Storage # of Holes _____
 Well Class: Infield Pool Ext. Wildcat Other: _____
 Type Equipment: Mud Rotary Air Rotary Cable
 If OWWO: old well information as follows:
 Operator: _____
 Well Name: _____
 Original Completion Date: _____ Original Total Depth: _____

Directional, Deviated or Horizontal wellbore? Yes No
 If Yes, true vertical depth: _____
 Bottom Hole Location: _____
 KCC DKT #: _____

Table I, Appendix A exception granted.

AFFIDAVIT

RECEIVED
 KANSAS CORPORATION COMMISSION

MAY 20 2008

The undersigned hereby affirms that the drilling, completion and eventual plugging of this well will comply with K.S.A. 55 et. seq.
 It is agreed that the following minimum requirements will be met:

1. Notify the appropriate district office **prior** to spudding of well;
2. A copy of the approved notice of intent to drill **shall be** posted on each drilling rig;
3. The minimum amount of surface pipe as specified below **shall be set** by circulating cement to the top; in all cases surface pipe shall be set through all unconsolidated materials plus a minimum of 20 feet into the underlying formation.
4. If the well is dry hole, an agreement between the operator and the district office on plug length and placement is necessary **prior to plugging**;
5. The appropriate district office will be notified before well is either plugged or production casing is cemented in;
6. If an ALTERNATE II COMPLETION, production pipe shall be cemented from below any usable water to surface within **120 DAYS** of spud date. Or pursuant to Appendix "B" - Eastern Kansas surface casing order #133,891-C, which applies to the KCC District 3 area, alternate II cementing must be completed within 30 days of the spud date or the well shall be plugged. **In all cases, NOTIFY district office** prior to any cementing.

I hereby certify that the statements made herein are true and correct to the best of my knowledge and belief.

Date: 5-18-2008 Signature of Operator or Agent: Larry Ressler Title: Agent

For KCC Use ONLY
 API # 15 - 155-21543-0000
 Conductor pipe required 250 feet
 Minimum surface pipe required 250 feet per ALT. I II
 Approved by: RWR 8-18-08
 This authorization expires: 8-18-09
 (This authorization void if drilling not started within 12 months of approval date.)
 Spud date: _____ Agent: _____

Remember to:
 - File Drill Pit Application (form CDP-1) with Intent to Drill;
 - File Completion Form ACO-1 within 120 days of spud date;
 - File acreage attribution plat according to field proration orders;
 - Notify appropriate district office 48 hours prior to workover or re-entry;
 - Submit plugging report (CP-4) after plugging is completed (within 60 days);
 - Obtain written approval before disposing or injecting salt water.
 - If this permit has expired (See: authorized expiration date) please check the box below and return to the address below.
 Well Not Drilled - Permit Expired Date: _____
 Signature of Operator or Agent: _____

13
23
4
 E
 W

IN ALL CASES PLOT THE INTENDED WELL ON THE PLAT BELOW

Plat of acreage attributable to a well in a prorated or spaced field

If the intended well is in a prorated or spaced field, please fully complete this side of the form. If the intended well is in a prorated or spaced field complete the plat below showing that the well will be properly located in relationship to other wells producing from the common source of supply. Please show all the wells and within 1 mile of the boundaries of the proposed acreage attribution unit for gas wells and within 1/2 mile of the boundaries of the proposed acreage attribution unit for oil wells.

API No. 15 - 155-21543-0000
 Operator: Howell Oil Co., Inc.
 Lease: Dole
 Well Number: 6
 Field: Burton
 Number of Acres attributable to well: 10
 QTR/QTR/QTR/QTR of acreage: SW - NE - SE -

Location of Well: County: Reno
 1,430 feet from N / S Line of Section
 825 feet from E / W Line of Section
 Sec. 13 Twp. 23 S. R. 4 E W

Is Section: Regular or Irregular

If Section is Irregular, locate well from nearest corner boundary.

Section corner used: NE NW SE SW

PLAT

(Show location of the well and shade attributable acreage for prorated or spaced wells.)

(Show footage to the nearest lease or unit boundary line.)

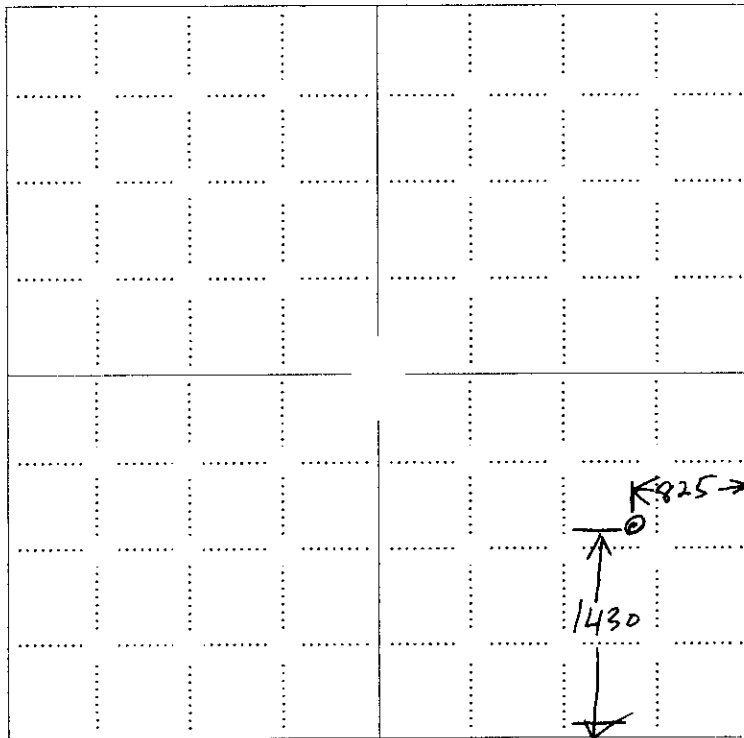

NOTE: In all cases locate the spot of the proposed drilling location.

RECEIVED
 KANSAS CORPORATION COMMISSION
 MAY 20 2008
 CONSERVATION DIVISION
 WICHITA, KS

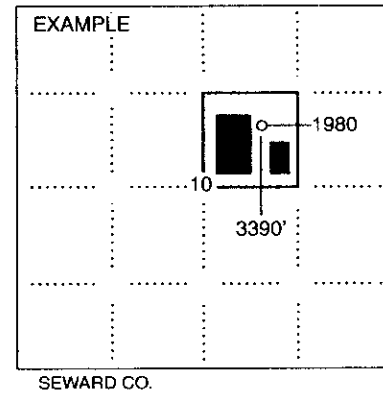

In plotting the proposed location of the well, you must show:

1. The manner in which you are using the depicted plat by identifying section lines, i.e. 1 section, 1 section with 8 surrounding sections, 4 sections, etc.
2. The distance of the proposed drilling location from the south / north and east / west outside section lines.
3. The distance to the nearest lease or unit boundary line (in footage).
4. If proposed location is located within a prorated or spaced field a certificate of acreage attribution plat must be attached: (C0-7 for oil wells; CG-8 for gas wells).

**KANSAS CORPORATION COMMISSION
OIL & GAS CONSERVATION DIVISION
APPLICATION FOR SURFACE PIT**

Form CDP-1
April 2004
Form must be Typed

Submit in Duplicate

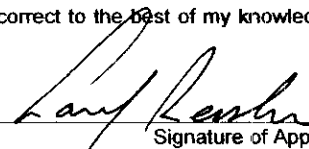
Operator Name: Howell Oil Co., Inc.		License Number: 5091
Operator Address: 2400 Riverbirch Rd.		Hutchinson KS. 67502
Contact Person: Larry Ressler		Phone Number: 620-664-0597
Lease Name & Well No.: Dole 6		Pit Location (QQQQ): <u>SW NE SE</u>
Type of Pit: <input type="checkbox"/> Emergency Pit <input type="checkbox"/> Burn Pit <input type="checkbox"/> Settling Pit <input checked="" type="checkbox"/> Drilling Pit <input type="checkbox"/> Workover Pit <input type="checkbox"/> Haul-Off Pit <small>(If WP Supply API No. or Year Drilled)</small>	Pit is: <input checked="" type="checkbox"/> Proposed <input type="checkbox"/> Existing If Existing, date constructed: Pit capacity: 5,000 (bbls)	Sec. <u>13</u> Twp. <u>23</u> R. <u>4</u> <input type="checkbox"/> East <input checked="" type="checkbox"/> West <u>1,430</u> Feet from <input type="checkbox"/> North / <input checked="" type="checkbox"/> South Line of Section <u>825</u> Feet from <input checked="" type="checkbox"/> East / <input type="checkbox"/> West Line of Section Reno County
Is the pit located in a Sensitive Ground Water Area? <input checked="" type="checkbox"/> Yes <input type="checkbox"/> No		Chloride concentration: _____ mg/l <small>(For Emergency Pits and Settling Pits only)</small>
Is the bottom below ground level? <input checked="" type="checkbox"/> Yes <input type="checkbox"/> No	Artificial Liner? <input type="checkbox"/> Yes <input checked="" type="checkbox"/> No	How is the pit lined if a plastic liner is not used? Bentonite, drilling solids and native clay
Pit dimensions (all but working pits): <u>100</u> Length (feet) <u>100</u> Width (feet) <input type="checkbox"/> N/A: Steel Pits Depth from ground level to deepest point: <u>3</u> (feet) <input type="checkbox"/> No Pit		
If the pit is lined give a brief description of the liner material, thickness and installation procedure.		Describe procedures for periodic maintenance and determining liner integrity, including any special monitoring.
		RECEIVED MAY 20 2008 KANSAS CORPORATION COMMISSION CONSERVATION DIVISION WICHITA, KS
Distance to nearest water well within one-mile of pit <u>990</u> feet Depth of water well <u>60</u> feet	Depth to shallowest fresh water <u>15</u> feet. Source of information: <input checked="" type="checkbox"/> measured <input type="checkbox"/> well owner <input type="checkbox"/> electric log <input type="checkbox"/> KDWR	
Emergency, Settling and Burn Pits ONLY: Producing Formation: _____ Number of producing wells on lease: _____ Barrels of fluid produced daily: _____ Does the slope from the tank battery allow all spilled fluids to flow into the pit? <input type="checkbox"/> Yes <input type="checkbox"/> No	Drilling, Workover and Haul-Off Pits ONLY: Type of material utilized in drilling/workover: <u>Chemical mud</u> Number of working pits to be utilized: <u>3</u> Abandonment procedure: <u>Empty, allow to dry completely & backfill</u> Drill pits must be closed within 365 days of spud date.	
I hereby certify that the above statements are true and correct to the best of my knowledge and belief.		
<u>5-18-08</u> Date	 Signature of Applicant or Agent	

15-155-21543-0000

KCC OFFICE USE ONLY		Steel Pit <input type="checkbox"/>	RFAC <input type="checkbox"/>	RFAS <input checked="" type="checkbox"/>
Date Received: <u>5/20/08</u>	Permit Number: _____	Permit Date: <u>8/13/08</u>	Lease Inspection: <input checked="" type="checkbox"/> Yes <input type="checkbox"/> No	

Mail to: KCC - Conservation Division, 130 S. Market - Room 2078, Wichita, Kansas 67202



Kathleen Sebelius, Governor
Thomas E. Wright, Chairman
Michael C. Moffet, Commissioner
Joseph F. Harkins, Commissioner

August 13, 2008

Mr. Larry Ressler
Howell Oil Co., Inc.
2400 Riverbirch Rd
Hutchinson, KS 67502

Re: Drilling Pit Application
Dole Lease Well No. 6
SE/4 Sec. 13-23S-04W
Reno County, Kansas

Dear Mr. Ressler:

District staff has inspected the above referenced location and has determined that the reserve pit shall be constructed **without slots**, the bottom shall be flat and reasonably level, and **all pits must be lined with bentonite**. The free fluids must be removed. The fluids are to be removed from the reserve pit as soon as the Hutchinson Salt section has been drilled through and displacement of the fluids into the reserve pit has occurred. The fluids should be removed again within 72 hours after drilling operations have ceased.

If production casing is set all completion fluids shall be removed from the working pits daily. NO completion fluids or non-exempt wastes shall be placed in the reserve pit.

The fluids should be taken to an authorized disposal well. Please call the District Office at (316) 630-4000 when the fluids have been removed. Please file form CDP-5 (August 2004), Exploration and Production Waste Transfer, within 30 days of fluid removal. Conservation division forms are available through our office and on the KCC web site:
www.kcc.state.ks.us/conservation/forms.

A copy of this letter should be posted in the doghouse along with the approved Intent to Drill. If you have any questions or concerns please feel free to contact the undersigned at the above address.

Sincerely,

Kathy Haynes
Environmental Protection and Remediation Department

cc: File

Ressler Well Service, Inc.

P.O. Box 525, Burrton, Ks. 67020

Shop Phone-620-463-2202 / Cell-620-664-0597 / Fax-620-463-2566

Kansas Corporation Commission- Conservation Division

Mr. Doug Louis

Mr. Rick Hesterman

RE: Dole # 6 1430' FSL, 825' FEL Sec. 13-T23S-R4W

Asking for an exemption for the above referenced well to Table 1, AppendixA Conductor pipe requirement of 12" or larger. 10 3/4" 32 lb. casing I.D. is approximately 10.192" which would allow adequate clearance to run 8 5/8 O.D. casing if needed. Thank You for consideration of this matter.

Larry Ressler- Howell Oil Co., Inc.

RECEIVED
KANSAS CORPORATION COMMISSION

MAY 20 2008

CONSERVATION DIVISION
WICHITA, KS

August 14, 2008

Larry Ressler
Howell Oil Co., Inc.
2400 Riverbirch Rd.
Hutchinson, KS 67502

RE: Dole #5, 1756' FSL, 1694' FEL Sec. 13-T23S-R4W
Dole #6, 1430' FSL, 825' FEL Sec. 13-T23S-R4W

Dear Mr. Ressler:

The Kansas Corporation Commission (KCC) received your request on May 20, 2008 for an exception to Table 1, Appendix A Conductor pipe requirement for the above-referenced wells. From your request, the KCC understands that Howell Oil Co., Inc. is requesting to run 10-3/4", 32 lb. conductor casing rather than 12" conductor casing as required in Table 1, Appendix A. Your request states that 8-5/8" casing can be run inside the 10-3/4" if needed.

After review of this matter by technical staff it was determined that the 10-3/4", 32 lb. casing I.D. is approximately 10.192", which would allow adequate clearance to run 8-5/8" O.D. casing if needed.

Based on this information, an exception is granted for the Table 1, Appendix A Conductor Pipe requirements and 10-3/4" 32 lb. conductor may be used in place of 12" conductor at the referenced locations.

Sincerely,

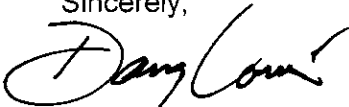

Doug Louis
Director

cc: Steve Bond ~~SK~~
Jeff Klock - Dist #2 ✓ via e-mail 8-14-08

CONSERVATION DIVISION

Finney State Office Building, 130 S. Market, Room 2078, Wichita, KS 67202-3802

(316) 337-6200 • Fax: (316) 337-6211 • <http://kcc.ks.gov/>