

For KCC Use: 8-25-08
 Effective Date: _____
 District #: _____
 SGA? Yes No

KANSAS CORPORATION COMMISSION
 OIL & GAS CONSERVATION DIVISION

Form C-1
 October 2007
Form must be Typed
Form must be Signed
All blanks must be Filled

NOTICE OF INTENT TO DRILL

Must be approved by KCC five (5) days prior to commencing well

Expected Spud Date: September 9 2008
 month day year

Spot Description: _____
 _____ NE _____ SW _____ NW _____ Sec. 14 Twp. 6 S. R. 22 E W
 (0000) 1,650 feet from N / S Line of Section
990 feet from E / W Line of Section

Is SECTION: Regular Irregular?

(Note: Locate well on the Section Plat on reverse side)

County: Graham

Lease Name: Pakkebie Farms Well #: 12-14

Field Name: _____

Is this a Prorated / Spaced Field? Yes No

Target Formation(s): Lansing Kansas City

Nearest Lease or unit boundary line (in footage): 990 fwl

Ground Surface Elevation: 2328 feet MSL

Water well within one-quarter mile: Yes No

Public water supply well within one mile: Yes No

Depth to bottom of fresh water: 180 ft

Depth to bottom of usable water: 1150 ft

Surface Pipe by Alternate: I II

Length of Surface Pipe Planned to be set: 250

Length of Conductor Pipe (if any): none

Projected Total Depth: 4000'

Formation at Total Depth: Arbuckle

Water Source for Drilling Operations:

Well Farm Pond Other: _____

DWR Permit #: _____

(Note: Apply for Permit with DWR)

Will Cores be taken? Yes No

If Yes, proposed zone: _____

OPERATOR: License# 34038 ✓

Name: Flatirons Resources LLC

Address 1: 303 E. 17th Ave

Address 2: Suite 940

City: Denver State: CO Zip: 80203 + _____

Contact Person: Jeffery E. Jones

Phone: (303) 292-3902 ext 224

CONTRACTOR: License# 33493 ✓

Name: American Eagle Drilling, LLC

Well Drilled For: Well Class: Type Equipment:

Oil Gas Seismic; _____ # of Holes Other: _____
 Enh Rec Storage Disposal Infield Pool Ext. Wildcat Other _____
 Mud Rotary Air Rotary Cable

If OWWO: old well information as follows:

Operator: _____

Well Name: _____

Original Completion Date: _____ Original Total Depth: _____

Directional, Deviated or Horizontal wellbore? Yes No

If Yes, true vertical depth: _____

Bottom Hole Location: _____

KCC DKT #: _____

RECEIVED
 KANSAS CORPORATION COMMISSION

AUG 20 2008

CONSERVATION DIVISION
 WICHITA, KS

AFFIDAVIT

The undersigned hereby affirms that the drilling, completion and eventual plugging of this well will comply with K.S.A. 55 et. seq.

It is agreed that the following minimum requirements will be met:

1. Notify the appropriate district office **prior** to spudding of well;
2. A copy of the approved notice of intent to drill **shall be posted** on each drilling rig;
3. The minimum amount of surface pipe as specified below **shall be set** by circulating cement to the top; in all cases surface pipe **shall be set** through all unconsolidated materials plus a minimum of 20 feet into the underlying formation.
4. If the well is dry hole, an agreement between the operator and the district office on plug length and placement is necessary **prior to plugging**;
5. The appropriate district office will be notified before well is either plugged or production casing is cemented in;
6. If an ALTERNATE II COMPLETION, production pipe shall be cemented from below any usable water to surface within **120 DAYS** of spud date. Or pursuant to Appendix "B" - Eastern Kansas surface casing order #133,891-C, which applies to the KCC District 3 area, alternate II cementing must be completed within 30 days of the spud date or the well shall be plugged. **In all cases, NOTIFY district office** prior to any cementing.

I hereby certify that the statements made herein are true and correct to the best of my knowledge and belief.

Date: 8/19/2008 Signature of Operator or Agent: Barry R Lager Title: Reg. Explor. Manager

For KCC Use ONLY

API # 15 - 005-23468-0000

Conductor pipe required None feet

Minimum surface pipe required 230 feet per ALT. I II

Approved by: RWA 8-20-08

This authorization expires: 8-20-09
 (This authorization void if drilling not started within 12 months of approval date.)

Spud date: _____ Agent: _____

Remember to:

- File Drill Pit Application (form CDP-1) with Intent to Drill;
- File Completion Form ACO-1 within 120 days of spud date;
- File acreage attribution plat according to field proration orders;
- Notify appropriate district office 48 hours prior to workover or re-entry;
- Submit plugging report (CP-4) after plugging is completed (within 60 days);
- Obtain written approval before disposing or injecting salt water.
- If this permit has expired (See: authorized expiration date) please check the box below and return to the address below.

Well Not Drilled - Permit Expired Date: _____
 Signature of Operator or Agent: _____

14
6
22
 E
 W

IN ALL CASES PLOT THE INTENDED WELL ON THE PLAT BELOW

Plat of acreage attributable to a well in a prorated or spaced field

If the intended well is in a prorated or spaced field, please fully complete this side of the form. If the intended well is in a prorated or spaced field complete the plat below showing that the well will be properly located in relationship to other wells producing from the common source of supply. Please show all the wells and within 1 mile of the boundaries of the proposed acreage attribution unit for gas wells and within 1/2 mile of the boundaries of the proposed acreage attribution unit for oil wells.

API No. 15 - 065-23468-0000
 Operator: Flatirons Resources LLC
 Lease: Pakkebie Farms
 Well Number: 12-14
 Field: _____

Number of Acres attributable to well: _____
 QTR/QTR/QTR/QTR of acreage: _____ - NE - SW - NW

Location of Well: County: Graham
 _____ feet from N / S Line of Section
 _____ feet from E / W Line of Section
 Sec. 14 Twp. 6 S. R. 22 E W

Is Section: Regular or Irregular

If Section is Irregular, locate well from nearest corner boundary.

Section corner used: NE NW SE SW

PLAT

*(Show location of the well and shade attributable acreage for prorated or spaced wells.)
 (Show footage to the nearest lease or unit boundary line.)*

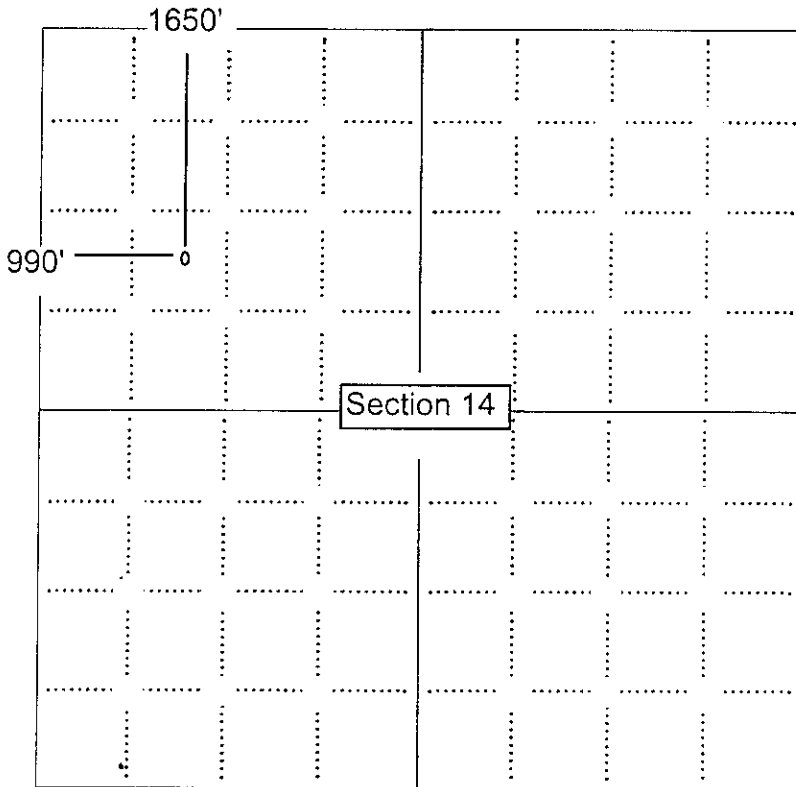

NOTE: In all cases locate the spot of the proposed drilling location.

RECEIVED
 KANSAS CORPORATION COMMISSION
AUG 20 2008
 CONSERVATION DIVISION
 WICHITA, KS

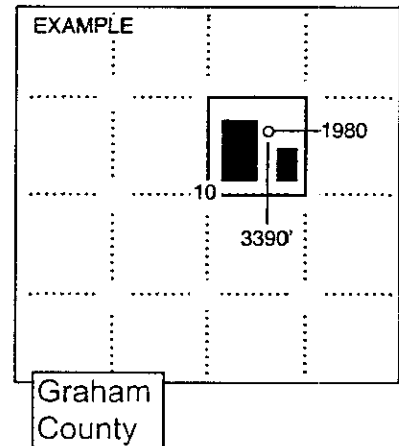

In plotting the proposed location of the well, you must show:

1. The manner in which you are using the depicted plat by identifying section lines, i.e. 1 section, 1 section with 8 surrounding sections, 4 sections, etc.
2. The distance of the proposed drilling location from the south / north and east / west outside section lines.
3. The distance to the nearest lease or unit boundary line (in footage).
4. If proposed location is located within a prorated or spaced field a certificate of acreage attribution plat must be attached: (CO-7 for oil wells; CG-8 for gas wells).

**KANSAS CORPORATION COMMISSION
OIL & GAS CONSERVATION DIVISION
APPLICATION FOR SURFACE PIT**

Form CDP-1
April 2004
Form must be Typed

Submit in Duplicate

Operator Name: Flatirons Resources LLC		License Number: 34038	
Operator Address: 303 E. 17th Ave		Suite 940 Denver CO 80203	
Contact Person: Jeffery E. Jones		Phone Number: (303) 292-3902 ext 224	
Lease Name & Well No.: Pakkebier Farms 12-14		Pit Location (QQQQ): _____ NE _____ SW _____ NW Sec. 14 Twp. 6 R. 22 <input type="checkbox"/> East <input checked="" type="checkbox"/> West 1,650 Feet from <input checked="" type="checkbox"/> North / <input type="checkbox"/> South Line of Section 990 Feet from <input type="checkbox"/> East / <input checked="" type="checkbox"/> West Line of Section Graham _____ County	
Type of Pit: <input type="checkbox"/> Emergency Pit <input type="checkbox"/> Burn Pit <input type="checkbox"/> Settling Pit <input checked="" type="checkbox"/> Drilling Pit <input type="checkbox"/> Workover Pit <input type="checkbox"/> Haul-Off Pit (If WP Supply API No. or Year Drilled)		Pit is: <input checked="" type="checkbox"/> Proposed <input type="checkbox"/> Existing If Existing, date constructed: _____ Pit capacity: _____ (bbls)	
Is the pit located in a Sensitive Ground Water Area? <input type="checkbox"/> Yes <input checked="" type="checkbox"/> No		Chloride concentration: _____ mg/l <i>(For Emergency Pits and Settling Pits only)</i>	
Is the bottom below ground level? <input checked="" type="checkbox"/> Yes <input type="checkbox"/> No		Artificial Liner? <input type="checkbox"/> Yes <input checked="" type="checkbox"/> No	
Pit dimensions (all but working pits): _____ 30 _____ Length (feet) _____ 10 _____ Width (feet) _____ N/A: Steel Pits Depth from ground level to deepest point: _____ 6 _____ (feet) _____ No Pit		How is the pit lined if a plastic liner is not used? Natural gumbo seal	
If the pit is lined give a brief description of the liner material, thickness and installation procedure.		Describe procedures for periodic maintenance and determining liner integrity, including any special monitoring. Daily inspection when drilling / periodic inspection following drilling operations	
Distance to nearest water well within one-mile of pit _____ 3577 _____ feet Depth of water well _____ 160 _____ feet		Depth to shallowest fresh water _____ 75 _____ feet. Source of information: <input type="checkbox"/> measured <input type="checkbox"/> well owner <input type="checkbox"/> electric log <input checked="" type="checkbox"/> KDWR	
Emergency, Settling and Burn Pits ONLY: Producing Formation: _____ Number of producing wells on lease: _____ Barrels of fluid produced daily: _____ Does the slope from the tank battery allow all spilled fluids to flow into the pit? <input type="checkbox"/> Yes <input type="checkbox"/> No		Drilling, Workover and Haul-Off Pits ONLY: Type of material utilized in drilling/workover: drilling mud & water Number of working pits to be utilized: _____ 2 _____ Abandonment procedure: remove mud from drill site, let water evaporate, back fill when dry Drill pits must be closed within 365 days of spud date.	

I hereby certify that the above statements are true and correct to the best of my knowledge and belief.

8/19/2008
Date

Barry R Leyer
Signature of Applicant or Agent

RECEIVED
KANSAS CORPORATION COMMISSION
AUG 20 2008
CONSERVATION DIVISION
WICHITA, KS

KCC OFFICE USE ONLY

Steel Pit RFAC RFAS

Date Received: 8/20/08 Permit Number: _____ Permit Date: 8/20/08 Lease Inspection: Yes No

Mail to: KCC - Conservation Division, 130 S. Market - Room 2078, Wichita, Kansas 67202

15-005-23468-0000