

For KCC Use: 8-31-08
 Effective Date: 3
 District # _____
 SGA? Yes No

KANSAS CORPORATION COMMISSION
 OIL & GAS CONSERVATION DIVISION
NOTICE OF INTENT TO DRILL

Form C-1
 December 2002
Form must be Typed
Form must be Signed
All blanks must be Filled

Must be approved by KCC five (5) days prior to commencing well

Expected Spud Date September 4, 2008
 month day year

OPERATOR: License# 33074
 Name: Dart Cherokee Basin Operating Co. LLC
 Address: 211 W. Myrtle
 City/State/Zip: Independence KS 67301
 Contact Person: Bill Barks
 Phone: 620-331-7870

CONTRACTOR: License# 5675
 Name: McPherson Drilling

Well Drilled For:	Well Class:	Type Equipment:
<input type="checkbox"/> Oil	<input type="checkbox"/> Enh Rec	<input type="checkbox"/> Infield
<input checked="" type="checkbox"/> Gas	<input type="checkbox"/> Storage	<input checked="" type="checkbox"/> Pool Ext.
<input type="checkbox"/> OWWO	<input type="checkbox"/> Disposal	<input type="checkbox"/> Wildcat
<input type="checkbox"/> Seismic; # of Holes _____	<input type="checkbox"/> Other _____	<input type="checkbox"/> Mud Rotary
<input type="checkbox"/> Other _____		<input checked="" type="checkbox"/> Air Rotary
		<input type="checkbox"/> Cable

If OWWO: old well information as follows:
 Operator: _____
 Well Name: _____
 Original Completion Date: _____ Original Total Depth: _____

Directional, Deviated or Horizontal wellbore? Yes No
 If Yes, true vertical depth: _____
 Bottom Hole Location: _____
 KCC DKT #: _____

Spot East
 C SE NE Sec. 26 Twp. 29 S. R. 15E West
3300 FSL feet from N / S Line of Section
660 FEL feet from E / W Line of Section
 Is SECTION Regular Irregular?

(Note: Locate well on the Section Plat on reverse side)
 County: Wilson
 Lease Name: Frankenbery Well #: B4-26
 Field Name: Cherokee Basin Coal Gas Area
 Is this a Prorated / Spaced Field? Yes No
 Target Information(s): Mississippian
 Nearest Lease or unit boundary: 660 feet
 Ground Surface Elevation: 988 feet MSL
 Water well within one-quarter mile: Yes No
 Public water supply well within one mile: Yes No
 Depth to bottom of fresh water: 175 / 100
 Depth to bottom of usable water: 200 / 150
 Surface Pipe by Alternate: 1 2
 Length of Surface Pipe Planned to be set: 40'
 Length of Conductor Pipe required: _____
 Projected Total Depth: 1538 feet
 Formation at Total Depth: Mississippian
 Water Source for Drilling Operations:
 Well Farm Pond Other _____
 DWR Permit #: _____

(Note: Apply for Permit with DWR)
 Will Cores be taken? Yes No
 If Yes, proposed zone: _____

AFFIDAVIT

RECEIVED

The undersigned hereby affirms that the drilling, completion and eventual plugging of this well will comply with K.S.A. 55 et. seq. It is agreed that the following minimum requirements will be met:

AUG 26 2008

KANSAS CORPORATION COMMISSION
 CONSERVATION DIVISION
 WICHITA, KS

1. Notify the appropriate district office **prior** to spudding of well;
2. A copy of the approved notice of intent to drill **shall be** posted on each drilling rig;
3. The minimum amount of surface pipe as specified below **shall be set** by circulating cement to the top; in all cases surface pipe shall be set through all unconsolidated materials plus a minimum of 20 feet into the underlying formation.
4. If the well is dry hole, an agreement between the operator and the district office on plug length and placement is necessary **prior to plugging**;
5. The appropriate district office will be notified before well is either plugged or production casing is cemented in;
6. If an ALTERNATE II COMPLETION, production pipe shall be cemented from below any usable water to surface within **120 days** of spud date. Or pursuant to Appendix "B" - Eastern Kansas surface casing order #133,891-C, which applies to the KCC District 3 area, alternate II cementing must be completed within 30 days of the spud date or the well shall be plugged. **In all cases, NOTIFY district office** prior to any cementing.

I hereby certify that the statements made herein are true and to the best of my knowledge and belief.

Date: August 25, 2008 Signature of Operator or Agent: Will Barks Title: Operations Manager

For KCC Use ONLY
 API # 15 - 205-27652-0000
 Conductor pipe required None feet
 Minimum surface pipe required 20 feet per Alt. 10 2
 Approved by: RWA 8-26-08
 This authorization expires: 8-26-09
 (This authorization void if drilling not started within 6 months of effective date.)
 Spud date: _____ Agent: _____

Remember to:

- File Drill Pit Application (form CDP-1) with Intent to Drill;
- File Completion Form ACO-1 within 120 days of spud date;
- File acreage attribution plat according to field proration orders;
- Notify appropriate district office 48 hours prior to workover or re-entry;
- Submit plugging report (CP-4) after plugging is completed;
- Obtain written approval before disposing or injecting salt water.

Well Not Drilled - Permit Expired

Signature of Operator or Agent: _____
 Date: _____

26 29 15E

IN ALL CASES PLOT THE INTENDED WELL ON THE PLAT BELOW

Plat of acreage attributable to a well in a prorated or spaced field

If the intended well is in a prorated or spaced field, please fully complete this side of the form. If the intended well is in a prorated or spaced field complete the plat below showing that the well will be properly located in relationship to other wells producing from the common source of supply. Please show all the wells and within 1 mile of the boundaries of the proposed acreage attribution unit for gas wells and within 1/2 mile of the boundaries of the proposed acreage attribution unit for oil wells.

API No. 15 - 205-27652-0000
 Operator: Dart Cherokee Basin Operating Co. LLC
 Lease: Frankenberg
 Well Number: B4-26
 Field: Cherokee Basin Coal Gas Area
 Number of Acres attributable to well: 40
 QTR / QTR / QTR of acreage: C - SE - NE

Location of Well: County: Wilson
3300 FSL feet from N / S Line of Section
660 FEL feet from E / W Line of Section
 Sec. 26 Twp. 29 S. R. 15E East West

Is Section: Regular or Irregular

If Section Is Irregular, locate well from nearest corner boundary.

Section corner used: NE NW SE SW

PLAT

*(Show location of the well and shade attributable acreage for prorated or spaced wells.)
 (Show footaae to the nearest lease or unit boundary line.)*

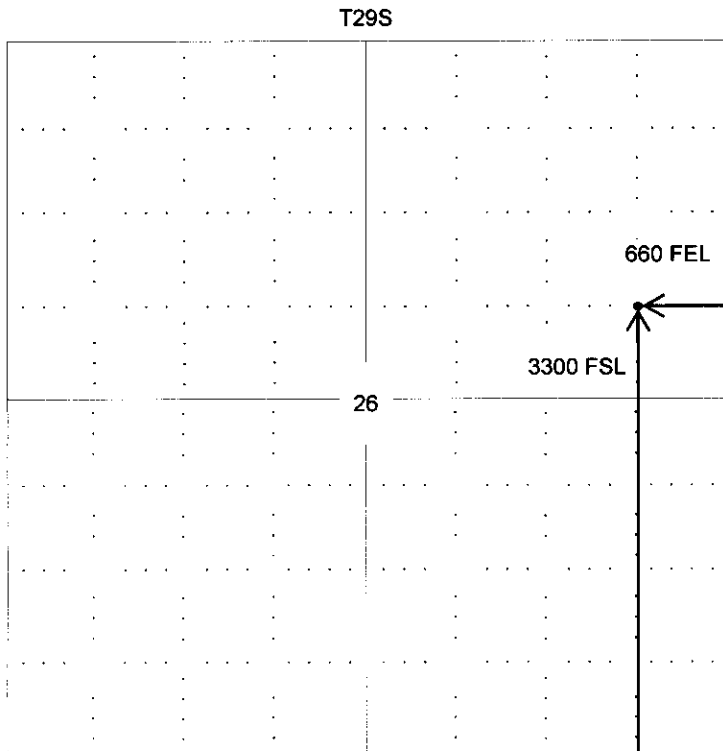

NOTE: In all cases locate the spot of the proposed drilling locaton.

R15E

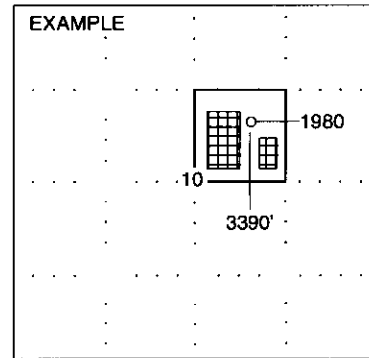

Wilson Co.

RECEIVED
 KANSAS CORPORATION COMMISSION
AUG 26 2008
 CONSERVATION DIVISION
 WICHITA, KS

In plotting the proposed location of the well, you must show:

1. The manner in which you are using the depicted plat by identifying section lines, i.e. 1 section, 1 section with 8 surrounding sections, 4 sections, etc.
2. The distance of the proposed drilling location from the section's south / north and east / west.
3. The distance to the nearest lease or unit boundary line.
4. If proposed location is located within a prorated or spaced field a certificate of acreage attribution plat must be attached: (CO-7 for oil wells; CG-8 for gas wells).

**KANSAS CORPORATION COMMISSION
OIL & GAS CONSERVATION DIVISION
APPLICATION FOR SURFACE PIT**

Form CDP-1
April 2004
Form must be Typed

Submit in Duplicate

Operator Name: Dart Cherokee Basin Operating Co. LLC		License Number: 33074
Operator Address: 211 W. Myrtle		Independence KS 67301
Contact Person: Bill Barks		Phone Number: (620) 331 -7870
Lease Name & Well No.: Frankenberg B4-26		Pit Location (QQQQ): C SE NE Sec. 26 Twp. 29 R. 15E <input checked="" type="checkbox"/> East <input type="checkbox"/> West 3300 FSL Feet from <input type="checkbox"/> North / <input checked="" type="checkbox"/> South Line of Section 660 FEL Feet from <input checked="" type="checkbox"/> East / <input type="checkbox"/> West Line of Section Wilson County
Type of Pit: <input type="checkbox"/> Emergency Pit <input type="checkbox"/> Burn Pit <input type="checkbox"/> Settling Pit <input checked="" type="checkbox"/> Drilling Pit <input type="checkbox"/> Workover Pit <input type="checkbox"/> Haul-Off Pit <small>(If WP Supply API No. or Year Drilled)</small>	Pit is: <input checked="" type="checkbox"/> Proposed <input type="checkbox"/> Existing If Existing, date constructed: Pit capacity: 926 (bbls)	
Is the pit located in a Sensitive Ground Water Area? <input type="checkbox"/> Yes <input checked="" type="checkbox"/> No		Chloride concentration: _____ mg/l <small>(For Emergency Pits and Settling Pits only)</small>
Is the bottom below ground level? <input checked="" type="checkbox"/> Yes <input type="checkbox"/> No	Artificial Liner? <input type="checkbox"/> Yes <input checked="" type="checkbox"/> No	How is the pit lined if a plastic liner is not used? Natural Clays
Pit dimensions (all but working pits): 35 Length (feet) 30 Width (feet) N/A: Steel Pits Depth from ground level to deepest point: 5 (feet)		
If the pit is lined give a brief description of the liner material, thickness and installation procedure.		Describe procedures for periodic maintenance and determining liner integrity, including any special monitoring.
Distance to nearest water well within one-mile of pit N/A feet Depth of water well _____ feet	Depth to shallowest fresh water _____ feet. Source of information: _____ measured _____ well owner _____ electric log _____ KDWR	
Emergency, Settling and Burn Pits ONLY: Producing Formation: _____ Number of producing wells on lease: _____ Barrels of fluid produced daily: _____ Does the slope from the tank battery allow all spilled fluids to flow into the pit? <input type="checkbox"/> Yes <input type="checkbox"/> No	Drilling, Workover and Haul-Off Pits ONLY: Type of material utilized in drilling/workover: Air Number of working pits to be utilized: one Abandonment procedure: Air dry, fill Drill pits must be closed within 365 days of spud date.	
I hereby certify that the above statements are true and correct to the best of my knowledge and belief.		RECEIVED KANSAS CORPORATION COMMISSION
August 25, 2008 Date	<i>Bill Barks</i> Signature of Applicant or Agent	AUG 26 2008 CONSERVATION DIVISION WICHITA, KS

15-2005-27652-000

KCC OFFICE USE ONLY		
Date Received: 8/26/08	Permit Number: _____	Permit Date: 8/26/08 Lease Inspection: <input type="checkbox"/> Yes <input checked="" type="checkbox"/> No

Mail to: KCC - Conservation Division, 130 S. Market - Room 2078, Wichita, Kansas 67202

KCC -- Conservation Division Forms -- 11/01/2007Internet KCC Home Page -- <http://kcc.ks.gov>Conservation Division Home Page -- <http://kcc.ks.gov/conservation/index.htm>Conservation Division Forms -- <http://kcc.ks.gov/conservation/forms/index.htm>**ADOBE FILL-IN FORM ON INTERNET**

FORM DATE

General Administrative

- 09/2005 ■ License Application OPL-1
- 04/2004 ■ Request for Change of Operator; Transfer of Injection or Surface Pit Permit T-1

Well Permitting

- 10/2007 ■ Notice of Intent to Drill C-1 Please use updated form on future filings.
- 04/2004 ■ Application for Surface Pit CDP-1
- 12/1993 ■ Cathodic Protection Borehole Intent to Drill CB-1

Well Completion Reports and Other Well Application

- 09/1999 ■ Well Completion Form ACO-1
- 09/2005 ■ Commingling Application ACO-4
- 05/1988 ■ Dual Completion Report ACO-5
- 09/2005 ■ Well Location Exception Application Check List ACO-17
- 09/2005 ■ Venting-Flaring of Gas ACO-18
- 09/2005 ■ Extended Gas Venting Affidavit CG-3
- 09/2005 ■ Coalbed Natural Gas Venting Affidavit CG-4
- 10/2004 ■ Temporary Abandonment Application CP-111
- 09/2003 ■ Verified Affidavit For Vacuum Operations V-1

Surface Pits and Waste Transfer

- 04/2004 ■ Application for Surface Pit CDP-1
- 04/2004 ■ Closure of Surface Pit CDP-4
- 04/2004 ■ Exploration and Production Waste Transfer CDP-5

Well Plugging Report

- 09/2003 ■ Well Plugging Application CP-1
- 12/2003 ■ Well Plugging Record CP-4
- 08/2003 ■ Seismic Hole Affidavit

Oil & Gas Well Testing Report

- 10/1996 ■ Oil Productivity Test & GOR Report C-5
- 10/1996 ■ Multi-Point Back Pressure Test CG-1
- 07/2003 ■ One Point Stabilized Open Flow or Deliverability Test G-2

Gas Gathering Report

- 04/1998 ■ Gas Gathering Report GG-1
- 04/1998 ■ Gas Gathering Segment Report GG-1a

Oil and Gas Producer's Report

- 06/1989 ■ Summary of Oil Producers Report CO-8, CO-8A
- 08/2000 ■ Gas Producer/Purchaser Monthly Report CG-7, CG-7A

Acreage Attribution and Well Spacing Report

- 12/1994 ■ Oil Acreage Attribution Plat CO-7
- 12/1994 ■ Gas Acreage Attribution Plat CG-8
- 05/1989 ■ Application for Well Spacing ACO-7

New Pool and Certificate of Enhancement Projects (Severance Tax Exemptions) Request

- 10/2005 ■ New Pool Determination-Discovery Allowable ACO-16
- 10/1999 ■ Application for Enhanced Recovery Project Certification CER-1, and
Calculation Sheet Base Production Calculation and Certification CER 1-A

Underground Injection Control Report

- 07/2003 ■ UTC Application U-1
- 07/2003 ■ Annual Report U3-C. This form is required on an annual basis due each March 1.
- 07/2003 ■ Notice of Injection (of commencement or termination of injection) U-5
- 07/2003 ■ Application to Amend Injection Order U-8
- 07/2003 ■ Notice to Modify Injection Order U-9

Wireline Service

- 08/2003 ■ Monthly Wireline Service Company Report MWSC-1