

ORIGINAL

RECEIVED  
KANSAS CORPORATION COMMISSION

KANSAS CORPORATION COMMISSION  
OIL & GAS CONSERVATION DIVISION  
WELL COMPLETION FORM  
WELL HISTORY - DESCRIPTION OF WELL & LEASE

JAN 08 2007

Form ACO-1  
September 1999  
Form Must Be Typed

CONSERVATION DIVISION  
WICHITA, KS

Operator: License # 32309  
Name: Presco Western, LLC  
Address: 5480 Valmont, Ste. 350  
City/State/Zip: Boulder, CO 80301  
Purchaser: Plains Marketing LP - Oil OneOK - Gas  
Operator Contact Person: Leonard Witkowski  
Phone: (303) 444-8881  
Contractor Name: Cheyenne Drilling LP  
License: 33375  
Wellsite Geologist: Boulder Office

Designate Type of Completion:  
 New Well  Re-Entry  Workover  
 Oil  SWD  SLOW  Temp. Abd.  
 Gas  ENHR  SIGW  
 Dry  Other (Core, WSW, Expl., Cathodic, etc)

If Workover/Re-entry: Old Well Info as follows:  
Operator: \_\_\_\_\_  
Well Name: \_\_\_\_\_  
Original Comp. Date: \_\_\_\_\_ Original Total Depth: \_\_\_\_\_  
 Deepening  Re-perf.  Conv. to Enhr./SWD  
 Plug Back \_\_\_\_\_ Plug Back Total Depth \_\_\_\_\_  
 Commingled \_\_\_\_\_ Docket No. \_\_\_\_\_  
 Dual Completion \_\_\_\_\_ Docket No. \_\_\_\_\_  
 Other (SWD or Enhr.?) \_\_\_\_\_ Docket No. \_\_\_\_\_

7/21/2006      7/29/2006      12/07/2006  
Spud Date or      Date Reached TD      Completion Date or  
Recompletion Date                Recompletion Date

API No. 15 - 081-21668-00-00  
County: Haskell  
NW SE SE Sec. 19 Twp. 30 S. R. 32  East  West  
1241 feet from S N (circle one) Line of Section  
1312 feet from E W (circle one) Line of Section

Footages Calculated from Nearest Outside Section Corner:  
(circle one) NE SE NW SW  
Lease Name: Hoffman Well #: 3-O19-30-32  
Field Name: Unnamed

Producing Formation: Morrow/St. Louis  
Elevation: Ground: 2901 Kelly Bushing: 2913  
Total Depth: 5796 Plug Back Total Depth: \_\_\_\_\_  
Amount of Surface Pipe Set and Cemented at 1684 Feet  
Multiple Stage Cementing Collar Used?  Yes  No  
If yes, show depth set \_\_\_\_\_ Feet  
If Alternate II completion, cement circulated from \_\_\_\_\_  
feet depth to \_\_\_\_\_ w/ \_\_\_\_\_ sx cmt.

Drilling Fluid Management Plan ALT I WAN  
(Data must be collected from the Reserve Pit) 8-27-07  
Chloride content 8500 ppm Fluid volume 1000 bbls  
Dewatering method used Air Evaporation  
Location of fluid disposal if hauled offsite: \_\_\_\_\_  
Operator Name: \_\_\_\_\_  
Lease Name: \_\_\_\_\_ License No.: \_\_\_\_\_  
Quarter \_\_\_\_\_ Sec. \_\_\_\_\_ Twp. \_\_\_\_\_ S. R. \_\_\_\_\_  East  West  
County: \_\_\_\_\_ Docket No.: \_\_\_\_\_

**INSTRUCTIONS:** An original and two copies of this form shall be filed with the Kansas Corporation Commission, 130 S. Market - Room 2078, Wichita, Kansas 67202, within 120 days of the spud date, recompletion, workover or conversion of a well. Rule 82-3-130, 82-3-106 and 82-3-107 apply. Information of side two of this form will be held confidential for a period of 12 months if requested in writing and submitted with the form (see rule 82-3-107 for confidentiality in excess of 12 months). One copy of all wireline logs and geologist well report shall be attached with this form. ALL CEMENTING TICKETS MUST BE ATTACHED. Submit CP-4 form with all plugged wells. Submit CP-111 form with all temporarily abandoned wells.

All requirements of the statutes, rules and regulations promulgated to regulate the oil and gas industry have been fully complied with and the statements herein are complete and correct to the best of my knowledge.

Signature: \_\_\_\_\_  
Title: Regulatory Specialist Date: 12/28/2006

Subscribed and sworn to before me this 28<sup>th</sup> day of December

2006  
Notary Public: \_\_\_\_\_  
Date Commission Expires: 4-7-09

JENNIFER THOMAS  
Notary Public  
State of Colorado

KCC Office Use ONLY  
4 Letter of Confidentiality Received  
If Denied, Yes  Date: 1-16-07  
 Wireline Log Received  
 Geologist Report Received  
 UIC Distribution

Operator Name: Presco Western, LLC Lease Name: Hoffman Well #: 3-O19-30-32  
 Sec. 19 Twp. 30 S. R. 32  East  West County: Haskell

**INSTRUCTIONS:** Show important tops and base of formations penetrated. Detail all cores. Report all final copies of drill stems tests giving interval tested, time tool open and closed, flowing and shut-in pressures, whether shut-in pressure reached static level, hydrostatic pressures, bottom hole temperature, fluid recovery, and flow rates if gas to surface test, along with final chart(s). Attach extra sheet if more space is needed. Attach copy of all Electric Wireline Logs surveyed. Attach final geological well site report.

Drill Stem Tests Taken <input type="checkbox"/> Yes <input checked="" type="checkbox"/> No <i>(Attach Additional Sheets)</i>  Samples Sent to Geological Survey <input checked="" type="checkbox"/> Yes <input type="checkbox"/> No  Cores Taken <input type="checkbox"/> Yes <input checked="" type="checkbox"/> No  Electric Log Run <input checked="" type="checkbox"/> Yes <input type="checkbox"/> No <i>(Submit Copy)</i>  List All E. Logs Run:  Compensated Neutron/SDD Log, Dual Induction Log, Borehole Compensated Sonic w/ITT log, Cement Bond Log GR/CCL/LOG	<input checked="" type="checkbox"/> Log Formation (Top), Depth and Datum <input type="checkbox"/> Sample  <table border="0" style="width:100%"> <tr> <td style="width:60%">Name</td> <td style="width:20%">Top</td> <td style="width:20%">Datum</td> </tr> <tr> <td>Heebner</td> <td>4143</td> <td>-1230</td> </tr> <tr> <td>Lansing</td> <td>4246</td> <td>-1333</td> </tr> <tr> <td>Kansas City</td> <td>4702</td> <td>-1789</td> </tr> <tr> <td>Marmaton</td> <td>4837</td> <td>-1924</td> </tr> <tr> <td>Pawnee</td> <td>4952</td> <td>-2039</td> </tr> <tr> <td>Ft. Scott</td> <td>4996</td> <td>-2083</td> </tr> <tr> <td>Morrow</td> <td>5333</td> <td>-2420</td> </tr> <tr> <td>St Genevieve</td> <td>5508</td> <td>-2595</td> </tr> </table>	Name	Top	Datum	Heebner	4143	-1230	Lansing	4246	-1333	Kansas City	4702	-1789	Marmaton	4837	-1924	Pawnee	4952	-2039	Ft. Scott	4996	-2083	Morrow	5333	-2420	St Genevieve	5508	-2595
Name	Top	Datum																										
Heebner	4143	-1230																										
Lansing	4246	-1333																										
Kansas City	4702	-1789																										
Marmaton	4837	-1924																										
Pawnee	4952	-2039																										
Ft. Scott	4996	-2083																										
Morrow	5333	-2420																										
St Genevieve	5508	-2595																										

CASING RECORD <input checked="" type="checkbox"/> New <input type="checkbox"/> Used							
Report all strings set-conductor, surface, intermediate, production, etc.							
Purpose of String	Size Hole Drilled	Size Casing Set (In O.D.)	Weight Lbs./ Ft.	Setting Depth	Type of Cement	# Sacks Used	Type and Percent Additives
Surface	12-1/4"	8-5/8"	23 STC R3	1682	Comm/Lite	150/575	3%CC/3%CC, 1/4#floseal
Production	7-7/8"	5-1/2"	15.5 LTC R3	5784	ASC	220	10%seal, 5#Gil, 5%FL160, 2% gel

ADDITIONAL CEMENTING / SQUEEZE RECORD				
Purpose:	Depth Top Bottom	Type of Cement	#Sacks Used	Type and Percent Additives
<input type="checkbox"/> Perforate <input type="checkbox"/> Protect Casing <input type="checkbox"/> Plug Back TD <input checked="" type="checkbox"/> Plug Off Zone	5325-5796	Comm	50	3%CC

**RECEIVED**  
**KANSAS CORPORATION COMMISSION**  
**JAN 08 2007**  
**CONSERVATION DIVISION**  
**WICHITA, KS**

Shots Per Foot	PERFORATION RECORD - Bridge Plugs Set/Type Specify Footage of Each Interval Perforated	Acid, Fracture, Shot, Cement Squeeze Record (Amount and Kind of Material Used)	Depth
4	5487-5494 Chester; 5461-5466 Chester; 5386-5399 Morrow	2000g 15%NEFE; 30 bbls 2% flush (packer set at 5475 & 5366)	
4	4742-4758 KC B	2000g 15%NEFE; 30 bbls 2% flush (retainer set at 5325)	

TUBING RECORD		Size	Set At	Packer At	Liner Run
		2.875	5305	5325	<input type="checkbox"/> Yes <input checked="" type="checkbox"/> No
Date of First, Resumerd Production, SWD or Enhr. 8/21/2006			Producing Method		
			<input type="checkbox"/> Flowing <input checked="" type="checkbox"/> Pumping <input type="checkbox"/> Gas Lift <input type="checkbox"/> Other (Explain)		
Estimated Production Per 24 Hours	Oil Bbls.	Gas Mcf	Water Bbls.	Gas-Oil Ratio	Gravity
	0	0	0	NA	NA

Disposition of Gas      METHOD OF COMPLETION      Production Interval

Vented    Sold    Used on Lease     
  Open Hole    Perf.    Dually Comp.    Commingled  
*(If vented, Submit ACO-18.)*     
  Other (Specify) \_\_\_\_\_

RECEIVED  
 KANSAS CORPORATION COMMISSION  
 JAN 08 2007  
 CONSERVATION DIVISION  
 WICHITA, KS

# ALLIED CEMENTING CO., INC. 24968

Federal Tax I.D. \_\_\_\_\_

SHIP TO P.O. BOX 31  
 RUSSELL, KANSAS 67665

SERVICE POINT:  
Oakley, KS

DATE 7-22-06	SEC 1A	TWP 30s	RANGE 3240	CALLED OUT	ON LOCATION 9:30am	JOB START 11:00am	JOB FINISH 5:00am
LEASE Hoskman # 30-19	WELL.# 30-32	LOCATION Sublot 35-1c-1125	COUNTY Haskell	STATE KS			
OLD OR <u>NEW</u> (Circle one)				Wino			

CONTRACTOR Cheyenne #16 OWNER Same  
 TYPE OF JOB Surface  
 HOLE SIZE 12 1/4 T.D. 1704  
 CASING SIZE 8 5/8 23' DEPTH 1704  
 TUBING SIZE \_\_\_\_\_ DEPTH \_\_\_\_\_  
 DRILL PIPE \_\_\_\_\_ DEPTH \_\_\_\_\_  
 TOOL \_\_\_\_\_ DEPTH \_\_\_\_\_  
 PRES. MAX \_\_\_\_\_ MINIMUM \_\_\_\_\_  
 MEAS. LINE \_\_\_\_\_ SHOE JOINT 40  
 CEMENT LEFT IN CSG. 40  
 PERFS. \_\_\_\_\_  
 DISPLACEMENT 105.97

CEMENT AMOUNT ORDERED 150 com 39acc  
575 lite 39acc - 1 1/4" Class seal

COMMON	150	@	12 <sup>00</sup>	1830 <sup>00</sup>
POZMIX		@		
GEL		@		
CHLORIDE	24	@	46 <sup>00</sup>	1104 <sup>00</sup>
ASC		@		
Lite	575	@	61 <sup>00</sup>	6497 <sup>00</sup>
Class seal	144 <sup>#</sup>	@	2 <sup>00</sup>	288 <sup>00</sup>
HANDLING	779	@	1 <sup>90</sup>	1480 <sup>10</sup>
MILEAGE	0850	@	2181 <sup>20</sup>	
				TOTAL 13395 <sup>00</sup>

EQUIPMENT  
 PUMP TRUCK CEMENTER Fuzzy/max  
 # 102 HELPER Tarred  
 BULK TRUCK  
 # 344 DRIVER Larry  
 BULK TRUCK  
 # 347 DRIVER Wayne

REMARKS:  
Cement did circulate  
Approx 100 bags  
Plug down @ 5:00 am  
@ 900' + hold + slot in  
Thanks Fuzzy crew

SERVICE

DEPTH OF JOB	1704		
PUMP TRUCK CHARGE		@	1800 <sup>00</sup>
EXTRA FOOTAGE		@	
MILEAGE	35	@	520 <sup>00</sup>
MANIFOLD + head		@	175 <sup>00</sup>
TOTAL 2175 <sup>00</sup>			

CHARGE TO: Presco-Western LLC  
 STREET \_\_\_\_\_  
 CITY \_\_\_\_\_ STATE \_\_\_\_\_ ZIP \_\_\_\_\_

PLUG & FLOAT EQUIPMENT

1 - Guide shoe			235 <sup>00</sup>
1 - ASU Insul (B)	@		325 <sup>00</sup>
4 - Cent	@	55 <sup>00</sup>	220 <sup>00</sup>
1 - Bag Kit	@		180 <sup>00</sup>
1 - rubber plug	@		100 <sup>00</sup>
TOTAL 1060 <sup>00</sup>			

To Allied Cementing Co., Inc. \_\_\_\_\_  
 You are hereby requested to rent cementing equipment and furnish cementer and helper to assist owner or contractor to do work as is listed. The above work was done to satisfaction and supervision of owner agent or contractor. I have read & understand the "TERMS AND CONDITIONS" listed on the reverse side.

SIGNATURE Rodney Gonzales

TAX \_\_\_\_\_  
 TOTAL CHARGE \_\_\_\_\_  
 DISCOUNT \_\_\_\_\_ IF PAID IN 30 DAYS  
 PRINTED NAME Rodney Gonzales

# ALLIED CEMENTING CO., INC.

RECEIVED KANSAS CORPORATION COMMISSION

24 JAN 8 2007

Federal Tax I.D. [ ]

REMIT TO P.O. BOX 31  
RUSSELL, KANSAS 67665

SERVICE POINT: CONSERVATION DIVISION  
OAKLEY, KS WICHITA, KS

DATE	7-30-06	SEC	19	TWP	30	RANGE	32	CALLED OUT		ON LOCATION	3:30pm	JOB START	3:30pm	JOB FINISH	1:45AM
LEASE	Hoffman	WELL #	43	LOCATION	Sublette 3 side 1/2 S			COUNTY	Haskell	STATE	KS				
OLD OR NEW (Circle one)	NEW														

CONTRACTOR Cherokee Dab #16 OWNER same

TYPE OF JOB	Production 54 ins
HOLE SIZE	5 7/8 T.D. 5798
CASING SIZE	5 1/2 I.S. DEPTH 5798
TUBING SIZE	DEPTH
DRILL PIPE	DEPTH
TOOL	DEPTH
PRES. MAX	MINIMUM
MEAS. LINE	SHOE JOINT 42 1/2
CEMENT LEFT IN CSG.	42 lb
PERFS.	
DISPLACEMENT	136.99 BBLs

CEMENT	
AMOUNT ORDERED	220 ASC
	2 1/2 gal 10% salt, 54 1/2 1/2 gal
	1 1/2 gal 10% FL 160

EQUIPMENT	
PUMP TRUCK	CEMENTER <u>Tussy Max</u>
#	<u>102</u> HELPER <u>Tarrod</u>
BULK TRUCK	
#	<u>218</u> DRIVER <u>Larry</u>
BULK TRUCK	
#	DRIVER

COMMON	@		
POZMIX	@	16 65	66 60
GEL	4 @	16 20	66 60
CHLORIDE	@		
ASC	220 @	14 20	3124 00
Salt	1100 # @	19 20	211 20
Gilsonite	1100 # @	.70	770 00
FL 160	103 # @	10 65	1096 95
W.P. II	1500 # @	1.00	1500 00
HANDLING	298 @	1.1	566 20
MILEAGE	.09 x 54 mile		938 70
TOTAL			7273 25

REMARKS:

Pump 500-A1 w/ R-II  
Pump 220 cement  
Washout pump lines  
Displace plus to insert  
L.S. press 1100 #  
Land press 1500 # + hld  
Job complete @ 1:45 AM  
Thanks Tussy crew

CHARGE TO: Plasco. Winstan LLC  
STREET \_\_\_\_\_  
CITY \_\_\_\_\_ STATE \_\_\_\_\_ ZIP \_\_\_\_\_

SERVICE	
DEPTH OF JOB	
PUMP TRUCK CHARGE	1965 20
EXTRA FOOTAGE	@
MILEAGE	35 @ 6 00 210 00
MANIFOLD	@
Head	@ 100 00
TOTAL	2275 00

PLUG & FLOAT EQUIPMENT

1- Port collar	1750 00
1- G. shoe (B) @	150 00
1- ATU Insert (B) @	250 00
2- Centralizers @ 50 00	350 00
1- Basket @	150 00
1- Rubber Plug @	59 00
TOTAL	2709 00

To Allied Cementing Co., Inc.  
You are hereby requested to rent cementing equipment and furnish cementer and helper to assist owner or contractor to do work as is listed. The above work was done to satisfaction and supervision of owner agent or contractor. I have read & understand the "TERMS AND CONDITIONS" listed on the reverse side.

TAX \_\_\_\_\_  
TOTAL CHARGE \_\_\_\_\_  
DISCOUNT \_\_\_\_\_ IF PAID IN 30 DAYS

SIGNATURE Rodney [Signature] PRINTED NAME: Rodney [Signature]

JAN 08 2007

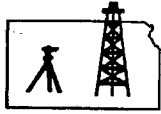

**ROBINSON SERVICES**  
Oil Field & Construction Staking  
P.O. Box 2324  
Garden City, Kansas 67846  
Office/Fax: (620) 276-6159  
Cell: (620) 272-1499

CONSERVATION DIVISION  
WICHITA, KS

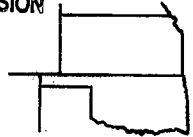

062106-n  
PLAT NO.

6155  
INVOICE NO.

Presco Western, LLC.  
OPERATOR

Hoffman #3-O19-30-32  
LEASE NAME

Haskell County, KS.  
COUNTY

19  
Sec.

30s  
Twp.

32w  
Rng.

1241'FSL - 1312'FEL  
LOCATION SPOT

SCALE: 1" = 1000'  
DATE: June 21, 2006  
MEASURED BY: Tom West  
DRAWN BY: D. Mader  
AUTHORIZED BY: Len & Janice

GR. ELEVATION: 2901.4' D.F.: \_\_\_\_\_

**Directions:** From the West edge of Sublette (at the intersection of Hwy. 83 and Hwy. 56) Now go South 4 miles on Hwy 83 to the South West corner of section 19 - Now go East 0.8 mile to ingress stake - Now go approx. 1240 ft. into staked location through wheat stubble.

***This drawing is for construction purposes only***

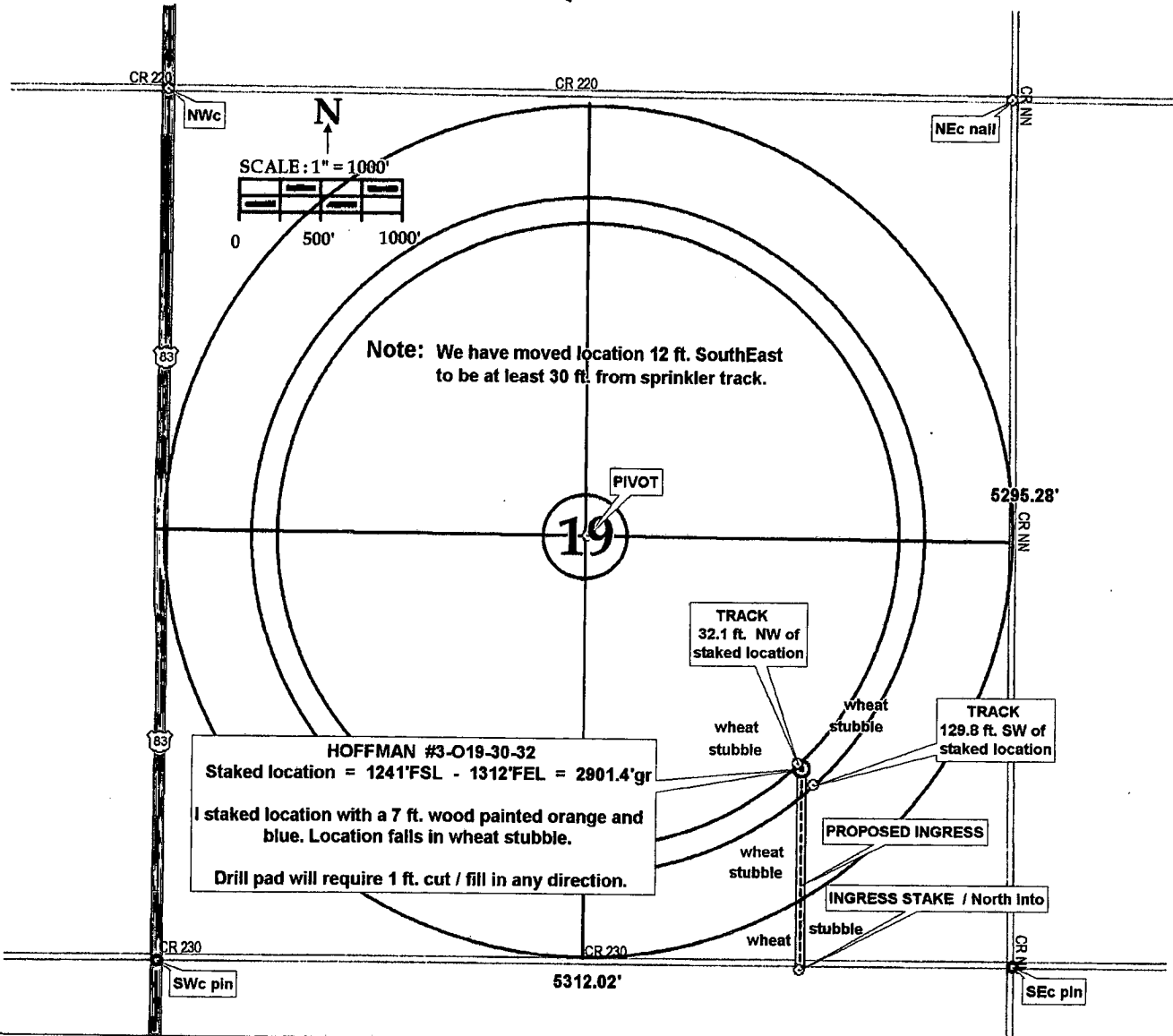

JAN 08 2007

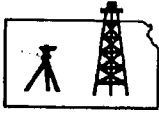

**ROBINSON SERVICES**  
Oil Field & Construction Staking  
P.O. Box 2324  
Garden City, Kansas 67846  
Office/Fax: (620) 276-6159  
Cell: (620) 272-1499

CONSERVATION DIVISION  
WICHITA, KS



062106-n  
PLAT NO.

6155  
INVOICE NO.

Presco Western, LLC.  
OPERATOR

Hoffman #3-O19-30-32  
LEASE NAME

Haskell County, KS.  
COUNTY

19  
Sec.

30s  
Twp.

32w  
Rng.

1241'FSL - 1312'FEL  
LOCATION SPOT

SCALE: 1" = 1000'  
DATE: June 21, 2006  
MEASURED BY: Tom West  
DRAWN BY: D. Mader  
AUTHORIZED BY: Len & Janice



GR. ELEVATION: 2901.4' D.F.: \_\_\_\_\_

**Directions:** From the West edge of Sublette (at the intersection of Hwy. 83 and Hwy. 56) Now go South 4 miles on Hwy 83 to the South West corner of section 19 - Now go East 0.8 mile to ingress stake - Now go approx. 1240 ft. into staked location through wheat stubble.

**This drawing is for construction purposes only**

