

Give All Information Completely
Make Required Affidavit
Mail or Deliver Report to:
Conservation Division
State Corporation Commission
212 North Market, Insurance Bldg.
Wichita, Kansas

15-141-20058-00-00
WELL PLUGGING RECORD

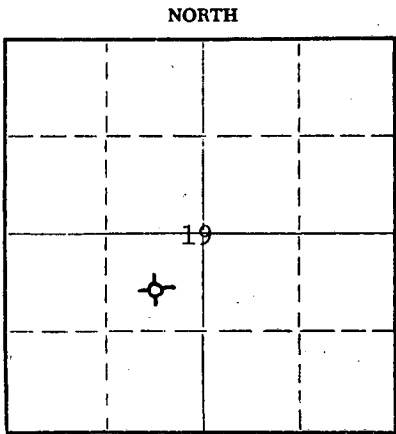

Locate well correctly on above Section Plat

Osborne County, Sec. 19 Twp. 9S Rge. 15W ~~XX~~ (W)
Location as "NE/CNW/SW" or footage from lines C NE SW
Lease Owner John O. Farmer, Inc.
Lease Name Hachmeister "D" Well No. #1
Office Address P.O. Box 352, Russell, KS 67665
Character of Well (completed as Oil, Gas or Dry Hole) Dry Hole
Date well completed August 30, 1979
Application for plugging filed Yes 19
Application for plugging approved 19
Plugging commenced 19
Plugging completed 7:15 P.M., August 30, 1979
Reason for abandonment of well or producing formation _____

If a producing well is abandoned, date of last production 19____
Was permission obtained from the Conservation Division or its agents before plugging was commenced? Yes

Name of Conservation Agent who supervised plugging of this well Dwane Rankin
Producing formation _____ Depth to top _____ Bottom _____ Total Depth of Well _____ Feet
Show depth and thickness of all water, oil and gas formations.

OIL, GAS OR WATER RECORDS

CASING RECORD

FORMATION	CONTENT	FROM	TO	SIZE	PUT IN	PULLED OUT

Describe in detail the manner in which the well was plugged, indicating where the mud fluid was placed and the method or methods used in introducing it into the hole. If cement or other plugs were used, state the character of same and depth placed, from _____ feet to _____ feet for each plug set.

Plug #1 set @ 660' w/50 sx. cement
Plug #2 set @ 200' w/25 sx. cement
Plug #3 set @ 40' w/10 sx. cement

(If additional description is necessary, use BACK of this sheet)

Name of Plugging Contractor John O. Farmer, Inc.
Address P.O. Box 352, Russell, KS 67665

STATE OF Kansas, COUNTY OF Russell, ss.
John O. Farmer (employee or owner) or (owner or operator) of the above-described well, being first duly sworn on oath, says: That I have knowledge of the facts, statements, and matters herein contained and the log of the above-described well as filed and that the same are true and correct. So help me God.

(Signature) John O. Farmer
P.O. Box 352, Russell, KS 67665
(Address)

SUBSCRIBED AND SWORN TO before me this 11th day of September, 19 79

March 29, 1983

Connie Lynn Anderson
Notary Public.

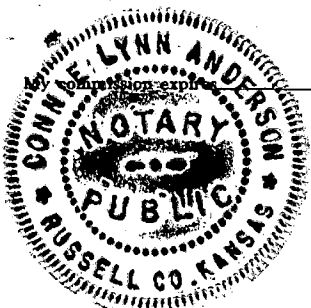

RECEIVED
SEP 13 1979 9-13-79
CONSERVATION DIVISION
Wichita, Kansas

IMPORTANT
 Kans. Geo. Survey request
 samples on this well.

KANSAS DRILLERS LOG

S. 19 T. 9 R. 15 ^{NE} W

Loc. C NE SW

County Osborne

640 Acres
 N

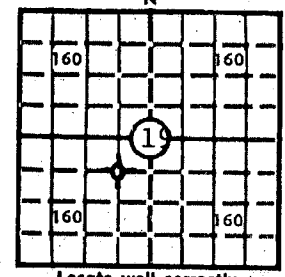

Locate well correctly

Elev.: Gr. 2015'

DF 2018' KB 2020'

API No. 15 — 141 — 20,058 ⁻⁰⁰⁻⁰⁰
 County Number

Operator
John O. Farmer, Inc.

Address
Box 352 Russell, Kansas 67665

Well No. #1 Lease Name Hachmeister "D"

Footage Location
660 feet from (N) ~~XX~~ line 660 feet from (E) ~~XX~~ line

Principal Contractor John O. Farmer, Inc. Geologist Sam L. Farmer

Spud Date 8-23-79 Total Depth _____ P.B.T.D. _____

Date Completed 8-30-79 Oil Purchaser _____

CASING RECORD

Report of all strings set — surface, intermediate, production, etc.

Purpose of string	Size hole drilled	Size casing set (in O.D.)	Weight lbs/ft.	Setting depth	Type cement	Sacks	Type and percent additives
Surface	12-1/4"	8-5/8"	28	201'	Common	150	

LINER RECORD

PERFORATION RECORD

Top, ft.	Bottom, ft.	Sacks cement	Shots per ft.	Size & type	Depth interval

TUBING RECORD

Size	Setting depth	Packer set at

ACID, FRACTURE, SHOT, CEMENT SQUEEZE RECORD

Amount and kind of material used	Depth interval treated

RECEIVED
 STATE CORPORATION COMMISSION

SEP 13 1979

INITIAL PRODUCTION

Date of first production _____ Producing method (flowing, pumping, gas lift, etc.) _____

RATE OF PRODUCTION PER 24 HOURS

Oil	Gas	Water	Gas-oil ratio
_____ bbls.	_____ MCF	_____ bbls.	_____ CFPB

Disposition of gas (vented, used on lease or sold) _____ Producing interval (s) _____

CONSERVATION DIVISION
 WICHITA, KANSAS
 9-13-79

INSTRUCTIONS: As provided in KCC Rule 82-2-125, within 90 days after completion of a well, one completed copy of this Drillers Log shall be transmitted to the State Geological Survey of Kansas, 4150 Monroe Street, Wichita, Kansas 67209. Copies of this form are available from the Conservation Division, State Corporation Commission, 3830 So. Meridian (P.O. Box 17027), Wichita, Kansas 66217. Phone AC 316-522-2206. If confidential custody is desired, please note Rule 82-2-125. Drillers Logs will be on open file in the Oil and Gas Division, State Geological Survey of Kansas, Lawrence, Kansas 66044.

Operator John O. Farmer, Inc.		DESIGNATE TYPE OF COMP.: OIL, GAS, DRY HOLE, SWDW, ETC.:
Well No. #1	Lease Name Hachmeister "D"	Dry Hole
S 19 T 9S R 15 ^{EX} _W		

WELL LOG

Show all important zones of porosity and contents thereof; cored intervals, and all drill-stem tests, including depth interval tested, cushion used, time tool open, flowing and shut-in pressures, and recoveries.

SHOW GEOLOGICAL MARKERS, LOGS RUN, OR OTHER DESCRIPTIVE INFORMATION.

FORMATION DESCRIPTION, CONTENTS, ETC.	TOP	BOTTOM	NAME	DEPTH
Shale & Sand	-0-	940		<u>Sample Tops</u>
Red Bed	940	1237		
Anhydrite	1237	1268	Anhydrite	1237 (+783)
Shale & Lime	1268	3270	Topeka	2949 (-929)
Lime & Shale	3270	3355	Heebner	3163 (-1143)
Lime	3355	3505	Toronto	3204 (-1184)
Lime & Shale	3505	3580	Lansing	3226 (-1206)
Lime	3580	3704	B/KC	3492 (-1472)
			Conglomerate	3596 (-1576)
			T.D.	3704 (-1684)

USE ADDITIONAL SHEETS, IF NECESSARY, TO COMPLETE WELL RECORD.

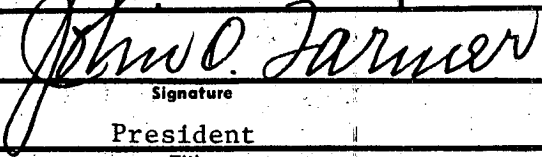
Date Received	
	Signature
	President
	Title
	September 11, 1979
	Date