

EFFECTIVE DATE: 9-12-90

FORM MUST BE TYPED

State of Kansas

FORM MUST BE SIGNED

FORM C-1 4/90

NOTICE OF INTENTION TO DRILL

ALL BLANKS MUST BE FILLED

Must be approved by the K.C.C. five (5) days prior to commencing well

Expected Spud Date 9.....22.....1990..... NW NW SE... Sec 26 Twp 8... S, Rg 18... X East X West ✓
 month day year

OPERATOR: License # 5635 ✓
 Name: The Gene Brown Company
 Address: P.O. Drawer 220
 City/State/Zip: Plainville, Kansas 67663
 Contact Person: Thomas M. Brown
 Phone: 913-434-4811

CONTRACTOR: License # 6997 ✓
 Name: Bill's Well Service

Well Drilled For: Well Class: Type Equipment:

X... Oil ... Inj X Infield X Mud Rotary ✓
 ... Gas ... Storage ... Pool Ext. ... Air Rotary ✓
X... OWWO ... Disposal ... Wildcat ... Cable
 ... Seismic; ... # of Holes

If OWWO: old well information as follows:

Operator: Braden Drilling Company ✓
 Well Name: Dechant #1
 Comp. Date: 2-25-53 Old Total Depth 3446

API number NA

Directional, Deviated or Horizontal wellbore? yes X no ✓

If yes, total depth location:

..... 2310..... feet from South line of Section ✓
 2310..... feet from East line of Section ✓
 (Note: Locate well on Section Plat on Reverse Side)

County: Rooks ✓
 Lease Name: Peter Dechant Well #: 2 ✓
 Field Name: Dopita Ext ✓
 Is this a Prorated Field? yes X.. no ✓
 Target Formation(s): LKC-Arbuckle ✓
 Nearest lease or unit boundary: 330 ✓
 Ground Surface Elevation: 1969..... feet MSL ✓
 Domestic well within 330 feet: 1450 yes no ✓
 Municipal well within one mile: yes X.. no ✓
 Depth to bottom of fresh water: 100ft ✓
 Depth to bottom of usable water: 750ft 820 ✓
 Surface Pipe by Alternate: 1 X.. 2 ✓
 Length of Surface Pipe set: 8.5/8 at 230' ✓
 Length of Conductor pipe required: n/a ✓
 Projected Total Depth: 3446 ✓
 Formation at Total Depth: Arbuckle ✓
 Water Source for Drilling Operations:
 City water well farm pond X.. other ✓
 DWR Permit #: ✓
 Will Cores Be Taken?: yes X.. no ✓
 If yes, proposed zone:

AFFIDAVIT: * See attached letter

The undersigned hereby affirms that the drilling, completion and eventual plugging of this well will comply with K.S.A. 55-101, et. seq.

It is agreed that the following minimum requirements will be met:

1. The appropriate district office shall be notified before setting surface pipe;
2. The minimum amount of surface pipe as specified above shall be set by circulating cement to the top; in all cases surface pipe shall be set through all unconsolidated materials plus a minimum of 20 feet into the underlying formation;
3. If the well is dry, a plugging proposal shall be submitted to the district office. An agreement between the operator and the district office on plug length and placement is necessary prior to plugging;
4. The appropriate district office will be notified before well is either plugged or production casing is cemented in;
5. If an Alternate II completion, production pipe shall be cemented from below any usable water to surface within 120 days of spud date. In all cases, notify district office prior to any cementing.

I hereby certify that the statements made herein are true and to the best of my knowledge and belief.

Date: 9-7-90..... Signature of Operator or Agent: Thomas M. Brown..... Title: Development Supervisor Or

FOR KCC USE:

API # 15- 163-01,027-00-01
 Conductor pipe required None feet
 Minimum surface pipe required 230 feet per Alt. • ②
 Approved by: mdw 9-12-90
 EFFECTIVE DATE: 9-12-90
 This authorization expires: 3-12-91
 (This authorization void if drilling not started within 6 months of effective date.)
 Spud date: _____ Agent: _____

RECEIVED
STATE OF KANSAS

SEP 12 1990

9-12-90
CONSEV. DIV.
Wichita, Kansas

REMEMBER TO:

- File Drill Pit Application (form CDP-1) with Intent to Drill;
- File Completion Form ACO-1 within 120 days of spud date;
- File acreage attribution plat according to field proration orders;
- Notify appropriate district office 48 hours prior to workover or re-entry;
- Submit plugging report (CP-4) after plugging is completed;
- Obtain written approval before disposing or injecting salt water.

PLAT OF ACREAGE ATTRIBUTABLE TO A WELL

State Corporation Commission, Conservation Division
200 Colorado Derby Bldg. Wichita, Kansas 67202

OPERATOR	The Gene Brown Company	LOCATION OF WELL:
LEASE	Peter Dechant	2310 feet north of SE corner
WELL NUMBER	#2	2310 feet west of SE corner
FIELD	Dopita Ext	SW $\frac{1}{4}$ Sec. 26 T 8 R 18 X/W
		COUNTY Rooks

NO. OF ACRES ATTRIBUTABLE TO WELL 10
140 Acres

DESCRIPTION OF ACREAGE N $\frac{1}{2}$ of SE $\frac{1}{4}$ and SE $\frac{1}{4}$ of SE $\frac{1}{4}$ and East $\frac{1}{2}$ - SW $\frac{1}{4}$ of SE $\frac{1}{4}$

NOTE: If plat depicted is insufficient for your circumstances, you may attach your own scaled or surveyed plat.

PLAT

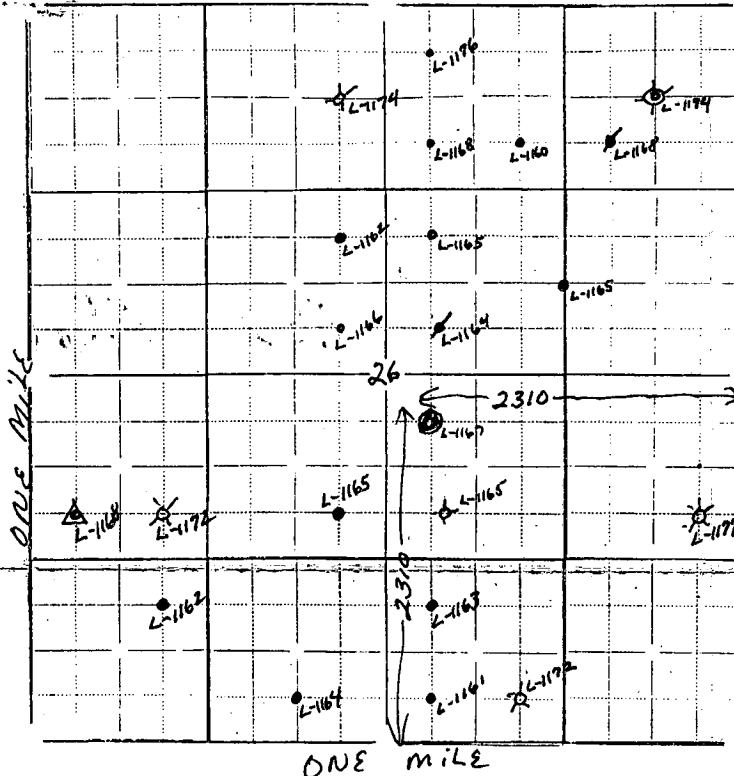

In plotting the proposed location of the well, you must show:

- 1) The manner in which you are using the depicted plat by identifying section lines, i.e. 1 section, 1 section with 8 surrounding partial sections, 4 sections, 16 sections, etc.;
- 2) the well's location relative to the location of other wells producing from the same common source of supply in adjoining drilling units, pursuant to K.A.R. 82-3-108, 82-3-207, 82-3-312, or special orders of the Commission;
- 3) the distance of the proposed drilling location from the section's east and south lines; and
- 4) the distance to the nearest lease or unit boundary line.

I hereby certify that the statements made herein are true and to the best of my knowledge and belief.

Signature of Operator or Agent Thomas M Brown

Date 9-7-90 Title Development Supervisor