

EFFECTIVE DATE: 11-23-93

State of Kansas

DISTRICT # 4

NOTICE OF INTENTION TO DRILL

SEAT Yes No

Must be approved by the K.C.C. five (5) days prior to commencing well

Expected Spud Date November 16 1993
month day year

Spot SE - SW Sec 9 Twp 8 S. Rg 21 East West

OPERATOR: License # 31336
Name: Oil Quest Resources, Inc.
Address: 518 17th Street, Suite 560
City/State/Zip: Denver, CO 80202
Contact Person: William D. Helton
Phone: (303) 893-1972

30 feet from South North line of Section
2500 feet from East West line of Section
IS SECTION X REGULAR IRREGULAR?

(NOTE: Locate well on the Section Plat on Reverse Side)

County: Graham

Lease Name: Billips Well #: 1

Field Name: Wildcat

Is this a Prorated/Spaced Field? yes X no

Target Formation(s): LKC - Arbuckle

Nearest lease or unit boundary: 1350 ft

Ground Surface Elevation: 2010 feet MSL

Water well within one-quarter mile: Public Med X yes no

Public water supply well within one mile: X yes no

Depth to bottom of fresh water: 230

Depth to bottom of usable water: 720

Surface Pipe by Alternate: 1 X 2

Length of Surface Pipe Planned to be set: 240

Length of Conductor pipe required: none 40

Projected Total Depth: 3650

Formation at Total Depth: Arbuckle

Water Source for Drilling Operations: X well farm pond other

DWR Permit #:

Will Cores Be Taken?: yes X no

If yes, proposed zone:

Well Drilled For: Well Class: Type Equipment:
X Oil Enh Rec Infield X Mud Rotary
Gas Storage Pool Ext Air Rotary
OWWO Disposal X Wildcat Cable
Seismic: # of Holes Other

If OWWO: old well information as follows:

Operator:

Well Name:

Comp. Date: Old Total Depth

Directional, Deviated or Horizontal wellbore? yes X no

If yes, true vertical depth:

Bottom Hole Location:

AFFIDAVIT

The undersigned hereby affirms that the drilling, completion and eventual plugging of this well will comply with K.S.A. 55-101, et. seq.

It is agreed that the following minimum requirements will be met:

- 1. Notify the appropriate district office prior to spudding of well;
2. A copy of the approved notice of intent to drill shall be posted on each drilling rig;
3. The minimum amount of surface pipe as specified below shall be set by circulating cement to the top; in all cases surface pipe shall be set through all unconsolidated materials plus a minimum of 20 feet into the underlying formation;
4. If the well is dry hole, an agreement between the operator and the district office on plug length and placement is necessary prior to plugging;
5. The appropriate district office will be notified before well is either plugged or production casing is cemented in;
6. IF AN ALTERNATE II COMPLETION, PRODUCTION PIPE SHALL BE CEMENTED FROM BELOW ANY USABLE WATER TO SURFACE WITHIN 120 DAYS OF SPUD DATE. IN ALL CASES, NOTIFY DISTRICT OFFICE PRIOR TO ANY CEMENTING.

I hereby certify that the statements made herein are true and to the best of my knowledge and belief.

Date: 11-15-93 Signature of Operator or Agent: M.D. Helton Title: President

FOR KCC USE: 065 - 22731 - 0000
API # 15-
Conductor pipe required 40 feet
Minimum surface pipe required 240 feet per Alt. X
Approved by: CB 11-18-93
This authorization expires: 5-18-94
(This authorization void if drilling not started within 6 months of effective date.)
Spud date: Agent:

RECEIVED STATE CORPORATION COMMISSION

NOV 10 1993 11-10-93 CONSERVATION DIVISION Wichita, Kansas

REMEMBER TO:

- File Drill Pit Application (form CDP-1) with Intent to Drill;
- File Completion Form ACO-1 within 120 days of spud date;
- File acreage attribution plat according to field proration orders;
- Notify appropriate district office 48 hours prior to workover or re-entry;
- Submit plugging report (CP-4) after plugging is completed;
- Obtain written approval before disposing or injecting salt water.

Mail to: Conservation Division, 200 Colorado Derby Building, 202 W. First St., Wichita, Kansas 67202-1286.

IN ALL CASES PLOT THE INTENDED WELL ON THE PLAT BELOW

PLAT OF ACREAGE ATTRIBUTABLE TO A WELL IN A PRORATED OR SPACED FIELD

If the intended well is in a prorated or spaced field, please fully complete this side of the form. If the intended well is in a prorated or spaced field complete the plat below showing that the well will be properly located in relationship to other wells producing from the common source of supply. Please show all the wells within 1 mile of the boundaries of the proposed acreage attribution unit for gas wells and within 1/2 mile of the boundaries of the proposed acreage attribution unit for oil wells.

API NO. 15- \_\_\_\_\_  
 OPERATOR Oil Quest Resources, Inc.  
 LEASE Billips  
 WELL NUMBER #1  
 FIELD Unnamed

LOCATION OF WELL: COUNTY Graham  
30 feet from south north line of section  
2500 feet from east west line of section  
 SECTION 9 TWP 8S RG 21W

NUMBER OF ACRES ATTRIBUTABLE TO WELL 20  
 QTR/QTR/QTR OF ACREAGE SE - SE - SW

IS SECTION X REGULAR or IRREGULAR  
IF SECTION IS IRREGULAR, LOCATE WELL FROM NEAREST CORNER BOUNDARY.

Section corner used: NE NW SE SW

PLAT

(Show location of the well and shade attributable acreage for prorated or spaced wells.)  
 (Show footage to the nearest lease or unit boundary line.)

R 21 W

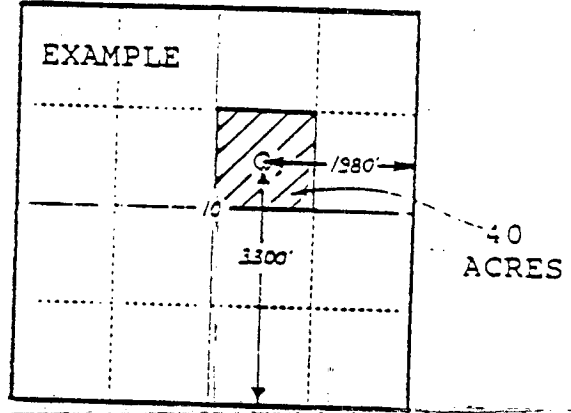
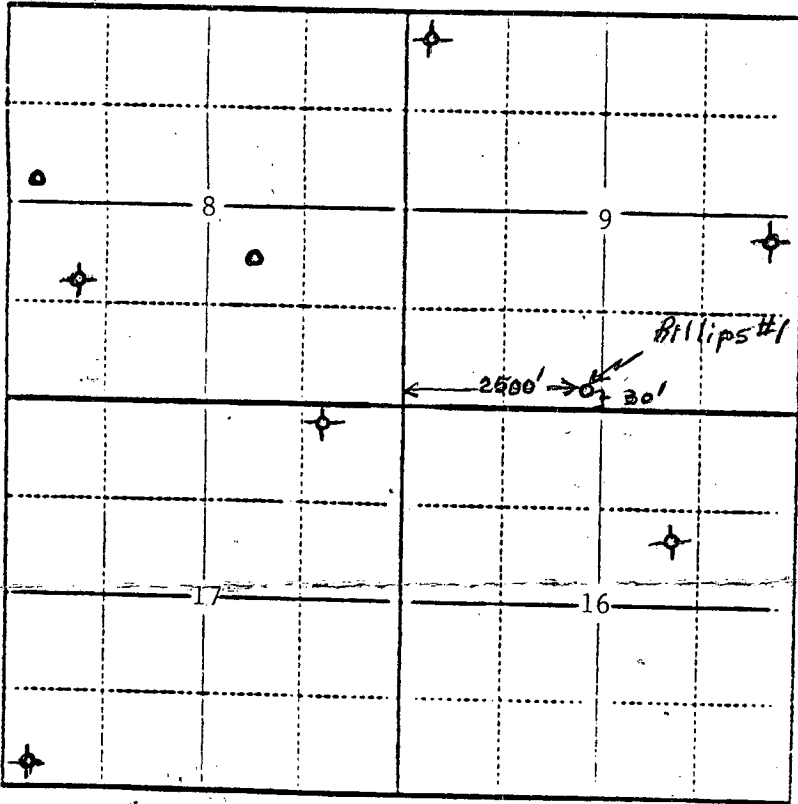

SEWARD CO.

\* Oper. contact @ 12:00 on 11-19-93  
 LEASE ALSO COVERS the N1/2 N1/2 of Sec. 16

Graham County

In plotting the proposed location of the well, you must show:

- 1) The manner in which you are using the depicted plat by identifying section lines, i.e. 1 section, 1 section with 8 surrounding sections, 4 sections, etc.;
- 2) the distance of the proposed drilling location from the section's south/north and east/west lines; and
- 3) the distance to the nearest lease or unit boundary line.