

EFFECTIVE DATE: 7-27-91

*'OWWO' Correction*

FORM MUST BE TYPED  
FORM C-1 4/90

State of Kansas  
NOTICE OF INTENTION TO DRILL

FORM MUST BE SIGNED  
ALL BLANKS MUST BE FILLED

Must be approved by the K.C.C. five (5) days prior to commencing well

Expected Spud Date 7/23/91  
month day year

NE NW NW Sec 35 Twp 8 S, Rg 22 X East West

OPERATOR: License # 4767  
Name: Ritchie Exploration, Inc.  
Address: 125 N. Market, Suite 1000  
City/State/Zip: Wichita, KS 67202  
Contact Person: Leah Kasten  
Phone: 316/267-4375

4950 feet from South line of Section  
4290 feet from East line of Section  
(Note: Locate well on Section Plat on Reverse Side)

CONTRACTOR: License #: 30606  
Name: Murfin Drilling Co., Inc.

County: Graham  
Lease Name: Buss Well #: 2  
Field Name: Mickelson SE

Well Drilled For: Well Class: Type Equipment:  
Oil Inj X Infield X Mud Rotary  
Gas Storage Pool Ext. Air Rotary  
OWWO X Disposal Wildcat Cable  
Seismic; # of Holes

Is this a Prorated Field? yes X no  
Target Formation(s): Cedar Hills  
Nearest lease or unit boundary: 330'  
Ground Surface Elevation: 2192' feet MSL

If OWWO: old well information as follows:  
Operator: K&E Drilling, Inc.  
Well Name: #1 Buss  
Comp. Date: 12/11/84 Old Total Depth 3921'

Domestic well within 330 feet: yes X no  
Municipal well within one mile: yes X no  
Depth to bottom of fresh water: 270'  
Depth to bottom of usable water: 995'

API# was 15-065-22,035  
Directional, Deviated or Horizontal wellbore? yes X no  
If yes, total depth location: \_\_\_\_\_

Surface Pipe by Alternate: 1 X 2  
Length of Surface Pipe set: 367'  
Length of Conductor pipe required: \_\_\_\_\_  
Projected Total Depth: 1760'

Formation at Total Depth: Anhydrite  
Water Source for Drilling Operations:  
well farm pond X other \_\_\_\_\_

DWR Permit #: \_\_\_\_\_  
Will Cores Be Taken?: yes no  
If yes, proposed zone: \_\_\_\_\_

OWWO: API # 15-065-22,035 AFFIDAVIT 15: API # 15-065-22,035-A

The undersigned hereby affirms that the drilling, completion and eventual plugging of this well will comply with K.S.A. 55-101, et. seq.

- It is agreed that the following minimum requirements will be met:
1. The appropriate district office shall be notified before setting surface pipe;
  2. The minimum amount of surface pipe as specified above shall be set by circulating cement to the top; in all cases surface pipe shall be set through all unconsolidated materials plus a minimum of 20 feet into the underlying formation;
  3. If the well is dry, a plugging proposal shall be submitted to the district office. An agreement between the operator and the district office on plug length and placement is necessary prior to plugging;
  4. The appropriate district office will be notified before well is either plugged or production casing is cemented in;
  5. If an Alternate II completion, production pipe shall be cemented from below any usable water to surface within 120 days of spud date. In all cases, notify district office prior to any cementing.

I hereby certify that the statements made herein are true and to the best of my knowledge and belief.

Date: 7/16/91 Signature of Operator or Agent: Leah Kasten Title: Geologist

RECEIVED  
STATE CORPORATION COMMISSION  
JUL 17 1991  
CONSERVATION DIVISION  
Wichita, Kansas

FOR KCC USE:  
API # 15- 15-065-22,035-00-01  
Conductor pipe required None feet  
Minimum surface pipe required 300 feet per Alt. 8(2)  
Approved by: MLW 7-22-91; call 9-13-91  
EFFECTIVE DATE: 7-27-91  
This authorization expires: 1-22-92  
(This authorization void if drilling not started within 6 months of effective date.)  
Spud date: \_\_\_\_\_ Agent: \_\_\_\_\_

352  
2210

- REMEMBER TO:
- File Drill Pit Application (form CDP-1) with Intent to Drill;
  - File Completion Form ACO-1 within 120 days of spud date;
  - File acreage attribution plat according to field proration orders;
  - Notify appropriate district office 48 hours prior to workover or re-entry;
  - Submit plugging report (CP-4) after plugging is completed;
  - Obtain written approval before disposing or injecting salt water.

PLAT OF ACREAGE ATTRIBUTABLE TO A WELL

State Corporation Commission, Conservation Division  
200 Colorado Derby Bldg. Wichita, Kansas 67202

OPERATOR Ritchie Exploration, Inc.  
LEASE Buss  
WELL NUMBER 2  
FIELD Mickelson SE

LOCATION OF WELL:  
4950 feet north of SE corner  
4290 feet west of SE corner  
Sec. 35 T 8S R 22 E/W

NO. OF ACRES ATTRIBUTABLE TO WELL n/a  
DESCRIPTION OF ACREAGE NW/4

COUNTY Graham  
IS SECTION  REGULAR  IRREGULAR?  
IF IRREGULAR, LOCATE WELL FROM NEAREST CORNER BOUNDARY.

NOTE: If plat depicted is insufficient for your circumstances, you may attach your own scaled or surveyed plat.

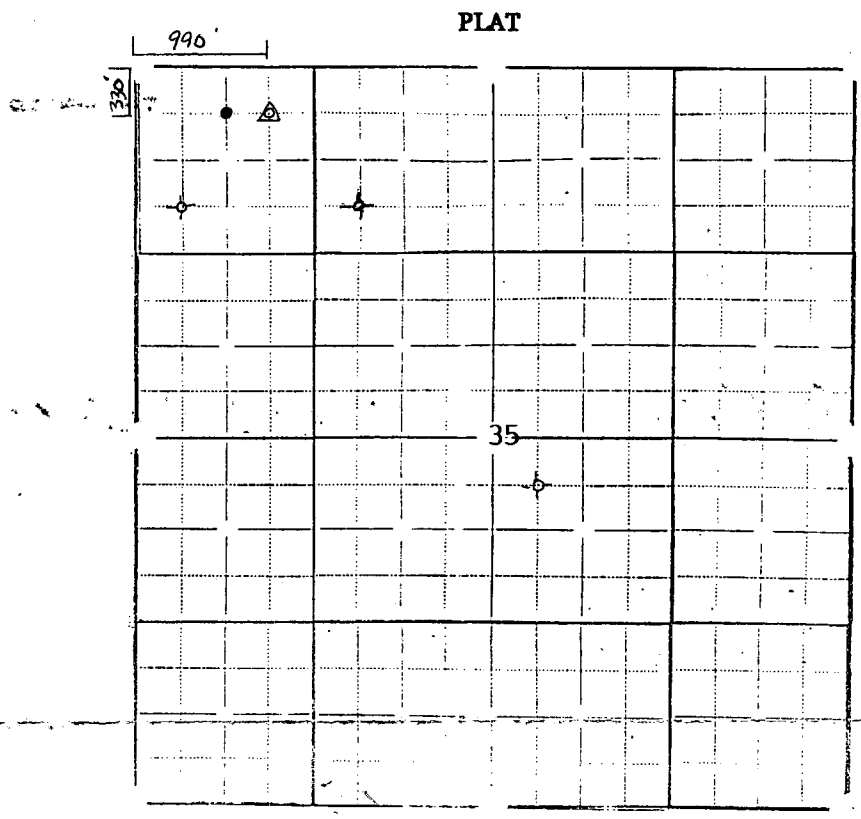

In plotting the proposed location of the well, you must show:

- 1) The manner in which you are using the depicted plat by identifying section lines, i.e. 1 section, 1 section with 8 surrounding partial sections, 4 sections, 16 sections, etc.;
- 2) the well's location relative to the location of other wells producing from the same common source of supply in adjoining drilling units, pursuant to K.A.R. 82-3-108, 82-3-207, 82-3-312, or special orders of the Commission;
- 3) the distance of the proposed drilling location from the section's east and south lines; and
- 4) the distance to the nearest lease or unit boundary line.

I hereby certify that the statements made herein are true and to the best of my knowledge and belief.

Signature of Operator or Agent Leah Kasten

Date 7/16/91 Title Geologist