

For KCC Use: 4-2803
Effective Date: 4
District #: 4
SGA? Yes No

KANSAS CORPORATION COMMISSION
OIL & GAS CONSERVATION DIVISION

Form C-1
September 1999
Form must be Typed
Form must be Signed
All blanks must be Filled

NOTICE OF INTENT TO DRILL

Must be approved by KCC five (5) days prior to commencing well

Expected Spud Date May 6 2003 Spot Ap SE NE NW NW Sec. 2 Twp. 8S S. R. 40 East West

OPERATOR: License# 30282 **RECEIVED** 600' feet from N (circle one) Line of Section
Name: Lobo Production, Inc. 1115' feet from W (circle one) Line of Section
Address: 6715 Rd 22 SECTION Regular Irregular?
City/State/Zip: Goodland, KS 67735 **APR 23 2003**

Contact Person: John Sanders County: Sherman (Note: Locate well on the Section Plat on reverse side)
Phone: 785-899-5684 Lease Name: Wolfe-Eyth Well #: 2-2

CONTRACTOR: License# Schaal Drilling #33229 Field Name: Goodland Gas Field
Name: Poe Servicing Inc. #3152 Is this a Prorated / Spaced Field? Yes No

Target Information(s): Niobrara
Nearest Lease or unit boundary: 600'
Ground Surface Elevation: 3610' feet MSL
Water well within one-quarter mile: Yes No
Public water supply well within one mile: Yes No
Depth to bottom of fresh water: 198' 230'
Depth to bottom of usable water: 198' 230'
Surface Pipe by Alternate: 1 2

Length of Surface Pipe Planned to be set: 226' 280' min
Length of Conductor Pipe required: none
Projected Total Depth: 1320'
Producing Formation Target: 1144'

Water Source for Drilling Operations:
Well Farm Pond Other CityWater
DWR Permit #: _____

(Note: Apply for Permit with DWR)
Will Cores be taken? Yes No
If Yes, proposed zone: _____

AFFIDAVIT *

The undersigned hereby affirms that the drilling, completion and eventual plugging of this well will comply with K.S.A. 55-101, et. seq.
It is agreed that the following minimum requirements will be met:
1. Notify the appropriate district office **prior** to spudding of well;
2. A copy of the approved notice of intent to drill **shall be** posted on each drilling rig;
3. The minimum amount of surface pipe as specified below **shall be set** by circulating cement to the top; in all cases surface pipe **shall be set** through all unconsolidated materials plus a minimum of 20 feet into the underlying formation.
4. If the well is dry hole, an agreement between the operator and the district office on plug length and placement is necessary **prior to plugging**;
5. The appropriate district office will be notified before well is either plugged or production casing is cemented in;
6. If an ALTERNATE II COMPLETION, production pipe shall be cemented from below any usable water to surface within **120 days** of spud date. **In all cases, NOTIFY district office** prior to any cementing.
I hereby certify that the statements made herein are true and to the best of my knowledge and belief.

Date: 4/22/03 Signature of Operator or Agent: John Sanders Title: President

For KCC Use ONLY
API # 15 - 181-20321-00-00
Conductor pipe required NONE feet
Minimum surface pipe required 280' feet per Alt. 1
Approved by: RJP 4-23-03
This authorization expires: 10-23-03
(This authorization void if drilling not started within 6 months of effective date.)
Spud date: _____ Agent: _____

- Remember to:
- File Drill Pit Application (form CDP-1) with Intent to Drill;
 - File Completion Form ACO-1 within 120 days of spud date;
 - File acreage attribution plat according to field proration orders;
 - Notify appropriate district office 48 hours prior to workover or re-entry;
 - Submit plugging report (CP-4) after plugging is completed;
 - Obtain written approval before disposing or injecting salt water.

2
8
40W

IN ALL CASES PLOT THE INTENDED WELL ON THE PLAT BELOW

Plat of acreage attributable to a well in a prorated or spaced field

If the intended well is in a prorated or spaced field, please fully complete this side of the form. If the intended well is in a prorated or spaced field complete the plat below showing that the well will be properly located in relationship to other wells producing from the common source of supply. Please show all the wells and within 1 mile of the boundaries of the proposed acreage attribution unit for gas wells and within 1/2 mile of the boundaries of the proposed acreage attribution unit for oil wells.

API No. 15 - _____
Operator: _____
Lease: _____
Well Number: _____
Field: _____

Number of Acres attributable to well: _____

QTR / QTR / QTR of acreage: _____

Location of Well: County: _____

_____ feet from S / N (circle one) Line of Section

_____ feet from E / W (circle one) Line of Section

Sec. _____ Twp. _____ S. R. _____ East West

Is Section _____ Regular or _____ Irregular

If Section is Irregular, locate well from nearest corner boundary.

Section corner used: ___ NE ___ NW ___ SE ___ SW

PLAT

(Show location of the well and shade attributable acreage for prorated or spaced wells.)

(Show footage to the nearest lease or unit boundary line.)

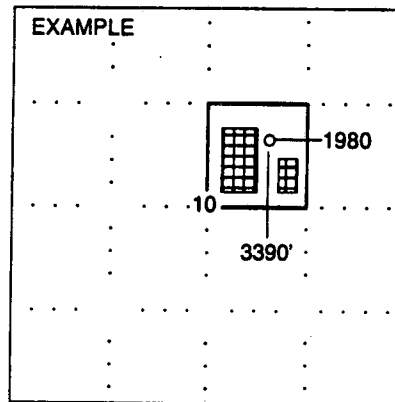
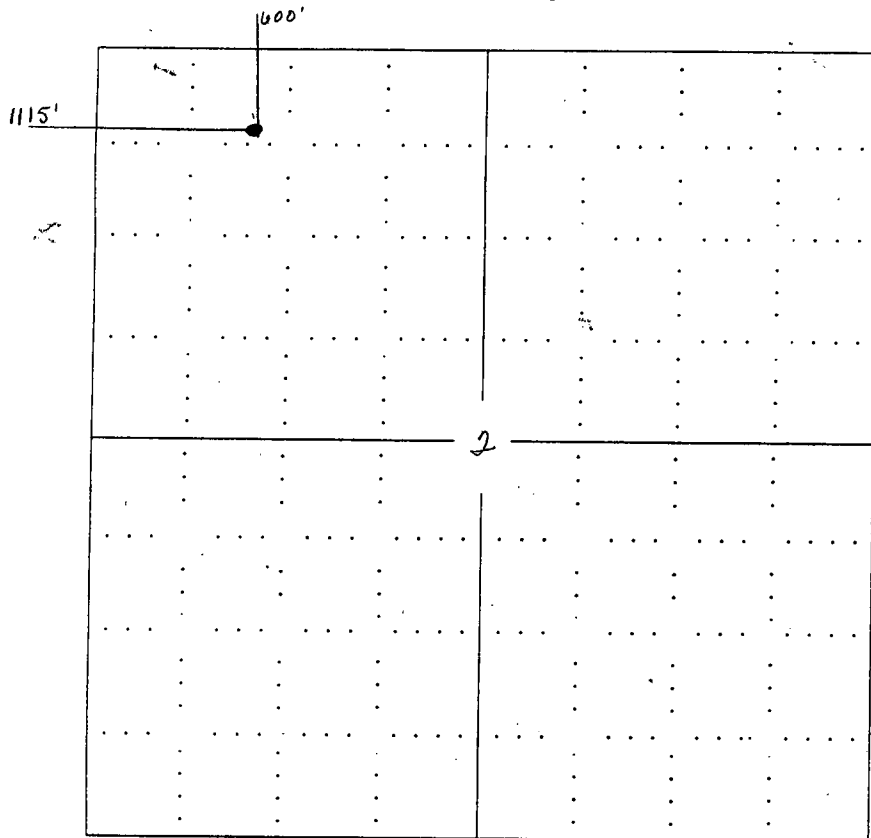

SEWARD CO.

NOTE: In all cases locate the spot of the proposed drilling location.

In plotting the proposed location of the well, you must show.

1. The manner in which you are using the depicted plat by identifying section lines, i.e. 1 section, 1 section with 8 surrounding sections, 4 sections, etc.
2. The distance of the proposed drilling location from the section's south / north and east / west.
3. The distance to the nearest lease or unit boundary line.
4. If proposed location is located within a prorated or spaced field a certificate of acreage attribution plat must be attached: (CO-7 for oil wells; CG-8 for gas wells).