

EFFECTIVE DATE: 7-30-95  
DISTRICT # 4  
SEA7... Yes X No

State of Kansas  
NOTICE OF INTENTION TO DRILL

Must be approved by the K.C.C. five (5) days prior to commencing well

Expected Spud Date August 1 1995  
month day year

Spot 220' West of  
NW NW SW Sec 25 Twp 9 S Rg 20 East

OPERATOR: License # 30537  
Name: VENTURE RESOURCES, INC.  
Address: 518 17th St, Ste. 1130  
City/State/Zip: Denver, CO 80202  
Contact Person: Ron Mackey  
Phone: 303-573-6634

2310' feet from South / North line of Section  
110' feet from East / West line of Section

IS SECTION REGULAR X IRREGULAR?  
(NOTE: Locate well on the Section Plat on Reverse Side)

CONTRACTOR: License #: 5929  
Name: Duke Drilling CO, Inc.

County: ROOKS  
Lease Name: STEEPLES Well #: 1  
Field Name: none

Well Drilled For: Well Class: Type Equipment:  
X Oil ... Enh Rec ... Infield X Mud Rotary  
Gas ... Storage ... Pool Ext. ... Air Rotary  
OAWO ... Disposal X Wildcat ... Cable  
Seismic; # of Holes ... Other

Is this a Prorated/Spaced Field? yes X no  
Target Formation(s): ARBUCKLE/LKC  
Nearest lease or unit boundary: 110'

If OAWO: old well information as follows:  
Operator:  
Well Name:  
Comp. Date: Old Total Depth

Ground Surface Elevation: 2190' feet NSL  
Water well within one-quarter mile: X yes ... no  
Public water supply well within one mile: yes X no

Directional, Deviated or Horizontal wellbore? yes X no  
If yes, true vertical depth:  
Bottom Hole Location:

Depth to bottom of fresh water: 242' (E-Log)  
Depth to bottom of usable water: 1365' (E-Log)  
Surface Pipe by Alternate: 1 X 2  
Length of Surface Pipe Planned to be set: 260'

AFFIDAVIT

The undersigned hereby affirms that the drilling, completion and eventual plugging of this well will comply with K.S.A. 55-101, et. seq.  
It is agreed that the following minimum requirements will be met:

- 1. Notify the appropriate district office prior to spudding of well;
- 2. A copy of the approved notice of intent to drill shall be posted on each drilling rig;
- 3. The minimum amount of surface pipe as specified below shall be set by circulating cement to the top; in all cases surface pipe shall be set through all unconsolidated materials plus a minimum of 20 feet into the underlying formation;
- 4. If the well is dry hole, an agreement between the operator and the district office on plug length and placement is necessary prior to plugging;
- 5. The appropriate district office will be notified before well is either plugged or production casing is cemented in;
- 6. IF AN ALTERNATE II COMPLETION, PRODUCTION PIPE SHALL BE CEMENTED FROM BELOW ANY USABLE WATER TO SURFACE WITHIN 120 DAYS OF SPUD DATE. IN ALL CASES, NOTIFY DISTRICT OFFICE PRIOR TO ANY CEMENTING.

I hereby certify that the statements made herein are true and to the best of my knowledge and belief.  
Date: 6-21-95 Signature of Operator or Agent: [Signature] Title: V.P.

FOR KCC USE:  
API # 15- 163-232660000  
Conductor pipe required NONE feet  
Minimum surface pipe required 260' feet per Alt. X (2)  
Approved by: JK 7-25-95  
This authorization expires: 1-25-96  
(This authorization void if drilling not started within 6 months of effective date.)  
Spud date: Agent:

REMEMBER TO:

- File Drill Pit Application (form CDP-1) with Intent to Drill;
- File Completion Form ACD-1 within 120 days of spud date;
- File acreage attribution plat according to field proration orders;
- Notify appropriate district office 48 hours prior to workover or re-entry;
- Submit plugging report (CP-4) after plugging is completed;
- Obtain written approval before disposing or injecting salt water.

Mail to: Conservation Division, 208 Colorado Derby Building, 202 W. First St., Wichita, Kansas 67202-1286.

25  
9  
2005

IN ALL CASES PLOT THE INTENDED WELL ON THE PLAT BELOW.

PLAT OF ACREAGE ATTRIBUTABLE TO A WELL IN A PRORATED OR SPACED FIELD

If the intended well is in a prorated or spaced field, please fully complete this side of the form. If the intended well is in a prorated or spaced field complete the plat below showing that the well will be properly located in relationship to other wells producing from the common source of supply. Please show all the wells within 1 mile of the boundaries of the proposed acreage attribution unit for gas wells and within 1/2 mile of the boundaries of the proposed acreage attribution unit for oil wells.

API NO. 15-  
 OPERATOR VENTURE RESOURCES, INC.  
 LEASE STEEPLES  
 WELL NUMBER #1  
 FIELD Wildcat

LOCATION OF WELL: COUNTY ROOKS  
2310' feet from south/north line of section  
110' feet from east/west line of section  
 SECTION 25 TWP 9S RG 20W

NUMBER OF ACRES ATTRIBUTABLE TO WELL 10  
 QTR/QTR/QTR OF ACREAGE NW - NW - SW  
220' West of

IS SECTION        REGULAR or X IRREGULAR  
IF SECTION IS IRREGULAR, LOCATE WELL FROM NEAREST  
CORNER BOUNDARY.

Section corner used:        NE        NW        SE X SW

**PLAT**

(Show location of the well and shade attributable acreage for prorated or spaced wells.)  
 (Show footage to the nearest lease or unit boundary line.)

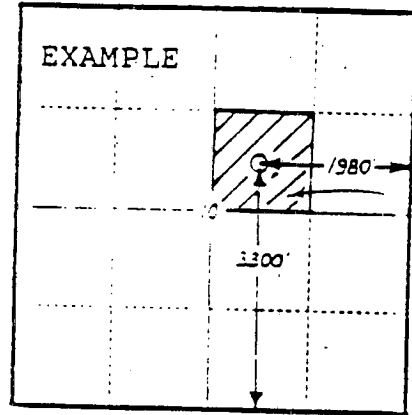
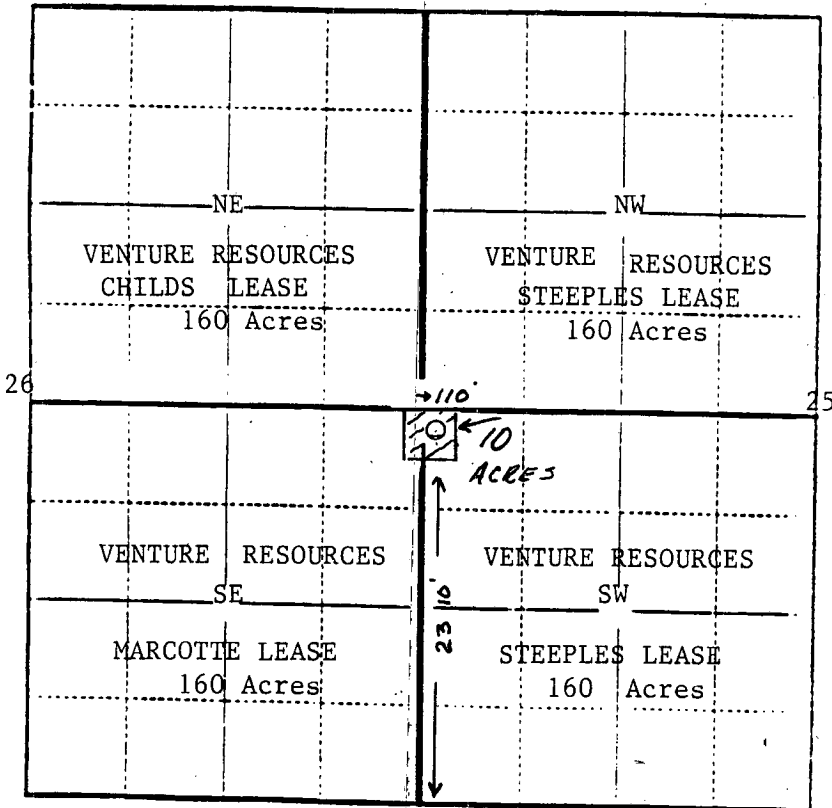

**RECEIVED**  
 KANSAS CORPORATION COMMISSION

JUL 17 1995

CONSERVATION DIVISION  
 WICHITA, KS

In plotting the proposed location of the well, you must show:

- 1) The manner in which you are using the depicted plat by identifying section lines, i.e. 1 section, 1 section with 8 surrounding sections, 4 sections, etc.;
- 2) the distance of the proposed drilling location from the section's south/north and east/west lines; and
- 3) the distance to the nearest lease or unit boundary line.