

For KCC Use: 4-23-02
Effective Date: _____
District # 4
SGA? Yes No

KANSAS CORPORATION COMMISSION
OIL & GAS CONSERVATION DIVISION
NOTICE OF INTENT TO DRILL

Form C-1
September 1999
Form must be Typed
Form must be Signed
All blanks must be Filled

Must be approved by KCC five (5) days prior to commencing well

Expected Spud Date 5 8 2002
month day year

Spot 194' W, 60' N East
NW - SW - SW Sec. 32 Twp. 10 S. R. 19 West
1050 feet from (S) (circle one) Line of Section
136 feet from (W) (circle one) Line of Section
Is SECTION Regular Irregular?

OPERATOR: License# 6892
Name: Trich Production, Inc.
Address: P. O. Box 1408
Longview, Texas 75606
City/State/Zip:
Contact Person: Ken Fletcher
Phone: (972) 422-4335

CONTRACTOR: License# 30606
Name: Murfin Drilling Company, Inc.

RECEIVED
APR 17 2002
KCC - WICHITA

(Note: Locate well on the Section Plat on reverse side)
County: Rooks
Lease Name: Schoshetom Unit Wall #: 1-32
Field Name: Wildcat

Is this a Prorated / Spaced Field? Yes No
Target Formation(s): LKC/Arbuckle
Nearest Lease or unit boundary: 524
Ground Surface Elevation: 2129 feet MSL
Water well within one-quarter mile: Yes No
Public water supply well within one mile: Yes No
Depth to bottom of fresh water: 180'
Depth to bottom of usable water: 760'
Surface Pipe by Alternate: 1 2
Length of Surface Pipe Planned to be set: 250'
Length of Conductor Pipe required: NA
Projected Total Depth: 3800'
Formation at Total Depth: Arbuckle
Water Source for Drilling Operations:
Well Farm Pond Other
DWR Permit #: _____
(Note: Apply for Permit with DWR)
Will Cores be taken? Yes No
If Yes, proposed zone: _____

Well-Drilled For: Well Class: Type Equipment:
 Oil Enh Rec Infield Mud Rotary
 Gas Storage Pool Ext. Air Rotary
 OWWO Disposal Wildcat Cable
 Seismic; # of Holes Other
 Other

If OWWO: old well information as follows:
Operator: _____
Well Name: _____
Original Completion Date: _____ Original Total Depth: _____
Directional, Deviated or Horizontal wellbore? Yes No
If Yes, true vertical depth: _____
Bottom Hole Location: _____
KCC DKT #: _____

AFFIDAVIT

The undersigned hereby affirms that the drilling, completion and eventual plugging of this well will comply with K.S.A. 55-101, et. seq.
It is agreed that the following minimum requirements will be met:
1. Notify the appropriate district office **prior** to spudding of well;
2. A copy of the approved notice of intent to drill **shall be** posted on each drilling rig;
3. The minimum amount of surface pipe as specified below **shall be set** by circulating cement to the top; in all cases surface pipe **shall be set** through all unconsolidated materials plus a minimum of 20 feet into the underlying formation.
4. If the well is dry hole, an agreement between the operator and the district office on plug length and placement is necessary **prior to plugging**;
5. The appropriate district office will be notified before well is either plugged or production casing is cemented in;
6. If an ALTERNATE II COMPLETION, production pipe shall be cemented from below any usable water to surface within **120 days** of spud date. **In all cases, NOTIFY district office** prior to any cementing.

I hereby certify that the statements made herein are true and to the best of my knowledge and belief.
Date: 4-15-02 Signature of Operator or Agent: Kenneth M. Olshaker Title: Agent

For KCC Use ONLY
API # 15 - 163-23344-00-00
Conductor pipe required NONE feet
Minimum surface pipe required 250 feet per Alt. # 2
Approved by: RJP 4-18-2002
This authorization expires: 10-1-2002
(This authorization void if drilling not started within 6 months of effective date.)
Spud date: _____ Agent: _____

- Remember to:**
- File Drill Pit Application (form CDP-1) with Intent to Drill;
 - File Completion Form ACO-1 within 120 days of spud date;
 - File acreage attribution plat according to field proration orders;
 - Notify appropriate district office 48 hours prior to workover or re-entry;
 - Submit plugging report (CP-4) after plugging is completed;
 - Obtain written approval before disposing or injecting salt water.

32 10 1905

PLAT AND CERTIFICATION OF ACREAGE ATTRIBUTABLE TO A OIL WELL

Kansas Corporation Commission, Conservation Division
Finney State Office Building, 130 South Market, Room 2078
Wichita, Kansas 67202

15-163-23344-00-00

API NUMBER 15-

LOCATION OF WELL: COUNTY _____ Rooks _____

OPERATOR Trich Production, Inc.

LEASE Schoshetom

WELL NUMBER 1-32

FIELD Wildcat

1050 feet from south/north line of section
136 feet from east / west line of section

NUMBER OF ACRES ATTRIBUTABLE TO WELL 40

QTR/QTR/QTR OF ACREAGE NW - SW - Sw

SECTION 32 TWP 10 (S) RG 19 E/W
IS SECTION X REGULAR or IRREGULAR
IF SECTION IS IRREGULAR, LOCATE WELL FROM
NEAREST CORNER BOUNDARY. (check line below)
Section corner used: NE NW SE X SW

(Show the location of the well and shade attributable acreage for prorated or spaced wells).
(Show the footage to the nearest lease or unit boundary line; and show footage to the nearest
common source supply well).

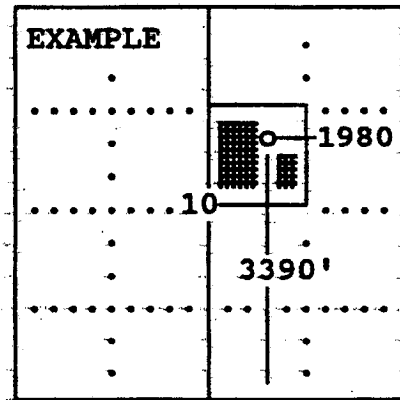
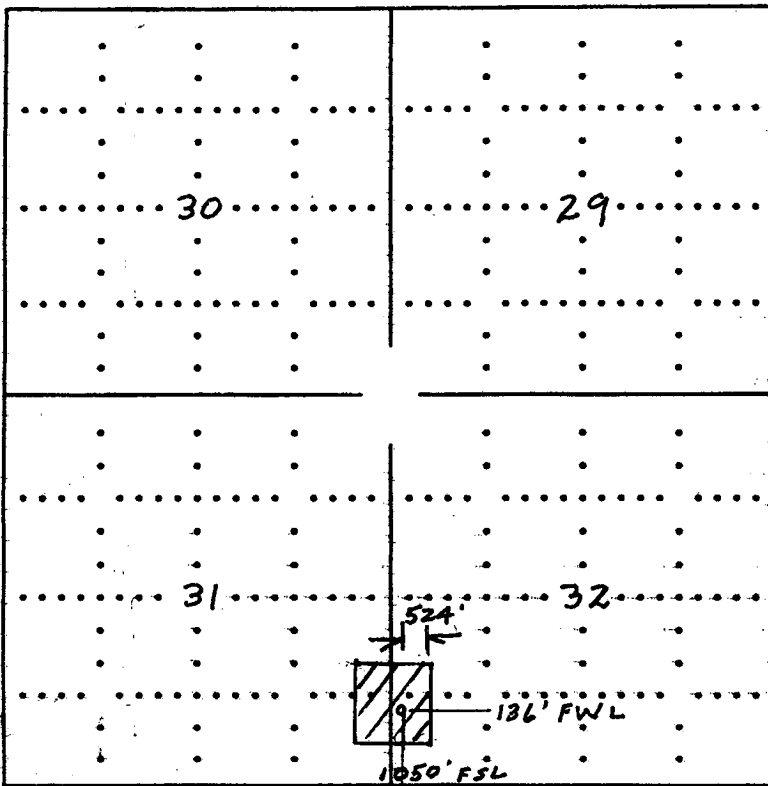

SEWARD CO.

RECEIVED
APR 17 2002
KCC WICHITA

The undersigned hereby certifies as AGENT (title) for

TRICH PRODUCTION, INC. (Co.), a duly authorized agent, that all
information shown hereon is true and correct to the best of my knowledge and belief, that all
acreage claimed attributable to the well named herein is held by production from that well.

Signature Kenneth M. Stelcher

Subscribed and sworn to before me on this 15th day of April, 2002

W J Emerson
Notary Public

My Commission expires 10-31-05

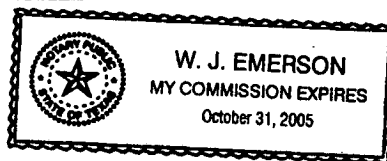

FORM CO-7 (12/94)

15-163-23344-00-00

Trich Production, Inc.
P. O. Box 1408

~~Lone Star, Texas 75001~~

ATTN:

Bob Peterson
337-6211

April 15, 2002

Mr. Jerry Abels
c/o Murfin Drilling Company
250 N. Water, Suite 300
Wichita, Kansas 67202

d

Section 31:SW/4 and Section 32:SW/4
T10S,R19W

Dear Sir:

Please execute the enclosed Declaration of Pooling and Unitization for Murfin Drilling Company, Inc. and send for recording.

Please furnish Trich Production, Inc. with a copy of the recorded instrument When it is received by you.

Thank you for your consideration in this matter.

Sincerely,

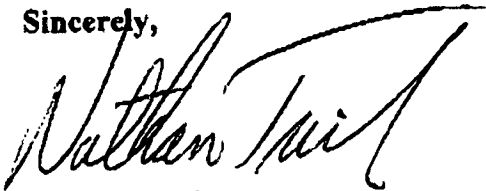

Nathan Trich

15-163-23344-00-00

DECLARATION OF POOLING AND UNITIZATION

KNOW ALL MEN BY THESE PRESENTS:

WHEREAS, TRICH PRODUCTION, INC., P. O. Box 1408, Longview, Texas 75606 and MURFIN DRILLING CO., INC., 250 N. Water, Suite 300, Wichita, Kansas 67202 are the owners of the Oil and Gas Leases described in Exhibit "A", attached hereto and made a part hereof, insofar as said leases cover the following lands in Rooks County, Kansas, as described herein to-wit:

TOWNSHIP 10 SOUTH RANGE 19 WEST

Section 31: SE/4

Section 32: SW/4

and;

WHEREAS, the Oil and Gas Leases described in Exhibit "A" contain a pooling and unitization clause which states:

"Lessee, at its option, is hereby given the right and power to pool or combine the acreage covered by this lease or any portion thereof with other land, lease or leases in the immediate vicinity thereof, when in lessee's judgment it is necessary or advisable to do so in order to properly develop and operate said lease premises so as to promote the conservation of oil, gas or other minerals in and under and that may be produced from said premises, such pooling to be of tracts contiguous to one another and to be into a unit or units not exceeding 40 acres each in the event of an oil well, or into a unit or units not exceeding 640 acres each in the event of a gas well. Lessee shall execute in writing and record in the conveyance records of the county in which the land herein leased is situated an instrument identifying and describing the pooled acreage. The entire acreage so pooled into a tract or unit shall be treated, for all purposes except the payment of royalties on production from the pooled unit, as if it were included in this lease. If production is found on the pooled acreage, it shall be treated as if production is had from this lease, whether the well or wells be located on the premises covered by this lease or not. In lieu of the royalties elsewhere herein specified, lessor shall receive on production from a unit so pooled only such portion of the royalty stipulated herein as the amount of his acreage place in the unit or his royalty interest therein on an acreage basis bears to the total acreage so pooled in the particular unit involved."

WHEREAS, the undersigned TRICH PRODUCTION, INC., Lessee desires to pool and unitize all Oil and Gas Leases described in Exhibit "A", insofar and only insofar as the same cover the following described lands, to-wit:

TOWNSHIP 10 SOUTH RANGE 19 WEST

A tract beginning at a point 580' north of the southwest corner of Section 32, thence east 660 feet, thence north 1320 feet, thence west 660 feet to the section line between Section 31 and Section 32 and continuing 660 feet west into Section 31, thence south 1320 feet, thence east 660 feet to the place of beginning.

said lands containing forty (40) acres, more or less, now being identified as "THE POOLED AND UNITIZED AREA" for production of oil and associated hydrocarbons from all zones and formations.

NOW THEREFORE, the undersigned, TRICH PRODUCTION, INC., does hereby pool and unitize the above described lands into one pooled and unitized area, containing forty (40) acres, provided that said pooling and unitization is limited to production of oil and associated hydrocarbons from all zones and formations.

The royalties accruing from any well located on said unit shall be prorated and paid to lessors of the various tracts included in the POOLED AND UNITIZED AREA in the same proportion that each tract of said Lessors bears to the total of the POOLED AND UNITIZED AREA.

IN WITNESS WHEREOF, this DECLARATION OF POOLING AND UNITIZATION, was executed this _____ day of _____, 2002.

TRICH PRODUCTION, INC.



Nathan Trich, President

MURFIN DRILLING CO., INC

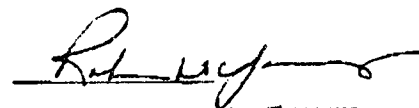

Robert D. Young, Secretary/Treasurer

15-163-23344-00-00

STATE OF TEXAS)

COUNTY OF GREGG)

Before me, the undersigned, a Notary Public, within and for said County and State, on this 15th day of April, 2002 personally appeared Nathan Trich, the President of TRICH PRODUCTION, INC. to me personally known to be the identical person who executed the within and foregoing instrument and acknowledged to me that he executed the same as his free and voluntary act and deed for the uses and purposes set forth therein.

IN WITNESS WHEREOF, I have set my hand and official seal this day.

My commission expires

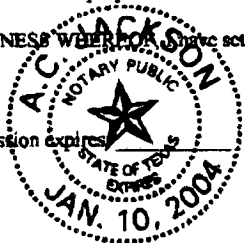

[Handwritten signature]

Notary Public

STATE OF KANSAS)

COUNTY OF SEDGWICK)

Before me, the undersigned, a Notary Public, within and for said County and State, on this 17th day of April, 2002 personally appeared Robert D. Young the Sed. Trees of MURFIN DRILLING COMPANY, INC. to me personally known to be the identical person who executed the within and foregoing instrument and acknowledged to me that he executed the same as his free and voluntary act and deed for the uses and purposes set forth therein.

IN WITNESS WHEREOF, I have set my hand and official seal this day.

My commission expires: 2-2-04

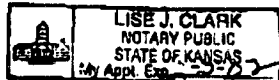

[Handwritten signature]

Notary Public Lise J. Clark

EXHIBIT "A"

15-163-23344-00-00

Lease No. 31-B:

LESSOR: David Schonthaler and Kelly Schonthaler, his wife.

LESSEE: J. Fred Hambright, Inc.

DATE: February 16, 2000

LAND: The Southeast Quarter (SE/4) (less and except a tract in square form approximately in the NE/4 SW/4 SE/4 surrounding the Schonthaler bore hole) Section 31, Township 10 South, Range 19 West, Rooks County, Kansas, covering 160 acres, more or less.

RECORDED: Book 303, Page 536, Rooks County Records.

Lease No. 32-A:

LESSOR: William David Tomasheck, a single man.

LESSEE: J. Fred Hambright, Inc.

DATE: January 28, 2000

LAND: The West Half (W/2) Section 32, Township 10 South, Range 19 West, Rooks County, Kansas, covering 320 acres, more or less.

RECORDED: Book 304, Page 202, Rooks County Records.

Lease No. 32-B:

LESSOR: Carol B. Shepherd, a single woman.

LESSEE: J. Fred Hambright, Inc.

DATE: March 14, 2000

LAND: The West Half (W/2) Section 32, Township 10 South, Range 19 West, Rooks County, Kansas, covering 320 acres, more or less.

RECORDED: Book 304, Page 661, Rooks County Records.

EXHIBIT "A"

15-163-23344-00-00

Lease No. 32-C:

LESSOR: Charles Burris, a single man
LESSEE: Trich Production, Inc.
DATE: April 28, 2001
LAND: West Half (W/2) of Section 32, Township 10 South, Range 19 West,
Rooks County, Kansas, covering 320 acres, more or less.
RECORDED: Book 312, Page 707, Rooks County Records.

Lease No. 32-D:

LESSOR: Rex Burris and Evelyn G. Burris, his wife
LESSEE: Trich Production, Inc.
DATE: April 28, 2001
LAND: West Half (W/2) Section 32, Township 10 South, Range 19 West,
Rooks County, Kansas, covering 320 acres, more or less.
RECORDED: Book 312, Page 740, Rooks County Records.

Lease No. 32-E:

LESSOR: Betty Burris, widow of Don Burris deceased
LESSEE: Trich Production, Inc.
DATE: April 28, 2001
LAND: West Half (W/2) Section 32, Township 10 South, Range 19 West,
Rooks County, Kansas, covering 320 acres, more or less.
RECORDED: Book 312, Page 743, Rooks County Records.

Lease No. 32-F:

LESSOR: George Burris and Gladys J. Burris, his wife
LESSEE: Trich Production, Inc.
DATE: April 28, 2001
LAND: West Half (W/2) Section 32, Township 10 South, Range 19 West,
Rooks County, Kansas, covering 320 acres, more or less.
RECORDED: Book 312, Page 709, Rooks County Records.

EXHIBIT "A"

15-163-23344-00-00

Lease No. 32-G:

LESSOR: Karen Svatos and Richard A. Svatos, her husband
LESSEE: Trich Production, Inc.
DATE: April 28, 2001
LAND: West Half (W/2) of Section 32, Township 10 South, Range 19 West, Rooks County, Kansas, covering 320 acres, more or less.
RECORDED: Book 312, Page 711, Rooks County Records.

Lease No. 32-H:

LESSOR: Juanita Clymer, a single woman
LESSEE: Trich Production, Inc.
DATE: April 28, 2001
LAND: West Half (W/2) Section 32, Township 10 South, Range 19 West, Rooks County, Kansas, covering 320 acres, more or less.
RECORDED: Book 313, Page 13, Rooks County Records.

Lease No. 32-I:

LESSOR: James Burris, married to Elsie P. Burris
LESSEE: Trich Production, Inc.
DATE: April 28, 2001
LAND: West Half (W/2) Section 32, Township 10 South, Range 19 West, Rooks County, Kansas, covering 320 acres, more or less.
RECORDED: Book 313, Page 240, Rooks County Records.

Lease No. 32-L:

LESSOR: Hartleigh Mellotte, aka Hartleigh U. Mellotte, married to Alice A. Mellotte
LESSEE: Trich Production, Inc.
DATE: April 28, 2001
LAND: West Half (W/2) Section 32, Township 10 South, Range 19 West, Rooks County, Kansas, covering 320 acres, more or less.
RECORDED: Book 313, Page 237, Rooks County Records.

EXHIBIT "A"

15-163-23344-00-00

Lease No. 32-K:

LESSOR: Caroline Myers, formerly Caroline Atherton, a widow
LESSEE: Trich Production, Inc.
DATE: April 26, 2001
LAND: West Half (W/2) of Section 32, Township 10 South, Range 19 West,
Rooks County, Kansas, covering 320 acres, more or less.
RECORDED: Book 312, Page 414, Rooks County Records.

Lease No. 32-L:

LESSOR: Linda Lato and Randal Lato, also known as Randal L. Lato, her husband
LESSEE: Trich Production, Inc.
DATE: May 14, 2001
LAND: West Half (W/2) Section 32, Township 10 South, Range 19 West,
Rooks County, Kansas, covering 320 acres, more or less.
RECORDED: Book 315, Page 44, Rooks County Records.

Lease No. 32-M:

LESSOR: Kenneth Dematteis, aka Ken Dematteis and Deanna Dematteis, his wife
LESSEE: Trich Production, Inc.
DATE: April 28, 2001
LAND: West Half (W/2) Section 32, Township 10 South, Range 19 West,
Rooks County, Kansas, covering 320 acres, more or less.
RECORDED: Book 315, Page 46, Rooks County Records.

Lease No. 32-N:

LESSOR: John Dematteis and Allison Dematteis, his wife
LESSEE: Trich Production, Inc.
DATE: April 28, 2001
LAND: West Half (W/2) Section 32, Township 10 South, Range 19 West,
Rooks County, Kansas, covering 320 acres, more or less.
RECORDED: Book 315, Page 48, Rooks County Records.

15-163-23344-00-0

DECLARATION OF POOLING AND UNITIZATION

RECEIVED

APR 17 2002

KCC WICHITA

KNOW ALL MEN BY THESE PRESENTS:

WHEREAS, TRICH PRODUCTION, INC., P. O. Box 1408, Longview, Texas 75606 and MURFIN DRILLING CO., INC., 250 N. Water, Suite 300, Wichita, Kansas 67202 are the owners of the Oil and Gas Leases described in Exhibit "A", attached hereto and made a part hereof, insofar as said leases cover the following lands in Rooks County, Kansas, as described herein to-wit:

TOWNSHIP 10 SOUTH, RANGE 19 WEST

Section 31: SE/4

Section 32: SW/4

and;

WHEREAS, the Oil and Gas Leases described in Exhibit "A" contain a pooling and unitization clause which states;

"Lessee, at its option, is hereby given the right and power to pool or combine the acreage covered by this lease or any portion thereof with other land, lease or leases in the immediate vicinity thereof, when in lessee's judgment it is necessary or advisable to do so in order to properly develop and operate said lease premises so as to promote the conservation of oil, gas or other minerals in and under and that may be produced from said premises, such pooling to be of tracts contiguous to one another and to be into a unit or units not exceeding 40 acres each in the event of an oil well, or into a unit or units not exceeding 640 acres each in the event of a gas well. Lessee shall execute in writing and record in the conveyance records of the county in which the land herein leased is situated an instrument identifying and describing the pooled acreage. The entire acreage so pooled into a tract or unit shall be treated, for all purposes except the payment of royalties on production from the pooled unit, as if it were included in this lease. If production is found on the pooled acreage, it shall be treated as if production is had from this lease, whether the well or wells be located on the premises covered by this lease or not. In lieu of the royalties elsewhere herein specified, lessor shall receive on production from a unit so pooled only such portion of the royalty stipulated herein as the amount of his acreage place in the unit or his royalty interest therein on an acreage basis bears to the total acreage so pooled in the particular unit involved."

WHEREAS, the undersigned TRICH PRODUCTION, INC., Lessee desires to pool and unitize all Oil and Gas Leases described in Exhibit "A", insofar and only insofar as the same cover the following described lands, to-wit:

TOWNSHIP 10 SOUTH, RANGE 19 WEST

A tract beginning at a point 580' north of the southwest corner of Section 32, thence east 660 feet, thence north 1320 feet, thence west 660 feet to the section line between Section 31 and Section 32 and continuing 660 feet west into Section 31, thence south 1320 feet, thence east 660 feet to the place of beginning.

said lands containing forty (40) acres, more or less, now being identified as "THE POOLED AND UNITIZED AREA" for production of oil and associated hydrocarbons from all zones and formations.

NOW THEREFORE, the undersigned, TRICH PRODUCTION, INC., does hereby pool and unitize the above described lands into one pooled and unitized area, containing forty (40) acres, provided that said pooling and unitization is limited to production of oil and associated hydrocarbons from all zones and formations.

The royalties accruing from any well located on said unit shall be prorated and paid to lessors of the various tracts included in the POOLED AND UNITIZED AREA in the same proportion that each tract of said Lessors bears to the total of the POOLED AND UNITIZED AREA.

IN WITNESS WHEREOF, this DECLARATION OF POOLING AND UNITIZATION, was executed this _____ day of _____, 2002.

TRICH PRODUCTION, INC.

MURFIN DRILLING CO., INC

Nathan Trich, President
