

For KCC Use: 10-2-02
Effective Date: 10-2-02
District # 4
SGA? Yes No

KANSAS CORPORATION COMMISSION
OIL & GAS CONSERVATION DIVISION
NOTICE OF INTENT TO DRILL

Must be approved by KCC five (5) days prior to commencing well

RECEIVED
SEP 27 2002
KCC WICHITA

Form C-1
September 1999
Form must be Signed
All blanks must be Filled

Expected Spud Date 10-14-2002
month day year

Spot 140' N, 150' E
- SW - NW Sec. 32 Twp. 10 S. R. 19 East West
1840 feet from 8 (N) (circle one) Line of Section
810 feet from F (W) (circle one) Line of Section
Is SECTION Regular Irregular?

OPERATOR: License# 6892
Name: Trich Production, Inc.
Address: P. O. Box 1408
Longview, Texas 75606
City/State/Zip:
Contact Person: Ken Fletcher
Phone: (972) 422-4335

(Note: Locate well on the Section Plat on reverse side)
County: Rooks
Lease Name: Carol Well #: 1-32
Field Name: Wildcat

CONTRACTOR: License# 30606
Name: Murfin Drilling Company, Inc.

Is this a Prorated / Spaced Field? Yes No
Target Formation(s): LKC/Arbuckle

Well Drilled For: Oil Enh Rec Infield Mud Rotary
 Gas Storage Pool Ext. Air Rotary
 OWWO Disposal Wildcat Cable
 Seismic; # of Holes Other

Nearest Lease or unit boundary: 810'
Ground Surface Elevation: 2110 est. feet MSL

If OWWO: old well information as follows:
Operator: _____
Well Name: _____
Original Completion Date: _____ Original Total Depth: _____

Water well within one-quarter mile: Yes No
Public water supply well within one mile: Yes No

Directional, Deviated or Horizontal wellbore? Yes No
If Yes, true vertical depth: _____
Bottom Hole Location: _____
KCC DKT #: _____

Depth to bottom of fresh water: 180'
Depth to bottom of usable water: 700' 820'

Surface Pipe by Alternate: 1 2

Length of Surface Pipe Planned to be set: 250'
Length of Conductor Pipe required: NA

Projected Total Depth: 3800'
Formation at Total Depth: Arbuckle

Water Source for Drilling Operations:
Well _____ Farm Pond _____ Other

DWR Permit #: _____
(Note: Apply for Permit with DWR)

Will Cores be taken? Yes No
If Yes, proposed zone: _____

AFFIDAVIT

The undersigned hereby affirms that the drilling, completion and eventual plugging of this well will comply with K.S.A. 55-101, et. seq.
It is agreed that the following minimum requirements will be met:

1. Notify the appropriate district office **prior** to spudding of well;
2. A copy of the approved notice of intent to drill **shall be** posted on each drilling rig;
3. The minimum amount of surface pipe as specified below **shall be set** by circulating cement to the top; in all cases surface pipe **shall be set** through all unconsolidated materials plus a minimum of 20 feet into the underlying formation.
4. If the well is dry hole, an agreement between the operator and the district office on plug length and placement is necessary **prior to plugging**;
5. The appropriate district office will be notified before well is either plugged or production casing is cemented in;
6. If an ALTERNATE II COMPLETION, production pipe shall be cemented from below any usable water to surface within **120 days** of spud date. **In all cases, NOTIFY district office** prior to any cementing.

I hereby certify that the statements made herein are true and to the best of my knowledge and belief.
Date: 9-25-02 Signature of Operator or Agent: [Signature] Title: Agent

For KCC Use ONLY
API # 15 - 163-23357-00-00
Conductor pipe required NONE feet
Minimum surface pipe required 200 feet per Alt. 2
Approved by: RSP 9-27-02
This authorization expires: 3-27-03
(This authorization void if drilling not started within 6 months of effective date.)
Spud date: _____ Agent: _____

- Remember to:**
- File Drill Pit Application (form CDP-1) with Intent to Drill;
 - File Completion Form ACO-1 within 120 days of spud date;
 - File acreage attribution plat according to field proration orders;
 - Notify appropriate district office 48 hours prior to workover or re-entry;
 - Submit plugging report (CP-4) after plugging is completed;
 - Obtain written approval before disposing or injecting salt water.

32
10
mb
19w

IN ALL CASES PLOT THE INTENDED WELL ON THE PLAT BELOW

Plat of acreage attributable to a well in a prorated or spaced field

If the intended well is in a prorated or spaced field, please fully complete this side of the form. If the intended well is in a prorated or spaced field complete the plat below showing that the well will be properly located in relationship to other wells producing from the common source of supply. Please show all the wells and within 1 mile of the boundaries of the proposed acreage attribution unit for gas wells and within 1/2 mile of the boundaries of the proposed acreage attribution unit for oil wells.

API No. 15 - _____
Operator: _____
Lease: _____
Well Number: _____
Field: _____
Number of Acres attributable to well: _____
QTR / QTR / QTR of acreage: _____

Location of Well: County: _____
_____ feet from S / N (circle one) Line of Section
_____ feet from E / W (circle one) Line of Section
Sec. _____ Twp. _____ S. R. _____ East West
Is Section _____ Regular or _____ Irregular
If Section is Irregular, locate well from nearest corner boundary.
Section corner used: ___ NE ___ NW ___ SE ___ SW

PLAT

*(Show location of the well and shade attributable acreage for prorated or spaced wells.)
(Show footage to the nearest lease or unit boundary line.)*

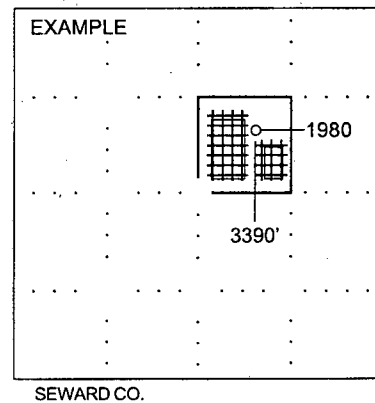
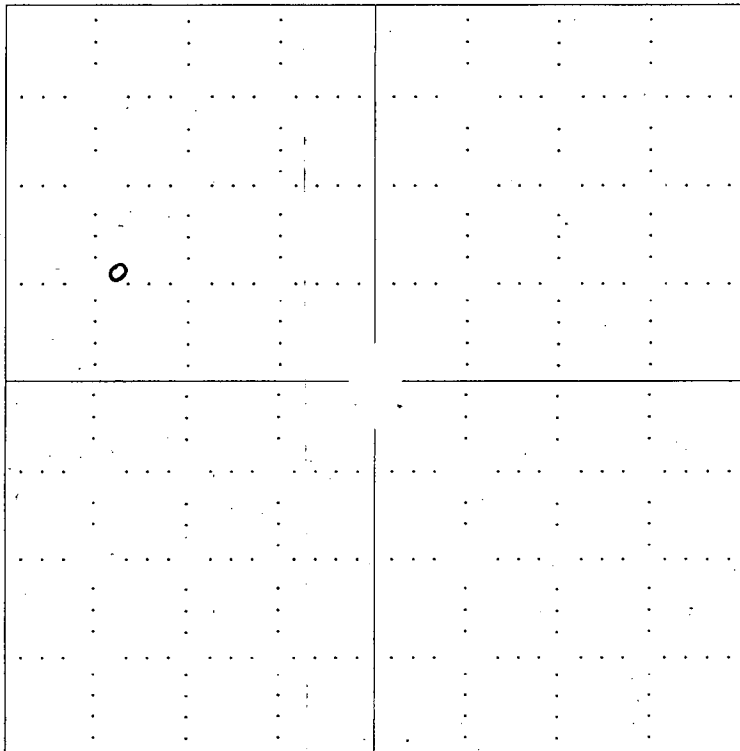

NOTE: In all cases locate the spot of the proposed drilling location.

In plotting the proposed location of the well, you must show:

1. The manner in which you are using the depicted plat by identifying section lines, i.e. 1 section, 1 section with 8 surrounding sections, 4 sections, etc.
2. The distance of the proposed drilling location from the section's south / north and east / west.
3. The distance to the nearest lease or unit boundary line.
4. If proposed location is located within a prorated or spaced field a certificate of acreage attribution plat must be attached: (CO-7 for oil wells; CG-8 for gas wells).

PLAT AND CERTIFICATION OF ACREAGE ATTRIBUTABLE TO A OIL WELL RECEIVED

Kansas Corporation Commission, Conservation Division
 Finney State Office Building, 130 South Market, Room 2078
 Wichita, Kansas 67202

SEP 27 2002

KCC WICHITA

API NUMBER 15- _____

LOCATION OF WELL: COUNTY _____ Rooks

OPERATOR Trich Production, Inc.

LEASE Carol

WELL NUMBER 1-32

FIELD Wildcat

1840 feet from south/north line of section

810 feet from east / west line of section

SECTION 32 TWP 10 (S) RG 19 E (W)

IS SECTION X REGULAR or _____ IRREGULAR

IF SECTION IS IRREGULAR, LOCATE WELL FROM
 NEAREST CORNER BOUNDARY. (check line below)

Section corner used: _____ NE X NW _____ SE _____ SW

NUMBER OF ACRES ATTRIBUTABLE TO WELL 10

QTR/QTR/QTR OF ACREAGE Approx-C SW - NW

(Show the location of the well and shade attributable acreage for prorated or spaced wells).
 (Show the footage to the nearest lease or unit boundary line; and show footage to the nearest common source supply well).

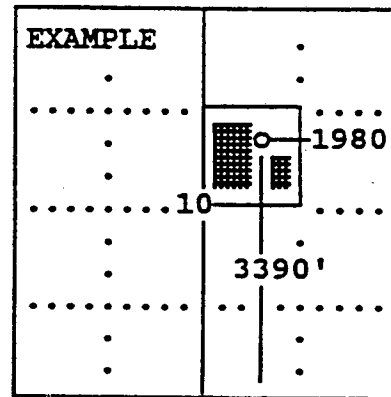
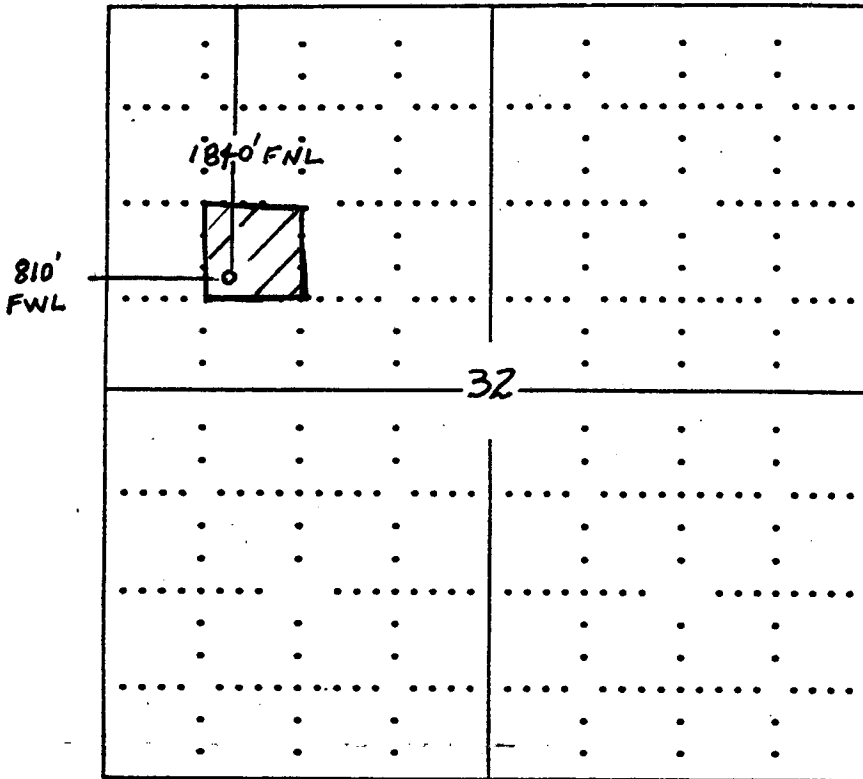

SEWARD CO.

The undersigned hereby certifies as _____ Agent _____ (title) for

Trich Production, Inc.

(Co.), a duly authorized agent, that all

information shown hereon is true and correct to the best of my knowledge and belief, that all acreage claimed attributable to the well named herein is held by production from that well.

Signature [Handwritten Signature]

Subscribed and sworn to before me on this 25th day of September, 192002

[Handwritten Signature]

Notary Public

My Commission expires 10-31-05

