

FOR KCC USE:

FORM C-1 7/91

FORM MUST BE TYPED

FORM MUST BE SIGNED

ALL BLANKS MUST BE FILLED

EFFECTIVE DATE: 10-26-96

State of Kansas  
NOTICE OF INTENTION TO DRILL

Must be approved by the K.C.C. five (5) days prior to commencing well.

DISTRICT # 4

SGA? Yes  No

Expected Spud Date October 24, 1996  
month day year

Spot SW NW SW Sec 12 Twp 9S S, Rg 17W East West

OPERATOR: License # 8735  
Name: S & M OIL  
Address: 2730 Thunderbird Drive  
City/State/Zip: Hays, Kansas 67601  
Contact Person: Steve Crawford  
Phone: 913/628-3658

1650 feet from South North line of Section  
330 feet from East West line of Section  
IS SECTION X REGULAR IRREGULAR?

(NOTE: Locate well on the Section Plat on Reverse Side)  
County: Rooks  
Lease Name: McClay Well #: 9  
Field Name:

CONTRACTOR: License #: 5929  
Name: DUKE DRILLING CO., INC.

CORRECTION 2-9-98 JK

Is this a Prorated/Spaced Field? yes X no

Target Formation(s): Arbuckle  
Nearest lease or unit boundary: 330'

Ground Surface Elevation: EST. 2000' feet MSL

Water well within one-quarter mile: yes X no

Public water supply well within one mile: yes X no

Depth to bottom of fresh water: 180'

Depth to bottom of usable water: 800'

Surface Pipe by Alternate: X

Length of Surface Pipe Planned to be set: 200' 330' 700' OK

Length of Conductor pipe required: N/A

Projected Total Depth: 3400'

Formation at Total Depth: Arbuckle

Water Source for Drilling Operations: well farm pond X other

Well Drilled For: Well Class: Type Equipment:

- X. Oil ... Enh Rec X. Infield X. Mud Rotary
... Gas ... Storage ... Pool Ext. ... Air Rotary
... OHWO ... Disposal ... Wildcat ... Cable
... Seismic; ... # of Holes ... Other
... Other

If OWMO: old well information as follows:
Operator:
Well Name:
Comp. Date: Old Total Depth

Directional, Deviated or Horizontal wellbore? yes X no
If yes, true vertical depth:
Bottom Hole Location:

Will Cores Be Taken? yes X no
If yes, proposed zone:

AFFIDAVIT

RECEIVED

KANSAS CORPORATION COMMISSION

The undersigned hereby affirms that the drilling, completion and eventual plugging of this well will comply with K.S.A. 55-101, et. seq.

It is agreed that the following minimum requirements will be met:

OCT 21 1996

10/21/96

- 1. Notify the appropriate district office prior to spudding of well;
2. A copy of the approved notice of intent to drill shall be posted on each drilling rig;
3. The minimum amount of surface pipe as specified below shall be set by circulating cement to the CONSERVATION BASES surface pipe shall be set through all unconsolidated materials plus a minimum of 20 feet into the underlying formation;
4. If the well is dry hole, an agreement between the operator and the district office on plug length and placement is necessary prior to plugging;
5. The appropriate district office will be notified before well is either plugged or production casing is cemented in;
6. IF AN ALTERNATE II COMPLETION, PRODUCTION PIPE SHALL BE CEMENTED FROM BELOW ANY USABLE WATER TO SURFACE WITHIN 120 DAYS OF SPUD DATE. IN ALL CASES, NOTIFY DISTRICT OFFICE PRIOR TO ANY CEMENTING.

I hereby certify that the statements made herein are true and to the best of my knowledge and belief.

Date: 10/21/96 Signature of Operator or Agent: [Signature] Title: Agent

FOR KCC USE:
API # 15- 163-232900000
Conductor pipe required NONE feet
Minimum surface pipe required 820' feet per Alt. (1) X
Approved by: JK 10-21-96
This authorization expires: 4-21-97
(This authorization void if drilling not started within 6 months of effective date.)
Spud date: Agent:

REMEMBER TO:

- File Drill Pit Application (form CDP-1) with Intent to Drill;
- File Completion Form ACO-1 within 120 days of spud date;
- File acreage attribution plat according to field proration orders;
- Notify appropriate district office 48 hours prior to workover or re-entry;
- Submit plugging report (CP-4) after plugging is completed;
- Obtain written approval before disposing or injecting salt water.

Mail to: KCC - Conservation Division, 130 S. Market - Room 2078, Wichita, Kansas 67202.

Handwritten marks: 2, 0, 17M

**IN ALL CASES PLOT THE INTENDED WELL ON THE PLAT BELOW**

**PLAT OF ACREAGE ATTRIBUTABLE TO A WELL IN A PRORATED OR SPACED FIELD**

If the intended well is in a prorated or spaced field, please fully complete this side of the form. If the intended well is in a prorated or spaced field complete the plat below showing that the well will be properly located in relationship to other wells producing from the common source of supply. Please show all the wells within 1 mile of the boundaries of the proposed acreage attribution unit for gas wells and within 1/2 mile of the boundaries of the proposed acreage attribution unit for oil wells.

API NO. 15- \_\_\_\_\_  
 OPERATOR \_\_\_\_\_ LOCATION OF WELL: COUNTY \_\_\_\_\_  
 LEASE \_\_\_\_\_ feet from south/north line of section  
 WELL NUMBER \_\_\_\_\_ feet from east/west line of section  
 FIELD \_\_\_\_\_ SECTION \_\_\_\_\_ TWP \_\_\_\_\_ RG \_\_\_\_\_

NUMBER OF ACRES ATTRIBUTABLE TO WELL \_\_\_\_\_ IS SECTION \_\_\_\_\_ REGULAR or \_\_\_\_\_ IRREGULAR  
 QTR/QTR/QTR OF ACREAGE \_\_\_\_\_ **IF SECTION IS IRREGULAR, LOCATE WELL FROM NEAREST CORNER BOUNDARY.**

Section corner used: \_\_\_\_\_ NE \_\_\_\_\_ NW \_\_\_\_\_ SE \_\_\_\_\_ SW

**PLAT**

(Show location of the well and shade attributable acreage for prorated or spaced wells.)  
 (Show footage to the nearest lease or unit boundary line.)

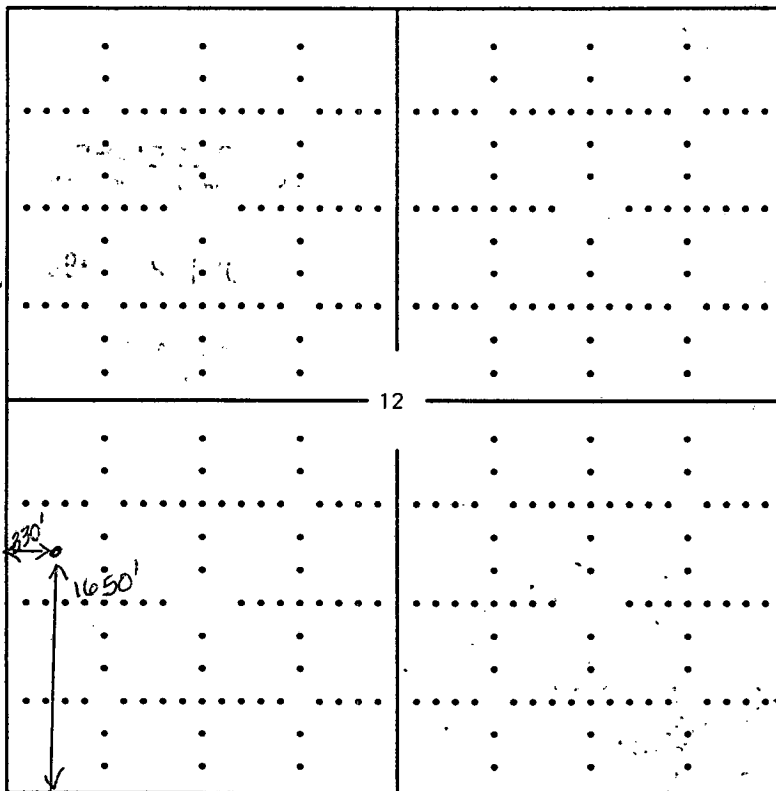

ROOKS COUNTY

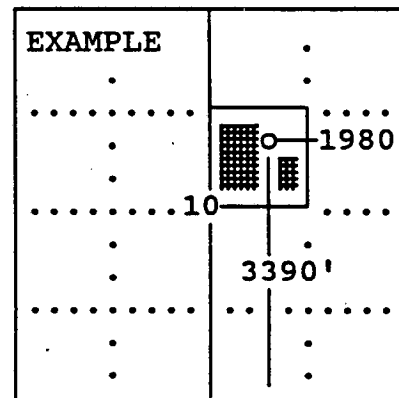

SEWARD CO.

**In plotting the proposed location of the well, you must show:**

- 1) The manner in which you are using the depicted plat by identifying section lines, i.e. 1 section, 1 section with 8 surrounding sections, 4 sections, etc.;
- 2) the distance of the proposed drilling location from the section's south/north and east/west; and
- 3) the distance to the nearest lease or unit boundary line.

EFFECTIVE DATE: 10-26-96

CORRECTION

FORM MUST BE TYPED  
FORM MUST BE SIGNED  
ALL BLANKS MUST BE FILLED

DISTRICT # 4  
SGA? Yes No

State of Kansas  
NOTICE OF INTENTION TO DRILL

Must be approved by the K.C.C. five (5) days prior to commencing well.

Expected Spud Date: October 24, 1996  
month day year

Spot SW NW SW Sec 12 Twp 9s S, Rg 17w East West

OPERATOR: License # 8735  
Name: S & M Oil  
Address: 2730 Thunderbird Dr.  
City/State/Zip: Hays, Kansas 67601  
Contact Person: Steve Crawford  
Phone: 913-628-3658

1650 feet from South / North line of Section  
330 feet from East / West line of Section  
IS SECTION X REGULAR IRREGULAR?

(NOTE: Locate well on the Section Plat on Reverse Side)

CONTRACTOR: License #: 5929  
Name: Duke Drilling Co., Inc.

County: Rooks  
Lease Name: McClay Well #: 9

Field Name:  
Is this a Prorated/Spaced Field? yes no X

Target Formation(s): Arbuckle

Nearest lease or unit boundary: 330!  
Ground Surface Elevation: Est. 2000! feet MSL

Water well within one-quarter mile: yes no X  
Public water supply well within one mile: yes no X

Depth to bottom of fresh water: 180!  
Depth to bottom of usable water: 800!

\* Surface Pipe by Alternate: 1 X 2

\* Length of Surface Pipe Planned to be set: 200!  
Length of Conductor pipe required: N/A

Projected Total Depth: 3400!  
Formation at Total Depth: Arbuckle

Water Source for Drilling Operations:  
... well ... farm pond X other

Well Drilled For: Well Class: Type Equipment:

X Oil Enh Rec X Infield X Mud Rotary  
... Gas ... Storage ... Pool Ext. ... Air Rotary  
... OMWO ... Disposal ... Wildcat ... Cable  
... Seismic; ... # of Holes ... Other

If OMWO: old well information as follows:  
Operator:  
Well Name:  
Comp. Date: Old Total Depth

Directional, Deviated or Horizontal wellbore? yes no X  
If yes, true vertical depth:  
Bottom Hole Location:

Will Cores Be Taken?: yes no X  
If yes, proposed zone:

\* WAS: ALT 1  
LENGTH OF SURFACE PIPE PLANNED

AFFIDAVIT

The undersigned hereby affirms that the drilling, completion and eventual plugging of this well will comply with K.S.A. 55-101, et. seq.  
It is agreed that the following minimum requirements will be met:

TO BE SET WAS: 1,330 FEET.

1. Notify the appropriate district office prior to spudding of well; IS: ALT 2 200 FEET OF SURFACE CASING
2. A copy of the approved notice of intent to drill shall be posted on each drilling rig;
3. The minimum amount of surface pipe as specified below shall be set by circulating cement to the top; in all cases surface pipe shall be set through all unconsolidated materials plus a minimum of 20 feet into the underlying formation;
4. If the well is dry hole, an agreement between the operator and the district office on plug length and placement is necessary prior to plugging;
5. The appropriate district office will be notified before well is either plugged or production casing is cemented in;
6. IF AN ALTERNATE II COMPLETION, PRODUCTION PIPE SHALL BE CEMENTED FROM BELOW ANY USABLE WATER TO SURFACE WITHIN 120 DAYS OF SPUD DATE. IN ALL CASES, NOTIFY DISTRICT OFFICE PRIOR TO ANY CEMENTING.

I hereby certify that the statements made herein are true and to the best of my knowledge and belief.

Date: 2-2-98 Signature of Operator or Agent: Steve Crawford Title: Operator

MIN. SURFACE CASING  
REQUIRED WAS: 820' \*  
ALT 1

MIN. SURFACE CASING  
IS: 200' ALT 2.

FOR KCC USE: 163-732900000  
 API # 15- 163-732900000  
 Conductor pipe required NONE feet  
 Minimum surface pipe required 200 feet per Alt. X(2)  
 Approved by: DR 2-9-98 JK 70RIG 10-21-96 JK  
 This authorization expires: 4-21-97  
 (This authorization void if drilling not started within 6 months of effective date.)  
 Spud date: Agent:

FEB 5

REMEMBER TO:

- File Drill Pit Application (form CDP-1) with Intent to Drill;
- File Completion Form ACO-1 within 120 days of spud date;
- File acreage attribution plat according to field proration orders;
- Notify appropriate district office 48 hours prior to workover or re-entry;
- Submit plugging report (CP-4) after plugging is completed;
- Obtain written approval before disposing or injecting salt water.

**IN ALL CASES PLOT THE INTENDED WELL ON THE PLAT BELOW**

**PLAT OF ACREAGE ATTRIBUTABLE TO A WELL IN A PRORATED OR SPACED FIELD**

If the intended well is in a prorated or spaced field, please fully complete this side of the form. If the intended well is in a prorated or spaced field complete the plat below showing that the well will be properly located in relationship to other wells producing from the common source of supply. Please show all the wells within 1 mile of the boundaries of the proposed acreage attribution unit for gas wells and within 1/2 mile of the boundaries of the proposed acreage attribution unit for oil wells.

API NO. 15- \_\_\_\_\_  
 OPERATOR \_\_\_\_\_  
 LEASE \_\_\_\_\_  
 WELL NUMBER \_\_\_\_\_  
 FIELD \_\_\_\_\_

LOCATION OF WELL: COUNTY \_\_\_\_\_  
 \_\_\_\_\_ feet from south/north line of section  
 \_\_\_\_\_ feet from east/west line of section  
 SECTION \_\_\_\_\_ TWP \_\_\_\_\_ RG \_\_\_\_\_

NUMBER OF ACRES ATTRIBUTABLE TO WELL \_\_\_\_\_  
 QTR/QTR/QTR OF ACREAGE \_\_\_\_\_

IS SECTION \_\_\_\_\_ REGULAR or \_\_\_\_\_ IRREGULAR  
**IF SECTION IS IRREGULAR, LOCATE WELL FROM NEAREST CORNER BOUNDARY.**

Section corner used: \_\_\_\_\_ NE \_\_\_\_\_ NW \_\_\_\_\_ SE \_\_\_\_\_ SW

**PLAT**

(Show location of the well and shade attributable acreage for prorated or spaced wells.)

(Show footage to the nearest lease or unit boundary line.)

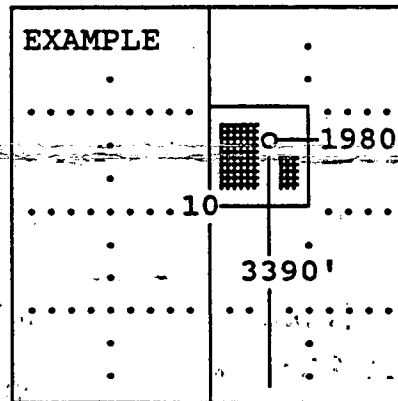
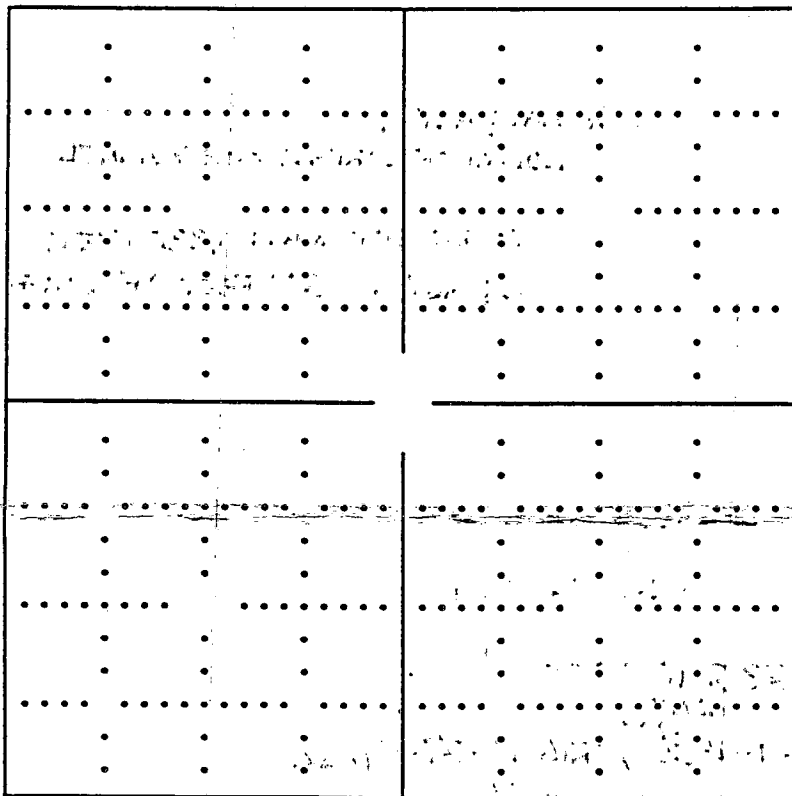

SEWARD CO.

**In plotting the proposed location of the well, you must show:**

- 1) The manner in which you are using the depicted plat by identifying section lines, i.e. 1 section, 1 section with 8 surrounding sections, 4 sections, etc.;
- 2) the distance of the proposed drilling location from the section's south/north and east/west; and
- 3) the distance to the nearest lease or unit boundary line.