

FOR KCC USE:

FORM C-1 7/91

EFFECTIVE DATE: 12-5-92

State of Kansas

FORM MUST BE TYPED

FORM MUST BE SIGNED

ALL BLANKS MUST BE FILLED

DISTRICT #

NOTICE OF INTENTION TO DRILL

SEAT Yes No

Must be approved by the K.C.C. five (5) days prior to commencing well

Expected Spud Date December 28 1992
month day year

Spot NE NE SW Sec 27 Twp 8 S Rg 18W East West

OPERATOR: License # 30722 ✓
Name: Edwin C. Schuett & Sharp Engineering
Address: 1616 Glenarm Place, Suite 1804
City/State/Zip: Denver, CO 80202
Contact Person: Gary Sharp
Phone: 316-733-5577

2310- feet from South ~~XXXX~~ line of Section
2310- feet from ~~XXXX~~ / West line of Section

CONTRACTOR: License # 8241 ✓
Name: Emphasis Oil Operations

IS SECTION REGULAR IRREGULAR?
(NOTE: Locate well on the Section Plat on Reverse Side)

Well Drilled For:	Well Class:	Type Equipment:
<input checked="" type="checkbox"/> Oil	... Enh Rec	... Infield
... Gas	... Storage	... Pool Ext.
... OWVO	... Disposal	<input checked="" type="checkbox"/> Wildcat
... Seismic:	... # of Holes	... Other
... Other		

County: Rooks
Lease Name: Fleming Well #: 1
Field Name: exploratory Wildcat
Is this a Prorated/Spaced Field? ... yes no

If OWVO: old well information as follows:
Operator: _____
Well Name: _____
Comp. Date: _____ Old Total Depth _____

Target Formation(s): Arbuckle
Nearest lease or unit boundary: 330'
Ground Surface Elevation: 1990' est. feet MSL
Water well within one-quarter mile: ... yes no

Directional, Deviated or Horizontal wellbore? ... yes no
If yes, true vertical depth: _____
Bottom Hole Location: _____

Public water supply well within one mile: ... yes no
Depth to bottom of fresh water: 120'
Depth to bottom of usable water: 930'
Surface Pipe by Alternate: ... 1 2
Length of Surface Pipe Planned to be set: 280' 500'
Length of Conductor pipe required: 0
Projected Total Depth: 3500'
Formation at Total Depth: Arbuckle
Water Source for Drilling Operations: well farm pond other

AFFIDAVIT

The undersigned hereby affirms that the drilling, completion and eventual plugging of this well will comply with K.S.A. 55-101, et. seq.
It is agreed that the following minimum requirements will be met:

1. Notify the appropriate district office prior to spudding of well;
2. A copy of the approved notice of intent to drill shall be posted on each drilling rig;
3. The minimum amount of surface pipe as specified below shall be set by circulating cement to the top; in all cases surface pipe shall be set through all unconsolidated materials plus a minimum of 20 feet into the underlying formation;
4. If the well is dry hole, an agreement between the operator and the district office on plug length and placement is necessary prior to plugging;
5. The appropriate district office will be notified before well is either plugged or production casing is cemented in;
6. IF AN ALTERNATE II COMPLETION, PRODUCTION PIPE SHALL BE CEMENTED FROM BELOW ANY USABLE WATER TO SURFACE WITHIN 120 DAYS OF SPUD DATE. IN ALL CASES, NOTIFY DISTRICT OFFICE PRIOR TO ANY CEMENTING.

I hereby certify that the statements made herein are true and to the best of my knowledge and belief.
Date: 12-7-92 Signature of Operator or Agent: Edwin C. Schuett Title: Operator

FOR KCC USE:
 API # 15- 163-23,213-00-00
 Conductor pipe required None feet
 Minimum surface pipe required 300' feet per Alt. ②
 Approved by: CB 12-10-92
 This authorization expires: 6-10-93
 (This authorization void if drilling not started within 6 months of effective date.)
 Spud date: _____ Agent: _____

RECEIVED
 STATE CORPORATION COMMISSION
 DEC 10 1992
 CONSERVATION DIVISION
 Wichita, Kansas

REMEMBER TO:

- File Drill Pit Application (form CDP-1) with Intent to Drill;
- File Completion Form ACO-1 within 120 days of spud date;
- File acreage attribution plat according to field prorations orders;
- Notify appropriate district office 48 hours prior to workover or re-entry;
- Submit plugging report (CP-4) after plugging is completed;
- Obtain written approval before disposing or injecting salt water.

Mail to: Conservation Division, 200 Colorado Derby Building, 202 W. First St., Wichita, Kansas 67202-1286.

IN ALL CASES PLOT THE INTENDED WELL ON THE PLAT BELOW

PLAT OF ACREAGE ATTRIBUTABLE TO A WELL IN A PRORATED OR SPACED FIELD

If the intended well is in a prorated or spaced field, please fully complete this side of the form. If the intended well is in a prorated or spaced field complete the plat below showing that the well will be properly located in relationship to other wells producing from the common source of supply. Please show all the wells within 1 mile of the boundaries of the proposed acreage attribution unit for gas wells and within 1/2 mile of the boundaries of the proposed acreage attribution unit for oil wells.

API NO. 15- _____
 OPERATOR _____ LOCATION OF WELL: COUNTY _____
 LEASE _____ feet from south/north line of section
 WELL NUMBER _____ feet from east/west line of section
 FIELD _____ SECTION _____ TWP _____ RG _____

NUMBER OF ACRES ATTRIBUTABLE TO WELL _____ IS SECTION _____ REGULAR or _____ IRREGULAR
 QTR/QTR/QTR OF ACREAGE _____ IF SECTION IS IRREGULAR, LOCATE WELL FROM NEAREST CORNER BOUNDARY.

Section corner used: _____ NE _____ NW _____ SE _____ SW
PLAT

(Show location of the well and shade attributable acreage for prorated or spaced wells.)
 (Show footage to the nearest lease or unit boundary line.)

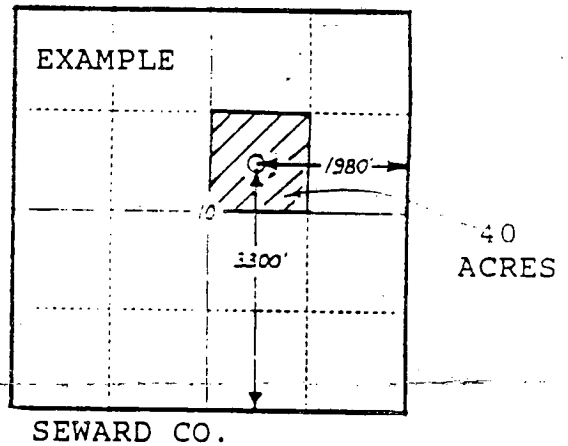
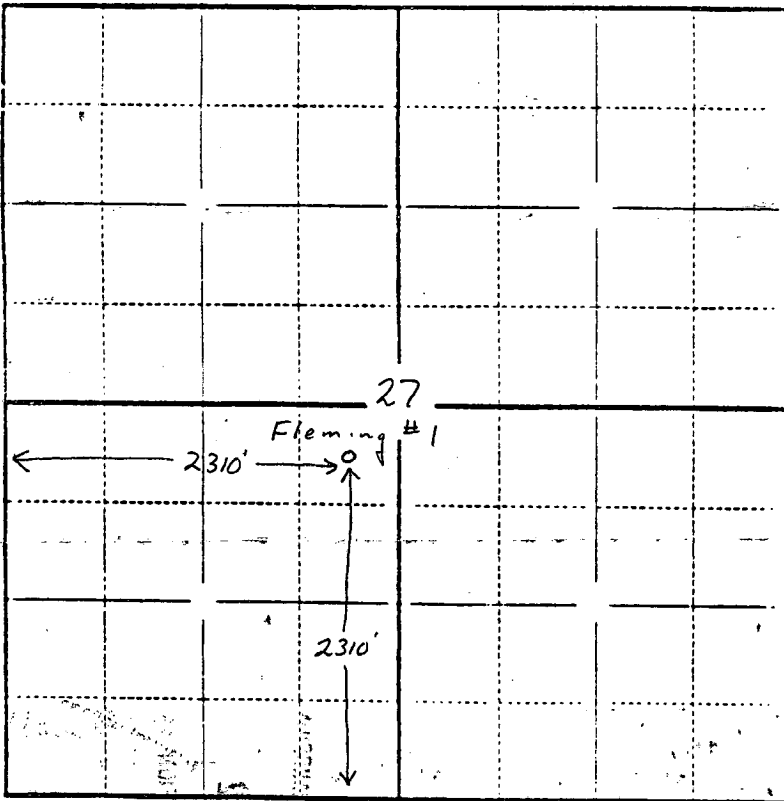

T8S R18W
 =Rooks County

In plotting the proposed location of the well, you must show:

- 1) The manner in which you are using the depicted plat by identifying section lines, i.e. 1 section, 1 section with 8 surrounding sections, 4 sections, etc.;
- 2) the distance of the proposed drilling location from the section's south/north and east/west lines; and
- 3) the distance to the nearest lease or unit boundary line.

Joan Finney
Governor

Jim Robinson
Chairman

F. S. Jack Alexander
Commissioner

Rachel C. Lipman
Commissioner

Judith McConnell
Executive Director

Brian Moline
General Counsel



Kansas Corporation Commission

IS-163-23213-00-00

December 11, 1992

To: Edwin C. Schuett
1616 Glenarm Place
Suite 1804
Denver, CO 80202

From: Chris Bean

Re: Fleming 1
Approximately ne ne sw Section 27-8S-18W
Rooks County, KS

Dear Mr. Sharp,

Please note that this intended well location is within a known shallow flow area of groundwater for elevations below 1880 feet G.L.. Caution should be exercised during the drilling of this well due to problems with shallow reservoirs which may flow during surface pipe drilling operations.

Sincerely,

Chris Bean

Chris Bean
Geologist

CC: District #4
Dave Williams
Gary Sharp