

NOTICE OF INTENTION TO DRILL

(see rules on reverse side)

Expected Spud Date... 12... 10... 87... month day year

API Number 15- 065-22,428-00 DA East

OPERATOR: License # 7448 Name Burch Exploration Inc. Address 11225 Edinborough Way City/State/Zip Parker, Colo. 80134 Contact Person David Burch Phone 303-841-9417

C. N 1/2 N 1/2 NE Sec. 5 Twp. 8 S, Rg. 22 4950 Ft. from South Line of Section 1320 Ft. from East Line of Section

(Note: Locate well on Section Plat on reverse side)

CONTRACTOR: License # 8682 Name Golden Eagle Drilling Inc. City/State McCook, Ne. 69001

Nearest lease or unit boundary line 330 feet County Graham Lease Name Chalfant Well # 1

Well Drilled For: Well Class: Type Equipment: X Oil Storage X Infield X Mud Rotary Gas Inj Pool Ext Air Rotary OWWO Expl Wildcat Cable

Ground surface elevation 2161 feet MSL Domestic well within 330 feet: yes no Municipal well within one mile: yes no

If OWWO: old well info as follows:

Operator Well Name Comp Date Old Total Depth

Depth to bottom of fresh water 200 180 Depth to bottom of usable water 250 1100 Surface pipe by Alternate 1 2 X Surface pipe planned to be set 300 Conductor pipe required 0 Projected Total Depth 4100 feet Formation LKC

I certify that well will comply with K.S.A. 55-101, et seq., plus eventually plugging hole to KCC specifications.

Date 11-20-87 Signature of Operator or Agent Title agent

For KCC Use:

Conductor Pipe Required feet; Minimum Surface Pipe Required 200 feet per Alt. This Authorization Expires 5-23-88 Approved By PH 11-23-87

EFFECTIVE DATE: 11-28-87

Must be filed with the K.C.C. five (5) days prior to commencing well  
 This card void if drilling not started within six (6) months of date received by K.C.C.

**Important procedures to follow:**

**A Regular Section of Land**  
**1 Mile = 5,280 Ft.**

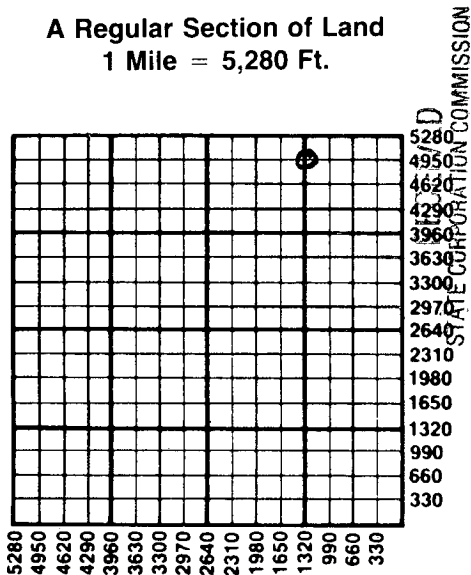

NOV 23 1987  
 NOV 23 1987  
 CONSERVATION DIVISION  
 Wichita, Kansas

1. Notify District office before setting surface casing.
2. Set surface casing by circulating cement to the top.
3. File completion forms ACO-1 with K.C.C. within 120 days of well spud date, following instructions on ACO-1, side 1, and including copies of wireline logs.  
 Notify District office 48 hours prior to old well workover or re-entry.  
 Prior to filing Intent, prepare a proposed plugging plan in case well is D & A, then obtain approval of plan when calling district office prior to setting surface pipe.
6. Submit plugging report (CP-4) to K.C.C. after plugging is completed.
7. Obtain an approved injection docket number before disposing of salt water.
8. Notify K.C.C. within 10 days when injection commences or terminates.
9. If an alternate 2 completion, cement in the production pipe from below any usable water to surface within 120 days of spud date.

State Corporation Commission of Kansas  
 Conservation Division  
 200 Colorado Derby Building  
 Wichita, Kansas 67202-1212  
 (316) 263-3238