

FOR KCC USE:

FORM C-1 7/91

EFFECTIVE DATE: 4-30-94

FORM MUST BE TYPED

DISTRICT 4

FORM MUST BE SIGNED

YEAR 1994

ALL BLANKS MUST BE FILLED

State of Kansas
NOTICE OF INTENTION TO DRILL

Must be approved by the K.C.C. five (5) days prior to commencing well

Expected Spud Date 5 month 2 day 94 year

Spot C N 1/2 NW Sec 30 Twp 8 S. Rg 24 East West

OPERATOR: License # 3736
Name: RLT Investment
Address: Box 63
City/State/Zip: Morland, KS 67650
Contact Person: Leon Pfeifer
Phone: 913-627-5711

660 feet from SOUTH/ North line of Section
1320 feet from WEST / West line of Section

IS SECTION X REGULAR IRREGULAR?
(NOTE: Locate well on the Section Plat on Reverse Side)
County: Graham
Lease Name: Keith Well #: 1-30
Field Name: Morland CONF.

CONTRACTOR: License # 4958
Name: Mallard JV, Inc.

Is this a Prorated/Spaced Field? yes X no
Target Formation(s): Lansing K.C.
Nearest lease or unit boundary: 660
Ground Surface Elevation: 2420 feet MSL

Well Drilled For: Well Class: Type Equipment:
Oil Enh Rec Infield Mud Rotary
Gas Storage Pool Ext. Air Rotary
OAWD Disposal Wildcat Cable
Seismic: # of Holes Other

Water well within one-quarter mile: yes X no
Public water supply well within one mile: yes X no
Depth to bottom of fresh water: 130'
Depth to bottom of usable water: 1200'

If OAWD: old well information as follows:
Operator:
Well Name:
Comp. Date: Old Total Depth

Surface Pipe by Alternate: 1 X 2
Length of Surface Pipe Planned to be set: 200'
Length of Conductor pipe required: N/A
Projected Total Depth: 4000'
Formation at Total Depth: Base K.C.

Directional, Deviated or Horizontal wellbores? yes X no
If yes, true vertical depth:
Bottom Hole Location:

Water Source for Drilling Operations:
X well farm pond other
DWR Permit #:
Will Cores Be Taken? yes X no
If yes, proposed zone:

AFFIDAVIT

The undersigned hereby affirms that the drilling, completion and eventual plugging of this well will comply with the provisions of the Kansas Conservation Division Act, Chapter 101, et. seq.

- It is agreed that the following minimum requirements will be met:
1. Notify the appropriate district office prior to spudding of well;
 2. A copy of the approved notice of intent to drill shall be posted on each drilling rig;
 3. The minimum amount of surface pipe as specified below shall be set by circulating cement to the surface pipe shall be set through all unconsolidated materials plus a minimum of 20 feet into the underlying formation;
 4. If the well is dry hole, an agreement between the operator and the district office on plug length and placement is necessary prior to plugging;
 5. The appropriate district office will be notified before well is either plugged or production casing is cemented in;
 6. IF AN ALTERNATE II COMPLETION, PRODUCTION PIPE SHALL BE CEMENTED FROM BELOW ANY USABLE WATER TO SURFACE WITHIN 120 DAYS OF SPUD DATE. IN ALL CASES, NOTIFY DISTRICT OFFICE PRIOR TO ANY CEMENTING.

I hereby certify that the statements made herein are true and to the best of my knowledge and belief.
Date: 04/22/94 Signature of Operator or Agent: Leon Pfeifer Title: Partner

RECEIVED
STATE CORPORATION COMMISSION
APR 25 1994
4-25-1994
CONSERVATION DIVISION

FOR KCC USE:
API # 15- 065-22739-00-00
Conductor pipe required NONE feet
Minimum surface pipe required 200' feet per Alt. X 2
Approved by: CHRIS B. 4-25-94
This authorization expires: 10-25-94
(This authorization void if drilling not started within 6 months of effective date.)
Spud date: Agent:

REMEMBER TO:

- File Drilling Pit Application (form CDP-1) with Intent to Drill;
- File Completion Form ACO-1 within 120 days of spud date;
- File acreage attribution plat according to field proration orders;
- Notify appropriate district office 48 hours prior to workover or re-entry;
- Submit plugging report (CP-4) after plugging is completed;
- Obtain written approval before disposing or injecting salt water.

Mail to: Conservation Division, 208 Colorado Derby Building, 202 W. First St., Wichita, Kansas 67202-1286.

30
4
24

IN ALL CASES PLOT THE INTENDED WELL ON THE PLAT BELOW

PLAT OF ACREAGE ATTRIBUTABLE TO A WELL IN A PRORATED OR SPACED FIELD

If the intended well is in a prorated or spaced field, please fully complete this side of the form. If the intended well is in a prorated or spaced field complete the plat below showing that the well will be properly located in relationship to other wells producing from the common source of supply. Please show all the wells within 1 mile of the boundaries of the proposed acreage attribution unit for gas wells and within 1/2 mile of the boundaries of the proposed acreage attribution unit for oil wells.

API NO. 15- _____
 OPERATOR RLT Investment
 LEASE Keith
 WELL NUMBER #1-30
 FIELD Morland CONF.

LOCATION OF WELL: COUNTY Graham
660 feet from ~~south~~/north line of section
1320 feet from ~~east~~/west line of section
 SECTION 30 TWP 8 RG 24

NUMBER OF ACRES ATTRIBUTABLE TO WELL 10
 QTR/QTR/QTR OF ACREAGE C - N $\frac{1}{2}$ - NW

IS SECTION X REGULAR or IRREGULAR
IF SECTION IS IRREGULAR, LOCATE WELL FROM NEAREST CORNER BOUNDARY.

Section corner used: NE NW SE SW

PLAT

(Show location of the well and shade attributable acreage for prorated or spaced wells.)
 (Show footage to the nearest lease or unit boundary line.)

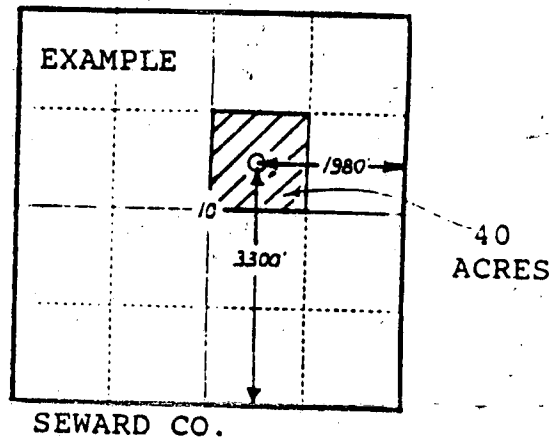
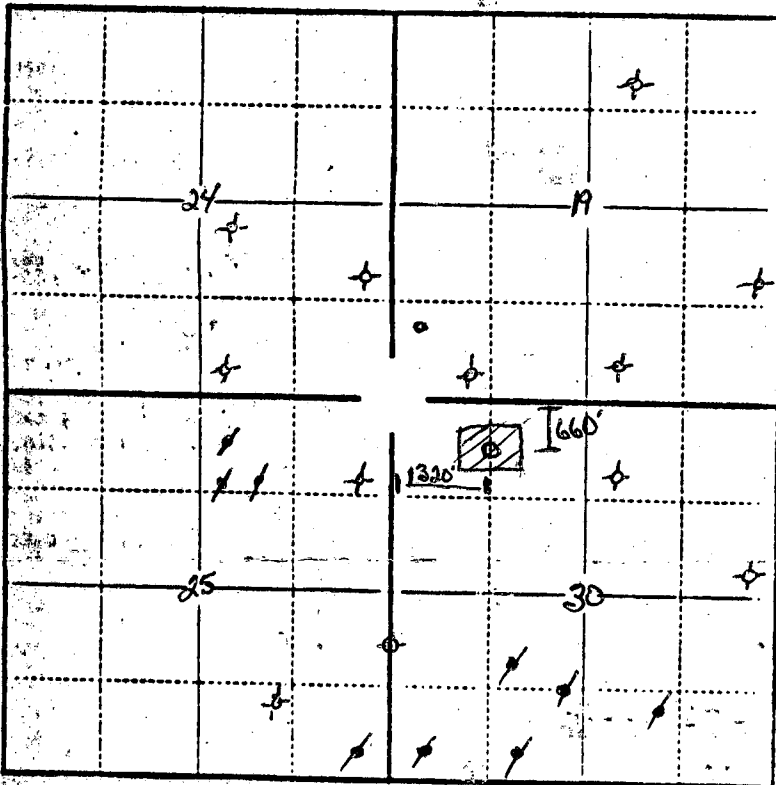

In plotting the proposed location of the well, you must show:

- 1) The manner in which you are using the depicted plat by identifying section lines, i.e. 1 section, 1 section with 8 surrounding sections, 4 sections, etc.;
- 2) the distance of the proposed drilling location from the section's south/north and east/west lines; and
- 3) the distance to the nearest lease or unit boundary line.