

For KCC Use:
 Effective Date: 10-22-00
 District #: 4
 SGA? Yes No

KANSAS CORPORATION COMMISSION
 OIL & GAS CONSERVATION DIVISION

Form C-1
 September 1999
 Form must be Typed
 Form must be Signed
 All blanks must be Filled

NOTICE OF INTENT TO DRILL

Must be approved by KCC five (5) days prior to commencing well

Expected Spud Date Nov. 15 2000
month day year

OPERATOR: License# 32686
 Name: Reilly Oil Co. Inc.
 Address: P. O. Box 1200
 City/State/Zip: Lawrence, Ks. 66044
 Contact Person: Larry A. Billings
 Phone: 785-749-0909

CONTRACTOR: License# 30076
 Name: A & A Production

Well Drilled For:	Well Class:	Type Equipment:
<input checked="" type="checkbox"/> Oil <input type="checkbox"/> Gas <input type="checkbox"/> OWWO <input type="checkbox"/> Seismic; # of Holes <input type="checkbox"/> Other	<input type="checkbox"/> Enh Rec <input type="checkbox"/> Storage <input type="checkbox"/> Disposal <input type="checkbox"/> Other	<input checked="" type="checkbox"/> Infield <input type="checkbox"/> Pool Ext. <input type="checkbox"/> Wildcat <input type="checkbox"/> Other
		<input checked="" type="checkbox"/> Mud Rotary <input type="checkbox"/> Air Rotary <input type="checkbox"/> Cable

If OWWO: old well information as follows:
 Operator: _____
 Well Name: _____
 Original Completion Date: _____ Original Total Depth: _____

Directional, Deviated or Horizontal wellbore? Yes No
 If Yes, true vertical depth: _____
 Bottom Hole Location: _____
 KCC DKT #: _____

Spot NE NW SE Sec. 23 Twp. 8s S. R. 23 East West
2310 feet from (S) (N) (circle one) Line of Section
1650 feet from (E) (W) (circle one) Line of Section
 Is SECTION Regular Irregular?

(Note: Locate well on the Section Plat on reverse side)
 County: Graham
 Lease Name: Justus Well #: 1
 Field Name: Legere

Is this a Prorated / Spaced Field? Yes No
 Target Information(s): Lansing/Kansas City
 Nearest Lease or unit boundary: 330'
 Ground Surface Elevation: est. 2131 feet MSL

Water well within one-quarter mile: Yes No
 Public water supply well within one mile: Yes No
 Depth to bottom of fresh water: 200'
 Depth to bottom of usable water: 900'
 Surface Pipe by Alternate: 1 2
 Length of Surface Pipe Planned to be set: 280'
 Length of Conductor Pipe required: none
 Projected Total Depth: 3700'
 Producing Formation Target: Lansing/Kansas City

Water Source for Drilling Operations:
 Well _____ Farm Pond Other _____
 DWR Permit #: _____
 (Note: Apply for Permit with DWR)
 Will Cores be taken? Yes No
 If Yes, proposed zone: _____

AFFIDAVIT

RECEIVED
 STATE CORPORATION COMMISSION

The undersigned hereby affirms that the drilling, completion and eventual plugging of this well will comply with K.S.A. 55-101, et seq.
 It is agreed that the following minimum requirements will be met:

1. Notify the appropriate district office *prior* to spudding of well;
2. A copy of the approved notice of intent to drill *shall be* posted on each drilling rig;
3. The minimum amount of surface pipe as specified below *shall be set* by circulating cement to the top; in all cases surface pipe *shall be set* through all unconsolidated materials plus a minimum of 20 feet into the underlying formation.
4. If the well is dry hole, an agreement between the operator and the district office on plug length and placement is necessary *prior to plugging*;
5. The appropriate district office will be notified before well is either plugged or production casing is cemented in;
6. If an ALTERNATE II COMPLETION, production pipe shall be cemented from below any usable water to surface within **120 days** of spud date. *In all cases, NOTIFY district office* prior to any cementing.

I hereby certify that the statements made herein are true and to the best of my knowledge and belief.

Date: 10/11/00 Signature of Operator or Agent: Larry A. Billings Title: Operator

For KCC Use ONLY

API # 15 - 065-22802-0000
 Conductor pipe required NONE feet
 Minimum surface pipe required 220' feet per Alt. (2)
 Approved by: DPW 10-17-00
 This authorization expires: 4-17-2001
 (This authorization void if drilling not started within 6 months of effective date.)
 Spud date: _____ Agent: _____

Remember to:

- File Drill Pit Application (form CDP-1) with Intent to Drill;
- File Completion Form ACO-1 within 120 days of spud date;
- File acreage attribution plat according to field proration orders;
- Notify appropriate district office 48 hours prior to workover or re-entry;
- Submit plugging report (CP-4) after plugging is completed;
- Obtain written approval before disposing or injecting salt water.

OCT 16 2000
 10/16/00
 CONSERVATION DIVISION
 Wichita, Kansas

23
 00
 233

IN ALL CASES PLOT THE INTENDED WELL ON THE PLAT BELOW

Plat of acreage attributable to a well in a prorated or spaced field

If the intended well is in a prorated or spaced field, please fully complete this side of the form. If the intended well is in a prorated or spaced field complete the plat below showing that the well will be properly located in relationship to other wells producing from the common source of supply. Please show all the wells and within 1 mile of the boundaries of the proposed acreage attribution unit for gas wells and within 1/2 mile of the boundaries of the proposed acreage attribution unit for oil wells.

API No. 15 - _____
 Operator: _____
 Lease: _____
 Well Number: _____
 Field: _____
 Number of Acres attributable to well: _____
 QTR / QTR / QTR of acreage: _____

Location of Well: County: _____
 _____ feet from S / N (circle one) Line of Section
 _____ feet from E / W (circle one) Line of Section
 Sec. _____ Twp. _____ S. R. _____ East West
 Is Section _____ Regular or _____ Irregular
If Section is Irregular, locate well from nearest corner boundary.
 Section corner used: ___ NE ___ NW ___ SE ___ SW

PLAT

*(Show location of the well and shade attributable acreage for prorated or spaced wells.)
 (Show footage to the nearest lease or unit boundary line.)*

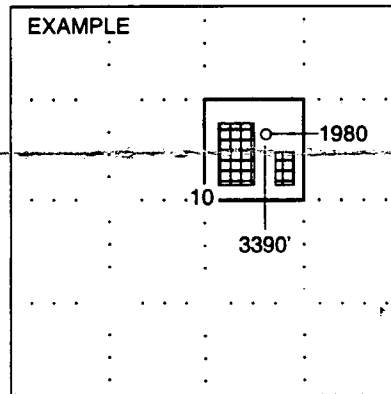
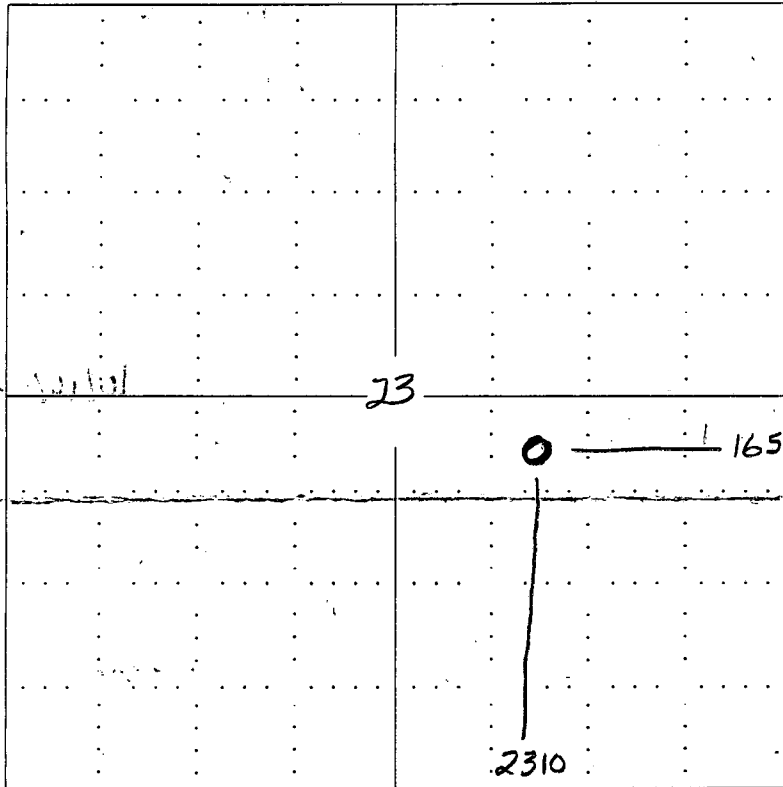

NOTE: In all cases locate the spot of the proposed drilling location.

In plotting the proposed location of the well, you must show:

1. The manner in which you are using the depicted plat by identifying section lines, i.e. 1 section, 1 section with 8 surrounding sections, 4 sections, etc.
2. The distance of the proposed drilling location from the section's south / north and east / west.
3. The distance to the nearest lease or unit boundary line.
4. If proposed location is located within a prorated or spaced field a certificate of acreage attribution plat must be attached: (CO-7 for oil wells; CG-8 for gas wells).