

EFFECTIVE DATE: 1-12-91

Must be approved by the K.C.C. five (5) days prior to commencing well

Expected Spud Date 1-12-1991
month day year

NW NW NW Sec 34 Twp 8S S, Rg 26 East X West

OPERATOR: License # 5474
Name: NORTHERN LIGHTS OIL CO. L.P.
Address: P.O. BOX 164
City/State/Zip: ANDOVER, KS 67002
Contact Person: John W. Sutherland, Jr.
Phone: 316-733-1515

.....4950..... feet from South line of Section
.....4950..... feet from East line of Section
(Note: Locate well on Section Plat on Reverse Side)

CONTRACTOR: License #: Will fill in on
Name: ACQ-1

County: Sheridan
Lease Name: Pratt "B" Well #: 34
Field Name: Unnamed Book

Well Drilled For: Well Class: Type Equipment:

Is this a Prorated Field? yes X.. no

X Oil ... Inj ... Infield X Mud Rotary
... Gas ... Storage X Pool-Ext ... Air Rotary
... OWWO ... Disposal ... Wildcat ... Cable
... Seismic; ... # of Holes

Target Formation(s): LKC

Nearest lease or unit boundary: 330!

Ground Surface Elevation: NA*..... feet MSL

Domestic well within 330 feet: will put on ACO-1 yes X.. no

Municipal well within one mile: yes X.. no

Depth to bottom of fresh water: 100

Depth to bottom of usable water: 1250

Surface Pipe by Alternate: 1 X 2

Length of Surface Pipe Planned to be set: 250!

Length of Conductor pipe required:

Projected Total Depth: 3950!

Formation at Total Depth: Marmaton

Water Source for Drilling Operations:

..... well X farm pond other

DWR Permit #:

Will Cores Be Taken?: yes X.. no

If yes, proposed zone:

If OWWO: old well information as follows:

Operator:

Well Name:

Comp. Date: Old Total Depth

Directional, Deviated or Horizontal wellbore? yes X.. no

If yes, total depth location:

AFFIDAVIT

The undersigned hereby affirms that the drilling, completion and eventual plugging of this well will comply with K.S.A. 55-101, et. seq.

It is agreed that the following minimum requirements will be met:

1. The appropriate district office shall be notified before setting surface pipe;
2. The minimum amount of surface pipe as specified above shall be set by circulating cement to the top; in all cases surface pipe shall be set through all unconsolidated materials plus a minimum of 20 feet into the underlying formation;
3. If the well is dry, a plugging proposal shall be submitted to the district office. An agreement between the operator and the district office on plug length and placement is necessary prior to plugging;
4. The appropriate district office will be notified before well is either plugged or production casing is cemented in;
5. If an Alternate II completion, production pipe shall be cemented from below any usable water to surface within 120 days of spud date. In all cases, notify district office prior to any cementing.

I hereby certify that the statements made herein are true and to the best of my knowledge and belief.

Date: 1/4/91 Signature of Operator or Agent: John W. Sutherland, Jr. Title: General Partner

FOR KCC USE:

API # 15- 179-20985-00-00

Conductor pipe required None feet

Minimum surface pipe required 200 feet per Alt. X 2

Approved by: Da 1-7-91

EFFECTIVE DATE: 1-12-91

This authorization expires: 7-7-91

(This authorization void if drilling not started within 6 months of effective date.)

Spud date: _____ Agent: _____

RECEIVED
STATE CORPORATION COMMISSION

JAN 7 1991
1-7-1991
CONSERVATION DIVISION
Wichita, Kansas

REMEMBER TO:

- File Drill Pit Application (form CDP-1) with Intent to Drill;
- File Completion Form ACO-1 within 120 days of spud date;
- File acreage attribution plat according to field proration orders;
- Notify appropriate district office 48 hours prior to workover or re-entry;
- Submit plugging report (CP-4) after plugging is completed;
- Obtain written approval before disposing or injecting salt water.

PLAT OF ACREAGE ATTRIBUTABLE TO A WELL

State Corporation Commission, Conservation Division
200 Colorado Derby Bldg. Wichita, Kansas 67202

OPERATOR NORTHERN LIGHTS OIL CO., LOCATION OF WELL: NW NW NW
 LEASE Pratt "B" 4950' feet north of SE corner
 WELL NUMBER #4 4950' feet west of SE corner
 FIELD Unnamed Sec. 34 T 8S R 26W E/W
 COUNTY SHERIDAN
 NO. OF ACRES ATTRIBUTABLE TO WELL 10 IS SECTION REGULAR IRREGULAR?
 DESCRIPTION OF ACREAGE NW NW NW IF IRREGULAR, LOCATE WELL FROM NEAREST
 CORNER BOUNDARY.

NOTE: If plat depicted is insufficient for your circumstances, you may attach your own scaled or surveyed plat.

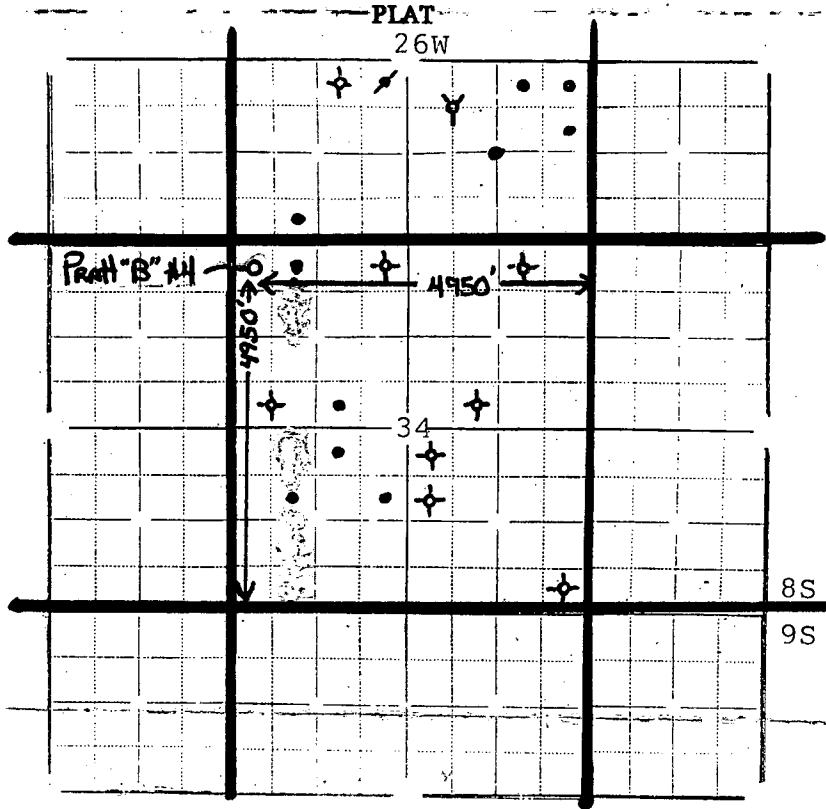

In plotting the proposed location of the well, you must show:

- 1) The manner in which you are using the depicted plat by identifying section lines, i.e. 1 section, 1 section with 8 surrounding partial sections, 4 sections, 16 sections, etc.;
- 2) the well's location relative to the location of other wells producing from the same common source of supply in adjoining drilling units, pursuant to K.A.R. 82-3-108, 82-3-207, 82-3-312, or special orders of the Commission;
- 3) the distance of the proposed drilling location from the section's east and south lines; and
- 4) the distance to the nearest lease or unit boundary line.

I hereby certify that the statements made herein are true and to the best of my knowledge and belief.

Signature of Operator or Agent John W. Smith

Date 1/4/91 Title General Partner