

FOR KCC USE:

* COR 6-2-94

FORM C-1 7/91
FORM MUST BE TYPED
FORM MUST BE SIGNED
ALL BLANKS MUST BE FILLED

EFFECTIVE DATE: 6-6-94

State of Kansas

DISTRICT # 4

NOTICE OF INTENTION TO DRILL

SEAT... Yes... No

Must be approved by the K.C.C. five (5) days prior to commencing well

Expected Spud Date June 10 1994
month day year

Spot SW N.W. NE. Sec 34 Twp 8S S, Rg 26 East West

OPERATOR: License # 5472
Name: Hoppe Oil & Gas Co., Inc.
Address: 212 N. Market, Ste. 315
City/State/Zip: Wichita, KS 67202
Contact Person: Rick A. Hoppe
Phone: (316) 265-4654

990' feet from South / North line of Section
2,310' feet from East / West line of Section
IS SECTION X REGULAR IRREGULAR?

CONTRACTOR: License #: 4958
Name: Mallard JV, Inc.

(NOTE: Locate well on the Section Plat on Reverse Side)
County: Sheridan
Lease Name: Pratt Well #: 1
Field Name: Wildcat
Is this a Prorated/Spaced Field? yes X no
Target Formation(s): LKC
Nearest lease or unit boundary: .330
Ground Surface Elevation: Unknown feet MSL
Water well within one-quarter mile: yes X no
Public water supply well within one mile: yes X no
Depth to bottom of fresh water: 200
Depth to bottom of usable water: 1500' APPX
Surface Pipe by Alternate: 1 X 2
Length of Surface Pipe Planned to be set: 250'
Length of Conductor pipe required: NONE
Projected Total Depth: 3,950'
Formation at Total Depth: BKC
Water Source for Drilling Operations:
... well X farm pond ... other

Well Drilled For: Well Class: Type Equipment:
X Oil ... Enh Rec ... Infield X Mud Rotary
Gas ... Storage ... Pool Ext. ... Air Rotary
OWWO ... Disposal X Wildcat ... Cable
Seismic: # of Holes ... Other
Other

If OWWO: old well information as follows:
Operator:
Well Name:
Comp. Date: Old Total Depth

Directional, Deviated or Horizontal wellbore? yes X no
If yes, true vertical depth:
Bottom Hole Location:

DWR Permit #:
Will Cores Be Taken? yes X no
If yes, proposed zone:

* WAS 21070

AFFIDAVIT * IS 21071

The undersigned hereby affirms that the drilling, completion and eventual plugging of this well will comply with 55-101, et. seq.
It is agreed that the following minimum requirements will be met:

RECEIVED
STATE CORPORATION COMMISSION
6-1-1994
JUN 01 1994
CONSERVATION DIVISION

- 1. Notify the appropriate district office prior to spudding of well;
- 2. A copy of the approved notice of intent to drill shall be posted on each drilling rig;
- 3. The minimum amount of surface pipe as specified below shall be set by circulating cement to the surface; in all cases surface pipe shall be set through all unconsolidated materials plus a minimum of 20 feet into the underlying formation;
- 4. If the well is dry hole, an agreement between the operator and the district office on plug length and placement is necessary prior to plugging;
- 5. The appropriate district office will be notified before well is either plugged or production casing is cemented in;
- 6. IF AN ALTERNATE II COMPLETION, PRODUCTION PIPE SHALL BE CEMENTED FROM BELOW ANY USABLE WATER TO SURFACE WITHIN 120 DAYS OF SPUD DATE. IN ALL CASES, NOTIFY DISTRICT OFFICE PRIOR TO ANY CEMENTING.

I hereby certify that the statements made herein are true and to the best of my knowledge and belief.
Date: 5/31/94 Signature of Operator or Agent: [Signature] Title: President

FOR KCC USE: 21071 - 00 - 00
API # 15- 179-21070 - 00 - 00
Conductor pipe required NONE feet
Minimum surface pipe required 250' feet per Alt. X
Approved by: CB 6-1-94
This authorization expires: 12-1-94
(This authorization void if drilling not started within 6 months of effective date.)
Spud date: Agent:

REMEMBER TO:

- File Drill Pit Application (form CDP-1) with Intent to Drill;
- File Completion Form ACO-1 within 120 days of spud date;
- File acreage attribution plat according to field proration orders;
- Notify appropriate district office 48 hours prior to workover or re-entry;
- Submit plugging report (CP-4) after plugging is completed;
- Obtain written approval before disposing or injecting salt water.

Mail to: Conservation Division, 200 Colorado Derby Building, 202 W. First St., Wichita, Kansas 67202-1286.

34
8
26

IN ALL CASES PLOT THE INTENDED WELL ON THE PLAT BELOW

PLAT OF ACREAGE ATTRIBUTABLE TO A WELL IN A PRORATED OR SPACED FIELD

If the intended well is in a prorated or spaced field, please fully complete this side of the form. If the intended well is in a prorated or spaced field complete the plat below showing that the well will be properly located in relationship to other wells producing from the common source of supply. Please show all the wells within 1 mile of the boundaries of the proposed acreage attribution unit for gas wells and within 1/2 mile of the boundaries of the proposed acreage attribution unit for oil wells.

API NO. 15- _____
 OPERATOR Hoppe Oil & Gas Co., Inc. LOCATION OF WELL: COUNTY Sheridan
 LEASE Pratt _____ 990 feet from ~~south~~/north line of section
 WELL NUMBER 1 (one) _____ 2,310 feet from east/~~west~~ line of section
 FIELD Wildcat Well _____ SECTION 34 TWP 8S RG 26W

NUMBER OF ACRES ATTRIBUTABLE TO WELL 10 IS SECTION X REGULAR or _____ IRREGULAR
 QTR/QTR/QTR OF ACREAGE SW - NW - NE _____ IF SECTION IS IRREGULAR, LOCATE WELL FROM NEAREST
 CORNER BOUNDARY.

Section corner used: _____ NE _____ NW _____ SE _____ SW
PLAT

(Show location of the well and shade attributable acreage for prorated or spaced wells.)
 (Show footage to the nearest lease or unit boundary line.)

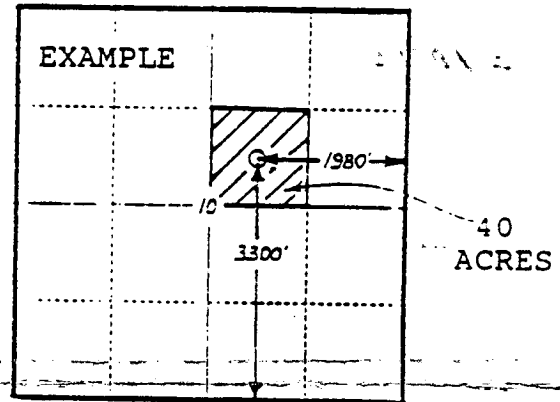
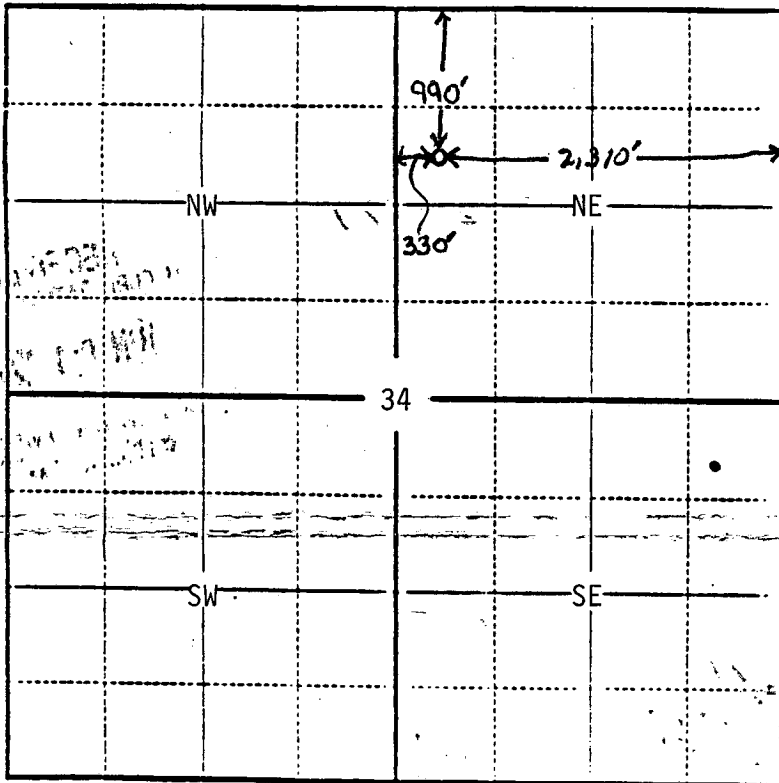

SEWARD CO.

TWSP. 8S, RGE 26W, Sheridan Co.

In plotting the proposed location of the well, you must show:

- 1) The manner in which you are using the depicted plat by identifying section lines, i.e. 1 section, 1 section with 8 surrounding sections, 4 sections, etc.;
- 2) the distance of the proposed drilling location from the section's south/north and east/west lines; and
- 3) the distance to the nearest lease or unit boundary line.