

CARD MUST BE TYPED

State of Kansas NOTICE OF INTENTION TO DRILL

CARD MUST BE SIGNED

Starting Date: November 20 1984
month day year

API Number 15- 179-20,780-00-00

OPERATOR: License # 4047
Name Sterling Petroleum Operating Co.
Address 112 South Broadway
City/State/Zip Sterling, KS 67579
Contact Person Curt Bennett
Phone (316) 278-3727

$S\frac{1}{2}$. $S\frac{1}{2}$. $SW\frac{1}{4}$ (location) Sec 26 Twp 8 S, Rge 29 East West

~~S# 330~~ Ft North from Southeast Corner of Section
~~E# 3960~~ Ft West from Southeast Corner of Section
(Note: Locate well on Section Plat on reverse side)

CONTRACTOR: License # 5783
Name Galloway Drilling Co., Inc.
City/State Wichita, KS 67202

Nearest lease or unit boundary line 330 feet.

County Sheridan

Lease Name Selbe Well# 1

Domestic well within 330 feet: yes no

Municipal well within one mile: yes no

Well Drilled For:	Well Class:	Type Equipment:
<input checked="" type="checkbox"/> Oil <input type="checkbox"/> Swd <input type="checkbox"/> Infield	<input checked="" type="checkbox"/> Pool Ext.	<input checked="" type="checkbox"/> Mud Rotary
<input type="checkbox"/> Gas <input type="checkbox"/> Inj	<input type="checkbox"/> Wildcat	<input type="checkbox"/> Air Rotary
<input type="checkbox"/> OWWO <input type="checkbox"/> Expl		<input type="checkbox"/> Cable

Depth to Bottom of fresh water 150 feet

Lowest usable water formation Dakota

Depth to Bottom of usable water 1800 1550 feet

Surface pipe by Alternate: 1 2

Surface pipe to be set 2.20 feet

Conductor pipe if any required None feet

Ground surface elevation 2808 feet MSL

This Authorization Expires 5-16-85

Approved By 11-16-84

If OWWO: old well info as follows:

Operator

Well Name

Comp Date Old Total Depth

Projected Total Depth 4225 feet

Projected Formation at TD Basic Kansas City

Expected Producing Formations L/KC

I certify that we will comply with K.S.A. 55-101, et seq., plus eventually plugging hole to K.C.C. specifications.

Date 11/14/84 Signature of Operator or Agent

Robert B. McGreey Title

MHC/KDHE 11/16/84
President - SPOC

Must be filed with the K.C.C. five (5) days prior to commencing well
This card void if drilling not started within six (6) months of date received by K.C.C.

ACD
11-16-84

A Regular Section of Land
1 Mile = 5,280 Ft.

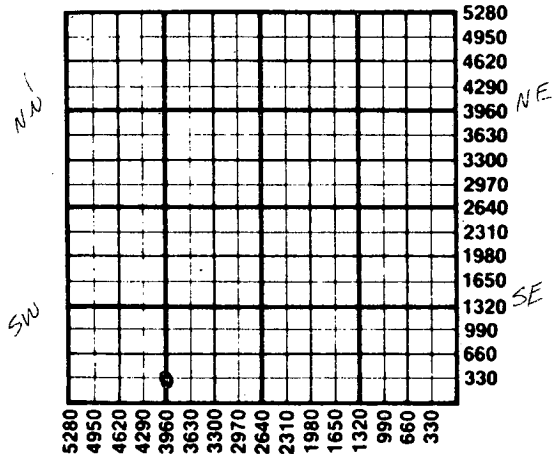

Important procedures to follow :

1. Notify District office before setting surface casing.
2. Set surface casing by circulating cement to the top.
3. File completion forms ACO-1 with K.C.C. within 90 days of well completion, following instructions on ACO-1, side 1, and including copies of wireline logs.
4. Notify District office 48 hours prior to old well workover or re-entry.
5. Prior to plugging, prepare a plugging plan, then obtain agreement from the appropriate district office for an approved plugging plan.
6. Submit plugging report (CP-4) to K.C.C. after plugging is completed.
7. Obtain an approved injection docket number before disposing of salt water.
8. Notify K.C.C. within 10 days when injection commences or terminates.
9. If an alternate 2 completion, cement in the production pipe from below any usable water to surface within 120 days of spud date.

State Corporation Commission of Kansas
Conservation Division
200 Colorado Derby Building
Wichita, Kansas 67202
(316)263-3238