

EFFECTIVE DATE: 7-7-91

NOTICE OF INTENTION TO DRILL

Must be approved by the K.C.C. five (5) days prior to commencing well

Expected Spud Date July 4 1991 SW NW SE Sec 15 Twp 8-S S, Rg 26-W East X West

OPERATOR: License # 06113
Name: Landmark Oil Exploration, Inc.
Address: 250 N. Water, Suite 308
City/State/Zip: Wichita, Kansas 67202
Contact Person: Jeff Wood
Phone: (316) 265-8181

CONTRACTOR: License #: 6033
Name: Murfin Drilling Company

Well Drilled For: Well Class: Type Equipment:
XX Oil ... Inj ... Infield XX Mud Rotary
... Gas ... Storage ... Pool Ext. ... Air Rotary
... OWWO ... Disposal XX Wildcat ... Cable
... Seismic; ... # of Holes

If OWWO: old well information as follows:
Operator: _____
Well Name: _____
Comp. Date: _____ Old Total Depth _____

Directional, Deviated or Horizontal wellbore? yes XX.. no ✓
If yes, total depth location: _____

.....1650..... feet from South line of Section/
.....2310..... feet from East line of Section/
(Note: Locate well on Section Plat on Reverse Side)
County: Sheridan
Lease Name: C. Robben Well #: #1-15
Field Name: unnamed
Is this a Prorated Field? yes XX.. no ✓
Target Formation(s): Lansing-Kansas City
Nearest lease or unit boundary: 330
Ground Surface Elevation: 2481' feet MSL
Domestic well within 330 feet: yes XX.. no ✓
Municipal well within one mile: yes XX.. no ✓
Depth to bottom of fresh water: 120
Depth to bottom of usable water: 1235
Surface Pipe by Alternate: 1 XX.. 2 ✓
Length of Surface Pipe Planned to be set: 275'
Length of Conductor pipe required: N/A
Projected Total Depth: 3950'
Formation at Total Depth: BKC
Water Source for Drilling Operations:
..... well farm pond XX.. other ✓

DWR Permit #: _____
Will Cores Be Taken?: yes XX.. no ✓
If yes, proposed zone: RECEIVED

STATE CORPORATION COMMISSION

7-1-91
1991

AFFIDAVIT

The undersigned hereby affirms that the drilling, completion and eventual plugging of this well will comply with K.S.A. 55-101, et. seq.

It is agreed that the following minimum requirements will be met:

1. The appropriate district office shall be notified before setting surface pipe;
2. The minimum amount of surface pipe as specified above shall be set by circulating cement to the top; in all cases surface pipe shall be set through all unconsolidated materials plus a minimum of 20 feet into the underlying formation;
3. If the well is dry, a plugging proposal shall be submitted to the district office. An agreement between the operator and the district office on plug length and placement is necessary prior to plugging;
4. The appropriate district office will be notified before well is either plugged or production casing is cemented in;
5. If an Alternate II completion, production pipe shall be cemented from below any usable water to surface within 120 days of spud date. In all cases, notify district office prior to any cementing.

I hereby certify that the statements made herein are true and to the best of my knowledge and belief.

Date: July 1, 1991 Signature of Operator or Agent: Jeffrey R. Wood Title: President

FOR KCC USE:

API # 15- 179-24014-00-00
 Conductor pipe required None feet
 Minimum surface pipe required 250 feet per Alt. (2)
 Approved by: MRW 7-291
 EFFECTIVE DATE: 7-7-91
 This authorization expires: 1-2-92
 (This authorization void if drilling not started within 6 months of effective date.)
 Spud date: _____ Agent: _____

REMEMBER TO:

- File Drill Pit Application (form CDP-1) with Intent to Drill;
- File Completion Form ACO-1 within 120 days of spud date;
- File acreage attribution plat according to field proration orders;
- Notify appropriate district office 48 hours prior to workover or re-entry;
- Submit plugging report (CP-4) after plugging is completed;
- Obtain written approval before disposing or injecting salt water.

W A J K N

15
8
26 W

PLAT OF ACREAGE ATTRIBUTABLE TO A WELL

State Corporation Commission, Conservation Division
200 Colorado Derby Bldg. Wichita, Kansas 67202

OPERATOR Landmark Oil Exploration, Inc. LOCATION OF WELL: C SW NW SE
 LEASE C. Robben 1650 feet north of SE corner
 WELL NUMBER #1-15 2310 feet west of SE corner
 FIELD Unnamed SE/4 Sec. 15 T 8-S R 26-W E/W
 COUNTY Sheridan
 NO. OF ACRES ATTRIBUTABLE TO WELL 160 IS SECTION XX REGULAR IRREGULAR?
 DESCRIPTION OF ACREAGE SE/4 IF IRREGULAR, LOCATE WELL FROM NEAREST
 CORNER BOUNDARY.

NOTE: If plat depicted is insufficient for your circumstances, you may attach your own scaled or surveyed plat.

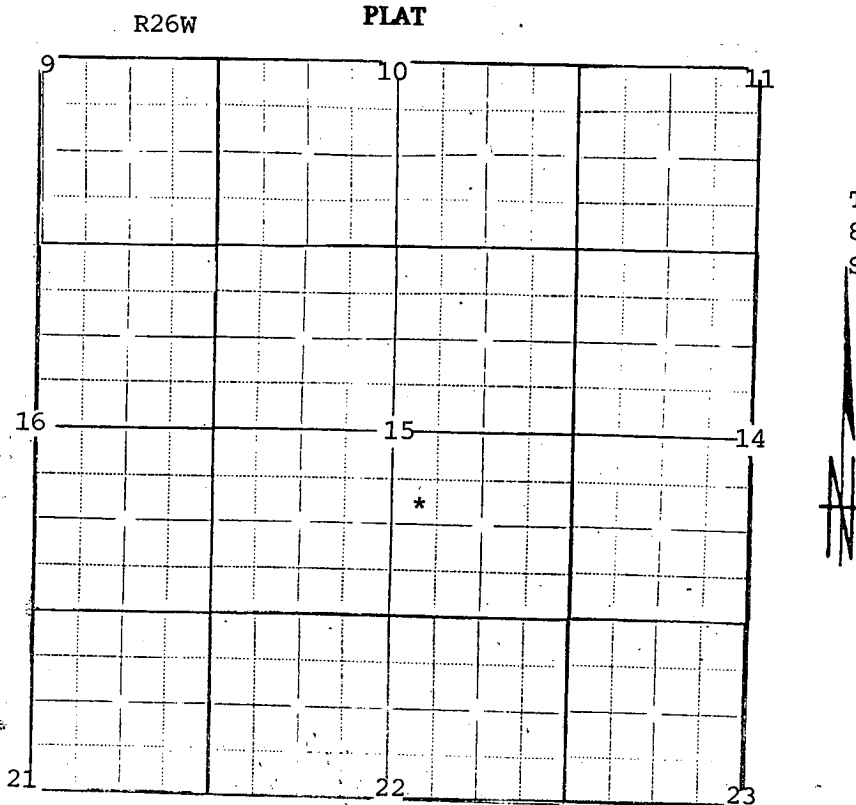

In plotting the proposed location of the well, you must show:

- 1) The manner in which you are using the depicted plat by identifying section lines, i.e. 1 section, 1 section with 8 surrounding partial sections, 4 sections, 16 sections, etc.;
- 2) the well's location relative to the location of other wells producing from the same common source of supply in adjoining drilling units, pursuant to K.A.R. 82-3-108, 82-3-207, 82-3-312, or special orders of the Commission;
- 3) the distance of the proposed drilling location from the section's east and south lines; and
- 4) the distance to the nearest lease or unit boundary line.

I hereby certify that the statements made herein are true and to the best of my knowledge and belief.

Signature of Operator or Agent [Signature]

Date July 1, 1991 Title President, Jeffrey R. Wood

