

Must be approved by the K.C.C. five (5) days prior to commencing well

Expected Spud Date March 31, 1991  
month day year

SE SW NW Sec 28 Twp 8 S, Rg 32 East  West

OPERATOR: License # 6484  
Name: Anderson Energy, Inc.  
Address: 200 E. First St., Suite 414  
City/State/Zip: Wichita, KS 67202  
Contact Person: William L. Anderson  
Phone: (316) 265-7929

2970 feet from South line of Section  
4290 feet from East line of Section  
(Note: Locate well on Section Plat on Reverse Side)

CONTRACTOR: License #: 5420  
Name: White & Ellis Drilling, Inc.

County: Thomas  
Lease Name: Weyand Well #: 4  
Field Name: North Randall

Well Drilled For: Well Class: Type Equipment:  
 Oil  Inj  Infield  Mud Rotary  
 Gas  Storage  Pool Ext.  Air Rotary  
 OWWO  Disposal  Wildcat  Cable  
 Seismic;  # of Holes

Is this a Prorated Field?  yes  no  
Target Formation(s): LKC Marmaton  
Nearest lease or unit boundary: 330'  
Ground Surface Elevation: 3098 est. feet MSL  
Domestic well within 330 feet:  yes  no  
Municipal well within one mile:  yes  no  
Depth to bottom of fresh water: 220'  
Depth to bottom of usable water: 280'  
Surface Pipe by Alternate:  1  2  
Length of Surface Pipe Planned to be set: 320'  
Length of Conductor pipe required: N/A  
Projected Total Depth: 4700'  
Formation at Total Depth: Mississippian

If OWWO: old well information as follows:  
Operator: \_\_\_\_\_  
Well Name: \_\_\_\_\_  
Comp. Date: \_\_\_\_\_ Old Total Depth \_\_\_\_\_

Water Source for Drilling Operations:  
 well  farm pond  other  
DWR Permit #: \_\_\_\_\_  
Will Cores Be Taken?:  yes  no  
If yes; proposed zone: \_\_\_\_\_

Directional, Deviated or Horizontal wellbore?  yes  no  
If yes, total depth location: \_\_\_\_\_

**AFFIDAVIT**

The undersigned hereby affirms that the drilling, completion and eventual plugging of this well will comply with K.S.A. 55-101, et. seq.

It is agreed that the following minimum requirements will be met:

1. The appropriate district office shall be notified before setting surface pipe;
2. The minimum amount of surface pipe as specified above shall be set by circulating cement to the top; in all cases surface pipe shall be set through all unconsolidated materials plus a minimum of 20 feet into the underlying formation;
3. If the well is dry, a plugging proposal shall be submitted to the district office. An agreement between the operator and the district office on plug length and placement is necessary prior to plugging;
4. The appropriate district office will be notified before well is either plugged or production casing is cemented in;
5. If an Alternate II completion, production pipe shall be cemented from below any usable water to surface within 120 days of spud date. In all cases, notify district office prior to any cementing.

I hereby certify that the statements made herein are true and to the best of my knowledge and belief.

Date: 3/29/91 Signature of Operator or Agent: William L. Anderson Title: Secy-Treas.

FOR KCC USE:  
API # 15- 193-10,552-00-00  
Conductor pipe required None feet  
Minimum surface pipe required 300 feet per Alt. ①  
Approved by: mlw 3-29-91  
EFFECTIVE DATE: 4-3-91  
This authorization expires: 9-29-91  
(This authorization void if drilling not started within 6 months of effective date.)  
Spud date: \_\_\_\_\_ Agent: \_\_\_\_\_

**CONTACT DISTRICT OFFICE PRIOR TO SPUDDING FOR APPROVAL**

**KCC OFFICE USE ONLY**

W 3-29-91 D

CT 3:0 Opn CT

mlw  
263-1946

RECEIVED  
STATE OF KANSAS  
CONSERVATION DIVISION  
Wichita, Kansas  
MAR 29 1991  
3/29/91  
28 8 32W

**REMEMBER TO:**

- File Drill Pit Application (form CDP-1) with Intent to Drill;
- File Completion Form ACO-1 within 120 days of spud date;
- File acreage attribution plat according to field proration orders;
- Notify appropriate district office 48 hours prior to workover or re-entry;
- Submit plugging report (CP-4) after plugging is completed;
- Obtain written approval before disposing or injecting salt water.

PLAT OF ACREAGE ATTRIBUTABLE TO A WELL

State Corporation Commission, Conservation Division  
200 Colorado Derby Bldg. Wichita, Kansas 67202

OPERATOR Anderson Energy, Inc. LOCATION OF WELL:  
 LEASE Weyand 2970 feet north of SE corner  
 WELL NUMBER 4 4290 feet west of SE corner  
 FIELD North Randall SE SW NW Sec. 28 T 8 R 32 ~~W~~ W  
 COUNTY Thomas  
 NO. OF ACRES. ATTRIBUTABLE TO WELL \_\_\_\_\_ IS SECTION X REGULAR \_\_\_\_\_ IRREGULAR?  
 DESCRIPTION OF ACREAGE SE SW NW IF IRREGULAR, LOCATE WELL FROM NEAREST  
 CORNER BOUNDARY.

NOTE: If plat depicted is insufficient for your circumstances, you may attach your own scaled or surveyed plat.

PLAT

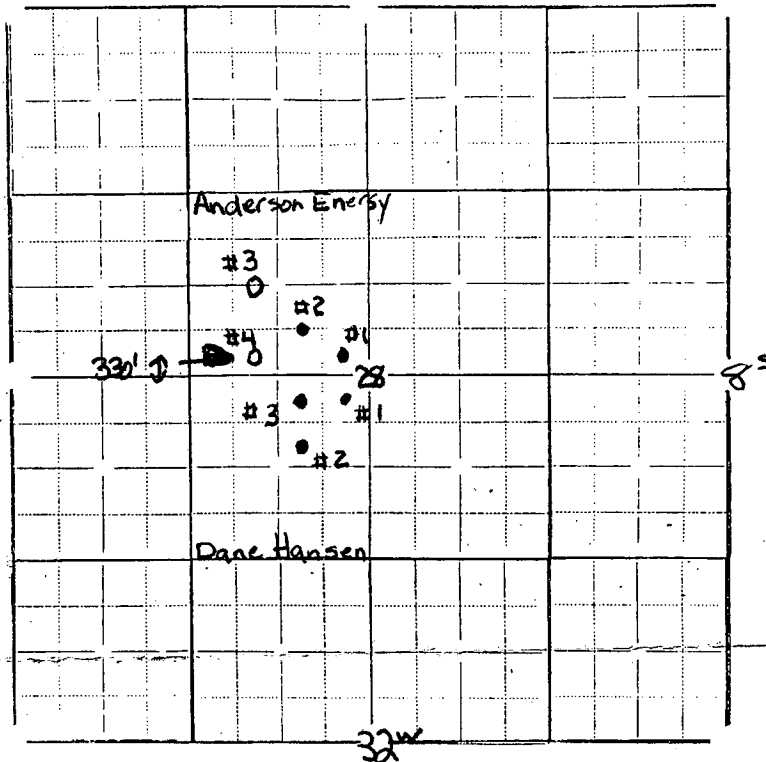

In plotting the proposed location of the well, you must show:

- 1) The manner in which you are using the depicted plat by identifying section lines, i.e. 1 section, 4 sections, 16 sections, etc.;
- 2) the well's location relative to the location of other wells producing from the same common source of supply in adjoining drilling units, pursuant to K.A.R. 82-3-108, 82-3-207, 82-3-312, or special orders of the Commission;
- 3) the distance of the proposed drilling location from the section's east and south lines; and
- 4) the distance to the nearest lease or unit boundary line.

CONTACT DISTRICT  
 OFFICE PRIOR  
 TO SCHEDULING  
 FOR APPROVAL  
 KCC OFFICE

I hereby certify that the statements made herein are true and to the best of my knowledge and belief.

Signature of Operator or Agent William J. Anderson

Date 3-29-91 Title Secy-Treas.