

EFFECTIVE DATE: 12-26-95

State of Kansas

DISTRICT # 4

NOTICE OF INTENTION TO DRILL

SGA? Yes No

Must be approved by the K.C.C. five (5) days prior to commencing well.

Expected Spud Date 1 15 1996 month day year

Spot E/2 E/2 NE. Sec 17. Twp 8S. S, Rg 34. East West

OPERATOR: License # 5420 Name: White & Ellis Drilling, Inc. Address: P.O. Box 48848 City/State/Zip: Wichita, KS 67201-8848 Contact Person: Michael L. Considine Phone: 316-263-1102

1320' feet from North line of Section 330' feet from East line of Section IS SECTION REGULAR X IRREGULAR?

CONTRACTOR: License # 5420 Name: White & Ellis Drilling, Inc.

(NOTE: Locate well on the Section Plat on Reverse Side) County: Thomas Lease Name: Cranston Farms Well #: 2-17 Field Name: Morgan Is this a Prorated/Spaced Field? yes X no Target Formation(s): LKC Marmaton Nearest lease or unit boundary: 330' Ground Surface Elevation: App. 3256' feet MSL Water well within one-quarter mile: X yes no Public water supply well within one mile: yes X no Depth to bottom of fresh water: 250' 250' Depth to bottom of usable water: 300' 1900' Surface Pipe by Alternate: 1 X 2 Length of Surface Pipe Planned to be set: 320' Length of Conductor pipe required: N/A Projected Total Depth: 4800' Formation at Total Depth: Mississippi Water Source for Drilling Operations: well farm pond X other

Well Drilled For: Well Class: Type Equipment: X Oil Enh Rec Infield X Mud Rotary Gas Storage X Pool Ext. Air Rotary OWD Disposal Wildcat Cable Seismic; # of Holes Other

If OWD: old well information as follows: Operator: Well Name: Comp. Date: Old Total Depth

Directional, Deviated or Horizontal wellbore? yes X no If yes, true vertical depth: Bottom Hole Location:

Will Cores Be Taken? yes X no If yes, proposed zone:

AFFIDAVIT

RECEIVED

KANSAS CORPORATION COMMISSION

The undersigned hereby affirms that the drilling, completion and eventual plugging of this well will comply with K.S.A. 55-101, et. seq. It is agreed that the following minimum requirements will be met:

DEC 21 1995 12-21-95 CONSERVATION DIVISION WICHITA, KS

- 1. Notify the appropriate district office prior to spudding of well; 2. A copy of the approved notice of intent to drill shall be posted on each drilling rig; 3. The minimum amount of surface pipe as specified below shall be set by circulating cement to the top; in all cases surface pipe shall be set through all unconsolidated materials plus a minimum of 20 feet into the underlying formation; 4. If the well is dry hole, an agreement between the operator and the district office on plug length and placement is necessary prior to plugging; 5. The appropriate district office will be notified before well is either plugged or production casing is cemented in; 6. IF AN ALTERNATE II COMPLETION, PRODUCTION PIPE SHALL BE CEMENTED FROM BELOW ANY USABLE WATER TO SURFACE WITHIN 120 DAYS OF SPUD DATE. IN ALL CASES, NOTIFY DISTRICT OFFICE PRIOR TO ANY CEMENTING.

I hereby certify that the statements made herein are true and to the best of my knowledge and belief.

Date: 12-20-95 Signature of Operator or Agent: Michael L. Considine Title: Secretary-Treasurer

FOR KCC USE: API # 15- 193-206440000 Conductor pipe required NONE feet Minimum surface pipe required 310' feet per Alt. X(2) Approved by: JK 12-21-95 This authorization expires: 6-21-96 (This authorization void if drilling not started within 6 months of effective date.) Spud date: Agent:

REMEMBER TO:

- File Drill Pit Application (form CDP-1) with Intent to Drill; - File Completion Form ACO-1 within 120 days of spud date; - File acreage attribution plat according to field proration orders; - Notify appropriate district office 48 hours prior to workover or re-entry; - Submit plugging report (CP-4) after plugging is completed; - Obtain written approval before disposing or injecting salt water.

Mail to: KCC - Conservation Division, 130 S. Market - Room 2078, Wichita, Kansas 67202.

17 8 3403

IN ALL CASES PLOT THE INTENDED WELL ON THE PLAT BELOW

PLAT OF ACREAGE ATTRIBUTABLE TO A WELL IN A PRORATED OR SPACED FIELD

If the intended well is in a prorated or spaced field, please fully complete this side of the form. If the intended well is in a prorated or spaced field complete the plat below showing that the well will be properly located in relationship to other wells producing from the common source of supply. Please show all the wells within 1 mile of the boundaries of the proposed acreage attribution unit for gas wells and within 1/2 mile of the boundaries of the proposed acreage attribution unit for oil wells.

API NO. 15- _____
 OPERATOR White & Ellis Drilling, Inc. LOCATION OF WELL: COUNTY Thomas
 LEASE Cranston Farms 1320' feet from ~~south~~/north line of section
 WELL NUMBER 2-17 330' feet from east/~~west~~ line of section
 FIELD Morgan SECTION 17 TWP 8S RG 34W

NUMBER OF ACRES ATTRIBUTABLE TO WELL 40 IS SECTION REGULAR or X IRREGULAR
 QTR/QTR/QTR OF ACREAGE E/2 - E/2 - NE **IF SECTION IS IRREGULAR, LOCATE WELL FROM NEAREST CORNER BOUNDARY.**

Section corner used: X NE NW SE SW

PLAT

(Show location of the well and shade attributable acreage for prorated or spaced wells.)
 (Show footage to the nearest lease or unit boundary line.)

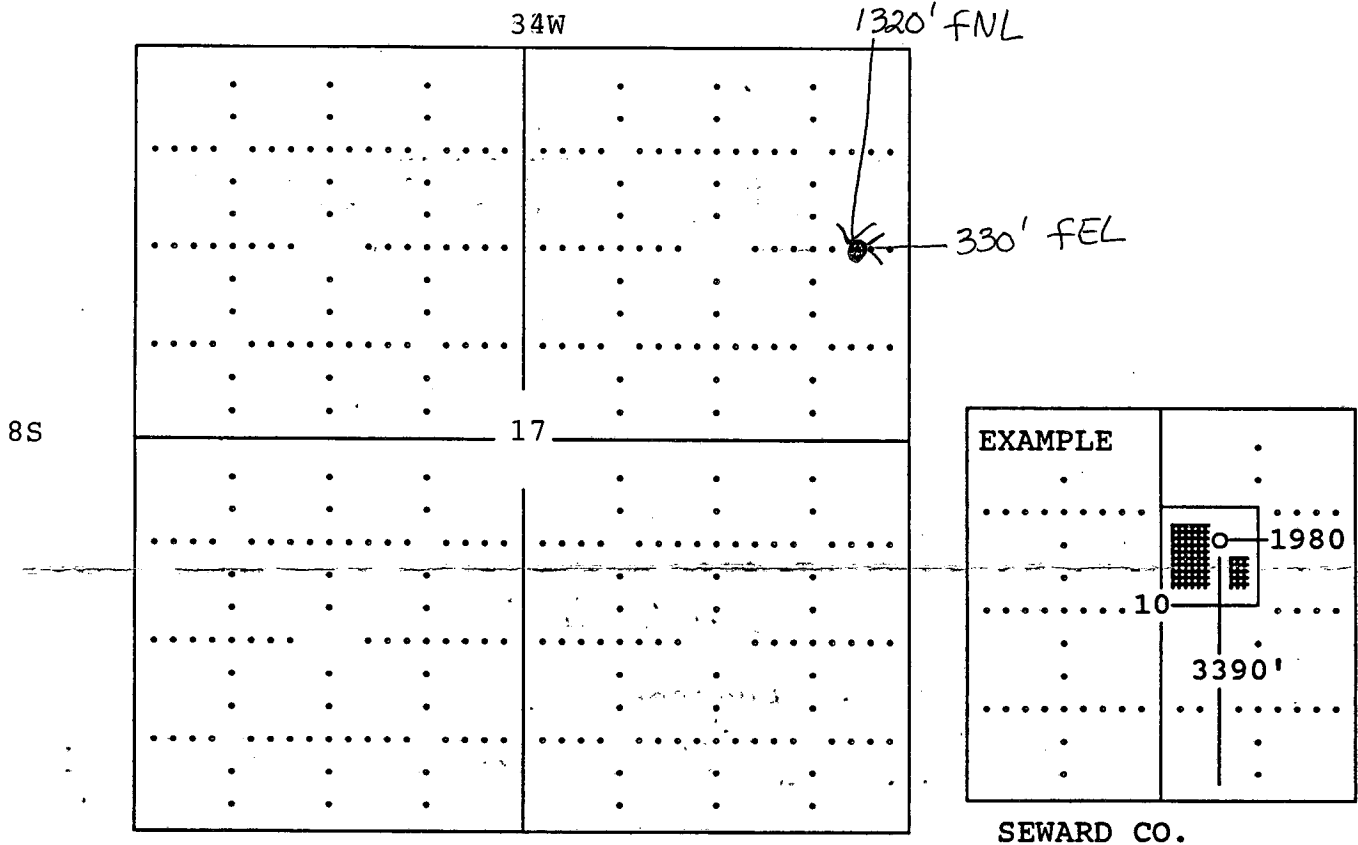

SEWARD CO.

In plotting the proposed location of the well, you must show:

- 1) The manner in which you are using the depicted plat by identifying section lines, i.e. 1 section, 1 section with 8 surrounding sections, 4 sections, etc.;
- 2) the distance of the proposed drilling location from the section's south/north and east/west; and
- 3) the distance to the nearest lease or unit boundary line.