

FOR KCC USE:

Mail to: Emphasis Oil Operations
State of Kansas

Mail to: HDP
2535 Marsh Ln.
#1208
Carrollton, TX 75006

FORM C-1 7/91
FORM MUST BE TYPED
FORM MUST BE SIGNED
ALL BLANKS MUST BE FILLED

EFFECTIVE DATE: 1-17-93
DISTRICT # 4
SEA? Yes No

NOTICE OF INTENTION TO DRILL
Must be approved by the K.C.C. five (5) days prior to commencing well

Expected Spud Date 01 15 93
month day year

Spot NW NE SE 5% Twp 9s S. Rg 17E East West

OPERATOR: License # 30730
Name: HORIZONTAL DEV. & PROD. INC
Address: 277 TOWN & COUNTRY VILLAGE
City/State/Zip: PALO ALTO, CA 94301
Contact Person: MIKE STERNBERG
Phone: 214-416-5873

2310 feet from South / North line of Section
990 feet from East / West line of Section
IS SECTION XX REGULAR IRREGULAR?
(NOTE: Locate well on the Section Plat on Reverse Side)

CONTRACTOR: License # 8241
Name: EMPHASIS OIL OPERATIONS

County: HOOKS
Lease Name: FISCHER Well #: 1
Field Name: DOPITA

Well Drilled For: Well Class: Type Equipment:
XX Oil Enh Rec Infield XX Mud Rotary
Gas Storage XX Pool Ext Air Rotary
OWWO Disposal Wildcat Cable
Seismic: # of Holes Other

Is this a Prorated/Spaced Field? yes XX no
Target Formation(s): LANSING/KC
Nearest lease or unit boundary: 330
Ground Surface Elevation: 2011 feet MSL

If OWWO: old well information as follows:
Operator:
Well Name:
Comp. Date: Old Total Depth

Water well within one-quarter mile: yes XX no
Public water supply well within one mile: yes XX no
Depth to bottom of fresh water: 690
Depth to bottom of usable water: 840

Directional, Deviated or Horizontal wellbore? yes no
If yes, true vertical depth:
Bottom Hole Location:

Surface Pipe by Alternate: 1 XX 2
Length of Surface Pipe Planned to be set: 200
Length of Conductor pipe required: NONE
Projected Total Depth: # 3400

Formation at Total Depth: LANSING/KC
Water Source for Drilling Operations:
well XX farm pond other
DWR Permit #:
Will Cores Be Taken?: yes XX no
If yes, proposed zone:

AFFIDAVIT

The undersigned hereby affirms that the drilling, completion and eventual plugging of this well will comply with K.S.A. 55-101, et. seq.
It is agreed that the following minimum requirements will be met:

1. Notify the appropriate district office prior to spudding of well;
2. A copy of the approved notice of intent to drill shall be posted on each drilling rig;
3. The minimum amount of surface pipe as specified below shall be set by circulating cement to the top; in all cases surface pipe shall be set through all unconsolidated materials plus a minimum of 20 feet into the underlying formation;
4. If the well is dry hole, an agreement between the operator and the district office on plug length and placement is necessary prior to plugging;
5. The appropriate district office will be notified before well is either plugged or production casing is cemented in;
6. IF AN ALTERNATE II COMPLETION, PRODUCTION PIPE SHALL BE CEMENTED FROM BELOW ANY USABLE WATER TO SURFACE WITHIN 120 DAYS OF SPUD DATE. IN ALL CASES, NOTIFY DISTRICT OFFICE PRIOR TO ANY CEMENTING.

I hereby certify that the statements made herein are true and to the best of my knowledge and belief.
Date: 01/07/93 Signature of Operator or Agent: Michael Sternberg Title: vice president

FOR KCC USE:
API # 15- 163-23,218-0000
Conductor pipe required None feet
Minimum surface pipe required 200 feet per Alt. X2
Approved by: CA 1-12-93
This authorization expires: 7-12-93
(This authorization void if drilling not started within 6 months of effective date.)
Spud date: Agent:

REMEMBER TO:

- File Drill Pit Application (form CDP-1) with Intent to Drill;
- File Completion Form ACO-1 within 120 days of spud date;
- File acreage attribution plat according to field proration orders;
- Notify appropriate district office 48 hours prior to workover or re-entry;
- Submit plugging report (CP-4) after plugging is completed;
- Obtain written approval before disposing or injecting salt water.

Mail to: Conservation Division, 200 Colorado Derby Building, 202 W. First St., Wichita, Kansas 67202-1286.

1/11/93
RECEIVED
STATE CORPORATION COMMISSION
JAN 9 9 1993
Wichita, Kansas

IN ALL CASES PLOT THE INTENDED WELL ON THE PLAT BELOW

PLAT OF ACREAGE ATTRIBUTABLE TO A WELL IN A PRORATED OR SPACED FIELD

If the intended well is in a prorated or spaced-field, please fully complete this side of the form. If the intended well is in a prorated or spaced field complete the plat below showing that the well will be properly located in relationship to other wells producing from the common source of supply. Please show all the wells within 1 mile of the boundaries of the proposed acreage attribution unit for gas wells and within 1/2 mile of the boundaries of the proposed acreage attribution unit for oil wells.

API NO. 15-
 OPERATOR HORIZONTAL DEV. & PROD. INC.
 LEASE FISCHER
 WELL NUMBER #1
 FIELD DOPITA

LOCATION OF WELL: COUNTY ROOKS
 @ 2310 feet from south north line of section
990 feet from east west line of section
 SECTION 5 TWP 9s RG 17w

NUMBER OF ACRES ATTRIBUTABLE TO WELL 10
 QTR/QTR/QTR OF ACREAGE NW NE SE

IS SECTION XX REGULAR or IRREGULAR
 IF SECTION IS IRREGULAR, LOCATE WELL FROM NEAREST
CORNER BOUNDARY.

Section corner used: NE NW XX SE SW

PLAT

(Show location of the well and shade attributable acreage for prorated or spaced wells.)
 (Show footage to the nearest lease or unit boundary line.)

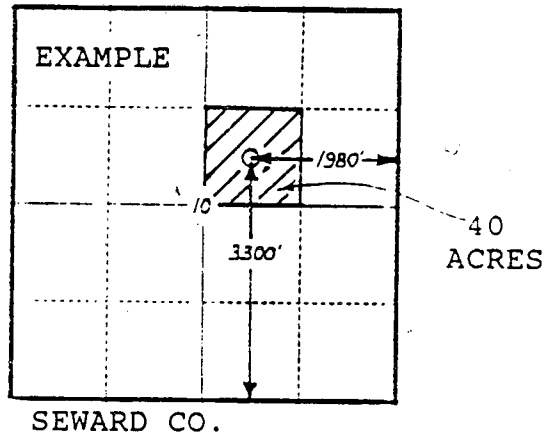
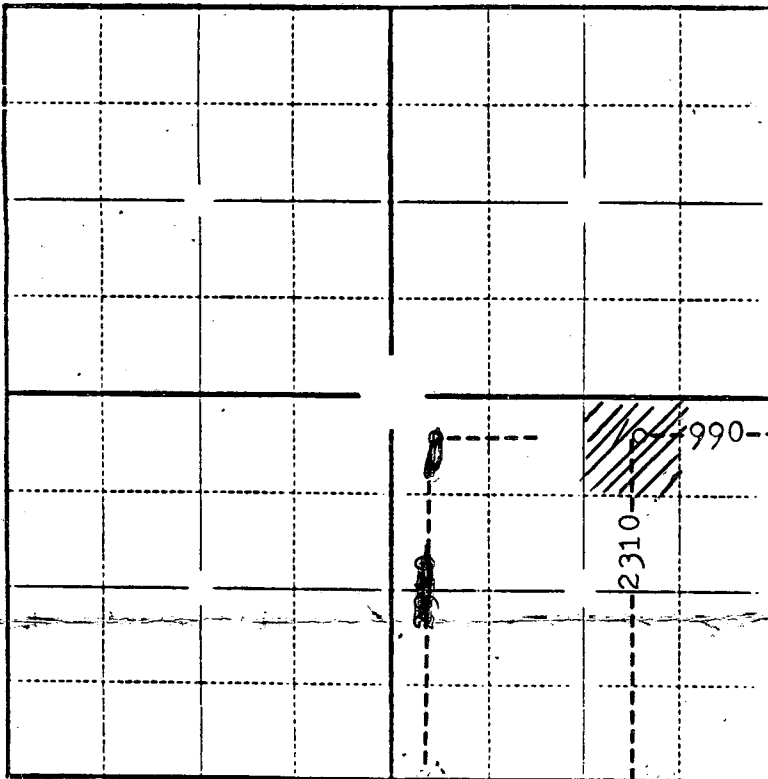

In plotting the proposed location of the well, you must show:

- 1) The manner in which you are using the depicted plat by identifying section lines, i.e. 1 section, 1 section with 8 surrounding sections, 4 sections, etc.;
- 2) the distance of the proposed drilling location from the section's south/north and east/west lines; and
- 3) the distance to the nearest lease or unit boundary line.