

STATE CORPORATION COMMISSION OF KANSAS
OIL & GAS CONSERVATION DIVISION
WELL COMPLETION OR RECOMPLETION FORM
ACO-1 WELL HISTORY
DESCRIPTION OF WELL AND LEASE

Operator: License # 8735
Name S & M Oil
Address 205 N. Jefferson
City/State/Zip Plainville, KS 67663

Purchaser Farmland Industries Inc

Operator Contact Person Steve Crawford
Phone (913) 434-2829

Contractor: License # 4083
Name Western Kansas Drilling

Wellsite Geologist Steve Crawford
Phone (913) 434-2829

Designate Type of Completion
 New Well Re-Entry Workover
 Oil Gas Dry
 SWD Inj Other (Core, Water Supply)
 Temp Abd Delayed Completion

If OWWO: old well info as follows:
Operator
Well Name
Comp. Date
Old Total Depth

WELL HISTORY

Drilling Method:
 Mud Rotary Air Rotary Cable
8-20-88 8-25-88 9-28-88
Spud Date Date Reached TD Completion Date
3402' 3369'
Total Depth PBTD

Amount of Surface Pipe Set and Cemented at 210 feet
Multiple Stage Cementing Collar Used? Yes No
DV Tool If yes, show depth set 1298-1301 feet
If alternate 2 completion, cement circulated from 1298-1301 feet depth to surface/350 SX cmt
Cement Company Name Allied
Invoice # 4388
12-5-88

API No. 15-163-23-014-00-00

County Rooks

C NE NW Sec 7 Twp 9s Rge 16 East
X West

4620 Ft North from Southeast Corner of Section
3300 Ft West from Southeast Corner of Section

(Note: Locate well in section plat below)

Lease Name Kern Well # 3

Field Name Hrabec Westhusin, East

Producing Formation Lansing - Kansas City

Elevation: Ground 1947 KB 1952

Section Plat

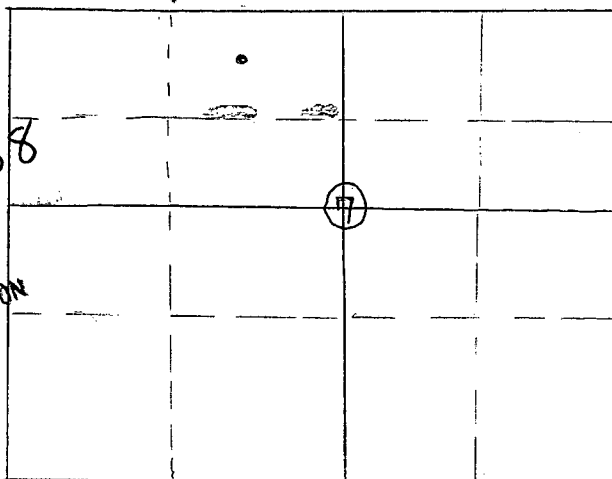

WATER SUPPLY INFORMATION

Disposition of Produced Water: Disposal
Docket # E 22,292 Repressuring

Questions on this portion of the ACO-1 call:
Water Resources Board (913) 296-3717

Source of Water:
Division of Water Resources Permit #

Groundwater Ft North from Southeast Corner
(Well) Ft West from Southeast Corner of
Sec Twp Rge East West

Surface Water Ft North from Southeast Corner
Kern Pond NE 1/4 Sec 1 Twp 9S Rge 17 East X West

Other (explain)
(purchased from city, R.W.D. #)

INSTRUCTIONS: This form shall be completed in duplicate and filed with the Kansas Corporation Commission, 200 Colorado Derby Building, Wichita, Kansas 67202, within 90 days after completion or recompletion of any well. Rule 82-3-130 and 82-3-107 apply. Information on side two of this form will be held confidential for a period of 12 months if requested in writing and submitted with the form. See rule 82-3-107 for confidentiality in excess of 12 months. One copy of all wireline logs and drillers time log shall be attached with this form. Submit CP-4 form with all plugged wells. Submit CP-111 form with all temporarily abandoned wells.

All requirements of the statutes, rules and regulations promulgated to regulate the oil and gas industry have been fully complied with and the statements herein are complete and correct to the best of my knowledge.

Signature Steve Crawford
Title Owner Date 11-14-88

Subscribed and sworn to before me this 14 day of November 1988
Notary Public Louise Van Dyke
Date Commission Expires 5-25-92



K.C.C. OFFICE USE ONLY
F Letter of Confidentiality Attached
C Wireline Log Received
C Drillers Timelog Received
Distribution
KCC SWD/Rep NGPA
KGS Plug Other
(Specify)
11-15-88

SIDE TWO

Operator Name S & M Oil Lease Name..... Kern Well #..... 3.....

Sec..... 7..... Twp..... 9..... Rge..... 16..... East West County..... Kern.....

WELL LOG

INSTRUCTIONS: Show important tops and base of formations penetrated. Detail all cores. Report all drill stem tests giving interval tested, time tool open and closed, flowing and shut-in pressures, whether shut-in pressure reached static level, hydrostatic pressures, bottom hole temperature, fluid recovery, and flow rates if gas to surface during test. Attach extra sheet if more space is needed. Attach copy of log.

Drill Stem Tests Taken Yes No
 Samples Sent to Geological Survey Yes No
 Cores Taken Yes No

Formation Description
 Log Sample

Name	Top	Bottom
Sand & Shale	0	236
Shale	236	790
Shale & Red Bed	790	1490
Shale	1490	2007
Shale & Lime	2007	2277
Lime & Shale	2277	3402

RECEIVED
 OIL & GAS DIVISION
 CALIFORNIA DEPARTMENT OF CONSERVATION
 SEP 28 1988

CASING RECORD TOP <input type="checkbox"/> New Bottom <input type="checkbox"/> Used							
Report all strings set-conductor, surface, intermediate, production, etc.							
Purpose of String	Size Hole Drilled	Size Casing Set (in O.D.)	Weight Lbs/Ft.	Setting Depth	Type of Cement	#Sacks Used	Type and Percent Additives
Surface.....	.12 1/2.....	8 5/8.....	.24.....	210.....	60/40 no	140.....	3% C.C. & 2% Ce
Production.....	.7 7/8.....	5 1/2.....	.14 & .15 1/2.....	3400.....	60/40 no	100.....	8% salt.....
PERFORATION RECORD				Acid, Fracture, Shot, Cement Squeeze Record			
Shots Per Foot	Specify Footage of Each Interval Perforated			(Amount and Kind of Material Used)		Depth	
One.....	3095, 3133, 3152, 3188, 3199, 3256,			5,000 gal. HCl.....			
	3262, 3262, 3274, 3282, 3303.....			Limited Entry.....			
TUBING RECORD				Liner Run <input type="checkbox"/> Yes <input checked="" type="checkbox"/> No			
Size 2 7/8"		Set At 3307'		Packer at None			
Date of First Production 9-28-88		Producing Method <input type="checkbox"/> Flowing <input checked="" type="checkbox"/> Pumping <input type="checkbox"/> Gas Lift <input type="checkbox"/> Other (explain).....					
Estimated Production Per 24 Hours		Oil 3 Bbls	Gas	Water 30 Bbls	Gas-Oil Ratio	Gravity 34	

METHOD OF COMPLETION Production Interval

Disposition of gas: Vented Open Hole Perforation
 Sold Other (Specify) 3095-3303.....
 Used on Lease

Dually Completed
 Commingled

15-163-23014-00-00

483-2627, Russell, Kansas
316-793-5861, Great Bend, Kansas

Phone Plainville 913-434-2812
Phone Ness City 913-798-3843

New

ALLIED CEMENTING CO., INC. No 4387

Home Office P. O. Box 31

Russell, Kansas 67665

Date	Sec.	Twp.	Range	Called Out	On Location	Job Start	Finish
8-25-88	7	9S	16W	9:30 A.M.	12:30 P.M.	6:30 P.M.	7:15 P.M.
Lease	Well No. 3		Location Plainville 6 1/2 E 4 N 1/2 E		County	State	
Contractor Western Ks. Drilg. Rig #1				Owner Same			
Type Job Two-stage Production String				To Allied Cementing Co., Inc. You are hereby requested to rent cementing equipment and furnish cementer and helper to assist owner or contractor to do work as listed.			
Hole Size 7 7/8"		T.D. 3402'		Charge To 5 3/4 M Oil Company			
Csg. 5 1/2"		Depth 3400'		Street 205 W. Jefferson			
Csg. Size 8 7/8"		Depth 215'		City Plainville State Kansas 67663			
Drill Pipe		Depth		The above was done to satisfaction and supervision of owner agent or contractor			
Tool		Depth		Purchase Order No.			
Cement Left in Csg. 27'		Shoe Joint 27'		X <i>[Signature]</i>			
Press Max. 1000 #		Minimum		CEMENT			
Meas Line X		Displace		Amount Ordered 100 sks @ 4.00 per 8 7/8" skt			
Perf.				Consisting of 2% gilsonite 2% gel			

No.	Cementer	Helper
Pumptrk 191	Gary H.	Marlyn K.
Pumptrk		
Bulktrk #60	Lawrence	
Bulktrk		

DEPTH of Job		Reference	Amount
#3 Pumptruck-bottom stage			838.00
#14 mileage @ 1.00/mi			12.00
Sub Total			850.00
Tax			
Total			

Remarks: *[Signature]*

Thanks
[Signature]

Common	60 sks @ 5.00/sk	300.00
Poz. Mix	40 sks @ 2.25/sk	90.00
Gel.	2 sks @ 6.75/sk	13.50
Chloride salt	8 sks @ 4.75/sk	38.00
Quickset		
Gilsonite	346 # @ 294/116	100.34
Sales Tax		
Handling	@ 90¢/sk. (100 sks)	90.00
Mileage	@ 0.34/sk. /mi. (12 mi. /mi)	40.00
Sub Total		671.84
Total		
Floating Equipment 5 1/2"		
1-regular guide shoe		119.00
1-AFU insert (Model "C")		180.00
1-limit clamp		12.00
2-cementing baskets @ 21.00 ea		42.00
3-centrifugers @ 44.00 ea		132.00
1-two-stage collar (Arrow)		24.00

15-163-23014-00-00

Kansas
Bend, Kansas

Phone Plainville 913-434-2812
Phone Ness City 913-798-3843

ALLIED CEMENTING CO., INC. No. 4388

Home Office P. O. Box 31

Russell, Kansas 67665

Sec.	Twp.	Range	Called Out	On Location	Job Start	Finish
7	9 ^s	16 ^w	9:30 A.M.	12:30 P.M.	7:45 P.M.	8:45 P.M.
Well No. 3			Location Plainville 6 1/2 E 4 N 1 1/2 E		County Rocks	State Ks.

Contractor	Western Ks. Drilg. Rig # 1
Type Job	Two Stage Production String
Hole Size	7 7/8" T.D. 3402'
Csg. 5 1/2"	Depth 3400'
Csg. Size 8 7/8"	Depth 215'
Drill Pipe	Depth
Tool D.V. (Arrow)	Depth 1298'
Cement Left in Csg. 27'	Shoe Joint 27'
Press Max. 1500 #	Minimum
Meas Line X	Displace
Perf.	

Owner	Same
To Allied Cementing Co., Inc. You are hereby requested to rent cementing equipment and furnish cementer and helper to assist owner or contractor to do work as listed.	
Charge To	J & M Oil Company
Street	205 North Jefferson
City	Plainville State Ks. 67663
The above was done to satisfaction and supervision of owner agent or contractor	
Purchase Order No.	
X	<i>Steve Crawford</i>
CEMENT	

EQUIPMENT		
No.	Cementer	Gary H.
Pumptrk 191	Helper	Marlyn K.
No.	Cementer	
Pumptrk 114	Helper	
	Driver	Scott R.
Bulktrk #950		
Bulktrk	Driver	

Amount Ordered	350 sks @ 50/50 per 60 gal.
Consisting of	
Common	175 sks @ 5.00/sk. \$875.00
Poz. Mix	175 sks @ 2.25/sk. 393.75
Gel.	21 sks @ 6.75/sk. 141.75
Chloride	
Quickset	
Sales Tax	
Handling	2.90 \$/sk. (350 sks) 315.00
Mileage	2.03 \$/sk./mi. (12 mi.) 126.00
Sub Total \$1851.50	
Total	
Floating Equipment	Thanks

DEPTH of Job	
Reference #3	Pumptruck-top stage \$600.00
#14	mileage N/C.
Sub Total \$600.00	
Tax	
Total	

Remarks: D.V. 500% opened & closed O.K.
Cement Circulated.
Plugged nat hole w/15 sks

RECEIVED
STATE CORPORATION COMMISSION
NOV 15 1988
11-15-1988
CONSERVATION DIVISION
Wichita, Kansas