

15-163-19183-00-00

WELL PLUGGING RECORD

Give All Information Completely
Make Required Affidavit
Mail or Deliver Report to:
Conservation Division
State Corporation Commission
211 No. Broadway
Wichita, Kansas

ROOKS County, Sec. 21 Twp. 9S Rge. 19 (X) (W)

Location as "NE/CNW/SW" or footage from lines N/2 NE NE
Lease Owner PETROLEUM, INC.
Lease Name MONGEAU Well No. 1
Office Address R.R. #2, GREAT BEND, KANSAS
Character of Well (completed as Oil, Gas or Dry Hole) DRY HOLE
Date well completed DEC. 3 19 65
Application for plugging filed DEC. 3 19 65
Application for plugging approved DEC. 3 19 65
Plugging commenced DEC. 3 19 65
Plugging completed DEC. 3 19 65
Reason for abandonment of well or producing formation NO PRODUCIBLE ZONE

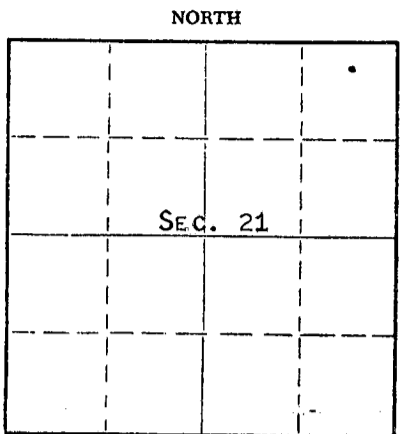

Locate well correctly on above Section Plat

If a producing well is abandoned, date of last production NONE 19
Was permission obtained from the Conservation Division or its agents before plugging was commenced? YES

Name of Conservation Agent who supervised plugging of this well GILBERT LEIKER
Producing formation _____ Depth to top _____ Bottom _____ Total Depth of Well 2650' Feet
Show depth and thickness of all water, oil and gas formations.

OIL, GAS OR WATER RECORDS

CASING RECORD

FORMATION	CONTENT	FROM	TO	SIZE	PUT IN	PULLED OUT
				8-5/8"	223'	NONE

Describe in detail the manner in which the well was plugged, indicating where the mud fluid was placed and the method or methods used in introducing it into the hole. If cement or other plugs were used, state the character of same and depth placed, from _____ feet to _____ feet for each plug set.

MUDDED UP WITH MUD TO 500', FOLLOWED BY WOODEN PLUG, PLACED 20 SACKS CEMENT ON TOP OF PLUG. MUDDED UP WITH HEAVY MUD TO 200', FOLLOWED BY WOODEN PLUG, PLACED 4 SACKS HULLS AND 20 SACKS CEMENT ON TOP OF PLUG. MUDDED UP WITH HEAVY MUD TO 40', FOLLOWED BY WOODEN PLUG, PLACED 1/2 SACK HULLS AND 10 SACKS CEMENT ON TOP OF PLUG TO BASE OF WELL CELLAR.

RECEIVED
STATE CORPORATION COMMISSION

DEC 14 1965

CONSERVATION DIVISION
WICHITA, KANSAS

(If additional description is necessary, use BACK of this sheet)

Name of Plugging Contractor GARVEY DRILLING COMPANY 12-14-65
Address R.R. #2, GREAT BEND, KANSAS

STATE OF KANSAS COUNTY OF BARTON, ss.
MONTE CHADD (employee of owner) or (owner or operator) of the above-described

well, being first duly sworn on oath, says: That I have knowledge of the facts, statements, and matters herein contained and the log of the above-described well as filed and that the same are true and correct. So help me God. MONTE CHADD DIST. PROD SUPT.

(Signature) [Signature]
R.R. #2, GREAT BEND, KANSAS
(Address)

SUBSCRIBED AND SWORN TO before me this 13 day of DECEMBER, 19 65

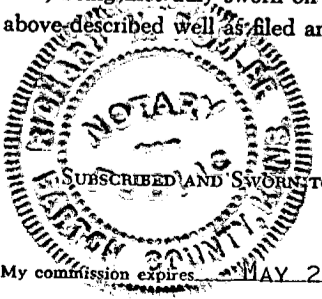

Richard H. Dumbleton
Notary Public.

WELL LOG 15-163-19183-00-00

COMPANY Petroleum, Inc

SEC. 21 T. 9S R. 19W

FARM Mongeau NO. 1

LOC. N/2 NE NE

TOTAL DEPTH 2650'

COUNTY Rooks

COMM. 11-29-65 COMP. 12-2-65

CONTRACTOR Garvey Drilling Company

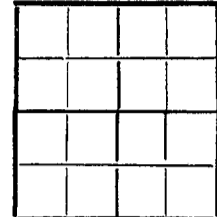

CASING 8 5/8" @ 223' w/175 sx

ELEVATION 2103' GL

PRODUCTION D & A

FIGURES INDICATE BOTTOM OF FORMATIONS

- 775' Shale
- 970' Shale and Sand Streaks
- 1155' Sand
- 1220' Shale and Sand
- 1490' Shale
- 1535' Anhydrite
- 1750' Shale
- 2120' Shale and Lime Streaks
- 2515' Lime and Shale
- 2605' Shale and Lime
- 2650' Shale
- 2650' RTD

RECEIVED
STATE CORPORATION COMMISSION

DEC 14 1965

12-14-65

CONSERVATION DIVISION
Wichita, Kansas

State of Kansas }
County of Barton } ss

I, Sam N. Stephens of Garvey Drilling Company

upon oath state the above and foregoing is a true and correct copy of the log of the Mongeau No. 1 well.



Sam N. Stephens

Subscribed and sworn to before me this 10th day of December 19 65

My Commission Expires: November 5, 1969

Richard H. Boys
NOTARY PUBLIC