

15-065-01531-00-00

WELL PLUGGING RECORD

Give All Information Completely
 Make Required Affidavit

COUNTY Graham SEC. 19 TWP. 9 RGE. 22 NW
 Location as in quarters or footage from lines:
C/SE/SE

Locate Well
 correctly on above
 Section Platt.

Lease Owner John O. Farmer, Inc.
 Lease Name Farrell Well No. #2
 Office Address 370 W. Wichita - Box 352 - Russell, Ks.
 Character of Well (Completed as Oil, Gas or Dry Hole): Oil
 Date Well Completed _____
 Application for plugging filed _____
 Plugging commenced June 28, 1983
 Plugging completed July 06, 1983
 Reason for abandonment of well or producing formation
Depleted

Was permission obtained from the Conservation Division or it's
 Agent's before plugging was commenced? Yes

Name of Conservation Agent who supervised plugging of this well Carl Goodrow

Producing formation _____ Depth to top _____ bottom _____ T.D. 3915'

Show depth and thickness of all water, oil and gas formations.

OIL, GAS OR WATER RECORDS Casing Record

Formation	Content	From	To	Size	Put in	Pulled Out
				8 5/8"	160'	NONE
				4 1/2"	3914'	822.37'

Describe in detail the manner in which the well was plugged, indicating where the mud
 fluid was placed and the method or methods used in introducing it into the hold. If cement
 or other plugs were used, state the character of same and depth placed, from _____ feet
 to _____ feet for each plug set.

Dumped four (4) sacks cement, sanded to 3825' and dumped four (4) sacks
 cement.
 Shot casing at 2000', 1500', 1000' and 800'.
 Pulled twenty-six (26) joints 4 1/2" casing.
 Squeezed well with two (2) sacks hulls, twenty-seven (27) sacks gel,
 one hundred (100) sacks cement, thirteen (13) sacks gel, released
 plug and pumped seventy (70) sacks 50/50 pozmix cement with 6% added
 gel and 3% calcium chloride.

(If additional description is necessary, use BACK of this sheet)
 Name of Plugging Contractor Rockhold Engineering, Inc.

STATE OF KANSAS COUNTY OF BARTON, ss.
James W. Rockhold (employee of owner) or (owner or operator) of the
 above-described well, being first duly sworn on oath, says: That I have knowledge of the
 facts, statements, and matters herein contained and the log of the above-described well as
 filed and that the same are true and correct. So help me God.

(Signature) James W. Rockhold
 JAMES W. ROCKHOLD - Box 698 - Great Bend, Ks.
 (Address) 67530

SUBSCRIBED AND SWORN TO before me this 14th day of July, 1983

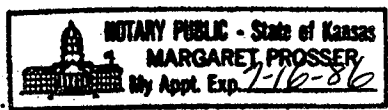

Margaret Prosser
 Notary Public.

My Commission expires: _____

RECEIVED
 STATE CORPORATION COMMISSION
15-83
JUL 15 1983

OPERATOR John O. Farmer, Inc.

ADDRESS P.O. Box 352, Russell, Kansas

Give detailed description and thickness of all formation drilled through, contents of sand, whether dry, water, oil or gas.

WELL NO. 2 COUNTY Grahams TWP 9S RGE. 22W FARM NAME FARRELL

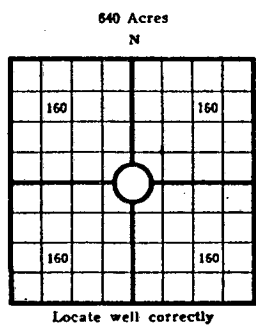

COUNTY Graham SEC. 19 TWP. 9s RGE. 22w
COMPANY OPERATING John O. Farmer, Inc.
OFFICE ADDRESS P.O. Box 352, Russell, Kansas
DRILLING STARTED 3/9 64, 1964, DRILLING FINISHED 3/18 64, 1964
DATE OF FIRST PRODUCTION SE SE COMPLETED
WELL LOCATED 1/4 1/4 1/4 North of South Line and _____ ft. East of West Line of Quarter Section
Elevation (Relative to sea level) DERRICK FLOOR 2429 GROUND 2426
CHARACTER OF WELL (Oil, gas or dryhole) Oil

OIL OR GAS SANDS OR ZONES

Name	From	To	Name	From	To
1			4		
2			5		
3			6		

Perforating Record If Any

Shot Record

Formation	From	To	No. of Shots	Formation	From	To	Size of Shot

CASING RECORD

Amount Set								Amount Pulled		Packer Record	
Size	Wt.	Thds.	Make	Ft.	In.	Ft.	In.	Size	Length	Depth Set	Make

Liner Record: Amount _____ Kind _____ Top _____ Bottom _____

CEMENTING AND MUDDING

Size	Amount Set		Sacks Cement	Chemical		Method of Cementing	Amount	Mudding Method	Results (See Note)
	Ft.	In.		Gal.	Make				
8	5/8"	160'	130	bx.					
4	1/2"	39' 1/4"	100	bx.					

Note: What method was used to protect sands if outer strings were pulled? _____

NOTE: Were bottom hole plugs used? _____ If so, state kind, depth set and results obtained _____

TOOLS USED

Rotary Tools were used from 0 feet to R.T.D. Cable tools were used from _____ feet to _____ feet, and from _____ feet to _____ feet, and from _____ feet to _____ feet
Type Rig Rotary

INITIAL PRODUCTION TEST

Describe initial test: whether by flow through tubing or casing or by pumping _____
Amount of Oil Production _____ bbls. Size of choke, if any _____ Length of test _____ Water Production _____ bbls. Gravity of oil _____ Type of Pump if pump is used, describe _____

Formation	Top	Bottom	Formation	Top	Bottom
Shale	160	360			
Shale & Sand	360	1500			
Dakota Sand	1500	1710			
Shale & Redbed	1710	1968			
Anhydrite	1968	2005			
Shale & Shells	2005	2635			
Shale & Limeq	2635	2785			
Lime & Shale	2785	3731			
Lime	3731	3915			
T.D.	3915				

Sample Tops

Anhydrite	1968	(- 463)
Heebner	3648	(-1217)
Toronto	3671	(-1240)
Lansing-Kansas C.	3685	(-1254)
Base-Kansas City	3910	(-1479)
T. D.	3915	(-1484)

RECEIVED
STATE CORPORATION COMMISSION
MAY 17 1983
CONSERVATION DIVISION
Wichita, Kansas
5-17-83

15-065-61531-00-00

I, the undersigned, being first duly sworn upon oath, state that this well record is true, correct and complete according to the records of this office and to the best of my knowledge and belief.

John O. Farmer
Name and title of representative of company
President
Subscribed and sworn to before me this 19th day of March, 1964

My Commission expires 2/15/67

Helen Carlson
Notary Public.