

FORM MUST BE TYPED

FORM MUST BE SIGNED

ALL BLANKS MUST BE FILLED

EFFECTIVE DATE: 4-7-2001DISTRICT # 4SGA? ... Yes ☒ No

State of Kansas

NOTICE OF INTENTION TO DRILL

Must be approved by the K.C.C. five (5) days prior to commencing well.

Expected Spud Date April 1 2 2001 / Spot 110' N C
 month day year N 1/2 SE SE Sec 21 Twp 9 S, Rg 25 X East West

OPERATOR: License # 31866
 Name: RL Investment
 Address: HCR-01 Box 63
 City/State/Zip: Morland, KS 67650
 Contact Person: Leon Pfeifer
 Phone: 785-627-5711

CONTRACTOR: License # 30606
 Name: Murfdn Drilling

Well Drilled For: Well Class: Type Equipment:

☒ Oil ... Enh Rec ... Infield ☒ Mud Rotary
☐ Gas ... Storage ☒ Pool Ext. ... Air Rotary
☐ OWWO ... Disposal ... Wildcat ... Cable
☐ Seismic; ... # of Holes ... Other
☐ Other

If OWWO: old well information as follows:

Operator:
 Well Name:
 Comp. Date: Old Total Depth

Directional, Deviated or Horizontal wellbore? yes ☒ no
 If yes, true vertical depth:
 Bottom Hole Location:

1100 feet from South / North line of Section
660 feet from East / West line of Section
 IS SECTION ☒ REGULAR ☐ IRREGULAR?

(NOTE: Locate well on the Section Plat on Reverse Side)

County: GrahamLease Name: Dreiling Well #: 4Field Name: Emor NWIs this a Prorated/Spaced Field? yes ☒ noTarget Formation(s): Cherokee-LKCNearest lease or unit boundary: 660Ground Surface Elevation: 2607 EST feet MSLWater well within one-quarter mile: yes ☒ noPublic water supply well within one mile: yes ☒ noDepth to bottom of fresh water: 550 150Depth to bottom of usable water: 200 1400 3/4 DAVOTASurface Pipe by Alternate: 1 ☒ 2Length of Surface Pipe Planned to be set: 200Length of Conductor pipe required: NAProjected Total Depth: 4320Formation at Total Depth: Cherokee

Water Source for Drilling Operations:

... well farm pond ☒ otherWill Cores Be Taken?: yes ☒ no

If yes, proposed zone:

AFFIDAVIT

The undersigned hereby affirms that the drilling, completion and eventual plugging of this well will comply with K.S.A. 55-101, et. seq.

It is agreed that the following minimum requirements will be met:

1. Notify the appropriate district office prior to spudding of well;
2. A copy of the approved notice of intent to drill shall be posted on each drilling rig;
3. The minimum amount of surface pipe as specified below shall be set by circulating cement to the top; in all cases surface pipe shall be set through all unconsolidated materials plus a minimum of 20 feet into the underlying formation;
4. If the well is dry hole, an agreement between the operator and the district office on plug length and placement is necessary prior to plugging;
5. The appropriate district office will be notified before well is either plugged or production casing is cemented in;
6. IF AN ALTERNATE II COMPLETION, PRODUCTION PIPE SHALL BE CEMENTED FROM BELOW ANY USABLE WATER TO SURFACE WITHIN 120 DAYS OF SPUD DATE. IN ALL CASES, NOTIFY DISTRICT OFFICE PRIOR TO ANY CEMENTING.

I hereby certify that the statements made herein are true and to the best of my knowledge and belief.

Date: 3-28-01 Signature of Operator or Agent: Leon Pfeifer Title: Partner

FOR KCC USE:

API # 15- 065-22817-0000Conductor pipe required NONE feetMinimum surface pipe required 200 feet per Alt. ☒ 2Approved by: JK 4-2-2001This authorization expires: 10-2-2001

(This authorization void if drilling not started within 6 months of effective date.)

Spud date: _____ Agent: _____

REMEMBER TO:

- File Drill Pit Application (form CDP-1) with Intent to Drill;
- File Completion Form ACO-1 within 120 days of spud date;
- File acreage attribution plat according to field proration orders;
- Notify appropriate district office 48 hours prior to workover or re-entry;
- Submit plugging report (CP-4) after plugging is completed;
- Obtain written approval before disposing or injecting salt water.

Mail to: KCC - Conservation Division, 130 S. Market - Room 2078, Wichita, Kansas 67202.

RECEIVED
 STATE CORPORATION COMMISSION
 MAR 30 2001

CONSERVATION DIVISION
 Wichita, Kansas

21
 9
 25W

IN ALL CASES PLOT THE INTENDED WELL ON THE PLAT BELOW

PLAT OF ACREAGE ATTRIBUTABLE TO A WELL IN A PRORATED OR SPACED FIELD

If the intended well is in a prorated or spaced field, please fully complete this side of the form. If the intended well is in a prorated or spaced field complete the plat below showing that the well will be properly located in relationship to other wells producing from the common source of supply. Please show all the wells within 1 mile of the boundaries of the proposed acreage attribution unit for gas wells and within 1/2 mile of the boundaries of the proposed acreage attribution unit for oil wells.

API NO. 15- _____
OPERATOR RL Investment LOCATION OF WELL: COUNTY Graham
LEASE Dreiling _____ 1100 feet from South/north line of section
WELL NUMBER #4 _____ 660 feet from East/west line of section
FIELD Emor NW _____ SECTION 21 TWP 9S RG 25W

NUMBER OF ACRES ATTRIBUTABLE TO WELL _____ IS SECTION X REGULAR or _____ IRREGULAR
QTR/QTR/QTR OF ACREAGE _____ **IF SECTION IS IRREGULAR, LOCATE WELL FROM NEAREST CORNER BOUNDARY.**

Section corner used: _____ NE _____ NW _____ SE _____ SW

PLAT

(Show location of the well and shade attributable acreage for prorated or spaced wells.)
(Show footage to the nearest lease or unit boundary line.)

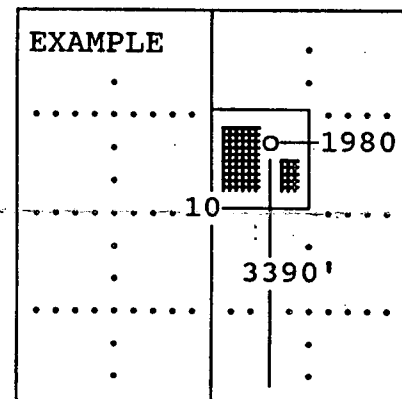
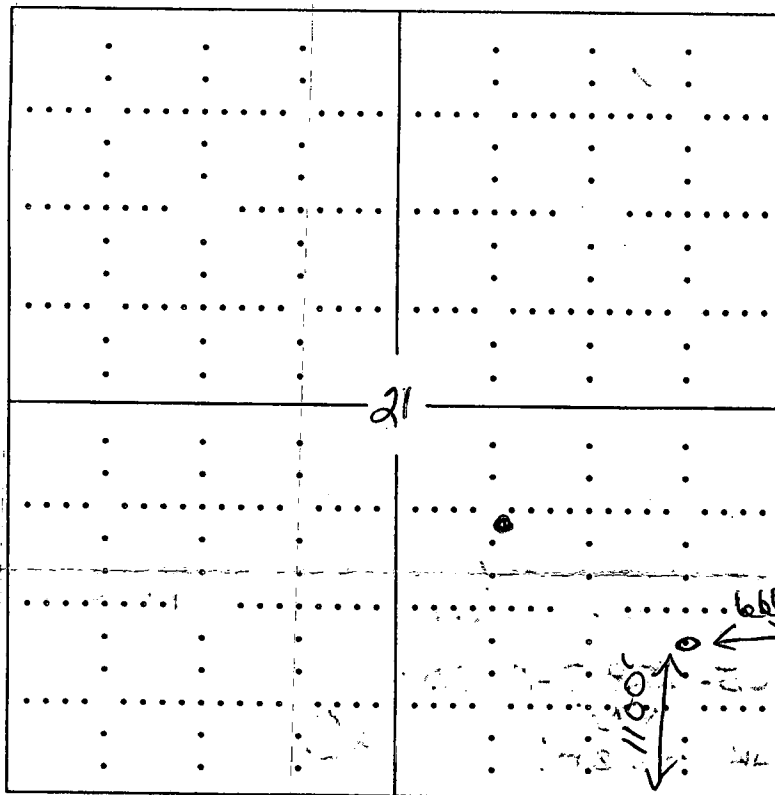

SEWARD CO.

In plotting the proposed location of the well, you must show:

- 1) The manner in which you are using the depicted plat by identifying section lines, i.e. 1 section, 1 section with 8 surrounding sections, 4 sections, etc.;
- 2) the distance of the proposed drilling location from the section's south/north and east/west; and
- 3) the distance to the nearest lease or unit boundary line.