

FOR KCC USE:

FORM C-1 7/91

FORM MUST BE TYPED

FORM MUST BE SIGNED

ALL BLANKS MUST BE FILLED

EFFECTIVE DATE: 10-1-91  
DISTRICT # 4  
SGA? Yes  No

State of Kansas  
NOTICE OF INTENTION TO DRILL

Must be approved by the K.C.C. five (5) days prior to commencing well

Expected Spud Date .....  
month day year

Spot \_\_\_\_\_ East  
NE NE Sec 2 Twp 9 S Rg 26 X West

OPERATOR: License # 6867  
Name: Steinle Oil Co.  
Address: 624 E. Third  
City/State/Zip: Russell, KS 67665  
Contact Person: Lavern Steinle - Wallace Carlson  
Phone: (913)-483-3905 / (303)-671-6036

330' feet from South / North line of Section  
330' feet from East / West line of Section

IS SECTION X REGULAR IRREGULAR?

(NOTE: Locate well on the Section Plat on Reverse Side)

County: Sheridan  
Lease Name: Edwin Simon Well #: 1-A

Field Name: UNNAMED

Is this a Prorated/Spaced Field? yes X no

Target Formation(s): Lansing

Nearest lease or unit boundary: 330'

Ground Surface Elevation: 2360' est. feet MSL

Water well within one-quarter mile: yes X no

Public water supply well within one mile: yes X no

Depth to bottom of fresh water: 120'

Depth to bottom of usable water: 1070' 1160'

Surface Pipe by Alternate: 1 X 2

Length of Surface Pipe Planned to be set: 240'

Length of Conductor pipe required: -0-

Projected Total Depth: 4050'

Formation at Total Depth: Lansing

Water Source for Drilling Operations:  
... well X farm pond ... other

DWR Permit #: \_\_\_\_\_

Will Cores Be Taken? yes X no

If yes, proposed zone: \_\_\_\_\_

CONTRACTOR: License #: 8241  
Name: Emphasis Oil Operations

Well Drilled For: Well Class: Type Equipment:  
X Oil Enh Rec Infield X Mud Rotary  
Gas Storage Pool Ext. Air Rotary  
OWWO Disposal X Wildcat Cable  
Seismic; # of Holes Other

If OWWO: old well information as follows:  
Operator: \_\_\_\_\_  
Well Name: \_\_\_\_\_  
Comp. Date: \_\_\_\_\_ Old Total Depth: \_\_\_\_\_

Directional, Deviated or Horizontal wellbore? yes X no

If yes, true vertical depth: \_\_\_\_\_

Bottom Hole Location: \_\_\_\_\_

AFFIDAVIT

The undersigned hereby affirms that the drilling, completion and eventual plugging of this well will comply with K.S.A. 55-101, et. seq.

It is agreed that the following minimum requirements will be met:

- 1. Notify the appropriate district office prior to spudding of well;
- 2. A copy of the approved notice of intent to drill shall be posted on each drilling rig;
- 3. The minimum amount of surface pipe as specified below shall be set by circulating cement to the top; in all cases surface pipe shall be set through all unconsolidated materials plus a minimum of 20 feet into the underlying formation;
- 4. If the well is dry hole, an agreement between the operator and the district office on plug length and placement is necessary prior to plugging;
- 5. The appropriate district office will be notified before well is either plugged or production casing is cemented in;
- 6. IF AN ALTERNATE II COMPLETION, PRODUCTION PIPE SHALL BE CEMENTED FROM BELOW ANY USABLE WATER TO SURFACE WITHIN 120 DAYS OF SPUD DATE. IN ALL CASES, NOTIFY DISTRICT OFFICE PRIOR TO ANY CEMENTING.

I hereby certify that the statements made herein are true and to the best of my knowledge and belief.

Date: 9-25-91 Signature of Operator or Agent: \_\_\_\_\_ Title: Agent

FOR KCC USE:  
API # 15- 19-21,023-00-00  
Conductor pipe required 1160 feet  
Minimum surface pipe required 240 feet per Alt. #2  
Approved by: [Signature] 9-26-91  
This authorization expires: 3-26-92  
(This authorization void if drilling not started within 6 months of effective date.)  
Spud date: \_\_\_\_\_ Agent: \_\_\_\_\_

RECEIVED  
STATE CORPORATION COMMISSION  
09-26-1991  
SEP 26 1991

CONSERVATION DIVISION  
Wichita Kansas

- REMEMBER TO:
- File Drill Pit Application (form CDP-1) with Intent to Drill;
  - File Completion Form ACO-1 within 120 days of spud date;
  - File acreage attribution plat according to field proration orders;
  - Notify appropriate district office 48 hours prior to workover or re-entry;
  - Submit plugging report (CP-4) after plugging is completed;
  - Obtain written approval before disposing or injecting salt water.

Mail to: Conservation Division, 200 Colorado Derby Building, 202 W. First St., Wichita, Kansas 67202-1286.

2  
6  
260

IN ALL CASES PLOT THE INTENDED WELL ON THE PLAT BELOW

**PLAT OF ACREAGE ATTRIBUTABLE TO A WELL IN A PRORATED OR SPACED FIELD**

If the intended well is in a prorated or spaced field, please fully complete this side of the form. If the intended well is in a prorated or spaced field complete the plat below showing that the well will be properly located in relationship to other wells producing from the common source of supply. Please show all the wells within 1 mile of the boundaries of the proposed acreage attribution unit for gas wells and within 1/2 mile of the boundaries of the proposed acreage attribution unit for oil wells.

API NO. 15- \_\_\_\_\_  
 OPERATOR \_\_\_\_\_ LOCATION OF WELL: COUNTY \_\_\_\_\_  
 LEASE \_\_\_\_\_ feet from south/north line of section  
 WELL NUMBER \_\_\_\_\_ feet from east/west line of section  
 FIELD \_\_\_\_\_ SECTION \_\_\_\_\_ TWP \_\_\_\_\_ RG \_\_\_\_\_

NUMBER OF ACRES ATTRIBUTABLE TO WELL \_\_\_\_\_ IS SECTION \_\_\_\_\_ REGULAR or \_\_\_\_\_ IRREGULAR  
 QTR/QTR/QTR OF ACREAGE \_\_\_\_\_ IF SECTION IS IRREGULAR, LOCATE WELL FROM NEAREST  
 CORNER BOUNDARY.

Section corner used: \_\_\_\_\_ NE \_\_\_\_\_ NW \_\_\_\_\_ SE \_\_\_\_\_ SW

**PLAT**

(Show location of the well and shade attributable acreage for prorated or spaced wells.)  
 (Show footage to the nearest lease or unit boundary line.)

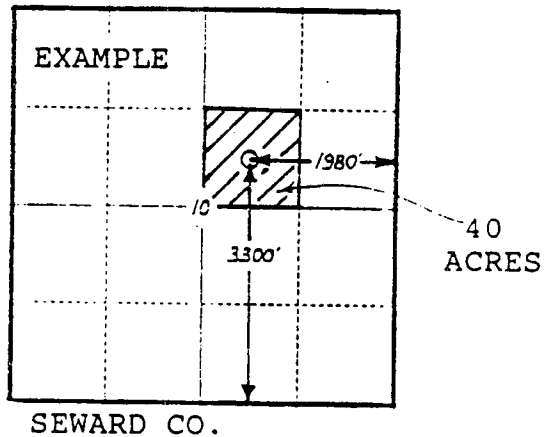
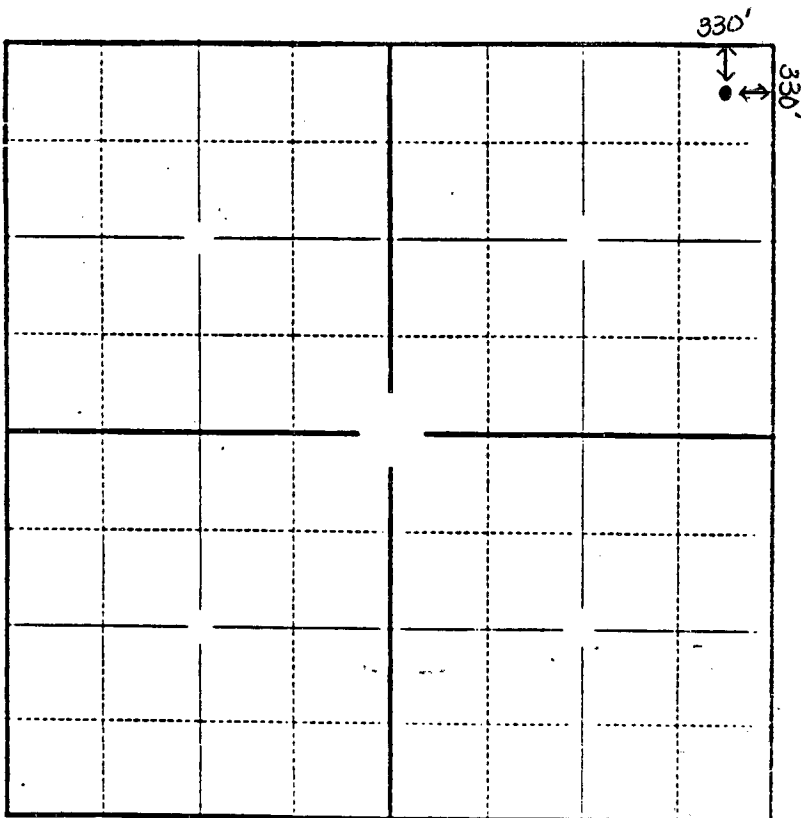

In plotting the proposed location of the well, you must show:

- 1) The manner in which you are using the depicted plat by identifying section lines, i.e. 1 section, 1 section with 8 surrounding sections, 4 sections, etc.;
- 2) the distance of the proposed drilling location from the section's south/north and east/west lines; and
- 3) the distance to the nearest lease or unit boundary line.