

Must be approved by the K.C.C. five (5) days prior to commencing well

Expected Spud Date 06 25 1991  
month day year

Ap. SW NE NE NW Sec 4 Twp 9-S S, Rg 26-W XX West

OPERATOR: License # 06113  
Name: Landmark Oil Exploration, Inc.  
Address: 250 N. Water, Suite 308  
City/State/Zip: Wichita, Kansas  
Contact Person: Jeff Wood  
Phone: (316) 265-8181

4950-4726 feet from South line of Section  
2970-3194 feet from East line of Section  
(Note: Locate well on Section Plat on Reverse Side)

CONTRACTOR: License #: 6033  
Name: Murfin Drilling Company

County: Sheridan  
Lease Name: Minium Well #: #2-4  
Field Name: unnamed Minium  
Is this a Prorated Field? X yes XX no  
Target Formation(s): LKC  
Nearest lease or unit boundary: 330-554'  
Ground Surface Elevation: N/A feet MSL  
Domestic well within 330 feet: yes XX no  
Municipal well within one mile: yes XX no  
Depth to bottom of fresh water: 220'  
Depth to bottom of usable water: 2480'  
Surface Pipe by Alternate: 1 XX 2  
Length of Surface Pipe Planned to be set: 275  
Length of Conductor pipe required: N/A  
Projected Total Depth: 3950'  
Formation at Total Depth: BKC  
Water Source for Drilling Operations:  
... well ... farm pond XX other

Well Drilled For: Well Class: Type Equipment:  
XX Oil ... Inj | ... Infield XX Mud Rotary  
... Gas ... Storage ... Pool Ext. ... Air Rotary  
... OWWO ... Disposal XX Wildcat ... Cable  
... Seismic; ... # of Holes

If OWWO: old well information as follows:  
Operator:  
Well Name:  
Comp. Date: Old Total Depth

Directional, Deviated or Horizontal wellbore? yes XX no  
If yes, total depth location:

DWR Permit #:  
Will Cores Be Taken?: yes XX no  
If yes, proposed zone:

\* Prorated: Twin-Shawnee (LKC) oil

**AFIDAVIT**

The undersigned hereby affirms that the drilling, completion and eventual plugging of this well will comply with K.S.A. 55-101, et. seq.

It is agreed that the following minimum requirements will be met:

1. The appropriate district office shall be notified before setting surface pipe;
2. The minimum amount of surface pipe as specified above shall be set by circulating cement to the top; in all cases surface pipe shall be set through all unconsolidated materials plus a minimum of 20 feet into the underlying formation;
3. If the well is dry, a plugging proposal shall be submitted to the district office. An agreement between the operator and the district office on plug length and placement is necessary prior to plugging;
4. The appropriate district office will be notified before well is either plugged or production casing is cemented in;
5. If an Alternate II completion, production pipe shall be cemented from below any usable water to surface within 120 days of spud date. In all cases, notify district office prior to any cementing.

I hereby certify that the statements made herein are true and to the best of my knowledge and belief.

Date: 06/19/91 Signature of Operator or Agent: Jeffrey R. Wood Title: President

FOR KCC USE:

API # 15-179-24013-00-00  
 Conductor pipe required N/A feet  
 Minimum surface pipe required 275 feet per Alt. XC2  
 Approved by: DPW 6-24-91  
 EFFECTIVE DATE: 6-29-91  
 This authorization expires: 12-24-91  
 (This authorization void if drilling not started within 6 months of effective date.)  
 Spud date: \_\_\_\_\_ Agent: \_\_\_\_\_

**REMEMBER TO:**

- File Drill Pit Application (form CDP-1) with Intent to Drill;
- File Completion Form ACO-1 within 120 days of spud date;
- File acreage attribution plat according to field proration orders;
- Notify appropriate district office 48 hours prior to workover or re-entry;
- Submit plugging report (CP-4) after plugging is completed;
- Obtain written approval before disposing or injecting salt water.

40 A  
150' center  
W A L K I N

TWIN-SHAWNEE  
RECEIVED  
DATE OPERATOR TO KANSAS  
JUN 19 1991  
Wichita, Kansas  
4  
9  
2600

**PLAT OF ACREAGE ATTRIBUTABLE TO A WELL**

State Corporation Commission, Conservation Division  
200 Colorado Derby Bldg. Wichita, Kansas 67202

OPERATOR Landmark Oil Exploration, Inc. LOCATION OF WELL: NE NE NW, 4-9S-26W  
 LEASE Minium 4950 4726' feet north of SE corner  
 WELL NUMBER #1-4 2970 3174' feet west of SE corner  
 FIELD \_\_\_\_\_ NW/4 Sec. 4 T 9-S R 26-W E/W  
 COUNTY Sheridan  
 NO. OF ACRES ATTRIBUTABLE TO WELL 40 IS SECTION XX REGULAR \_\_\_\_\_ IRREGULAR?  
160 IF IRREGULAR, LOCATE WELL FROM NEAREST  
 DESCRIPTION OF ACREAGE NW/4 CORNER BOUNDARY.

NOTE: If plat depicted is insufficient for your circumstances, you may attach your own scaled or surveyed plat.

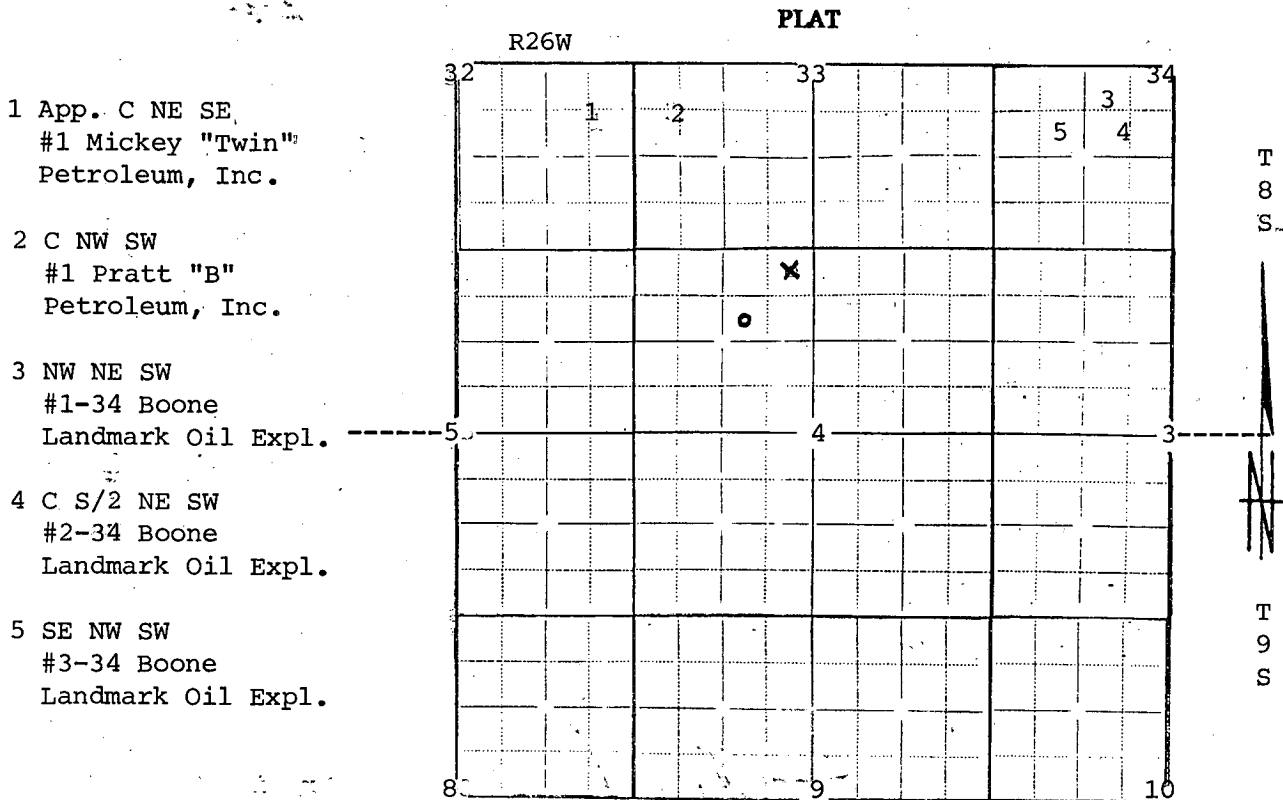

In plotting the proposed location of the well, you must show:

- 1) The manner in which you are using the depicted plat by identifying section lines, i.e. 1 section, 1 section with 8 surrounding partial sections, 4 sections, 16 sections, etc.;
- 2) the well's location relative to the location of other wells producing from the same common source of supply in adjoining drilling units, pursuant to K.A.R. 82-3-108, 82-3-207, 82-3-312, or special orders of the Commission;
- 3) the distance of the proposed drilling location from the section's east and south lines; and
- 4) the distance to the nearest lease or unit boundary line.

I hereby certify that the statements made herein are true and to the best of my knowledge and belief.

Signature of Operator or Agent \_\_\_\_\_

Date June 19, 1991 Title President, Jeffrey R. Wood

**JAMES**