

EFFECTIVE DATE: 11-11-90

State of Kansas

P.4.

NOTICE OF INTENTION TO DRILL

Must be approved by the K.C.C. five (5) days prior to commencing well

Expected Spud Date November 12 1990
month day year

SW SE NW Sec 7 Twp 9-S S, Rg 32-W XX East
XX West
..... 2970 feet from South line of Section
..... 3630 feet from East line of Section

OPERATOR: License # 06113
Name: Landmark Oil Exploration, Inc.
Address: 250 N. Water, Suite 308
City/State/Zip: Wichita, Kansas 67202
Contact Person: Jeffrey R. Wood
Phone: (316) 265-8181

(Note: Locate well on Section Plat on Reverse Side)
County: Thomas
Lease Name: Horn Well #: 1-7
Field Name: unnamed
Is this a Prorated Field? yes XX no
Target Formation(s): LKC Johnson
Nearest lease or unit boundary: 330'
Ground Surface Elevation: N/A feet MSL
Domestic well within 330 feet: yes XX no
Municipal well within one mile: yes XX no
Depth to bottom of fresh water:
Depth to bottom of usable water: 1950
Surface Pipe by Alternate: 1 XX 2
Length of Surface Pipe Planned to be set: 290'
Length of Conductor pipe required: N/A
Projected Total Depth: 4750'
Formation at Total Depth: Mississippian
Water Source for Drilling Operations:
.... well farm pond XX other

CONTRACTOR: License #: 6033
Name: Murfin Drilling Company

Well Drilled For: Well Class: Type Equipment:
XX Oil ... Inj ... Infield XX Mud Rotary
... Gas ... Storage ... Pool Ext. ... Air Rotary
... OWWO ... Disposal XX Wildcat ... Cable
... Seismic; ... # of Holes

If OWWO: old well information as follows:
Operator:
Well Name:
Comp. Date: Old Total Depth

Directional, Deviated or Horizontal wellbore? yes XX no
If yes, total depth location:

AFFIDAVIT

** 290' surface pipe required for ALT 2*

The undersigned hereby affirms that the drilling, completion and eventual plugging of this well will comply with K.S.A. 55-101, et. seq.

- It is agreed that the following minimum requirements will be met:
1. The appropriate district office shall be notified before setting surface pipe;
 2. The minimum amount of surface pipe as specified above shall be set by circulating cement to the top; in all cases surface pipe shall be set through all unconsolidated materials plus a minimum of 20 feet into the underlying formation;
 3. If the well is dry, a plugging proposal shall be submitted to the district office. An agreement between the operator and the district office on plug length and placement is necessary prior to plugging;
 4. The appropriate district office will be notified before well is either plugged or production casing is cemented in;
 5. If an Alternate II completion, production pipe shall be cemented from below any usable water to surface within 120 days of spud date. In all cases, notify district office prior to any cementing.
- I hereby certify that the statements made herein are true and to the best of my knowledge and belief.

Date: November 5, 1990 Signature of Operator or Agent: Jeffrey R. Wood Title: President

FOR KCC USE:
API # 15- 193-20,532-00-00
Conductor pipe required None feet
Minimum surface pipe required 290 feet per Alt. (2)
Approved by: MW 11-6-90
EFFECTIVE DATE: 11-11-90
This authorization expires: 5-6-91
(This authorization void if drilling not started within 6 months of effective date.)
Spud date: _____ Agent: _____

WALKN

RECEIVED
STATE CORPORATION COMMISSION
NOV 8 1990
11-06-1990
CONSERVATION DIVISION
Wichita, Kansas

REMEMBER TO:

- File Drill Pit Application (form CDP-1) with Intent to Drill;
- File Completion Form ACO-1 within 120 days of spud date;
- File acreage attribution plat according to field proration orders;
- Notify appropriate district office 48 hours prior to workover or re-entry;
- Submit plugging report (CP-4) after plugging is completed;
- Obtain written approval before disposing or injecting salt water.

PLAT OF ACREAGE ATTRIBUTABLE TO A WELL

State Corporation Commission, Conservation Division
 200 Colorado Derby Bldg. Wichita, Kansas 67202

OPERATOR Landmark Oil Exploration, Inc. LOCATION OF WELL: SW SE NW, Sec. 7-9S-32W
 LEASE Horn 2970 feet north of SE corner
 WELL NUMBER 1-7 3630 feet west of SE corner
 FIELD unnamed NW/4, Sec. 7 T 9-S R 32-W XX/W
 COUNTY Thomas
 NO. OF ACRES ATTRIBUTABLE TO WELL 160 IS SECTION XX REGULAR ... IRREGULAR?
 DESCRIPTION OF ACREAGE NW/4, IF IRREGULAR, LOCATE WELL FROM NEAREST
 CORNER BOUNDARY.

NOTE: If plat depicted is insufficient for your circumstances, you may attach your own scaled or surveyed plat.

PLAT

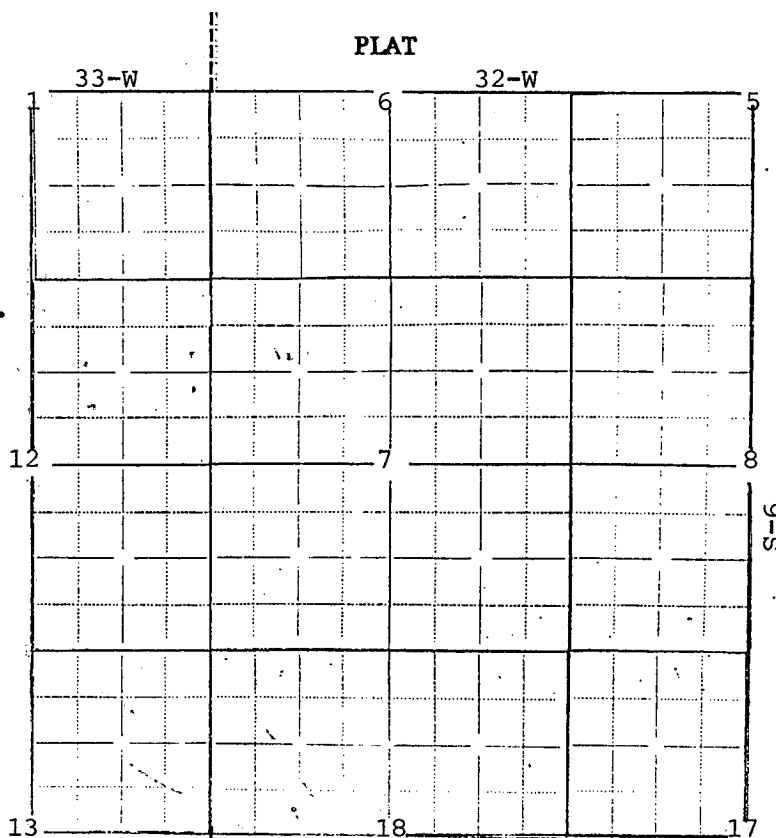

No production within
 3 miles at this time.

In plotting the proposed location of the well, you must show:

- 1) The manner in which you are using the depicted plat by identifying section lines, i.e. 1 section, 1 section with 8 surrounding partial sections, 4 sections, 16 sections, etc.;
- 2) the well's location relative to the location of other wells producing from the same common source or supply in adjoining drilling units, pursuant to K.A.R. 82-3-108, 82-3-207, 82-3-312, or special orders of the Commission;
- 3) the distance of the proposed drilling location from the section's east and south lines; and
- 4) the distance to the nearest lease or unit boundary line.

I hereby certify that the statements made herein are true and to the best of my knowledge and belief.

Signature of Operator or Agent [Signature]

Date November 5, 1990 Title President, Jeffrey R. Wood