

FORM MUST BE TYPED

State of Kansas

FORM MUST BE SIGNED

FORM C-1 4/90

EFFECTIVE DATE: 11-11-90

NOTICE OF INTENTION TO DRILL

ALL BLANKS MUST BE FILLED

Must be approved by the K.C.C. five (5) days prior to commencing well

Expected Spud Date * 12-7-90 month day year

* C NW SE Sec 30 Twp 9 S, Rg 32W X East West

OPERATOR: License # 30407 Name: Black Petroleum Company Address: P.O. Box 12922 City/State/Zip: Wichita, Kansas 67212 Contact Person: Thomas E. Black Phone: 316-942-2741

* 1980 feet from South line of Section * 1980 feet from East line of Section (Note: Locate well on Section Plat on Reverse Side)

CONTRACTOR: License #: 5302 Name: Red Tiger Drilling Co.

County: Thomas Lease Name: Steinle Farms Well #: 1 Field Name: Wildcat Is this a Prorated Field? yes X no Target Formation(s): Mississippi Nearest lease or unit boundary: 660' Ground Surface Elevation: 3126 feet MSL Domestic well within 330 feet: yes X no Municipal well within one mile: yes X no Depth to bottom of fresh water: 250 Depth to bottom of usable water: 2000 Surface Pipe by Alternate: 1 X 2 Length of Surface Pipe Planned to be set: 350' Length of Conductor pipe required: 0 Projected Total Depth: 4700' Formation at Total Depth: Mississippi Water Source for Drilling Operations: unknown well farm pond other DWR Permit #: Will Cores Be Taken?: yes X no If yes, proposed zone:

Well Drilled For: Well Class: Type Equipment:

X Oil Inj Infield X Mud Rotary Gas Storage Pool Ext Air Rotary OWWO Disposal X Wildcat Cable Seismic; # of Holes

If OWWO: old well information as follows:

Operator: Well Name: Comp. Date: Old Total Depth

Directional, Deviated or Horizontal wellbore? yes X no

If yes, total depth location:

* Items corrected

AFFIDAVIT

IS: C NW SE; 1980 FSL; 1980 FEL

WAS: NW NW SE; 2310 FSL; 2310 FEL

The undersigned hereby affirms that the drilling, completion and eventual plugging of this well will comply with K.S.A. 55-101, et. seq.

It is agreed that the following minimum requirements will be met:

- 1. The appropriate district office shall be notified before setting surface pipe;
2. The minimum amount of surface pipe as specified above shall be set by circulating cement to the top; in all cases surface pipe shall be set through all unconsolidated materials plus a minimum of 20 feet into the underlying formation;
3. If the well is dry, a plugging proposal shall be submitted to the district office. An agreement between the operator and the district office on plug length and placement is necessary prior to plugging;
4. The appropriate district office will be notified before well is either plugged or production casing is cemented in;
5. If an Alternate II completion, production pipe shall be cemented from below any usable water to surface within 120 days of spud date. In all cases, notify district office prior to any cementing.

I hereby certify that the statements made herein are true and to the best of my knowledge and belief.

Date: 11-26-90 Signature of Operator or Agent: Thomas E. Black Title: President

FOR KCC USE: API # 15- 193-20,530-00-00 Conductor pipe required None feet Minimum surface pipe required 350 feet per Alt. (2) Approved by: maw 10-3-90; sig 11-6-90 EFFECTIVE DATE: 11-11-90 This authorization expires: 5-6-91 (This authorization void if drilling not started within 6 months of effective date.) Spud date: Agent:

RECEIVED STATE CORPORATION COMMISSION

NOV 27 1990 11-27-1990 CONSERVATION DIVISION Wichita, Kansas

REMEMBER TO:

- File Drill Pit Application (form CDP-1) with Intent to Drill;
- File Completion Form ACO-1 within 120 days of spud date;
- File acreage attribution plat according to field proration orders;
- Notify appropriate district office 48 hours prior to workover or re-entry;
- Submit plugging report (CP-4) after plugging is completed;
- Obtain written approval before disposing or injecting salt water.

RECEIVED DATE 11/1/90

PLAT OF ACREAGE ATTRIBUTABLE TO A WELL

State Corporation Commission, Conservation Division
200 Colorado Derby Bldg. Wichita, Kansas 67202

OPERATOR Black Petroleum Co. LOCATION OF WELL:
 LEASE Steinle Farms 1980' feet north of SE corner
 WELL NUMBER 1 1980' feet west of SE corner
 FIELD Wildcat C NW SE Sec. 30 T 9s R 32 E/W
 COUNTY Thomas

NO. OF ACRES ATTRIBUTABLE TO WELL 20-40 IS SECTION XX REGULAR IRREGULAR?
 IF IRREGULAR, LOCATE WELL FROM NEAREST
 DESCRIPTION OF ACREAGE SE/4 CORNER BOUNDARY.

NOTE: If plat depicted is insufficient for your circumstances, you may attach your own scaled or surveyed plat.

PLAT
32 W

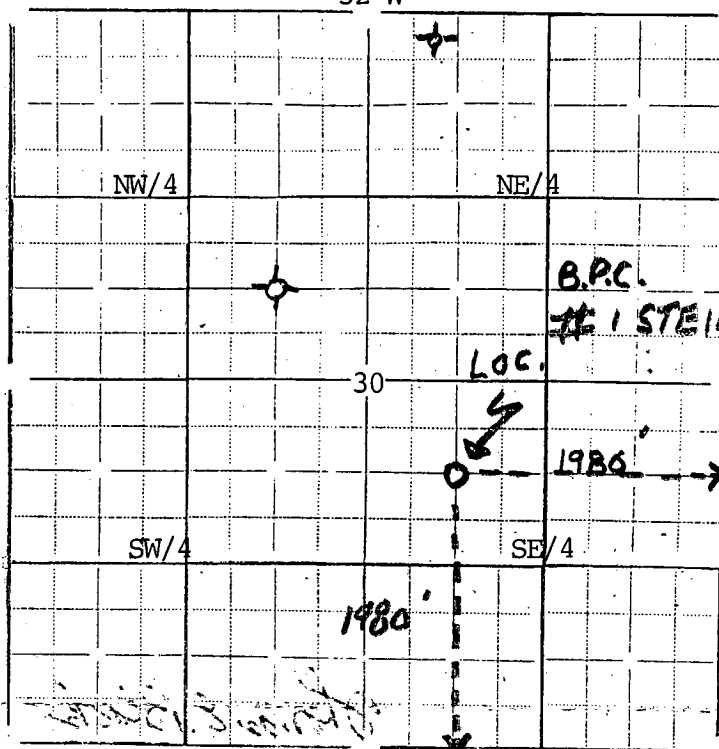

In plotting the proposed location of the well, you must show:

- 1) The manner in which you are using the depicted plat by identifying section lines, i.e. 1 section, 1 section with 8 surrounding partial sections, 4 sections, 16 sections, etc.;
- 2) the well's location relative to the location of other wells producing from the same common source of supply in adjoining drilling units; pursuant to K.A.R. 82-3-108, 82-3-207, 82-3-312, or special orders of the Commission;
- 3) the distance of the proposed drilling location from the section's east and south lines; and
- 4) the distance to the nearest lease or unit boundary line.

I hereby certify that the statements made herein are true and to the best of my knowledge and belief.

Signature of Operator or Agent Thomas E. Black

Date 4/26/90 Title Pres. B.P.C.