

EFFECTIVE DATE: 4-10-94

DISTRICT # 4  
SGA? Yes No

State of Kansas  
NOTICE OF INTENTION TO DRILL

Must be approved by the K.C.C. five (5) days prior to commencing well

Expected Spud Date 4 5 94  
month day year

Spot NE SE SE Sec 36 Twp 9 S Rg 32 X East West

OPERATOR: License # 30407  
Name: Black Petroleum Company  
Address: P. O. Box 12922  
City/State/Zip: Wichita, KS 67277  
Contact Person: Thomas E. Black  
Phone: (316) 942-2741

990 feet from South ~~MARK~~ line of Section  
330 feet from East ~~MARK~~ line of Section  
IS SECTION X REGULAR IRREGULAR?

CONTRACTOR: License #: 5420  
Name: White & Ellis Drilling, Inc.

(NOTE: Locate well on the Section Plat on Reverse Side)  
County: Thomas  
Lease Name: Nye Well #: 2  
Field Name:

Well Drilled For: Well Class: Type Equipment:  
X Oil ... Enh Rec X Infield X Mud Rotary  
... Gas ... Storage ... Pool Ext. ... Air Rotary  
... OWWO ... Disposal ... Wildcat ... Cable  
... Seismic; ... # of Holes ... Other  
If OWWO: old well information as follows:

Is this a Prorated/Spaced Field? ... yes X.. no  
Target Formation(s): Mississippi  
Nearest Lease or unit boundary: 330'  
Ground Surface Elevation: est. 3076' feet MSL

Operator:  
Well Name:  
Comp. Date: Old Total Depth

Water well within one-quarter mile: ... yes X.. no  
Public water supply well within one mile: ... yes X.. no  
Depth to bottom of fresh water: 230' 250'  
Depth to bottom of usable water: 1550'

Directional, Deviated or Horizontal wellbore? ... yes X. no  
If yes, true vertical depth:  
Bottom Hole Location:

Surface Pipe by Alternate: ... 1 X 2  
Length of Surface Pipe Planned to be set: 300' +  
Length of Conductor pipe required: none  
Projected Total Depth: 4725'

Formation at Total Depth: Mississippi  
Water Source for Drilling Operations:  
X well ... farm pond ... other

AFFIDAVIT

The undersigned hereby affirms that the drilling, completion and eventual plugging of this well will comply with K.S.A. 55-101, et. seq.  
It is agreed that the following minimum requirements will be met:

RECEIVED  
STATE CORPORATION COMMISSION  
APR 05 1994  
04-05-1994  
Wichita, Kansas  
CONSERVATION DIVISION

- 1. Notify the appropriate district office prior to spudding of well;
- 2. A copy of the approved notice of intent to drill shall be posted on each drilling rig;
- 3. The minimum amount of surface pipe as specified below shall be set by circulating cement the well to the target formation; surface pipe shall be set through all unconsolidated materials plus a minimum of 20 feet into the underlying formation;
- 4. If the well is dry hole, an agreement between the operator and the district office on plug length and placement is necessary prior to plugging;
- 5. The appropriate district office will be notified before well is either plugged or production casing is cemented in;
- 6. IF AN ALTERNATE II COMPLETION, PRODUCTION PIPE SHALL BE CEMENTED FROM BELOW ANY USABLE WATER TO SURFACE WITHIN 120 DAYS OF SPUD DATE. IN ALL CASES, NOTIFY DISTRICT OFFICE PRIOR TO ANY CEMENTING.

I hereby certify that the statements made herein are true and to the best of my knowledge and belief.  
Date: 3-30-94 Signature of Operator or Agent: Michael L. Considine Title: Sec.-Treas. for White & Ellis Drlg.

FOR KCC USE:  
API # 15- 193-20622-00-00  
Conductor pipe required NONE feet  
Minimum surface pipe required 300 feet per Alt. X 2  
Approved by: CB 4-5-94  
This authorization expires: 10-5-94  
(This authorization void if drilling not started within 6 months of effective date.)  
Spud date: Agent:

REMEMBER TO:

- File Drill Pit Application (form CDP-1) with Intent to Drill;
- File Completion Form ACO-1 within 120 days of spud date;
- File acreage attribution plat according to field proration orders;
- Notify appropriate district office 48 hours prior to workover or re-entry;
- Submit plugging report (CP-4) after plugging is completed;
- Obtain written approval before disposing or injecting salt water.

Mail to: Conservation Division, 200 Colorado Derby Building, 202 W. First St., Wichita, Kansas 67202-1286.

36  
9  
32

IN ALL CASES PLOT THE INTENDED WELL ON THE PLAT BELOW

**PLAT OF ACREAGE ATTRIBUTABLE TO A WELL IN A PRORATED OR SPACED FIELD**

If the intended well is in a prorated or spaced field, please fully complete this side of the form. If the intended well is in a prorated or spaced field complete the plat below showing that the well will be properly located in relationship to other wells producing from the common source of supply. Please show all the wells within 1 mile of the boundaries of the proposed acreage attribution unit for gas wells and within 1/2 mile of the boundaries of the proposed acreage attribution unit for oil wells.

API NO. 15- \_\_\_\_\_  
 OPERATOR Black Petroleum Company  
 LEASE Nye  
 WELL NUMBER #2  
 FIELD \_\_\_\_\_

LOCATION OF WELL: COUNTY Thomas  
990 feet from south/~~north~~ line of section  
330 feet from east/~~west~~ line of section  
 SECTION 36 TWP 9S RG 32W

NUMBER OF ACRES ATTRIBUTABLE TO WELL \_\_\_\_\_  
 QTR/QTR/QTR OF ACREAGE NE - SE - SE

IS SECTION X REGULAR or \_\_\_\_\_ IRREGULAR  
IF SECTION IS IRREGULAR, LOCATE WELL FROM NEAREST CORNER BOUNDARY.

Section corner used: \_\_\_\_\_ NE \_\_\_\_\_ NW X SE \_\_\_\_\_ SW

**PLAT**

(Show location of the well and shade attributable acreage for prorated or spaced wells.)  
 (Show footage to the nearest lease or unit boundary line.)

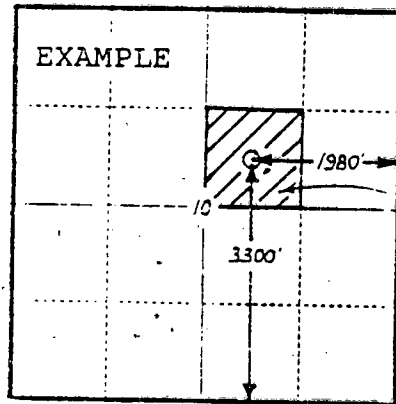
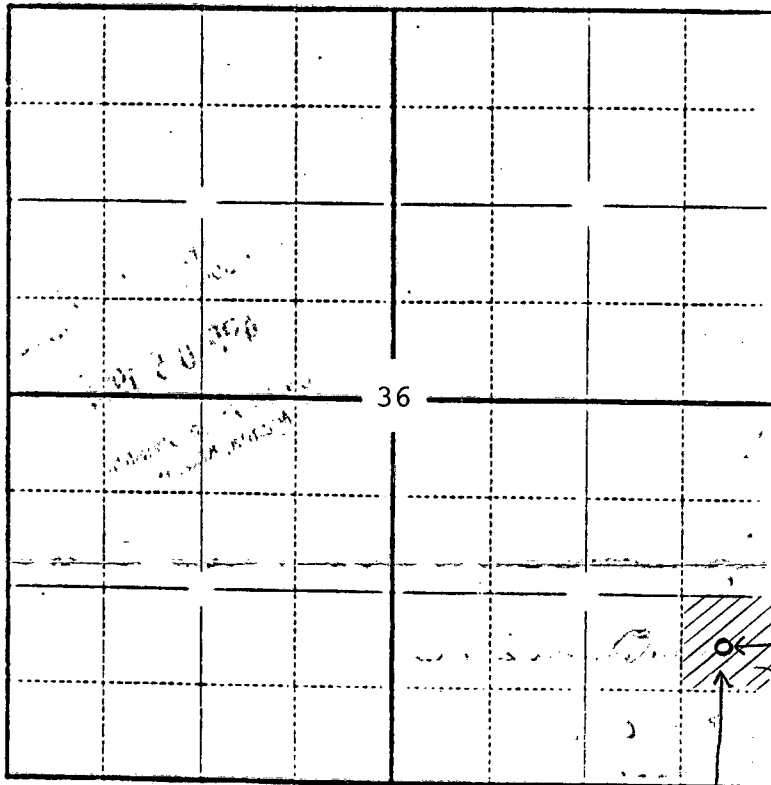

SEWARD CO.

40 ACRES

330' feet

40 acres

990' feet

In plotting the proposed location of the well, you must show:

- 1) The manner in which you are using the depicted plat by identifying section lines, i.e. 1 section, 1 section with 8 surrounding sections, 4 sections, etc.;
- 2) the distance of the proposed drilling location from the section's south/north and east/west lines; and
- 3) the distance to the nearest lease or unit boundary line.