

EFFECTIVE DATE: 6-23-91 State of Kansas

NOTICE OF INTENTION TO DRILL

Must be approved by the K.C.C. five (5) days prior to commencing well

Expected Spud Date 6 month 24 day 91 year

NW SW SW Sec 25 Twp 9 S, Rg 26 East West

OPERATOR: License # 5135
Name: John O. Farmer, Inc.
Address: P.O. Box 352
City/State/Zip: Russell, KS 67665
Contact Person: Sam Farmer
Phone: (913) 483-3144

990 feet from South line of Section
4950 feet from East line of Section
(Note: Locate well on Section Plat on Reverse Side)

CONTRACTOR: License #: 8241
Name: Emphasis Oil Operations

County: Sheridan
Lease Name: Transue Well #: 1
Field Name: (wildcat)
Is this a Prorated Field? yes no
Target Formation(s): Lansing
Nearest lease or unit boundary: 330'
Ground Surface Elevation: 2620 est. feet MSU
Domestic well within 330 feet: yes no
Municipal well within one mile: yes no
Depth to bottom of fresh water: 175'
Depth to bottom of usable water: 1320'
Surface Pipe by Alternate: 1 2
Length of Surface Pipe Planned to be set: 200'
Length of Conductor pipe required: none
Projected Total Depth: 4100'
Formation at Total Depth: Base/Kansas City
Water Source for Drilling Operations:
well farm pond other
DWR Permit #: _____
Will Cores Be Taken?: yes no
If yes, proposed zone: _____

Well Drilled For: Well Class: Type Equipment:
 Oil Inj Infield Mud Rotary
 Gas Storage Pool Ext. Air Rotary
 OWWO Disposal Wildcat Cable
 Seismic; # of Holes

If OWWO: old well information as follows:
Operator: _____
Well Name: _____
Comp. Date: _____ Old Total Depth _____

Directional, Deviated or Horizontal wellbore? yes no
If yes, total depth location: _____

AFFIDAVIT

The undersigned hereby affirms that the drilling, completion and eventual plugging of this well will comply with K.S.A. 55-101, et. seq.

It is agreed that the following minimum requirements will be met:

1. The appropriate district office shall be notified before setting surface pipe;
2. The minimum amount of surface pipe as specified above shall be set by circulating cement to the top; in all cases surface pipe shall be set through all unconsolidated materials plus a minimum of 20 feet into the underlying formation;
3. If the well is dry, a plugging proposal shall be submitted to the district office. An agreement between the operator and the district office on plug length and placement is necessary prior to plugging;
4. The appropriate district office will be notified before well is either plugged or production casing is cemented in;
5. If an Alternate II completion, production pipe shall be cemented from below any usable water to surface within 120 days of spud date. In all cases, notify district office prior to any cementing.

I hereby certify that the statements made herein are true and to the best of my knowledge and belief.

Date: 6-17-91 Signature of Operator or Agent: John O. Farmer III Title: President

FOR KCC USE:
API # 15- 179-21,012-00-00
Conductor pipe required None feet
Minimum surface pipe required 200 feet per Alt. **(2)**
Approved by: MAN 6-18-91
EFFECTIVE DATE: 6-23-91
This authorization expires: 12-18-91
(This authorization void if drilling not started within 6 months of effective date.)
Spud date: _____ Agent: _____

RECEIVED
STATE CORPORATION COMMISSION
06-18-1991
JUN 18 1991
CONSERVATION DIVISION
Wichita, Kansas

REMEMBER TO:

- File Drill Pit Application (form CDP-1) with Intent to Drill;
- File Completion Form ACO-1 within 120 days of spud date;
- File acreage attribution plat according to field proration orders;
- Notify appropriate district office 48 hours prior to workover or re-entry;
- Submit plugging report (CP-4) after plugging is completed;
- Obtain written approval before disposing or injecting salt water.

259262

PLAT OF ACREAGE ATTRIBUTABLE TO A WELL

State Corporation Commission, Conservation Division
200 Colorado Derby Bldg. Wichita, Kansas 67202

OPERATOR John O. Farmer, Inc. LOCATION OF WELL:
 LEASE Transue 990 feet north of SE corner
 WELL NUMBER #1 4950 feet west of SE corner
 FIELD (wildcat) NW SW SW Sec. 25 T. 9S R. 26 ~~XX~~W
 COUNTY Sheridan
 NO. OF ACRES ATTRIBUTABLE TO WELL 160 IS SECTION X REGULAR IRREGULAR?
 DESCRIPTION OF ACREAGE SW/4 IF IRREGULAR, LOCATE WELL FROM NEAREST
 CORNER BOUNDARY.

NOTE: If plat depicted is insufficient for your circumstances, you may attach your own scaled or surveyed plat.

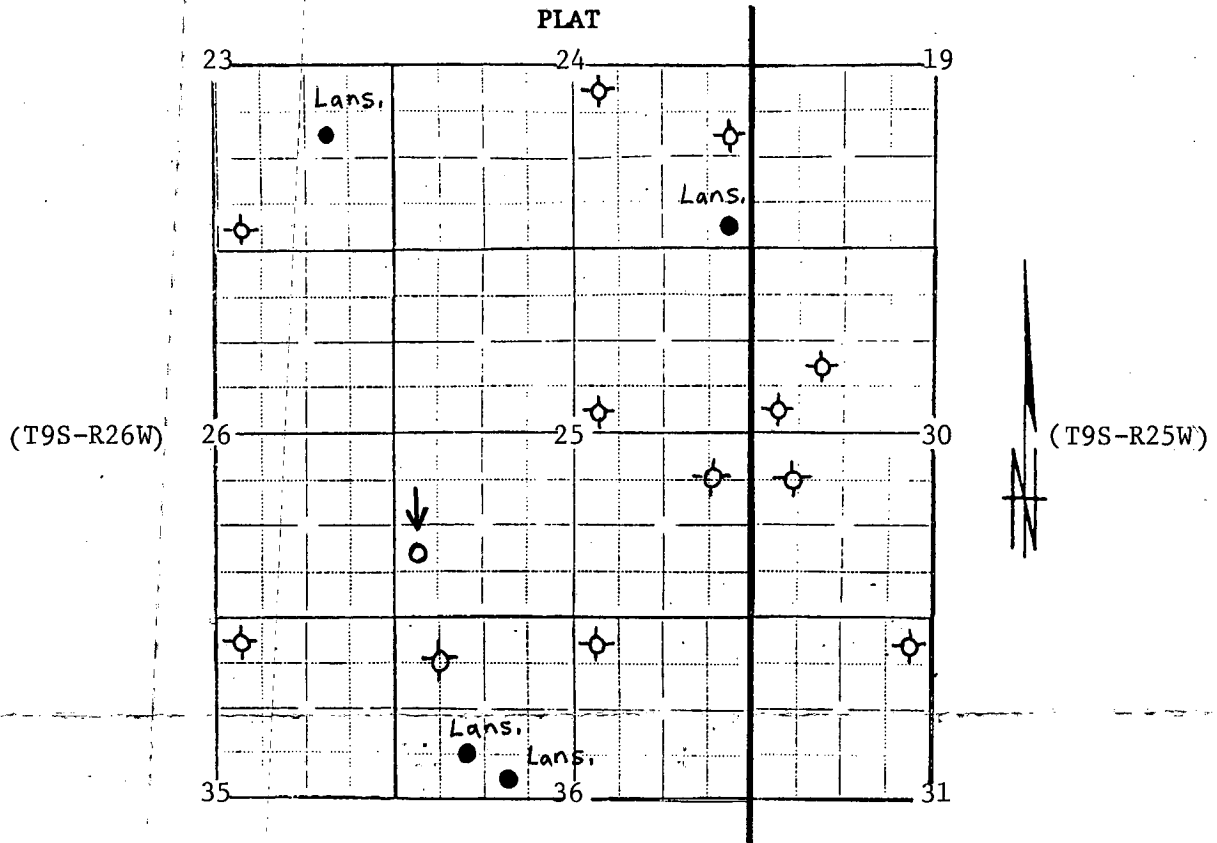

In plotting the proposed location of the well, you must show:

- 1) The manner in which you are using the depicted plat by identifying section lines, i.e. 1 section, 1 section with 8 surrounding partial sections, 4 sections, 16 sections, etc.;
- 2) the well's location relative to the location of other wells producing from the same common source of supply in adjoining drilling units, pursuant to K.A.R. 82-3-108, 82-3-207, 82-3-312, or special orders of the Commission;
- 3) the distance of the proposed drilling location from the section's east and south lines; and
- 4) the distance to the nearest lease or unit boundary line.

I hereby certify that the statements made herein are true and to the best of my knowledge and belief.

Signature of Operator or Agent John O. Farmer III
 Date 6-17-91 title President