

FOR KCC USE:

FORM C-1 7/91

EFFECTIVE DATE: 3-1-95

FORM MUST BE TYPED

DISTRICT # 4

State of Kansas
NOTICE OF INTENTION TO DRILL

FORM MUST BE SIGNED

SSA? Yes No

ALL BLANKS MUST BE FILLED

Must be approved by the K.C.C. five (5) days prior to commencing well

Spot 26 East
NE NE SE Sec 28 Twp 09 S, Rg 28 West

Expected Spud Date MARCH 15 1995
month day year

2310 feet from South / North line of Section
330 feet from East / West line of Section

OPERATOR: License # 6040
Name: BANKOFF OIL COMPANY
Address: P.O. BOX 16418
City/State/Zip: WICHITA, KS 67216
Contact Person: J.E. JESPERSEN
Phone: 316-262-2784

IS SECTION REGULAR IRREGULAR?
(NOTE: Locate well on the Section Plat on Reverse Side)

County: SHERIDAN
Lease Name: BREEDEN Well #: 1
Field Name: WILDCAT

CONTRACTOR: License #: 5420
Name: WHITE & ELLIS DRILLING, INC.

Is this a Prorated/Spaced Field? yes no XXXX
Target Formation(s): LANSING-KANSAS CITY

Nearest lease or unit boundary: 330 ft
Ground Surface Elevation: est. 2640 feet MSL

Well Drilled For: Well Class: Type Equipment:

Oil ... Enh Rec ... Infield Mud Rotary
 Gas ... Storage ... Pool Ext. ... Air Rotary
 OWWO ... Disposal Wildcat ... Cable
 Seismic; ... # of Holes ... Other

Water well within one-quarter mile: yes no

Public water supply well within one mile: yes no

Depth to bottom of fresh water: 150 ft.

Depth to bottom of usable water: 1350 ft.

Surface Pipe by Alternate: 1 2

Length of Surface Pipe Planned to be set: 200 ft.

Length of Conductor pipe required: N/A

Projected Total Depth: 4000 ft.

Formation at Total Depth: BASE KANSAS CITY

Water Source for Drilling Operations:

... well ... farm pond other

DWR Permit #:

Will Cores Be Taken?: yes no

If yes, proposed zone:

Directional, Deviated or Horizontal wellbore? yes no

If yes, true vertical depth:

Bottom Hole Location:

AFFIDAVIT

The undersigned hereby affirms that the drilling, completion and eventual plugging of this well will comply with K.S.A. 55-101, et. seq.

It is agreed that the following minimum requirements will be met:

1. Notify the appropriate district office prior to spudding of well;
2. A copy of the approved notice of intent to drill shall be posted on each drilling rig;
3. The minimum amount of surface pipe as specified below shall be set by circulating cement to the top; in all cases surface pipe shall be set through all unconsolidated materials plus a minimum of 20 feet into the underlying formation;
4. If the well is dry hole, an agreement between the operator and the district office on plug length and placement is necessary prior to plugging;
5. The appropriate district office will be notified before well is either plugged or production casing is cemented in;
6. IF AN ALTERNATE II COMPLETION, PRODUCTION PIPE SHALL BE CEMENTED FROM BELOW ANY USABLE WATER TO SURFACE WITHIN 120 DAYS OF SPUD DATE. IN ALL CASES, NOTIFY DISTRICT OFFICE PRIOR TO ANY CEMENTING.

I hereby certify that the statements made herein are true and to the best of my knowledge and belief.

Date: FEBR. 21, 1995 Signature of Operator or Agent: [Signature] Title: GEOLOGIST

FOR KCC USE:
 API # 15- 179-21074 0000
 Conductor pipe required NONE feet
 Minimum surface pipe required 200 feet per Alt.
 Approved by: DPW 2-24-95
 This authorization expires: 8-24-95
 (This authorization void if drilling not started within 6 months of effective date.)
 Spud date: _____ Agent: _____

REMEMBER TO:

- File Drill Pit Application (form CDP-1) with Intent to Drill;
- File Completion Form ACO-1 within 120 days of spud date;
- File acreage attribution plat according to field proration orders;
- Notify appropriate district office 48 hours prior to workover or re-entry;
- Submit plugging report (CP-4) after plugging is completed;
- Obtain written approval before disposing or injecting salt water.

Mail to: Conservation Division, 200 Colorado Derby Building, 202 W. First St., Wichita, Kansas 67202-1286.

STATE CORPORATION COMMISSION
RECEIVED
FEB 22 1995
CONSERVATION DIVISION
WICHITA, KANSAS

28
9
26W

IN ALL CASES PLOT THE INTENDED WELL ON THE PLAT BELOW
PLAT OF ACREAGE ATTRIBUTABLE TO A WELL IN A PRORATED OR SPACED FIELD

If the intended well is in a prorated or spaced field, please fully complete this side of the form. If the intended well is in a prorated or spaced field complete the plat below showing that the well will be properly located in relationship to other wells producing from the common source of supply. Please show all the wells within 1 mile of the boundaries of the proposed acreage attribution unit for gas wells and within 1/2 mile of the boundaries of the proposed acreage attribution unit for oil wells.

API NO. 15- _____
 OPERATOR BANKOFF OIL COMPANY LOCATION OF WELL: COUNTY SHERIDAN
 LEASE BREEDEN 2310 feet from south/~~XXXX~~ line of section
 WELL NUMBER 1 330 feet from east/~~XXXX~~ line of section
 FIELD WILDCAT SECTION 28 TWP 09 RG 26 W

NUMBER OF ACRES ATTRIBUTABLE TO WELL 10 IS SECTION XXX REGULAR or IRREGULAR
 QTR/QTR/QTR OF ACREAGE NE/4 NE/4 SE/4 **IF SECTION IS IRREGULAR, LOCATE WELL FROM NEAREST CORNER BOUNDARY.**

Section corner used: NE NW XXSE SW
PLAT

(Show location of the well and shade attributable acreage for prorated or spaced wells.)
 (Show footage to the nearest lease or unit boundary line.)

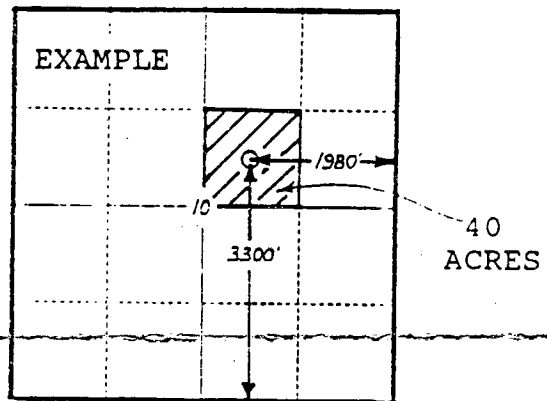
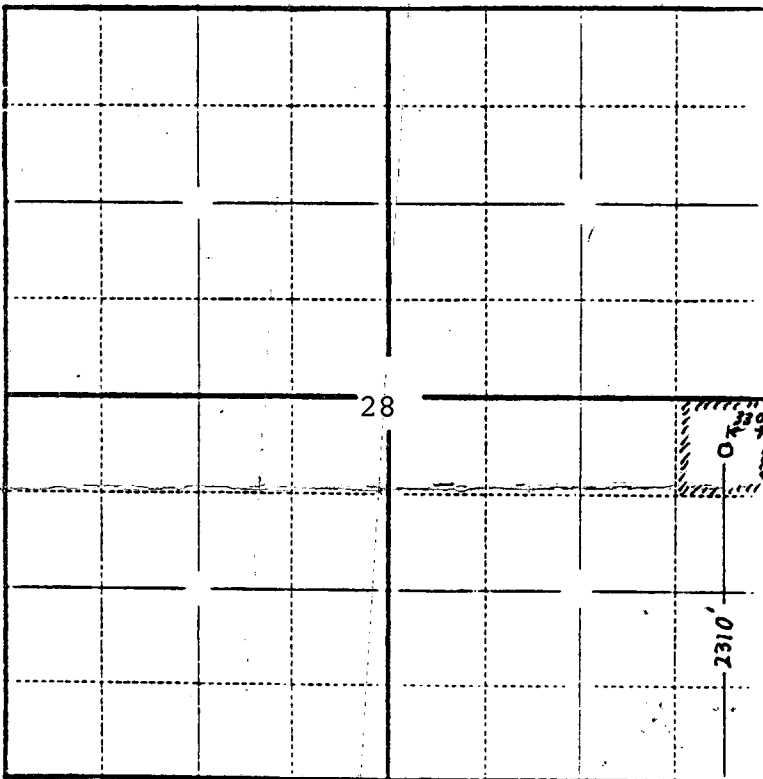

16 ACRES

In plotting the proposed location of the well, you must show:

- 1) The manner in which you are using the depicted plat by identifying section lines, i.e. 1 section, 1 section with 8 surrounding sections, 4 sections, etc.;
- 2) the distance of the proposed drilling location from the section's south/north and east/west lines; and
- 3) the distance to the nearest lease or unit boundary line.