

FOR KCC USE:

FORM C-1 7/91

FORM MUST BE TYPED

FORM MUST BE SIGNED

ALL BLANKS MUST BE FILLED

EFFECTIVE DATE: 5-23-92

State of Kansas

DISTRICT # 4

NOTICE OF INTENTION TO DRILL

SEA? Yes No

Must be approved by the K.C.C. five (5) days prior to commencing well

Expected Spud Date May 20, 1992 month day year

Spot SE SE NE Sec 23 Twp 9 S, Rg 27 East West

OPERATOR: License # 03655 STAAB ENERGY & LEASING Name: 2514 Haney Drive Address: Hays, Kansas 67601 Contact Person: Norman G. Staab Phone: 913-628-1326

2310 feet from XXXX / North line of Section 330 feet from East / XXXX line of Section

IS SECTION X REGULAR IRREGULAR?

(NOTE: Locate well on the Section Plat on Reverse Side)

County: Sheridan Lease Name: Dean Richards Well #: 1 Field Name: Unknown

CONTRACTOR: License #: 5665 5655 Name: Shields Drilling Co., Inc.

Is this a Prorated/Spaced Field? yes X no Target Formation(s): Lansing-Kansas City Nearest lease or unit boundary: 330' Ground Surface Elevation: Later feet MSL

Well Drilled For: Well Class: Type Equipment: X Oil Enh Rec Infield X Mud Rotary Gas Storage Pool Ext. Air Rotary DWVO Disposal X Wildcat Cable Seismic: # of Holes Other

Water well within one-quarter mile: X yes no Public water supply well within one mile: yes X no Depth to bottom of fresh water: 125' Depth to bottom of usable water: 1450' Surface Pipe by Alternate: 1 X 2 Length of Surface Pipe Planned to be set: 200' Length of Conductor pipe required: N/A Projected Total Depth: 4100' Formation at Total Depth: Mississippi Water Source for Drilling Operations: X well farm pond other

If DWVO: old well information as follows: Operator: Well Name: Comp. Date: Old Total Depth

DWR Permit #: Will Cores Be Taken?: yes X no If yes, proposed zone:

Directional, Deviated or Horizontal wellbore? yes X no If yes, true vertical depth: Bottom Hole Location:

AFFIDAVIT

The undersigned hereby affirms that the drilling, completion and eventual plugging of this well will comply with K.S.A. 55-101, et. seq.

It is agreed that the following minimum requirements will be met:

- 1. Notify the appropriate district office prior to spudding of well; 2. A copy of the approved notice of intent to drill shall be posted on each drilling rig; 3. The minimum amount of surface pipe as specified below shall be set by circulating cement to the top; in all cases surface pipe shall be set through all unconsolidated materials plus a minimum of 20 feet into the underlying formation; 4. If the well is dry hole, an agreement between the operator and the district office on plug length and placement is necessary prior to plugging; 5. The appropriate district office will be notified before well is either plugged or production casing is cemented in; 6. IF AN ALTERNATE II COMPLETION, PRODUCTION PIPE SHALL BE CEMENTED FROM BELOW ANY USABLE WATER TO SURFACE WITHIN 120 DAYS OF SPUD DATE. IN ALL CASES, NOTIFY DISTRICT OFFICE PRIOR TO ANY CEMENTING.

I hereby certify that the statements made herein are true and to the best of my knowledge and belief.

Date: May 16, 1992 Signature of Operator or Agent: Title: Owner

FOR KCC USE: API # 15-179-21038-00-00 Conductor pipe required NONE feet Minimum surface pipe required 200 feet per Alt. X(2) Approved by: DA 5-18-92 This authorization expires: 11-18-92 (This authorization void if drilling not started within 6 months of effective date.) Spud date: Agent:

REMEMBER TO:

- File Drill Pit Application (form CDP-1) with Intent to Drill; - File Completion Form ACO-1 within 120 days of spud date; - File acreage attribution plat according to field preparation orders; - Notify appropriate district office 48 hours prior to workover or re-entry; - Submit plugging report (CP-4) after plugging is completed; - Obtain written approval before disposing or injecting salt water.

Mail to: Conservation Division, 200 Colorado Derby Building, 202 W. First St., Wichita, Kansas 67202

RECEIVED CONSERVATION COMMISSION MAY 18 1992 05-18-1992 WICHITA, KANSAS

**IN ALL CASES PLOT THE INTENDED WELL ON THE PLAT BELOW**

**PLAT OF ACREAGE ATTRIBUTABLE TO A WELL IN A PRORATED OR SPACED FIELD**

**If the intended well is in a prorated or spaced field, please fully complete this side of the form.** If the intended well is in a prorated or spaced field complete the plat below showing that the well will be properly located in relationship to other wells producing from the common source of supply. Please show all the wells within 1 mile of the boundaries of the proposed acreage attribution unit for gas wells and within 1/2 mile of the boundaries of the proposed acreage attribution unit for oil wells.

API NO. 15- \_\_\_\_\_  
 OPERATOR STAAB ENERGY & LEASING LOCATION OF WELL: COUNTY Sheridan  
 LEASE DEAN RICHARDS 2310 feet from ~~south~~/north line of section  
 WELL NUMBER 1 330 feet from east/~~west~~ line of section  
 FIELD Unknown SECTION 23 TWP 9s RG 27w

NUMBER OF ACRES ATTRIBUTABLE TO WELL 160 IS SECTION X REGULAR or \_\_\_\_\_ IRREGULAR  
 QTR/QTR/QTR OF ACREAGE SE - SE - NE **IF SECTION IS IRREGULAR, LOCATE WELL FROM NEAREST CORNER BOUNDARY.**

Section corner used: X NE \_\_\_\_\_ NW \_\_\_\_\_ SE \_\_\_\_\_ SW

**PLAT**

(Show location of the well and shade attributable acreage for prorated or spaced wells.)  
 (Show footage to the nearest lease or unit boundary line.)

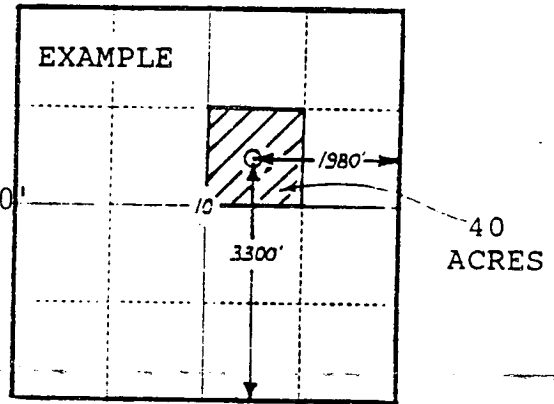
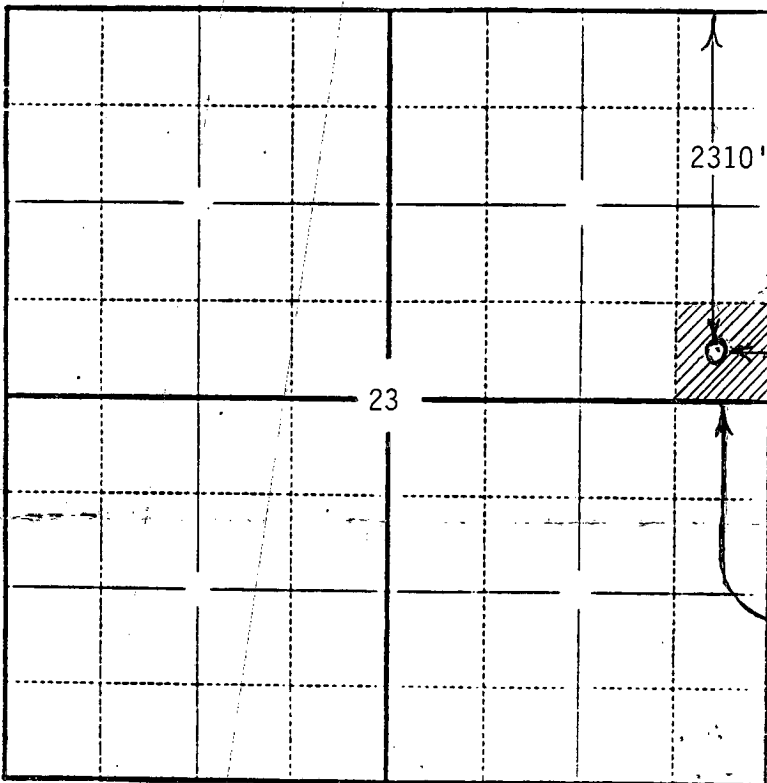

SEWARD CO.

10 Acres

SHERIDAN CO.

**In plotting the proposed location of the well, you must show:**

- 1) The manner in which you are using the depicted plat by identifying section lines, i.e. 1 section, 1 section with 8 surrounding sections, 4 sections, etc.;
- 2) the distance of the proposed drilling location from the section's south/north and east/west lines; and
- 3) the distance to the nearest lease or unit boundary line.