

FOR KCC USE:

FORM C-1 7/91

FORM MUST BE TYPED

EFFECTIVE DATE: 8-30-92

FORM MUST BE SIGNED

DISTRICT # 4

State of Kansas
NOTICE OF INTENTION TO DRILL

ALL BLANKS MUST BE FILLED

SEA? Yes X No

Must be approved by the K.C.C. five (5) days prior to commencing well

Expected Spud Date September 10, 1992
month day year

Spot SW SE NW Sec 14 Twp 9 S Rg 27 East West

OPERATOR: License # 03655
Name: STAAB ENERGY & LEASING
Address: 2514 Haney Drive
City/State/Zip: Hays, Kansas 67601
Contact Person: Norman G. Staab
Phone: 913-628-1326

2970 feet from South X North line of Section
3630 feet from East X West line of Section
IS SECTION XX REGULAR IRREGULAR

CONTRACTOR: License #: 5665
Name: Shields Drilling Co., Inc.

(NOTE: Locate well on the Section Plat on Reverse Side)
County: Sheridan
Lease Name: Popp Well #: 1
Field Name: Wildcat

Well Drilled For: Well Class: Type Equipment:
Oil Enh Rec Infield Mud Rotary
Gas Storage Pool Ext Air Rotary
OWWO Disposal Wildcat Cable
Seismic: # of Holes Other

Is this a Prorated/Spaced Field? yes X no
Target Formation(s): Lansing - Kansas City
Nearest lease or unit boundary: 1650'
Ground Surface Elevation: Later feet MSL
Water well within one-quarter mile: X yes no
Public water supply well within one mile: yes X no
Depth to bottom of fresh water: 125' 185'
Depth to bottom of usable water: 1450'
Surface Pipe by Alternate: 1 X 2 235'
Length of Surface Pipe Planned to be set: 200' 235'
Length of Conductor pipe required: N/A
Projected Total Depth: 4100'
Formation at Total Depth: Lansing - Kansas City
Water Source for Drilling Operations:
X well farm pond other

If OWWO: old well information as follows:
Operator:
Well Name:
Comp. Date: Old Total Depth

DWR Permit #:
Will Cores Be Taken? yes no
If yes, proposed zone:

Directional, Deviated or Horizontal wellbore? yes X no
If yes, true vertical depth:
Bottom Hole Location:

AFFIDAVIT

The undersigned hereby affirms that the drilling, completion and eventual plugging of this well will comply with K.S.A. 55-101, et. seq.
It is agreed that the following minimum requirements will be met:

- 1. Notify the appropriate district office prior to spudding of well;
- 2. A copy of the approved notice of intent to drill shall be posted on each drilling rig;
- 3. The minimum amount of surface pipe as specified below shall be set by circulating cement to the top; in all cases surface pipe shall be set through all unconsolidated materials plus a minimum of 20 feet into the underlying formation;
- 4. If the well is dry hole, an agreement between the operator and the district office on plug length and placement is necessary prior to plugging;
- 5. The appropriate district office will be notified before well is either plugged or production casing is cemented in;
- 6. IF AN ALTERNATE II COMPLETION, PRODUCTION PIPE SHALL BE CEMENTED FROM BELOW ANY USABLE WATER TO SURFACE WITHIN 120 DAYS OF SPUD DATE. IN ALL CASES, NOTIFY DISTRICT OFFICE PRIOR TO ANY CEMENTING.

I hereby certify that the statements made herein are true and to the best of my knowledge and belief.

Date: August 24, 1992 Signature of Operator or Agent: Norman G. Staab Title: Owner

FOR KCC USE:
API # 15- 179-21046-00-00
Conductor pipe required None feet
Minimum surface pipe required 235 feet per Alt. X
Approved by: TB 8-25-92
This authorization expires: 2-25-93
(This authorization void if drilling not started within 6 months of effective date.)
Spud date: Agent:

REMEMBER TO:

- File Drill Pit Application (form CDP-1) with Intent to Drill;
- File Completion Form ACD-1 within 120 days of spud date;
- File acreage attribution plat according to field proration orders;
- Notify appropriate district office 48 hours prior to workover or re-entry;
- Submit plugging report (CP-4) after plugging is completed;
- Obtain written approval before disposing or injecting salt water.

Mail to: Conservation Division, 200 Colorado Derby Building, 202 W. First St., Wichita, Kansas 67202-1286.

RECEIVED
STATE CORPORATION COMMISSION
AUG 25 1992
08-25-1992
CONSERVATION DIVISION
Wichita, Kansas

IN ALL CASES PLOT THE INTENDED WELL ON THE PLAT BELOW

PLAT OF ACREAGE ATTRIBUTABLE TO A WELL IN A PRORATED OR SPACED FIELD

If the intended well is in a prorated or spaced field, please fully complete this side of the form. If the intended well is in a prorated or spaced field complete the plat below showing that the well will be properly located in relationship to other wells producing from the common source of supply. Please show all the wells within 1 mile of the boundaries of the proposed acreage attribution unit for gas wells and within 1/2 mile of the boundaries of the proposed acreage attribution unit for oil wells.

API NO. 15- _____
 OPERATOR STAAB ENERGY & LEASING
 LEASE POPP
 WELL NUMBER 1
 FIELD WILDCAT

LOCATION OF WELL: COUNTY Sheridan
2970 feet from south ~~xxxx~~ line of section
3630 feet from east ~~xxxx~~ line of section
 SECTION 14 TWP 9s RG 27w

NUMBER OF ACRES ATTRIBUTABLE TO WELL 320
 QTR/QTR/QTR OF ACREAGE SW - SE - NW

IS SECTION X REGULAR or IRREGULAR
IF SECTION IS IRREGULAR, LOCATE WELL FROM NEAREST CORNER BOUNDARY.

Section corner used: NE NW SE SW

PLAT

(Show location of the well and shade attributable acreage for prorated or spaced wells.)
 (Show footage to the nearest lease or unit boundary line.)

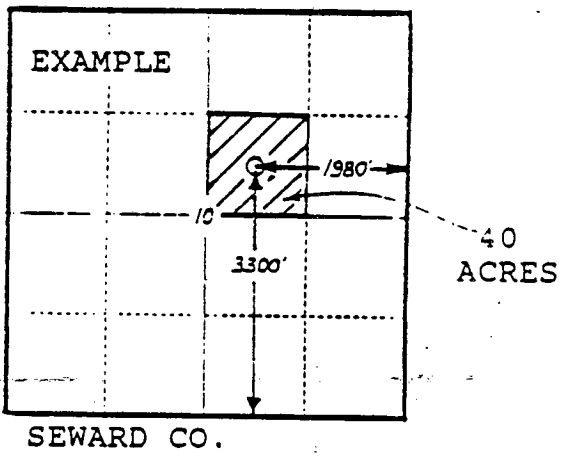
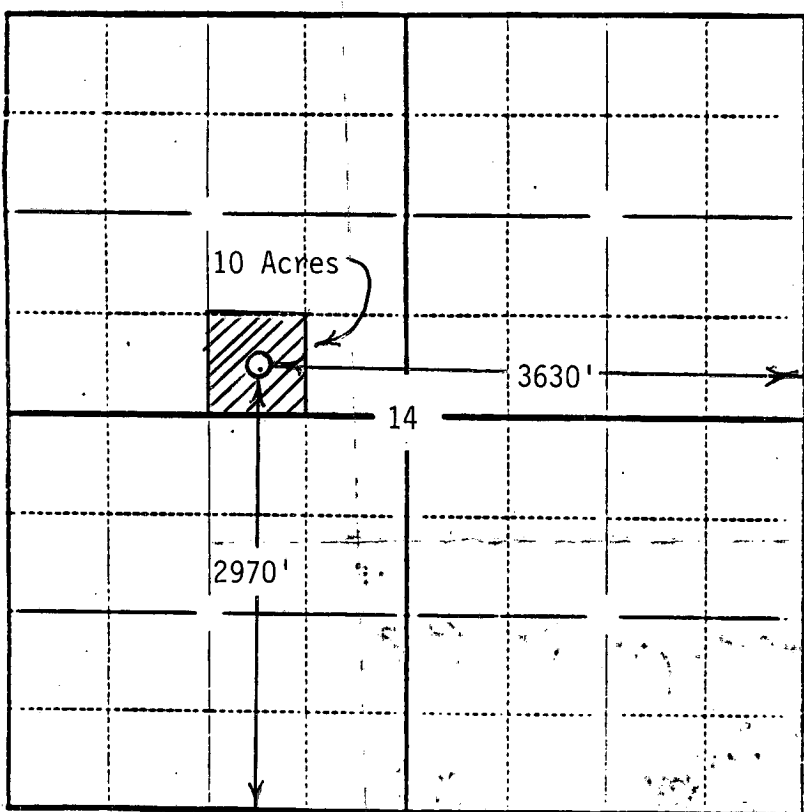

SHERIDAN
 COUNTY

In plotting the proposed location of the well, you must show:

- 1) The manner in which you are using the depicted plat by identifying section lines, i.e. 1 section, 1 section with 8 surrounding sections, 4 sections, etc.;
- 2) the distance of the proposed drilling location from the section's south/north and east/west lines; and
- 3) the distance to the nearest lease or unit boundary line.