

15-065-20364-00-00

STATE OF KANSAS
STATE CORPORATION COMMISSION

Form CP-4

Give All Information Completely
Make Required Affidavit
Mail or Deliver Report to:
Conservation Division
State Corporation Commission
212 No. Market,
Wichita, Kansas 67202

WELL PLUGGING RECORD

Graham County, Sec. 19 Twp. 9 Rge. 23 (E) (W) X

Location as "NE/CNW/SW" or footage from lines SE/SW/NW

Lease Owner John O. Farmer

Lease Name Harvey Well No. 1

Office Address 370 W. Wichita St. Russell, Kansas 67665

Character of Well (completed as Oil, Gas or Dry Hole) _____

Date well completed _____ 19 _____

Application for plugging filed _____ 19 _____

Application for plugging approved _____ 19 _____

Plugging commenced 9-10-71 _____ 19 _____

Plugging completed 9-16-71 _____ 19 _____

Reason for abandonment of well or producing formation Depleted

If a producing well is abandoned, date of last production _____ 19 _____

Was permission obtained from the Conservation Division or its agents before plugging was commenced? Yes

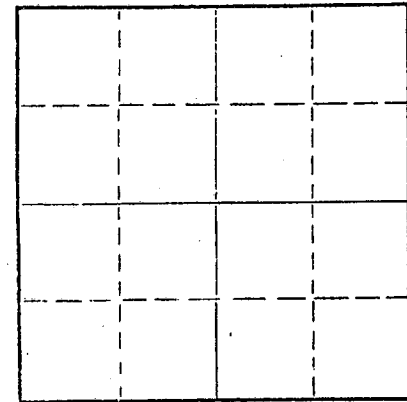

Locate well correctly on above
Section Plat

Name of Conservation Agent who supervised plugging of this well W. L. Nichols

Producing formation _____ Depth to top _____ Bottom _____ Total Depth of Well 3995 Feet

Show depth and thickness of all water, oil and gas formations.

OIL, GAS OR WATER RECORDS

CASING RECORD

FORMATION	CONTENT	FROM	TO	SIZE	PUT IN	PULLED OUT
				8 5/8"	200	None
				5 1/2"	3994	1623.75'
RECEIVED STATE CORPORATION COMMISSION OCT 4 1971 CONSERVATION DIVISION Wichita, Kansas						

Describe in detail the manner in which the well was plugged, indicating where the mud fluid was placed and the method or methods used in introducing it into the hole. If cement or other plugs were used, state the character of same and depth placed, from _____ feet to _____ feet for each plug set.

Plugged back with sand to 3900' and dumped 5 sacks cement. Shot pipe at 3418, 3320 ft. Spotted 80 BO at 700 lbs. pressure. Shot well at 2715, 2505, 2310, 2125, 1814, 1730, and 1611 ft. Pulled a total of 51 jts. of 5 1/2" casing. Squeezed with 5 sacks hulls, 17 sacks gel and 100 sacks pozmix cement, 13 sacks gel and 20 sacks cement, 3 sacks gel and 15 sacks cement.

(If additional description is necessary, use BACK of this sheet)

Name of Plugging Contractor Rockhold Engineering, Inc.

Address Box 698 Great Bend, Kansas 67530

STATE OF Kansas, COUNTY OF Barton, ss.

James W. Rockhold (employee of owner) or (owner or operator) of the above-described

well, being first duly sworn on oath, says: That I have knowledge of the facts, statements, and matters herein contained and the log of the above-described well as filed and that the same are true and correct. So help me God.

(Signature) James W. Rockhold James W. Rockhold

P. O. Box 698 Great Bend, Kansas 67530
(Address)

Subscribed and Sworn to before me this 28th day of SEPTEMBER, 1971

My commission expires October 8, 1973

Elaine Mauck
Elaine Mauck Notary Public.

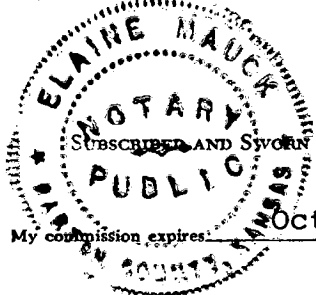

FARM NAME HARVEY
 WELL NO. 1
 COUNTY GRAHAM
 SEC. 19
 TWP. 9S
 RGE. 23W

OPERATOR John O. Farmer, Inc.

ADDRESS BOX 352, Russell, Ks.

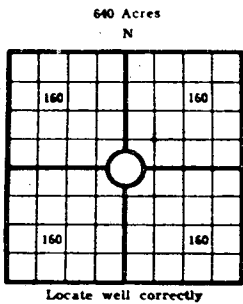

COUNTY Graham SEC. 19 TWP. 9S RGE. 23W

COMPANY OPERATING John O. Farmer, Inc.

OFFICE ADDRESS Box 352, Russell, Ks.

DRILLING STARTED 8/25/70 DRILLING FINISHED 9/2/70

DATE OF FIRST PRODUCTION _____ COMPLETED _____

WELL LOCATED SE 1/4 SW 1/4 NW 1/4 North of South

Line and _____ ft. East of West Line of Quarter Section

Elevation (Relative to sea level) DERRICK FLOOR 2427 GROUND 2424

CHARACTER OF WELL (Oil, gas or dryhole) Oil

OIL OR GAS SANDS OR ZONES

Name	From	To	Name	From	To
1			4		
2			5		
3			6		

Perforating Record If Any

Shot Record

Formation	From	To	No. of Shots	Formation	From	To	Size of Shot

CASING RECORD

Amount Set								Amount Pulled		Packer Record	
Size	Wt.	Thds.	Make	Ft.	In.	Ft.	In.	Size	Length	Depth Set	Make

Liner Record: Amount _____ Kind _____ Top _____ Bottom _____

CEMENTING AND MUDDING

Size	Amount Set		Sacks Cement	Chemical		Method of Cementing	Amount	Mudding Method	Results (See Note)
	Ft.	In.		Gal.	Make				
8-5/8"	200'		140	sx.	cement				
5-1/2"	3994'		100	sx.	cement				

Note: What method was used to protect sands if outer strings were pulled? _____

NOTE: Were bottom hole plugs used? _____ If so, state kind, depth set and results obtained _____

TOOLS USED

Rotary Tools were used from 0 feet to R.T.D. Cable tools were used from _____ feet to _____ feet, and from _____ feet to _____ feet, and from _____ feet to _____ feet to _____

Type Rig Rotary

INITIAL PRODUCTION TEST

Describe initial test: whether by flow through tubing or casing or by pumping _____

Amount of Oil Production _____ bbls. Size of choke, if any _____ Length of test _____ Water

Production _____ bbls. Gravity of oil _____ Type of Pump if pump is used, describe _____

FORMATION RECORD

Give detailed description and thickness of all formation drilled through, contents of sand, whether dry, water, oil or gas.

Formation	Top	Bottom	Formation	Top	Bottom
Surface		202			
Shale	202	1140			
Shale sand	1140	1485			
Shale	1485	1570			
Sand	1570	1835			
Redbed	1835	2070			
Anhydrite	2070	2106			
Shale shells	2106	2750			
Lime shale	2750	3750			
Lime	3750	3995			
			Log Tops		
			Heebner		3731'
			Toronto		3756'
			Lansing		3770'
			Base Kansas City		3992'
			T.D.		3995'
			Tops		

RECEIVED
 STATE CORPORATION COMMISSION
 SEP 8 1971
 CONSERVATION DIVISION
 WICHITA, KANSAS

I, the undersigned, being first duly sworn upon oath, state that this well record is true, correct and complete according to the records of this office and to the best of my knowledge and belief.

John O. Farmer
 Name and title of representative of company
 President
 8th day of September, 1970
Helen Carlson
 Notary Public.

15-065-20364-00-00