

Oil & Gas Conservation Division
WELL COMPLETION FORM
WELL HISTORY - DESCRIPTION OF WELL & LEASE

Form Must Be Typed

ORIGINAL

Operator: License 32406
Name: Phoenix Kansas Energy, LLC.
Address: 536 North Highland
City/State/Zip: Chanute, Kansas 66720
Purchaser: Plains Marketing
Operator Contact Person: Bob Barnett
Phone: (316) 431 - 2650
Contractor: Name: A & A Well Service
License: 31813
Wellsite Geologist: _____
Designate Type of Completion:

New Well Re-Entry Workover Temp. Abd.
 Oil SWD SIOW
 Gas ENHR SIGW
 Dry Other (Core, WSW, Expl., Cathodic, etc.)

If Workover/Re-entry: Old well Info as follows:

Operator: George A. Hoffman
Well Name: Albert Elmer #4111
Original Comp. Date: 7-5-1978 Original TD: 620'
 Deepening
 Plug Back Plug Back Total Depth 585'
 Commingled Docket No. _____
 Dual Completion Docket No. _____
 Other (SWD or Enhr?) Docket No. E-23622

10/24/00 NA 10/24/00
Spud Date or Date Reached TD Completion Date or
Recompletion Date Recompletion Date

API No. 15-037-19058-0001
County Crawford
- NE Sec. 30 Twp. 27 R 22 East
3610 feet from S / N (circle one) Line of Section
1340 feet from E / W (circle one) Line of Section
Footages Calculated from Nearest Outside Section Corner:
(circle one) NE SE NW SW
Lease Name: Elmer C Well # KX-8
Field Name: Hepler
Producing Formation Tucker
Elevation: Ground 969' Kelly Bushing: _____
Total Depth: 609' Plug Back TD: 585'
Amount of Surface Pipe Set and Cemented: 18'
Multiple Stage Cementing Collar Used? Yes No

RECEIVED
KANSAS CORPORATION COMMISSION
DEC 21 2000

If yes, how depth set _____
If Applicable II completion, cement circulated from 608
feet depth to Surface w/ 189 sx. cmt.

Drilling Fluid Management Plan *OWWO amended RGR 7/19/07*
(Data must be collected from the Reserve Pit)
Chloride content _____ ppm Fluid Volume _____ bbls
Dewatering method used _____
Location of fluid disposal if hauled offsite: _____
Operator Name: _____
Lease Name: _____ License No. _____
Quarter _____ Sec. _____ Twp. _____ s R. _____ East _____ West
County: _____ Docket No. _____

INSTRUCTIONS: An original and two copies of this form shall be filled with the Kansas Corporation Commission, 130 S. Market-Room 2078, Wichita, Kansas 67202, within 120 days of the spud date, recompletion, workover or conversion of a well. Rule 82-3-130 and 82-3-107 apply. Information of side two of this form will be held confidential for a period of 12 months if requested in writing and submitted with the form (see rule 82-3-107 for confidentiality in excess of 12 months). One copy of all wireline logs and geologist report shall be attached with this form. ALL CEMENTING TICKETS MUST BE ATTACHED. Submit CP-4 form with all plugged wells. Submit CP-111 form with all temporarily abandoned wells.

All requirements of the statutes, rules and regulations promulgated to regulate the oil and gas industry have been fully complied with and the statements herein are complete and correct to the best of my knowledge.

Signature: Bob Barnett
Title: Operations Manager Date: 12-18-00

Subscribed and sworn to before me this 18th day of Dec., 2000

Notary Public: Karen M. Willey

Date Commission Expires: _____

KCC Office Use Only
 Letter of Confidentiality Attached
 If denied, Yes Date _____
 Wireline Log Received
 Geologist Report Received
 UIC Distribution

Operator Name: **Phoenix Kansas Energy, LLC.** Lease Name: **Elmer C** Well #: **KX-8**

Sec. **30** Twp. **27** s R **22** East West

Instructions: Show important tops and base formations penetrated. Detail all cores. Report all final copies of drill stems test giving interval tested, time tool open and closed, flowing and shut-in pressures, whether shut-in pressure reached static level, hydrostatic pressure, bottom hole temperature, fluid recovery, and flow rates if gas to surface test, along with the chart(s). Attach extra sheet if more space is needed. Attach copy of all Electric Wiring Logs surveyed. Attach final geological well site report.

Drill Stem Tests Taken Yes No
 (Attach Additional Sheets)

Samples Sent to Geological Survey Yes No

Cores Taken Yes No

Electric Log Run Yes No

List All E. Logs Run:

Log Formation (Top), Depth and Datum Sample

Name Top Datum

See Attached

CASING RECORD <input type="checkbox"/> New <input type="checkbox"/> Used							
Report all strings set-conductor, surface, intermediate, production, etc.							
Purpose of String	Size Hole Drilled	Size Casing Set (In O.D.)	Weight Lbs./Ft.	Setting Depth	Type of Cement Used	# Sacks Used	Types and Percent Additives
Surface	NA	8"		18'	Portland	to surface	
Production	NA	2 7/8"		608'	Portland	189'	

Purpose:	Depth Top Bottom	Type of Cement	# Sacks Used	Type and Percent Additives
Perforate				
Protect Casing				
Plug Back TD				
Plug Off Zone				

Shots Per Foot	PERFORATION RECORD - Bridge Plugs Set/Type Specify Footage of Each Interval Perforated	Acid, Fracture, Shot, Cement Squeeze Record (Amount and Kind of Material Used)	Depth
2	575'-581'	91 bbls. 20-lb. gelled return brine	
		200 lbs. 20/40 mesh sand	
		800 lbs. 12/20 mesh sand	
		100 lbs. salt	

TUBING RECORD Size Set At Packer At Liner Run Yes No

None

Date of First, Resumed Production, SWD of **Enhr** Producing Method **Injection well**

will notify Flowing Pumping Gas Lift Other (Explain)

Estimated Production Per 24 Hours	Oil Bbls.	Gas Mcf	Water Bbls.	Gas-Oil Ratio	Gravity
	water injection well				

Disposition of Gas Method of Completion Production Interval

Vented Sold Used on Lease Open Hole Perf. Dually Comp. Commingled

Other (Specify)

State Geological Survey

WICHITA BRANCH
KANSAS DRILLERS LOG

COPY ORIGINAL 20325

S. 30 T. 27 R. 22 E W

API No. 15 — 037 — 20,325
County Number

Loc. 120' FNL & 280' FEL SE NW

Operator
George A. Hoffman

County Crawford

Address
P. O. Box 483 Chanute, Kansas 66720

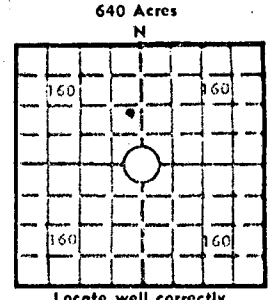

Well No. #H-11 Lease Name Albert Elmer

Footage Location
120 feet from (N) (X) line 280' feet from (E) (W) line of Sec. SE 1/4 of NW 1/4

Principal Contractor Way Drilling Co. Geologist Harold Krueger

Spud Date July 3, 1978 Total Depth 620 P.B.T.D. 594604

Elev.: Gr. 998

Date Completed July 5, 1978 Oil Purchaser General Energy

DF _____ KB _____

CASING RECORD

Report of all strings set — surface, intermediate, production, etc.

Purpose of string	Size hole drilled	Size casing set (in O.D.)	Weight lbs./ft.	Setting depth	Type cement	Sacks	Type and percent additives
Surface		6 1/4"		32'			
Casing		2 1/2"		616'	Bulk	81	

LINER RECORD

PERFORATION RECORD

Top, ft.	Bottom, ft.	Sacks cement	Shots per ft.	Size & type	Depth interval

TUBING RECORD

18 holes from 590 to 600'

Size	Setting depth	Packer set at
1"	585'	

ACID, FRACTURE, SHOT, CEMENT SQUEEZE RECORD

Amount and kind of material used	Depth interval treated

RECEIVED
KANSAS CORPORATION COMMISSION

JAN 19 2001

INITIAL PRODUCTION

CONSERVATION DIVISION

Date of first production 7-17-78 Producing method (flowing, pumping, gas lift, etc.) Pumping

RATE OF PRODUCTION PER 24 HOURS	Oil	Gas	Water	Gas-oil ratio	CFPB
	<u>5</u> bbls.	<u>0</u> MCF	<u>5</u> bbls.		

Disposition of gas (vented, used on lease or sold) _____ Producing interval(s) 590-600

INSTRUCTIONS: As provided in KCC Rule 82-2-125, within 90 days after completion of a well, one completed copy of this Drillers Log shall be transmitted to the State Geological Survey of Kansas, 4150 Monroe Street, Wichita, Kansas 67209. Copies of this form are available from the Conservation Division, State Corporation Commission, 3830 So. Meridian (P.O. Box 17027), Wichita, Kansas 66217. Phone AC 316-522-2206. If confidential custody is desired, please note Rule 82-2-125. Drillers Logs will be on open file in the Oil and Gas Division, State Geological Survey of Kansas, Lawrence, Kansas 66044.

Operator
Geo. A. Hoffman

DESIGNATE TYPE OF COMP.: OIL, GAS,
DRY HOLE, SWDW, ETC.:

Oil

ORIGINAL

Well No.
H-11

Lease Name
Albert Elmer

COPY

S ___ T ___ R ___ E
W

WELL LOG

SHOW GEOLOGICAL MARKERS, LOGS RUN,
OR OTHER DESCRIPTIVE INFORMATION.

Show all important zones of porosity and contents thereof; cored intervals, and all drill-stem tests, including depth interval tested, cushion used, time tool open, flowing and shut-in pressures, and recoveries.

FORMATION DESCRIPTION, CONTENTS, ETC.	TOP	BOTTOM	NAME	DEPTH
Soil - Clay	0	25		
Lime	25	30		
Shale	30	66		
Lime	66	80		
Shale	80	92		
Sand	92	104		
Shale	104	151		
Lime	151	155		
Coal	155	157		
Lime w/sand	157	160		
Lime	160	192		
Slate	192	220		
Sand	220	236		
Shale	236	248		
Coal	248	249		
Lime	249	270		
Shale	270	275		
Lime	275	282		
Shale	282	288		
Shale	288	291		
Sand	291	310		
Shale	310	360		
Shale	360	365		
Coal	365	366		
Shale	366	400		
Lime	400	403		
XXXX Shale	403	433		
Coal	433	434		
Shale	434	445		
Coal	445	445		
Sand w/Lm. Shale	446	460		
Shale	460	524		
Sand	524	527		
Shale	527	586		
Sand	586	593		
Sand OIL	593	603		
Shale	603	620		
Total Depth	620			

RECEIVED
KANSAS CORPORATION COMMISSION
JAN 19 2001
CONSERVATION DIVISION

USE ADDITIONAL SHEETS, IF NECESSARY, TO COMPLETE WELL RECORD.

Date Received

Geo. A. Hoffman
Signature

Owner - Operator

Title

July 21, 1978

Date

NUCLEAR WELL LOG

Adams Jetwell Service

1203 S. MAIN 205B WEST MAIN

Chanute, Kansas 66720

COMPANY GEORGE A. HOFFMAN
BOX 483, CHANUTE, KANSAS 66720
 WELL ALBERT ELMER # H-11
 FIELD _____
 COUNTY CRAWFORD STATE KANSAS

Location: 3870 NSL & 2890 WEL Other Services: _____
 Sec. 30 Twp. 27S Rge. 22E

Permanent Datum: _____, Elev. _____ Elev.: K.B. _____
 Log measured from G.L. ft. above perm. datum D.F. _____
 Drilling measured from _____ G.L. _____

Date	7-12-78	7-12-78
Run No.	1 N.W.	1 N.W.
Type Log	GAMMA RAY	PERFORATE
Depth - Driller		
Depth - Logger	604'	
Bottom logged interval	603'	
Top logged interval	200'	
Type fluid in hole	WTR.	WTR.
Cemented with		
Plug - Set at		
Level	FULL	FULL
Max. rec. temp., deg F.		
Type of shots		1 11/16 GLASS JETS
Recorded by	ADAMS	ADAMS
Witnessed by	KRUEGER	KRUEGER

RUN No.	BORE-HOLE RECORD				CASING RECORD			
	Bit	From	To	Size	Wgt.	From	To	
				2 1/2"		0	T.D.	



GEORGE A. HOFFMAN
 ALBERT ELMER # H-11
 CHANFORD COUNTY, KANSAS
 7-12-78

RECEIVED
KANSAS CORPORATION COMMISSION

JAN 19 2001

CONSERVATION DIVISION

CONSOLIDATED INDUSTRIAL SERVICES, INC.
 211 W. 14TH STREET, CHANUTE, KS 66720
 316-431-9210 OR 800-467-8676

TICKET NUMBER **15755**
 LOCATION 6 W. Starb. 15
 FOREMAN GK
1/2 E. on S. side

TREATMENT REPORT

K-8-8
API 15-037-19058-00-04

DATE <i>10-29-00</i>	CUSTOMER ACCT #	WELL NAME <i>Flora C</i>	QTR/QTR	SECTION <i>30</i>	TWP <i>27 S</i>	RGE <i>22 E</i>	COUNTY <i>Lawrence</i>	FORMATION <i>Tucker</i>
CHARGE TO: <i>TACO</i>				OWNER				
MAILING ADDRESS				OPERATOR				
CITY				CONTRACTOR				
STATE ZIP CODE				DISTANCE TO LOCATION				
TIME ARRIVED ON LOCATION				TIME LEFT LOCATION				

WELL DATA

HOLE SIZE
TOTAL DEPTH
CASING SIZE
CASING DEPTH
CASING WEIGHT
CASING CONDITION
TUBING SIZE <i>2 1/2 8 Reg V</i>
TUBING DEPTH
TUBING WEIGHT
TUBING CONDITION
PACKER DEPTH
PERFORATIONS <i>13 sheets</i>
SHOTS/FT
OPEN HOLE
TREATMENT VIA <i>1 tubing 125</i>

TYPE OF TREATMENT

<input type="checkbox"/> SURFACE PIPE	<input type="checkbox"/> ACID BREAKDOWN
<input type="checkbox"/> PRODUCTION CASING	<input type="checkbox"/> ACID STIMULATION
<input type="checkbox"/> SQUEEZE CEMENT	<input checked="" type="checkbox"/> ACID SPOTTING
<input type="checkbox"/> PLUG & ABANDON	<input checked="" type="checkbox"/> FRAC
<input type="checkbox"/> PLUG BACK	<input type="checkbox"/> FRAC + NITROGEN
<input type="checkbox"/> MISC PUMP	<input type="checkbox"/> FOAM FRAC
<input type="checkbox"/> OTHER	<input type="checkbox"/> NITROGEN

PRESSURE LIMITATIONS

	THEORETICAL	INSTRUCTED
SURFACE PIPE		
ANNULUS LONG STRING		
TUBING		

INSTRUCTIONS PRIOR TO JOB *100 gal, 1500 HCl acid spotted before Frac. Break Well down 5 stages acid 4 times, Established Max Rate, Ran for 4.00 hrs. salt ran 4.00 hrs 12/20, Overflushed 6 Bbls.*

JOB SUMMARY

DESCRIPTION OF JOB EVENTS *As Tired to Break Well down, Staged acid 4 times. Established Max Rate BPM 16, Ran for 2.40 hrs. salt 5.00 12/20, plugged 2.40 salt 100 LBS Ran 5.00 hrs more 12/20, Cleaned up Blender, & flushed to Perf. plus 6 Bbls. Flood 9.00 Bbls.*

PRESSURE SUMMARY

BREAKDOWN or CIRCULATING	<i>110 Breakdown</i>	psi
FINAL DISPLACEMENT		psi
ANNULUS		psi
MAXIMUM	<i>3000</i>	psi
MINIMUM	<i>1500</i>	psi
AVERAGE	<i>2250</i>	psi
ISIP	<i>250</i>	psi
5 MIN SIP	<i>10 Min 200</i>	<i>2000</i> psi
15 MIN SIP		<i>250</i> psi

TREATMENT RATE

BREAKDOWN BPM	<i>14</i>
INITIAL BPM	<i>14</i>
FINAL BPM	<i>16</i>
MINIMUM BPM	<i>11</i>
MAXIMUM BPM	<i>16</i>
AVERAGE BPM	<i>12.50</i>
HYD HHP = RATE X PRESSURE X 40.8	

AUTHORIZATION TO PROCEED _____ TITLE _____ DATE *10-29-00*

TICKET NUMBER **16931**
 LOCATION 6 W. 5th St 25
117 on S. side

FIELD TICKET

API 15-037-19058-00-0

DATE 10-25-00	CUSTOMER ACCT # 6730	WELL NAME K-X-8	QTR/QTR	SECTION 30	TWP 28S	RGE 22E	COUNTY Crawford	FORMATION Tucker
CHARGE TO <u>TOCO, LLC</u>				OWNER				
MAILING ADDRESS <u>536 N. Highland PO Box 425</u>				OPERATOR				
CITY & STATE <u>Chanute, Ks 66720</u>				CONTRACTOR				

ACCOUNT CODE	QUANTITY or UNITS	DESCRIPTION OF SERVICES OR PRODUCT	UNIT PRICE	TOTAL AMOUNT
5102-3	1	PUMP CHARGE <u>Trac Pump</u> <u>prop. price</u>		0.50
		HYDRAULIC HORSE POWER		
5302	1	acid spot		275 ⁰⁰
3107	125 gal	15% HCL acid		10600
1237	2nd 100LBS	Rock Salt - Med.		30 ⁰⁰
1208	1/4 Pint	Breaker LE134		17.27
1231	1/2oz 75LBS	Trac Seal		281 ²⁵
		STAND BY TIME		
		MILEAGE		
5301	2 1/2	WATER TRANSPORTS		175 ⁰⁰
		VACUUM TRUCKS		
2101	2oz	FRAC SAND 20/40		16.80
3102	10oz	10/20		115 ⁵⁰
		CEMENT		
		NITROGEN		
5109	230 Mi	TON-MILES		125 ⁰⁰
ESTIMATED TOTAL				1985.00

CUSTOMER or AGENTS SIGNATURE _____ CIS FOREMAN Frank Keittly

CUSTOMER or AGENT (PLEASE PRINT) _____ DATE 10-25-00

169818

4th well

CONSOLIDATED INDUSTRIAL SERVICES, INC.
211 W. 14TH STREET, CHANUTE, KS 66720
316-431-9210 OR 800-467-8676

TICKET NUMBER **15743**
LOCATION Chanute
FOREMAN Dwayne

TREATMENT REPORT

API 15-037-19058-00-61

DATE <u>10/10/00</u>	CUSTOMER ACCT.# <u>6920</u>	WELL NAME <u>KX-8</u>	QTR/QTR	SECTION <u>30</u>	TWP <u>24</u>	RGE <u>21</u>	COUNTY <u>Crawford</u>	FORMATION
CHARGE TO <u>1000</u>				OWNER				
MAILING ADDRESS <u>536 N. Highland</u>				OPERATOR				
CITY <u>Chanute</u>				CONTRACTOR				
STATE <u>KS</u>		ZIP CODE <u>66780</u>			DISTANCE TO LOCATION			
TIME ARRIVED ON LOCATION				TIME LEFT LOCATION				

WELL DATA

HOLE SIZE	<u>6"</u>
TOTAL DEPTH	<u>600</u>
CASING SIZE	<u>2 1/2"</u>
CASING DEPTH	<u>595</u>
CASING WEIGHT	
CASING CONDITION	
TUBING SIZE	<u>2"</u>
TUBING DEPTH	
TUBING WEIGHT	
TUBING CONDITION	
PACKER DEPTH	
PERFORATIONS	
SHOTS/FT	
OPEN HOLE	
TREATMENT VIA	

TYPE OF TREATMENT

<input type="checkbox"/> SURFACE PIPE	<input type="checkbox"/> ACID BREAKDOWN
<input checked="" type="checkbox"/> PRODUCTION CASING	<input type="checkbox"/> ACID STIMULATION
<input type="checkbox"/> SQUEEZE CEMENT	<input type="checkbox"/> ACID SPOTTING
<input type="checkbox"/> PLUG & ABANDON	<input type="checkbox"/> FRAC
<input type="checkbox"/> PLUG BACK	<input type="checkbox"/> FRAC + NITROGEN
<input type="checkbox"/> MISC PUMP	<input type="checkbox"/> FOAM FRAC
<input type="checkbox"/> OTHER	<input type="checkbox"/> NITROGEN

Re complete

PRESSURE LIMITATIONS

	THEORETICAL	INSTRUCTED
SURFACE PIPE		
ANNULUS LONG STRING		
TUBING		

INSTRUCTIONS PRIOR TO JOB Wash Down 4 Joints of Pipe and Cement to Surface

JOB SUMMARY

DESCRIPTION OF JOB EVENTS Wash Down 4 Joints of pipe and then Pumped 45K G followed by Dye and Cement when Dye came back ~~stopped~~ stopped and washed out Pump and Pumped Plug to 595'

PRESSURE SUMMARY

BREAKDOWN or CIRCULATING	psi
FINAL DISPLACEMENT	psi
ANNULUS	psi
MAXIMUM	psi
MINIMUM	psi
AVERAGE	psi
ISIP	psi
5 MIN SIP	psi
15 MIN SIP	psi

TREATMENT RATE

BREAKDOWN BPM
INITIAL BPM
FINAL BPM
MINIMUM BPM
MAXIMUM BPM
AVERAGE BPM
HYD HHP = RATE X PRESSURE X 40.8

AUTHORIZATION TO PROCEED _____ TITLE _____ DATE _____

ALL THE TERMS AND CONDITIONS STATED ON THE REVERSE SIDE ARE INCORPORATED AS PART OF THIS SALE.

CONSOLIDATED INDUSTRIAL SERVICES
AN INFINITY COMPANY

211 W. 14TH STREET, CHANUTE, KS 66720
316-431-9210 OR 800-467-8676

16866

TICKET NUMBER

LOCATION Dwayne Chanute

FIELD TICKET

Eimer C

APJ 15-037-19058-00-4

DATE <i>10/19/00</i>	CUSTOMER ACCT # <i>6920</i>	WELL NAME <i>KX 8</i>	QTR/QTR	SECTION <i>30</i>	TWP <i>27</i>	RGE <i>21</i>	COUNTY <i>Crawford</i>	FORMATION
CHARGE TO <i>TOCO</i>				OWNER				
MAILING ADDRESS <i>536 N. Highland</i>				OPERATOR				
CITY & STATE <i>Chanute Ks 66720</i>				CONTRACTOR				

ACCOUNT CODE	QUANTITY or UNITS	DESCRIPTION OF SERVICES OR PRODUCT	UNIT PRICE	TOTAL AMOUNT
<i>5401</i>		PUMP CHARGE <i>Cement Pump</i>		<i>525⁰⁰</i>
<i>5402</i>	<i>600</i>	<i>Footage</i>		<i>78⁰⁰</i>
		HYDRAULIC HORSE POWER		
<i>5609</i>	<i>2 hr</i>	<i>Wash Time</i>		<i>220⁰⁰</i>
<i>1107</i>	<i>1 SK</i>	<i>Flascol</i>		<i>35.25</i>
<i>1111</i>	<i>11 SK 150#</i>	<i>Salt</i>		<i>110⁰⁰</i>
		STAND BY TIME		
		MILEAGE		
<i>5501</i>	<i>2 hr</i>	WATER TRANSPORTS <i>Wash Time</i>		<i>140⁰⁰</i>
		VACUUM TRUCKS <i>Fresh water for cement</i>		
		FRAC SAND <i>Supplied by Customer</i>		
<i>1118</i>	<i>2 SK</i>	<i>Prem Gel About of Job</i>		<i>22⁰⁰</i>
<i>1104</i>	<i>189 SK</i>	<i>Cement Portland</i>		<i>1625.40</i>
<i>1118</i>	<i>4 SK</i>	<i>Prem Gel IA Cement</i>		<i>44⁰⁰</i>
		NITROGEN	<i>Tax</i>	<i>126.25</i>
<i>5407</i>	<i>25 mi.</i>	TON-MILES <i>On heavy</i>		<i>175⁰⁰</i>
		ESTIMATED TOTAL		<i>3101.25</i>

NSCO #15097

CUSTOMER or AGENTS SIGNATURE

CIS FOREMAN *Dwayne*

CUSTOMER or AGENT (PLEASE PRINT)

DATE

1109606